

ARCTIC AIR™ TOWER

Evaporative Air Cooler



Product Guide

SAVE THESE INSTRUCTIONS

READ ENTIRE MANUAL BEFORE USE

Congratulations!

Thanks for buying Arctic Air™ Tower – the powerful room cooler that pulls in hot air through its evaporative air-cooling anti-microbial filter and turns it into cool, refreshing air... instantly! Experience the cooling comfort of Arctic Air™ Tower.

WHAT'S INCLUDED:

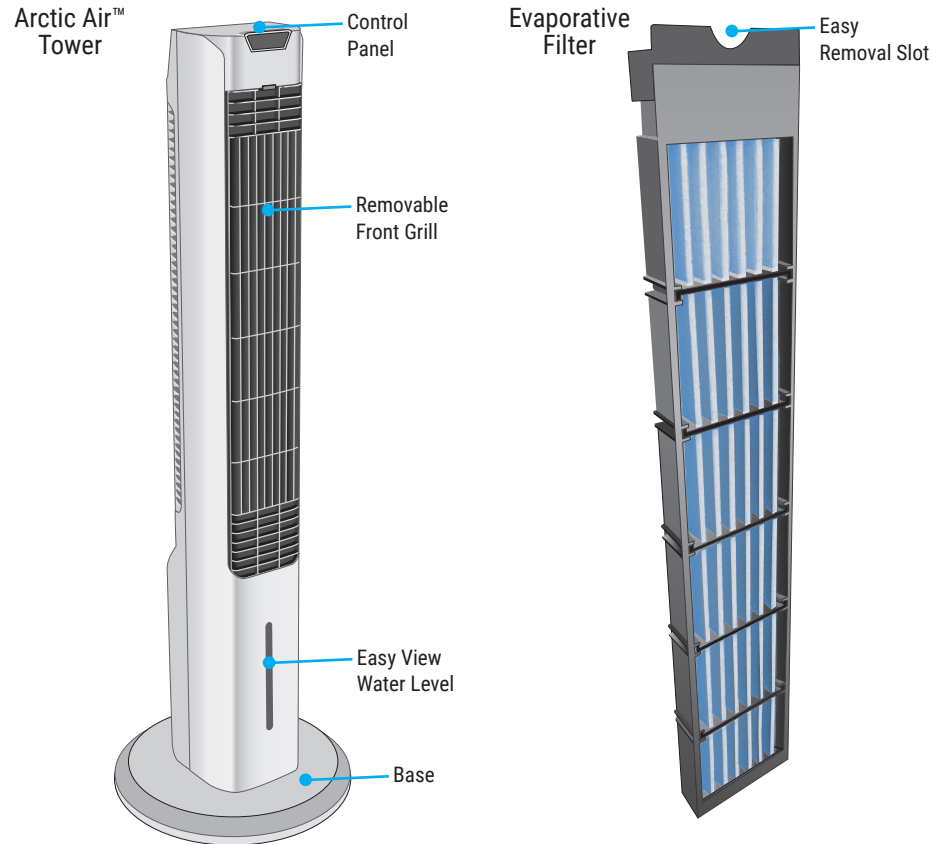

ASSEMBLY

1. Place Arctic Air™ Tower down so that the front grill is facing up while base is being assembled.

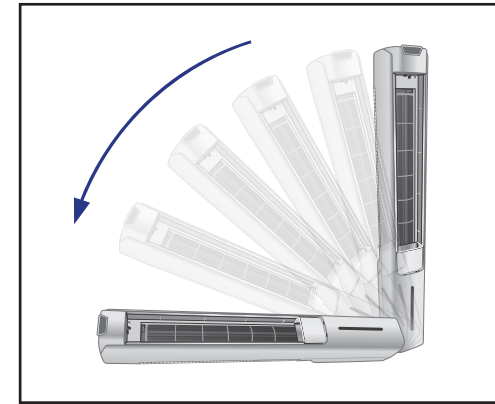

2. Assemble the two Base halves by inserting the tabs on one half into the slots on the other half.

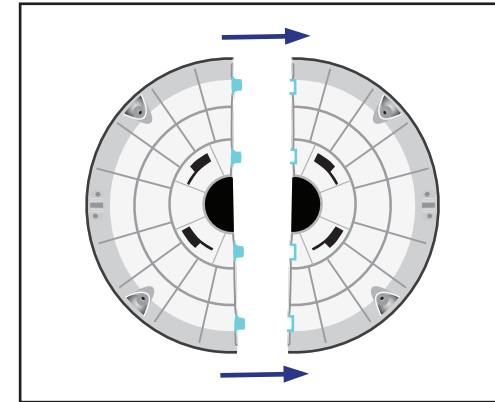

3. Align the assembled Base with the Arctic Air™ Tower. Pull the Power Cord through the hole in the center of the assembled Base.

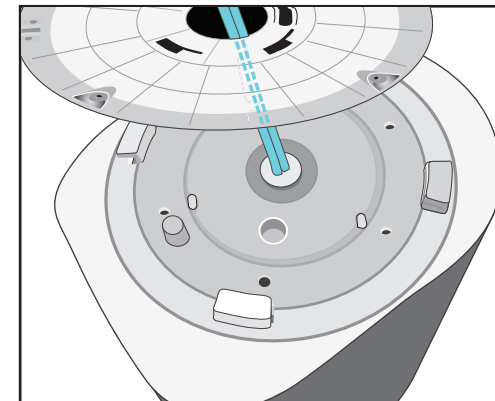

ASSEMBLY (CONT.):

- 4. Insert Tower Pegs (C) into Base Slots (D) and turn the Base clockwise (towards to the LOCK symbol) until it locks in place.
- 5. Pull the excess slack of the Power Cord through the hole. Plug the cord into a wall-outlet.

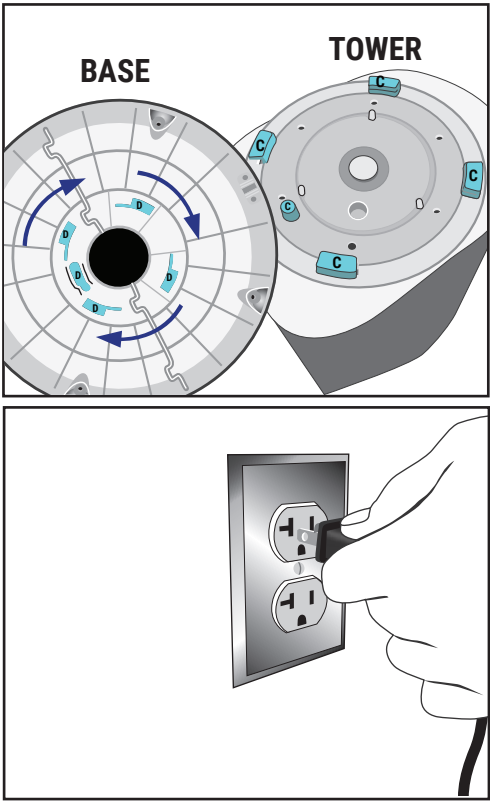

USAGE:

FILLING THE TANK

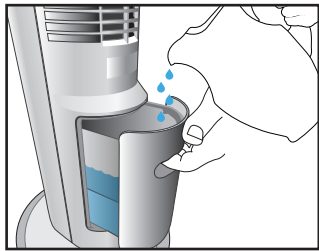



Pull out the drawer on the backside of the unit. Using a pitcher or other container, fill until MAX line. Be sure to at least fill until over MIN line or water pump will not function properly.

For Best Results, use cold water and/or ice cubes.

USAGE (CONT.):

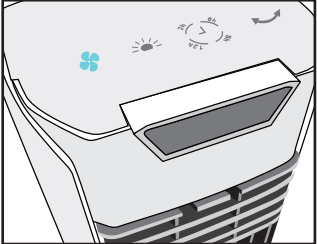
FAN SPEED



Arctic Air™ Tower has 3 fan speeds – High, Medium, and Low. To set desired speed, press the  button on the top control panel.

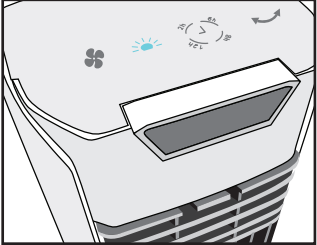

LIGHT SETTINGS

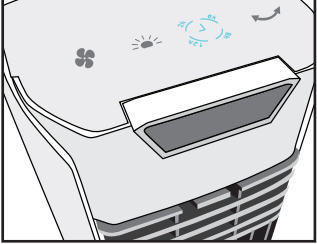

The light brightness to be dimmer or brighter can be adjusted to your liking. Lights default to high brightness, & when  button is pressed, brightness can be adjusted to half-brightness, or off.

TIMER



You can set an auto-off timer for 2, 6, 8, or 12 hours. Simply press the  button until your duration is selected. To cancel, press  until no longer lit.

OSCILLATION

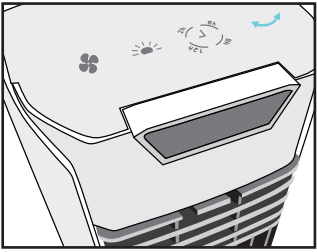

Arctic Air™ Tower also has wide-coverage oscillation built-in. Press the  button once for continuous oscillation, or press again to stop the unit where it is currently is.

MAINTENANCE:

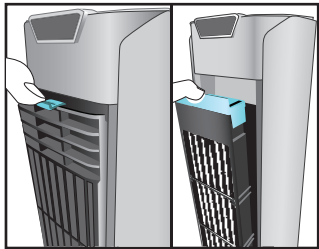

FILTER

To access filter, remove front grill by pressing tab on the top of the grill – place aside. Using the finger cut-out on the top of the filter, pull the filter towards you and remove.

We recommend weekly cleaning of your Arctic Air™ Tower and Filter to keep in best working condition, and replacing the Filter every 3-6 months.

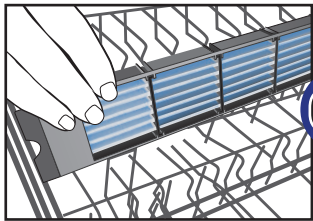

DISHWASHER: Place filter in the top-rack of your dishwasher & run cycle normally. Remove and let air dry.

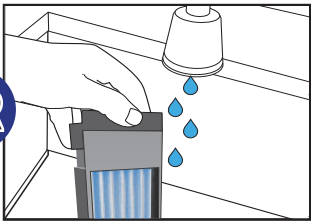

HAND WASH: Hand wash gently with warm water & soap. Shake out excess water & let air dry.

IMPORTANT: If you see mold on the filter or notice a musty smell, stop and clean the filter before further use. Soak the filter with equal parts clean water and white vinegar – allow to sit for 45-60 minutes. Rinse with warm water, wring out and let air dry.

UNIT CLEANING

- To prepare for cleaning, run Arctic Air™ Tower until all water has emptied from the water tank, or hold Arctic Air™ Tower over a sink and carefully dump out to avoid splashing or spilling.
- If you notice water tank is dirty, use a small, bendable brush (i.e. toothbrush, bottle brush, etc) and carefully clean the inside of the tank until clean. Rinse clean with warm water.

WARNINGS:

- Do not carry Arctic Air™ Tower when filled with water. Some water may remain in unit even if tank is empty.
- Use only clean water. If needed, use distilled water.
- Please read and follow regular maintenance as recommended in “Maintenance” section of this guide.
- Arctic Air™ Tower works best in non-polluted areas. Large dust/dirt particles may reduce lifetime of unit.
- We recommend use only in dry locations. If using in a moist area or environment, take care not to get water on external areas of the product.
- If a leak or spill occurs on the surface of device, unplug Arctic Air™ Tower & let it dry for 24 hours. Then, use as normal.
- Do not place in direct sunlight for extended periods of time.
- Before not using Arctic Air™ Tower for extended periods of time, empty the water tank, turn unit on, and set to highest fan speed for at least 4 hours. This will dry out then filter and inside of your unit.
- Only use the original power adapter and cord supplied in package.
- Do not touch the power supply or power cord with wet hands.
- Unplug Arctic Air™ Tower when cleaning, removing/replacing filter, or moving the device.
- For best results, place Arctic Air™ Tower on a higher surface like a table or countertop.
- Do not place Arctic Air™ Tower near a heater or any electrical equipment.
- Do not place the device in passageways or high traffic areas where there is a possibility of tripping or knocking it over.
- Do not allow any foreign objects inside Arctic Air™ Tower.
- Do not place items on top Arctic Air™ Tower.
- Do not block the front and back grills of the device.
- Do not turn the device upside down.
- Do not submerge the Arctic Air™ Tower under water or other liquids.
- Do not place Arctic Air™ Tower near open flames or fire sources.
- People with limited physical, visual or mental abilities or lacking proper experience and/or knowledge should never use the device without supervision of those responsible for their safety or those capable of assistance in using the device.
- The device can be switched off completely only when disconnected from the power supply.
- The manufacturer does not bear any responsibility for any damage from failure to comply with this product guide.
- A replaceable water filter is designed specifically for this product. If your cartridge has been broken or damaged, you can purchase a replacement.

ONTEL® ASSUMES NO RESPONSIBILITY FOR ANY INCIDENTAL OR CONSEQUENTIAL DAMAGES ARISING OUT OF YOUR USE OF THE PRODUCT. IN PURCHASING AND USING THIS PRODUCT, YOU ASSUME ALL RESPONSIBILITY FOR CLEANING THE PRODUCT AND MONITORING THE PRODUCT FOR MOLD. ADDITIONALLY, ONTEL® SPECIFICALLY DISCLAIMS ALL EXPRESSED WARRANTIES NOT OTHERWISE SET FORTH HEREIN AND ANY IMPLIED WARRANTIES OF MERCHANTABILITY OR FITNESS FOR A PARTICULAR PURPOSE. THERE ARE NO WARRANTIES WHICH EXTEND BEYOND THE DESCRIPTION OF THE FACE HEREOF.

FOR BEST RESULTS:

PRE-SOAK FILTER:

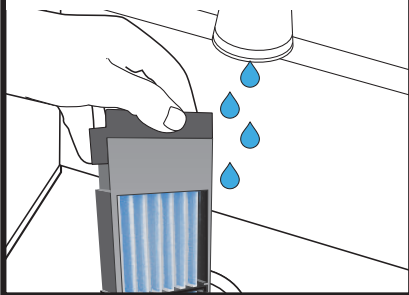

To **ACTIVATE COOLING**, soak your filter under running cold water.

PLACE IN FREEZER:

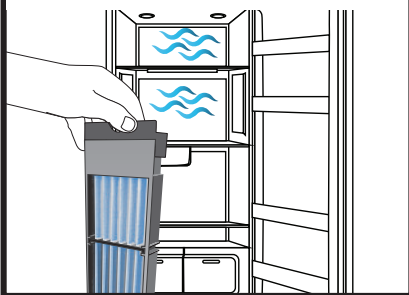

For **MAXIMUM COOLING**, place a wet filter in the freezer until frozen.

FILL WITH PITCHER:

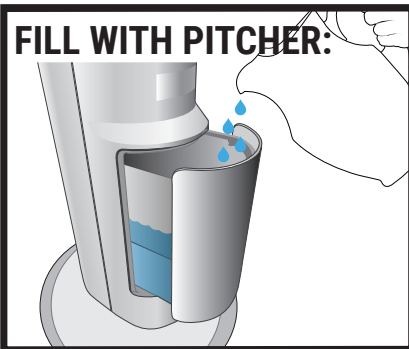

Place on flat surface & fill tank from a water pitcher. **For best results** use cold water and/or ice cubes.

FILTER CLEANING:

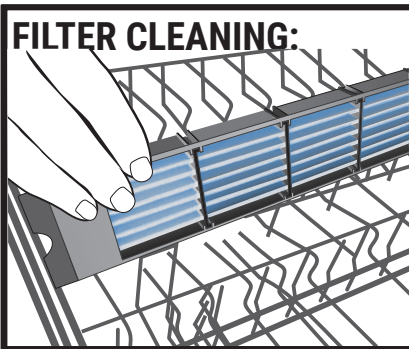

See Product Guide for Care & Cleaning instructions.

**DO NOT USE ARCTIC AIR™ TOWER WITHOUT FILTER.
WATER MAY LEAK OUT ONTO FLOOR.**

Please Note: You may notice some condensation forming on the front grill. This is normal.

FOR HOUSEHOLD USE ONLY

Made In China
Patent Pending

Model Number: 18009
AC100~120V
DC 5V, 1.5-2.0A
1217.0101