

BOOM JACKET II

RUGGED BLUETOOTH SPEAKER

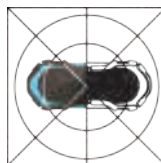

Quick Start Guide

Item # IMW579



1. Make sure the following items are included in your package.



Mount



AC Adapter

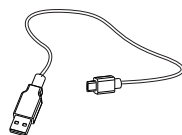

USB Cable

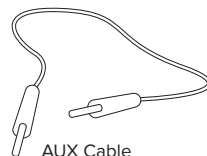
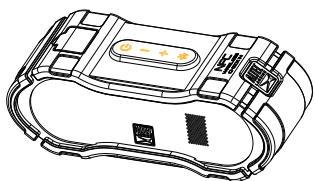

AUX Cable

2. For a look at the various buttons on your speaker, view the graphic below.

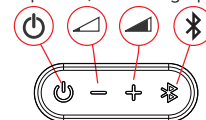
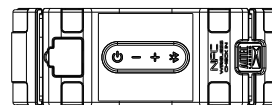

Power On	Press
Power Off.....	Hold for 2 Seconds
Play / Pause.....	Press
Volume Up / Down.....	Press + or -
Pairing Mode / Disconnect Device.....	Press
Battery Status.....	Press and +
Voice Control.....	Press 2 Times
Answer / End Call.....	Press
Stereo Plus Pairing.....	Hold for 2 Seconds
Next Track.....	Hold +
Previous Track.....	Hold -

3. Connect the included USB Cable to the included AC Adapter in order to charge your speaker's internal battery. A full charge takes approximately 4 hours.

Charging: When charging, an orange LED light will illuminate. The orange light will turn off when your unit is fully charged.

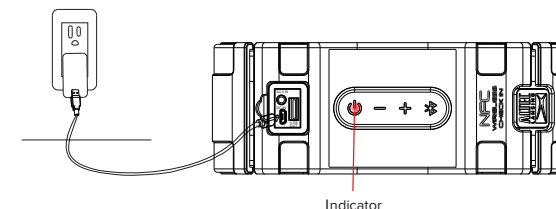

Indicator

4. Pairing Your Speaker with a Bluetooth Device

-Pairing the Boom Jacket II Speaker with a Bluetooth Device for the First Time

When you power on your Boom Jacket II speaker for the first time, it will automatically go into pairing mode. The LED status light will flash rapidly as your speaker searches for a Bluetooth audio source to pair with.

Once you have successfully paired your speaker with a Bluetooth audio source, the LED status light will stop flashing rapidly, and begin shining steadily while remaining blue. In addition, your speaker will emit an audible tone to confirm that pairing was successful.

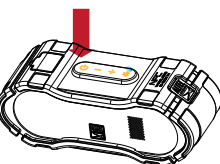

-Pairing Additional Bluetooth Devices to the Boom Jacket II Speaker
By pressing the Bluetooth Button () your speaker will again go into pairing mode. The LED status light will flash rapidly, as your speaker searches for another Bluetooth audio source to pair with.

* Pairing mode times out in 3 minutes.

5. Pair the Speaker Using NFC

With Near Field Communication (NFC), you can easily pair and connect your speaker to your compatible device. Just hold your NFC enabled device directly against the wireless check in spot on your speaker.

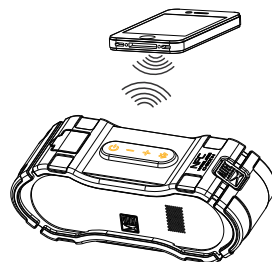

Power on your speaker. Go to the Bluetooth Manager of your Bluetooth device. Search Bluetooth devices and select "BOOM JACKET 2" to start connecting.

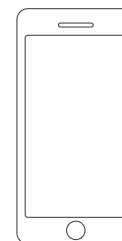

or

7. Using the Stereo Plus Pairing Feature

The Stereo Plus Pairing feature allows you to connect two Boom Jacket II speakers together for a bigger, more powerful sound.

The Stereo Plus Pairing feature can be accessed through the Altec Connect app, but you can also use it without the app. To do so, follow the steps below:

1. Have one Boom Jacket II speaker turned on, paired and playing music.
2. Power on your second Boom Jacket II speaker.
3. Press and hold the Bluetooth buttons on both speakers at the same time for two seconds.

The two connected speakers will now play the same music from the same device.

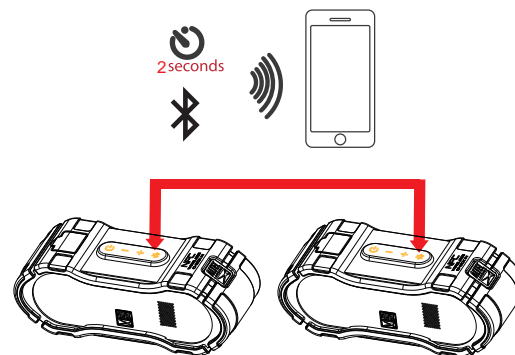

8. You can also use the included 3.5mm Auxiliary Cable to connect audio devices through the AUX In port on your speaker

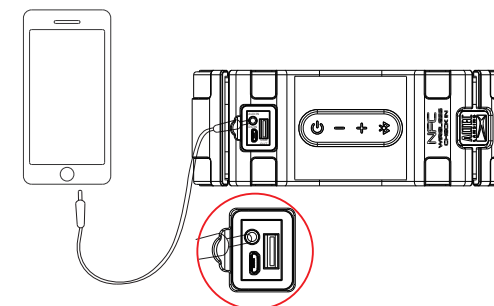

BOOM JACKET II

RUGGED BLUETOOTH SPEAKER

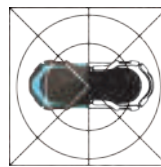

Quick Start Guide

Item # IMW579

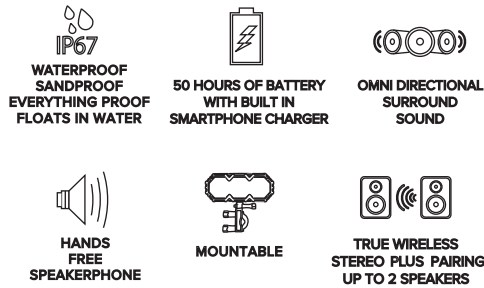

NOTE:

If product is exposed to salt water we recommend that you rinse it off with tap water to maintain proper long term performance of your product

Charging a Smartphone or Other Electronic Devices

The Boom Jacket II can be used to charge most smartphones and other electronic devices that plug into a USB port for charging. Plug one end of your device's charging cable into your device and plug the other end into the USB Out port on the you Boom Jacket II (you will need to open the waterproof cover). The Boom Jacket II does not need to be plugged in to a power outlet in order to charge your electronic devices, however, its battery life will decrease until the next time you recharge it.

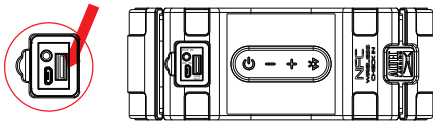

Technical Support

For technical support issues please visit our website at www.alteclansing.com. You can find manuals, software and FAQ's at the website. Can't find what you are looking for? Call 1-855-292-4087 to access our technical support information on the phone.

Altec Lansing One Year Warranty Card

This warranty covers the original consumer purchaser only and is not transferable.

This warranty covers products that fail to function properly UNDER NORMAL USAGE, due to defects in material or workmanship. Your product will be repaired or replaced at no charge for parts or labor for a period of one year.

What Is Not Covered by Warranty

Damages or malfunctions not resulting from defects in material or workmanship and damages or malfunctions from other than normal use, including but limited to, repair by unauthorized parties, tampering, modification or accident.

To Obtain Warranty Service and Troubleshooting information:

Call 1-855-292-4087 or Visit our website at www.alteclansing.com.

To receive Warranty service along with the name and address of an authorized product service center, the original consumer purchaser must contact us for problem determination and service procedures. Proof of purchase in the form of a bill of sale or receipted invoice, evidencing that the Product is within the applicable Warranty period(s), MUST be presented in order to obtain the requested service. It is your responsibility to properly package and send any defective products along with a dated copy of proof of purchase, a written explanation of the problem, and a valid return address to the authorized service center at your expense. Do not include any other items or accessories with the defective product. Any products received by the authorized service center that are not covered by warranty will be returned unrepaid.

NO WARRANTIES, WHETHER EXPRESS OR IMPLIED, INCLUDING, BUT NOT LIMITED TO, ANY IMPLIED WARRANTIES OF MERCHANTABILITY OR FITNESS FOR A PARTICULAR PURPOSE, OTHER THAN THOSE EXPRESSLY DESCRIBED ABOVE SHALL APPLY. DISTRIBUTOR FURTHER DISCLAIMS ALL WARRANTIES AFTER THE EXPRESS WARRANTY PERIOD STATED ABOVE. NO OTHER EXPRESS WARRANTY OR GUARANTY GIVEN BY ANY PERSON, FIRM OR ENTITY WITH RESPECT TO THE PRODUCT SHALL BE BINDING ON DISTRIBUTOR. REPAIR, REPLACEMENT, OR REFUND OF THE ORIGINAL PURCHASE PRICE - AT DISTRIBUTOR'S SOLE DISCRETION - ARE THE EXCLUSIVE REMEDIES OF THE CONSUMER. IN NO EVENT WILL DISTRIBUTOR, ITS MANUFACTURERS, OR SAKAR INT. BE LIABLE FOR ANY INCIDENTAL, DIRECT, INDIRECT, SPECIAL, PUNITIVE OR CONSEQUENTIAL DAMAGES (SUCH AS, BUT NOT LIMITED TO, DAMAGES FOR LOSS OF PROFITS, BUSINESS, SAVINGS, DATA OR RECORDS) CAUSED BY THE USE, MISUSE OR INABILITY TO USE THE PRODUCT. EXCEPT AS STATED HEREIN, NO OTHER WARRANTIES SHALL APPLY. NOTWITHSTANDING THE FOREGOING, CONSUMER'S RECOVERY AGAINST DISTRIBUTOR SHALL NOT EXCEED THE PURCHASE PRICE OF THE PRODUCT SOLD BY DISTRIBUTOR. THIS WARRANTY SHALL NOT EXTEND TO ANYONE OTHER THAN THE ORIGINAL CONSUMER WHO PURCHASED THE PRODUCT AND IS NOT TRANSFERABLE.

Some countries, states or provinces do not allow the exclusion or limitation of incidental or consequential damages or allow limitations on warranties, so limitation or exclusions may not apply to you. This warranty gives you specific legal rights, and you may have other rights that vary from state to state or province to province. Contact your authorized retailer to determine if another warranty applies. This product is manufactured, distributed and sold by SAKAR International, Inc. All other trademarks are the property of the respective owner, who has not sponsored, endorsed or approved this product.

This device complies with part 15 of the FCC rules. Operation is subject to the following two conditions: (1) this device may not cause harmful interference, and (2) this device must accept any interference received, including interference that may cause undesired operation.

Caution: changes or modifications not expressly approved by the party responsible for compliance could void the user's authority to operate the equipment.

NOTE: This equipment has been tested and found to comply with the limits for a Class B digital device, pursuant to Part 15 of the FCC Rules. These limits are designed to provide reasonable protection against harmful interference in a residential installation. This equipment generates, uses and can radiate radio frequency energy and, if not installed and used in accordance with instructions, may cause harmful interference to radio or television reception, which can be determined by turning the equipment off and on, the user is encouraged to try to correct the interference by one or more of the following measures:

- ___ Reorient or relocate the receiving antenna.
- ___ Increase the separation between the equipment and receiver.
- ___ Connect the equipment into an outlet on a circuit different from that to which the receiver is connected.
- ___ Consult the dealer or experienced radio/ TV technician for help.

