

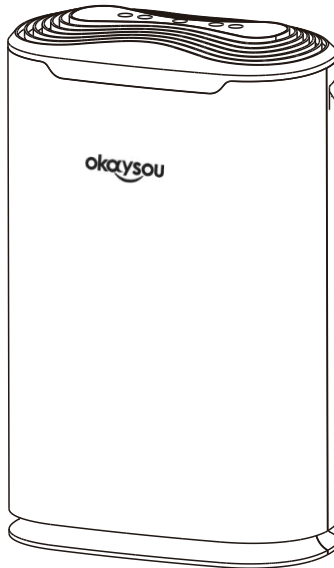

# AirMax 8L

## User Manual



Please read the user manual carefully before use. And please keep it properly after reading for checking in the future.

# CONTENTS

1.Safety Precautions.....	4
2.Product Description.....	6
Button control.....	7
3.Getting Started.....	8
Install the air filters.....	9-10
4. 5 Stages Purification.....	11
5.How to Use.....	12-13
6.Maintenance and Cleaning .....	14
General maintenance.....	14
Cleaning.....	14
Change filter.....	15-16
Long term iding.....	17
7.Troubleshooting.....	17
8.Warranty Information.....	18

## Specifications

Model: AirMax 8L

Power Supply: AC110V,60Hz,50W

Effective Range: 237 sq. ft. (22m<sup>2</sup>)

Noise Level: ≤59dB

CADR: 160CFM(180m<sup>3</sup>/h )

Size:12.9X7.1X19.4 in

## Package contents

1 x User manual

1 x Premium HEPA & Antimicrobial Filter A

1 x Premium Carbon & Catalyst Filter B

1 x AirMax 8L

# 1. Safety Precautions

**Important:** Please read and comply with all of the instructions and warnings provided in this manual before using this product to avoid causing any damages.



## WARNING



Wet hand forbidden

**Do not** touch power plug with wet hands, or it may cause electric shock.



Forbidden !

**Do not** clean this unit when it is working.

- Regularly clean the power plug to avoid the accumulation of dust which may cause damage to insulation part of the plug.



Forbidden !

**Do not** use power supply beyond specified value. Overheating and fire accident may occur if you use universal sockets or devices beyond specified value.

- Only can use 110V~alternating current (AC) power supply.



- Please make sure the plug is completely plugged before starting the device. If not, it may cause electric shock or overheating. Do not put any heavy products on wires or socket.



Forbidden !

**Do not** bind wires when using the machine to avoid electric shock, short circuit and fire accidents.

- Any cutting, scratching, refitting, over distorting, twisting, screwing and pulling of lines are all forbidden.



Regularly clean power plug

If dust accumulating on power plug, the dampness will make damage to insulation part of the plug, thus causing fire accident.

- Pull out the power plug and then clean with dry cloth(do not use wet cloth).
- If the machine will be of no use for long time, please unplug it.



Taking apart is forbidden !

**Do not** attempt to repair this device in any way or use any replacement components or parts to modify this unit.

- Doing so may cause electric shock, malfunction or fire accident. Contact Customer Support immediately.



Forbidden !

**Do not** put bars or metal products nearby air outlet or openings.

- These items may touch the internal parts of the appliance and cause an electric shock or damage.

Please turn off the power immediately in case of any of the following situations and contact Customer Support immediately:

- Malfunction of any switch.
- Circuit breaker worked or fuse burned.
- Abnormal heating of wires or plugs.
- Any burnt smell, abnormal sound or shock.



## NOTICE



Forbidden!

**Do not** use solvent like benzene, diluent to clean the machine, keep it away from wasp spray.

- Doing so may cause damages to this appliance.



Hold the plug when taking out the power plug and do not pull wires to avoid fire accident and electric shock.



Forbidden!

**Do not** use air purifier in the situation of greasy particle.

- This machine should not be used as ventilating or air evacuating equipment.



**Do not** place the air purifier near sources of heat, such as stove tops, ovens, radiators or computers.

- The air purifier cannot clear off carbon monoxide.



Forbidden!

**Do not** use the air purifier in the room with fumigation type pesticides.

Chemical residue could be accumulated inside the machine and then release from the outlet to make harm to health.

- The room should keep ventilated thoroughly after using the insecticide and then start to use air purifier.



Wetting forbidden!

**Do not** use this unit in high temperature and humid conditions, like bath room, because it may cause current leakage to lead electric shock or fire accident.



Wetting forbidden!

**Do not** use the air purifier in wet or humid environment.

- Or else it may cause electric shock or fire accident because of short circuit.



Keep away from flame!

**Do not** place the machine near the volatile substances or flammable items, such as tobacco and sparks.

## 2. Product Description

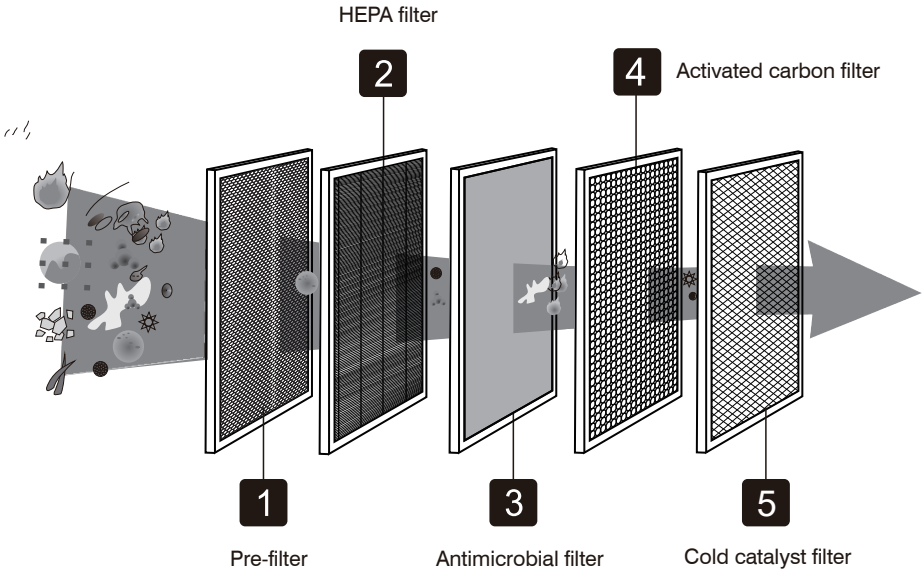
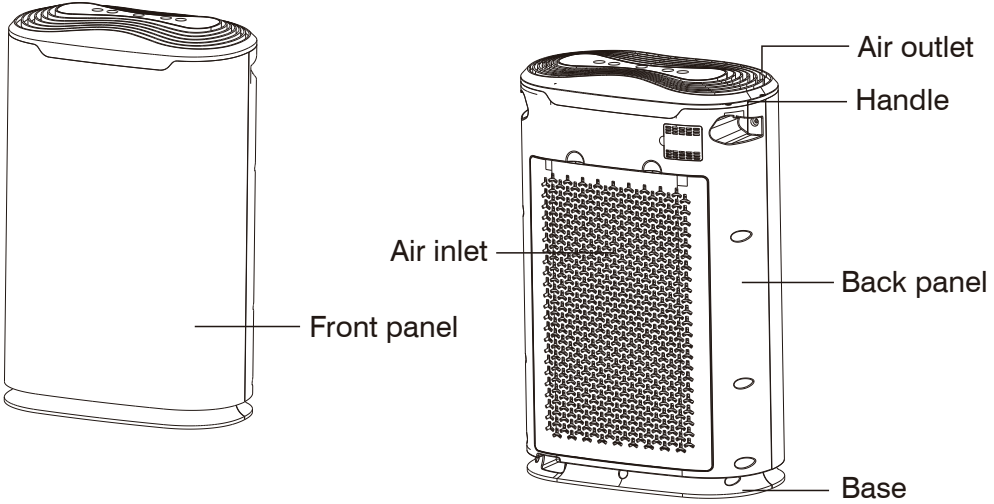

## Control panel

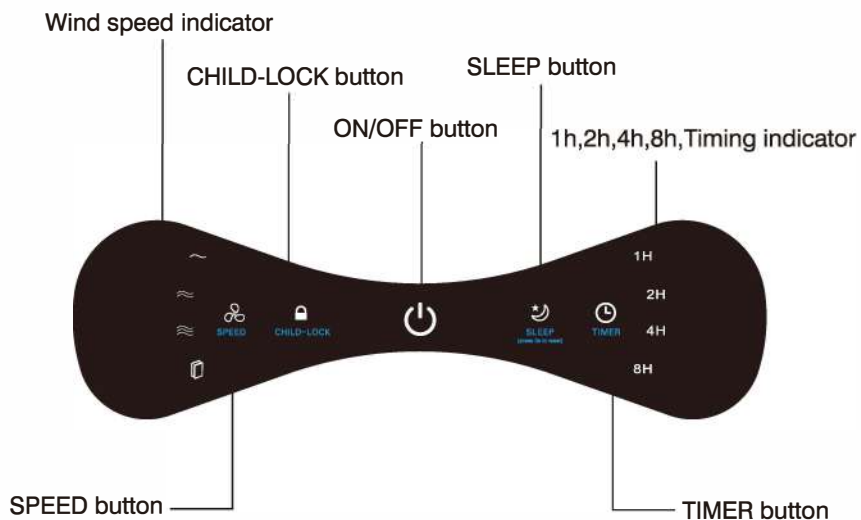

### 3. Getting Started

1. Press play button in the back cover and pull the cover, then you can lift the back cover and pull out slightly.

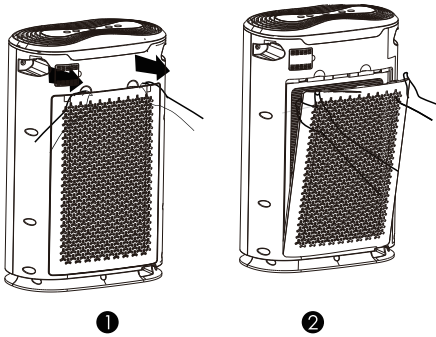

2. To reinstall the back cover, please align at the fixed groove and insert the cover into the groove, making the play button and frame withhold.

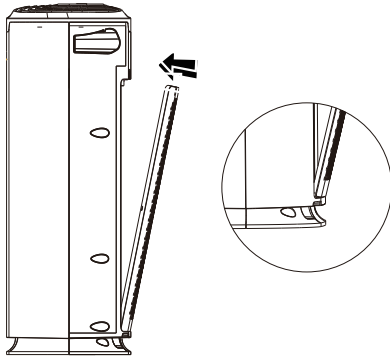

3. To make sure good air circulation effect, please ensure at least 50 cm distance between air inlet and wall or curtain. The distance to air outlet is also at least 50 cm. Please keep 1 m or more distance from TV, Radio.

#### Note

Please do not use the same socket with TV, radio and other appliances. Doing so may cause picture flutter or noise.

Do not obstruct air inlet and outlet, ensuring enough ventilation and high efficiency.

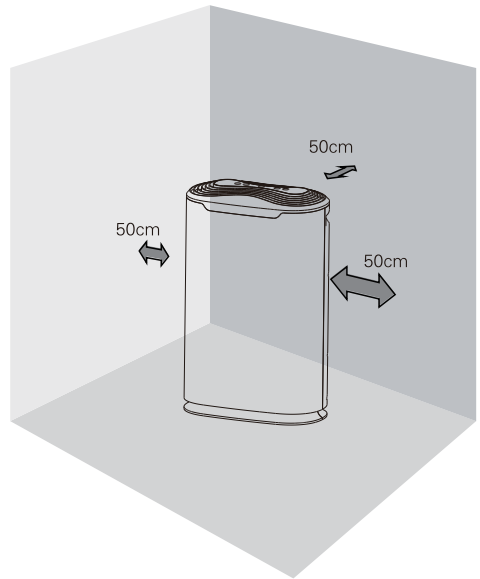



## Install the air filters

### Important:

Please remove all the packages of the filter before use. Please disassemble and reinstall filters according to the following instructions.

1. Place the air purifier in a dry, smooth and flat surface.

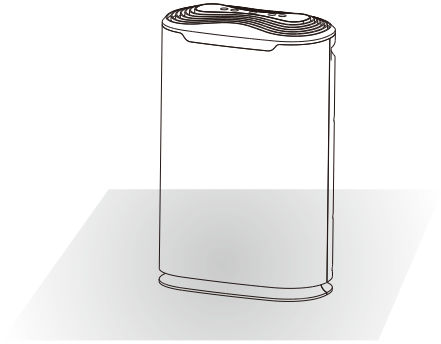

2. Press play button in the back cover and pull the cover, then lift and pull out the cover slightly.

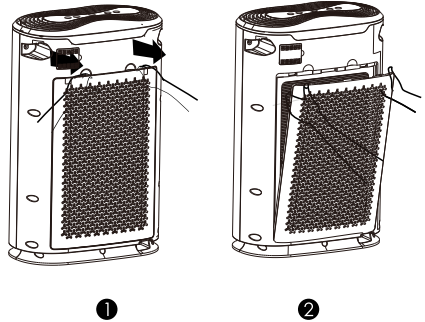

3. Disassemble all the filters.

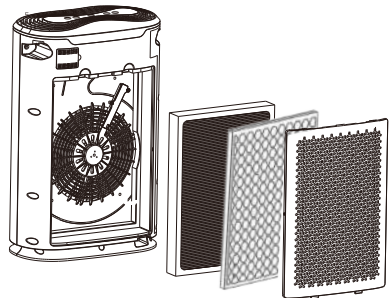

4. Remove all packages of the filters.

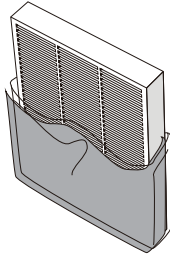

5. Replace the filters into the air purifier.

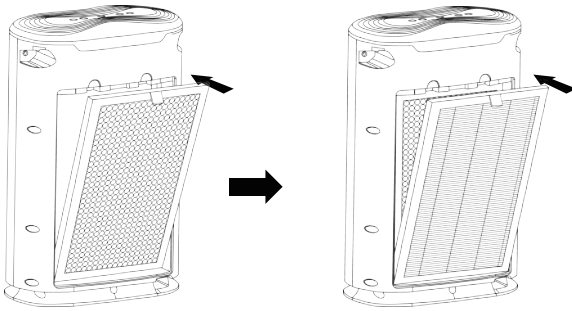

6. Reinstall the back cover.

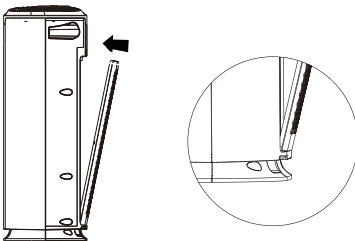

## Note

Please make sure the plug is outage when installation, maintenance or transportation.  
Please do not use the machine without filter.

## 4. 5 Stages Purification

### 5 steps filter purification

- First step: Pre-filter
- Second step: HEPA filter
- Third step: Antimicrobial filter
- Fourth step: Activated carbon filter
- Fifth step: Cold catalyst filter

#### First step: Pre-filter

Captures large particles such as pet dander, household dust and pollen.

#### Second step: HEPA filter

Removes 99.97% of particles as small as 0.25 microns.

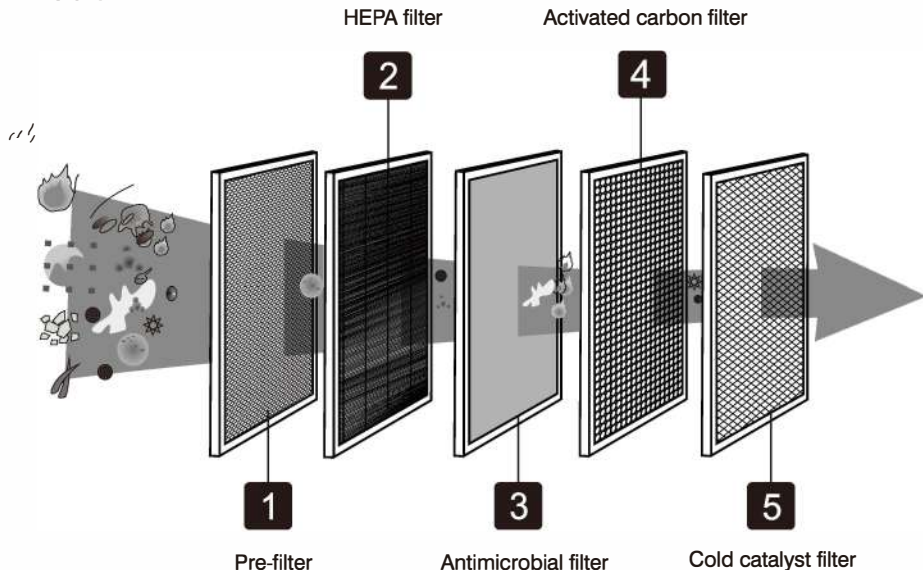

#### Third step: Antimicrobial filter

Inhibits various bacteria and the sterilization rate reaches to 99.9%.

#### Fourth step: Activated carbon filter

Absorbs volatile organic compounds and further removes toxic substances such as formaldehyde and other household odors.

#### Fifth step: Cold catalyst filter

Decomposes and captures ammonia, OVCs, hydrogen, etc.

# 5. How to Use

---

## Plug in

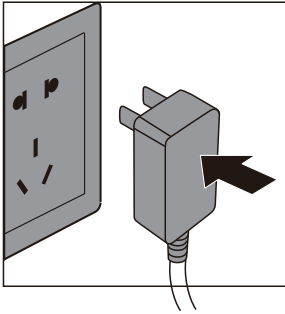

Plug the air purifier into a powered electrical outlet. The unit will set out a sound and all the indicators will be on. Then the power light will flash to enter the standby mode.

## ON/OFF button

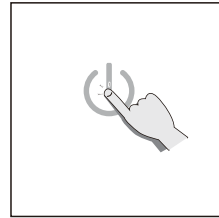

Press ON/OFF button to start producing fresh air on fan level 1.

## SPEED mode

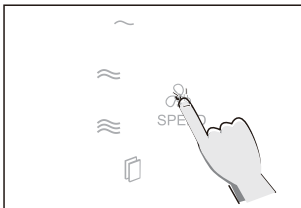

(Optional) Tap SPEED button to change fan speed from 1 to 3.

## TIMER mode

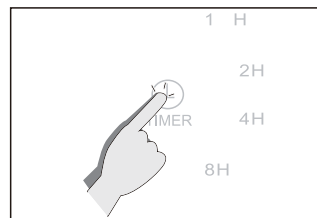

(Optional) Press TIMER button to customize the working time, 1h, 2h, 4h, 8h and no timer.

## SLEEP mode



(Optional) Tap SLEEP button to enter the sleep mode. In this mode, the indicator light of SLEEP will be on and the fan will work in the lowest speed. All the other indicator lights will be off and 10s later, the indicator light of SLEEP will be off. Press ON/OFF button to turn off the machine directly.

**Note:** Press SPEED, CHILD-LOCK, SLEEP or TIMER button while in sleep mode, the air purifier will exit the sleep mode.

The filter reset button will light up when the filters need to be replaced. Press SLEEP button for 3s to reset after changing filters.

If you want to set a time in SLEEP mode, please press TIMER button to choose 1.

If you want to set a time in SLEEP mode, please press TIMER button to choose 1h, 2h, 4h or 8h, then press the SLEEP mode button.

## CHILD-LOCK mode

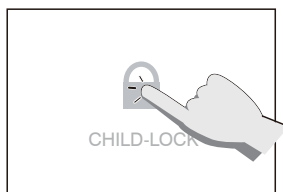

(Optional) Press CHILD-LOCK button for 3s, the indicator light of the CHILD-LOCK will be on. In this condition, the air purifier won't be action when pressing any key; Press another 3s to exit the CHILD-LOCK mode.

## 6. Maintenance and Cleaning

### General maintenance

Please make sure to pull out power plug before cleaning the unit.

Do not immerse the purifier in water or liquid detergents.

Do not use any detergent with abrasiveness, corrosive or inflammability, such as bleach or alcohol to clean any parts of the machine. The filters cannot be wash.



### Cleaning

Clean the air purifier regularly to prevent the dust accumulation.

Use soft and dry cloth to remove the dust from the air purifier.

Use soft and dry cloth to clean the outlet and inlet of the machine.

## Change filter

1. The filter replacement indicator light will be on to remind you to change the filters.

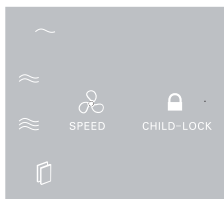

2. Turn off the power and pull out the plug.

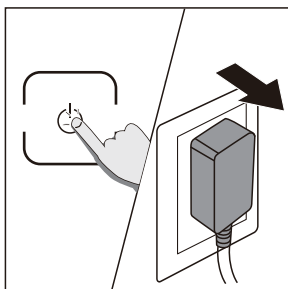

3. Press play button in the back cover to pull out the cover slightly.

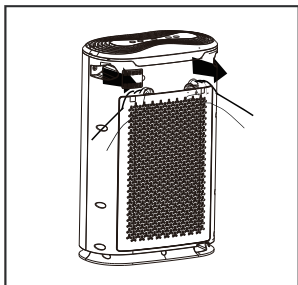

4. Remove all the filters.

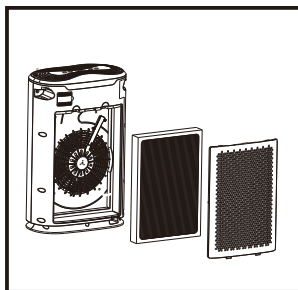

5. Remove all packages of filters, then install the new ones into the air purifier orderly.

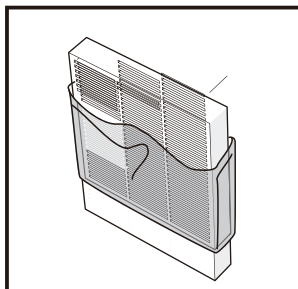

6. To reinstall the back cover, please align at the fixed groove and insert the cover into the groove, making the play button and frame withhold.

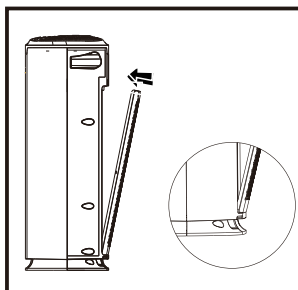

7. Plug in and turn on the air purifier.  
Press SLEEP button for 3s to reset  
the machine.

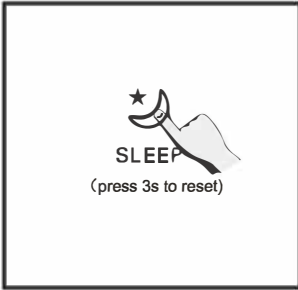
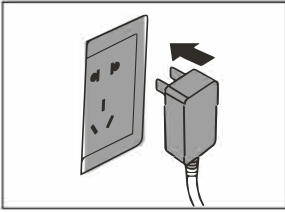

### Note

When the purifier runs for 1500 hours, the air purifier will send a siren and the indicator light of filter replacement will light up to remind you to change the filter. At this condition, the machine can still work normally.

## Long term idling

Pull out power plug if you do not use the air purifier.

Keep the purifier inside dry thoroughly, or else it may cause malfunction because rust.

Place the purifier in dry and ventilating place.  
Do not place flat or upside down to avoid malfunction.



## 7. Troubleshooting

The following problems may appear in daily use. Please contact Customer Support immediately if you could not find a solution in this chart.

Problem	Possible reason	Solution
Air purifier cannot work	Unit is not plugged into an electric outlet	Connect the plug to a powered electric outlet
	Power plug or wire is damaged	Contact customer support immediately
Fan does not work	Unit does not turn on	Plug in and turn on
	Motor is defective or loose	Contact customer support immediately
	Foreign particles come inside	Contact customer support immediately
	Filter packing is not removed	Remove packages of every filters
	Machine on uneven ground	Move to even and flat ground
Bad performance	Filter need to be replaced	Replace the filter
	Machine inlet or outlet blocked	Contact customer support immediately
	Filter plastic package is not removed	Remove all the packages and then use
	No enough space	Please ensure there is 50 cm distance between two-side air inlet, and the distance to air outlet is not less than 50 cm
	Lack of filter or the filter is not properly placed	Make sure all the filters are placed orderly in accordance with instructions
	Exceed the effective range	Check whether the room areas are within the effective cover area

## 8. Warranty Information

---

Okaysou warrants all products to be of the highest quality in material, craftsmanship, and service, effective starting from the date of purchase.

Okaysou will replace any product found to be defective due to manufacturer flaws based on eligibility. Refunds are available within the first 30 days of purchase.

Refunds are only available to the original purchaser of the product.

This warranty does not apply to the following:

- Damage due to abuse, accident, alteration, misuse, tampering or vandalism.
- Improper or inadequate maintenance.
- Damage in return transit.

### 2-year warranty

Please enter [www.okaysou.com/warranty](http://www.okaysou.com/warranty) to complete the warranty application to enjoy your 2-year warranty with more confidence. You could also enjoy more discounts and giveaway activities!

If you have any questions or concerns about your product, please feel free to contact our Customer Support.

**Email:** [Support@okaysou.com](mailto:Support@okaysou.com)

**Website:** [www.okaysou.com](http://www.okaysou.com)