

**TRAMONTINA**

**HOME APPLIANCES**

## 4.6 Cu. Ft. Deluxe Wine Cooler



### Use & Care Instructions

Read All Instructions Carefully.

Save These Instructions.

# Table of Contents

Product Introduction .....	2
Installation .....	3-8
Cleaning and Maintenance .....	8
LED Light Replacement .....	9
Troubleshooting .....	10
Safety Warnings .....	11
Customer Service .....	11
Product Warranty .....	12



US  
233267

Model #80901/103

# PRODUCT INTRODUCTION



- 1 Adjustable Electronic Thermostat with Digital Display
- 2 LED Light and Power Control
- 3 LED Interior Light
- 4 Adjustable Wood Shelves
- 5 Double Wood Shelf
- 6 Adjustable Front Leveling Legs
- 7 Double Pane Glass Door with Stainless Steel Frame
- 8 Stainless Steel Handle

# INSTALLATION

# STOP!

## BEFORE YOU DO ANYTHING!

**Do not plug the wine cooler into a power outlet until it has been resting in its upright position for at least six (6) hours.**

If the wine cooler has been laid on its side, placed upside down or tilted more than 45° during moving or transport, it is extremely important to allow the refrigerant and compressor oil to separate and settle so the compressor operates properly. Failure to do so will cause severe mechanical problems with the unit's motor/compressor, and *will void the warranty*.

## TRANSPORT

Use two or more people to move the wine cooler.

Do NOT use stainless steel handle to move or lift the unit.

## VENTILATION SPACE

In order for the wine cooler to function efficiently, it MUST be placed in an adequately ventilated space to allow for heat dissipation. It is important to allow at least 4 inches (100 mm) of space behind and on each side, and 8 inches (200 mm) of space above the unit.

The door requires approximately 22" (558 mm) of space in front of the wine cooler to open. To fully utilize the unit, space should be allowed for the door to open fully to 160°.

## STABLE SURFACE

The wine cooler must be placed on a flat, stable surface. Adjust the unit's front leveling legs to assure quiet operation and prevent rattling when the compressor activates.

**IMPORTANT:** Never place the unit on soft materials such as foam, plastic or thick textured carpeting.

# INSTALLATION

## POWER SUPPLY

This wine cooler is equipped with a 115V/60Hz single phase motor. If the power supply to the unit is subject to large fluctuations, it is strongly advised to utilize a wall-mounted power conditioner surge protection device to prevent damage to the electronic components and motor.

The power plug is a standard grounded three-prong non-polarized flush mount, which allows for easier connection to power outlets.

Power plug must be connected to the outlet directly, and never to an extension cord.

**IMPORTANT:** Do not cut or remove the third ground prong from the power cord.

## POWER CORD

Never shorten or lengthen the power cord. Do not fold or coil the power cord.

**IMPORTANT** - Never place the excess length of power cord into the compressor enclosure in the back of the wine cooler. This action creates a dangerous heat build-up which can melt the cord, cause an electrical hazard and may potentially cause a fire.

Touching the power cord to the compressor at the back of the unit during operation can create an electrical hazard and damage the compressor.

If the power cord is damaged, it must immediately be replaced by a trained service provider, as special tools are required.

**IMPORTANT:** Never use with an extension cord.

## CLEAN BEFORE USE

To remove any manufacturing dust and residual odors, wipe the wine cooler inside and out with a damp cloth and a solution of baking soda and warm water (2 tbsp. baking soda to 1 qt. water). Wipe away any residual baking soda with a clean moist cloth. Allow to dry before operating.

Periodically clean the wine cooler with a sponge or cloth moistened with mild soapy water, or baking soda and water.

## PROTECT FROM MOISTURE

Heavy moisture in the environment can cause degradation to the insulation, as well as rust to the cabinet, compressor and/or power supply.

Do not spray the wine cooler with water.

## PROTECT FROM HEAT

Place the wine cooler away from heat source or direct sun.

The hotter the operating environment, the harder the compressor has to work to keep the contents cold, which will shorten the operating life.

Do not cover the wine cooler with tarps or other items while operating, as this may cause overheating.

# INSTALLATION

## HANDLE INSTALLATION

**IMPORTANT: NEVER LAY THE WINE COOLER ON ITS BACK.**

The compressor and motor components are installed at the back of the unit and may easily be damaged if the wine cooler is placed on its back.

**IMPORTANT: DO NOT USE STAINLESS STEEL HANDLE TO MOVE OR LIFT THE UNIT.**

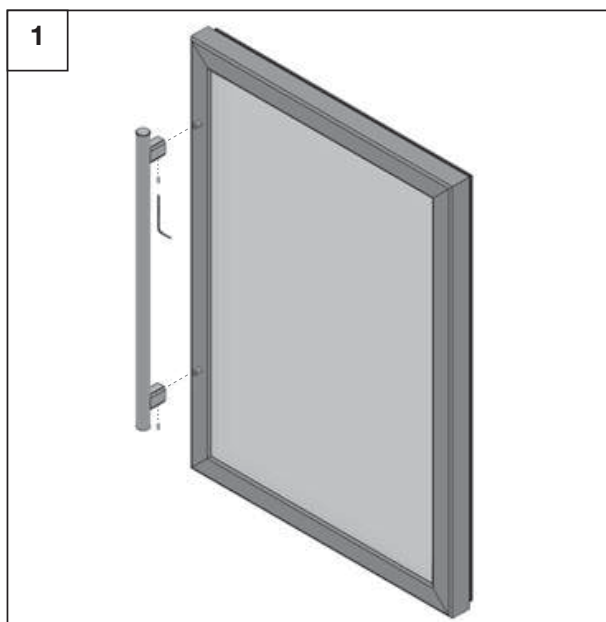

1  
Locate the two mounting studs protruding from the exterior stainless steel door frame.

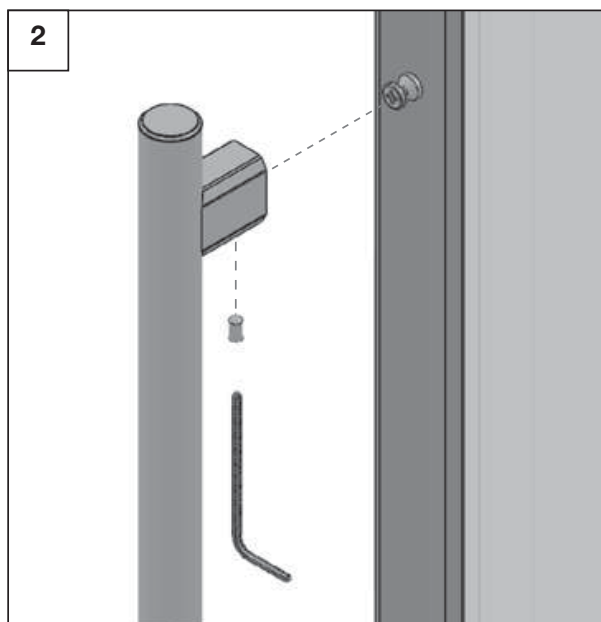

2  
Align the stainless steel handle door handle with the mounting studs. Make sure the holes in the mounting bracket are facing down.

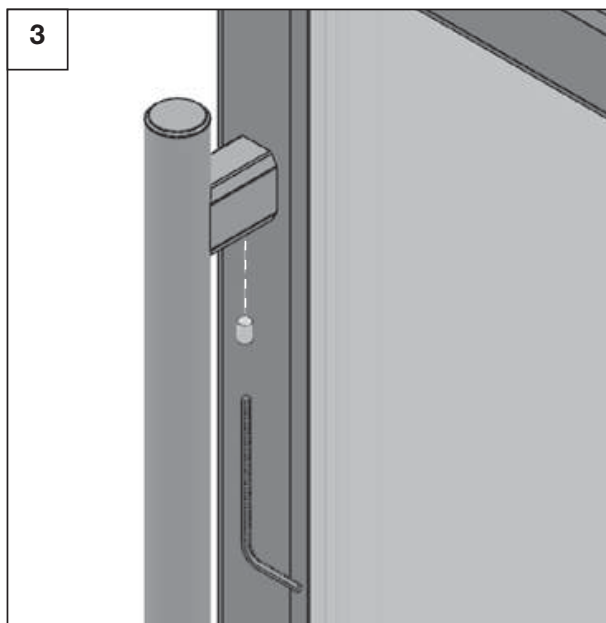

3  
Insert the included set screws into the holes. Use the included Allen key to tighten both the top and bottom mounts.

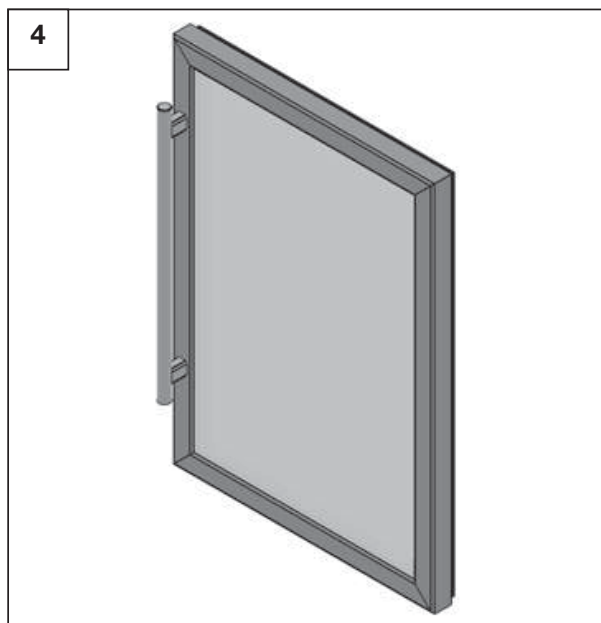

4  
Take care to not overtighten the set screws to prevent damage to the mount or door.

# INSTALLATION

## USING YOUR WINE COOLER

The wine cooler is designed for the storage of wine.

After connecting the wine cooler to a wall outlet, you will immediately hear a short beep.

Use the  $\wedge$  and  $\vee$  buttons to set the set the desired temperature.

Fahrenheit range: 33° – 50°F

Celsius range: 1° – 10°C.

### **NOTE:**

Press the “light” and “power” buttons simultaneously for two seconds to convert the thermostat display between Fahrenheit and Celsius.

After setting the desired temperature, the thermostat displays the current temperature inside the wine cooler. As the cooler chills over several hours, the display adjusts to reflect the interior temperature.

Allow the wine cooler to completely chill to the specified temperature prior to adding wine. To ensure proper cooling, do not overload the unit.

Press and hold the “power” button for three seconds to turn the cooler off.

## LED LIGHT

The LED automatically turns on and off each time the door is opened or closed.

# INSTALLATION

## STOCKING YOUR WINE COOLER

The wine cooler accommodates 45 standard wine bottles. To accommodate all 45 bottles, position the wood shelves and stock the wine as illustrated below.

Due to air circulation, temperatures may vary slightly within the cooler. Typically, the upper shelves may exhibit warmer temperatures, while the lower shelves exhibit cooler temperatures.

**ROW 1**  
7 bottles

**ROW 2**  
7 bottles

**ROW 3**  
7 bottles

**ROW 4**  
7 bottles

**ROW 5**  
7 bottles

**DOUBLE WOOD  
SHELF**  
10 bottles



**BOTTLE CONFIGURATION  
ON SHELF**



**BOTTLE CONFIGURATION  
ON DOUBLE WOOD SHELF**





# INSTALLATION

## SHUTDOWN

If the wine cooler will not be in use for a long period of time, disconnect it from the power outlet, clean inside thoroughly and leave the door open to prevent mildew.

## SAFETY WARNING

The appliance is not intended for use by young children or infirm persons without supervision. Young children should be supervised to ensure that they do not play with the appliance.

This wine cooler should not be positioned within a recessed or enclosed cabinet. It is designed for freestanding installation only. This unit is not designed to be installed in a RV, garage or any outside installation.

The surface of the compressor may become hot during normal operation. Do not touch as this may cause injury.

## OTHER DANGERS

Keep the wine cooler away from any combustible or volatile liquids or gases, including gasoline, oil, alcohol, paint, paint thinners and solvents. Such chemicals should never be stored in the unit.

---

# CLEANING AND MAINTENANCE

It is important to periodically clean and maintain the wine cooler. When performing maintenance, make certain the unit is unplugged from the power outlet.

Wipe the inner and outer surfaces of the wine cooler clean with a damp cloth. If needed, use a gentle detergent or a solution of baking soda and water. Remove any residue with clean water and a soft cloth, then dry with another cloth.

Once clean, you may use a common kitchen appliance wax on outer surfaces.

Inspect, clean and maintain the rubber gasket around the door. A small amount of petroleum jelly applied to the bracket side of gaskets will keep the gasket pliable and ensure a good seal.

### **IMPORTANT:**

- Do NOT use hot water, harsh detergents, gasoline, kerosene, solvents, acids or anything flammable to clean the wine cooler. These can damage the paint and degrade the plastic components.
- Do NOT spray the wine cooler with water as this may cause rust and degrade the insulation.

# LED LIGHT REPLACEMENT

**TOOLS NEEDED:** Phillips screwdriver and flashlight to illuminate the work area.

If the LED light is not illuminating, the light most likely needs to be replaced.

A replacement LED light may be purchased from Tramontina by calling Tramontina's Customer Service Department (800-221-7809).

**NOTE:** The replacement light is NOT available from home improvement, hardware or discount stores.

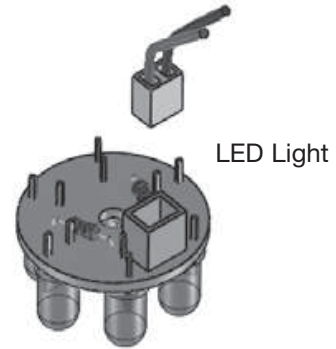

## Removing the Existing LED Light

Unplug the wine cooler.

- 1) To remove the clear plastic cover, press and slide towards the back of the cooler.
- 2) Remove the center screw to release the LED light assembly.
- 3) Gently unclip the power cable from the white socket.

## Installing the Replacement LED Light

- 1) Insert the power cable into the white socket.
- 2) Reattach the LED light assembly to the top panel.
- 3) Reattach the clear plastic cover by positioning it over the LED light and sliding toward the door.

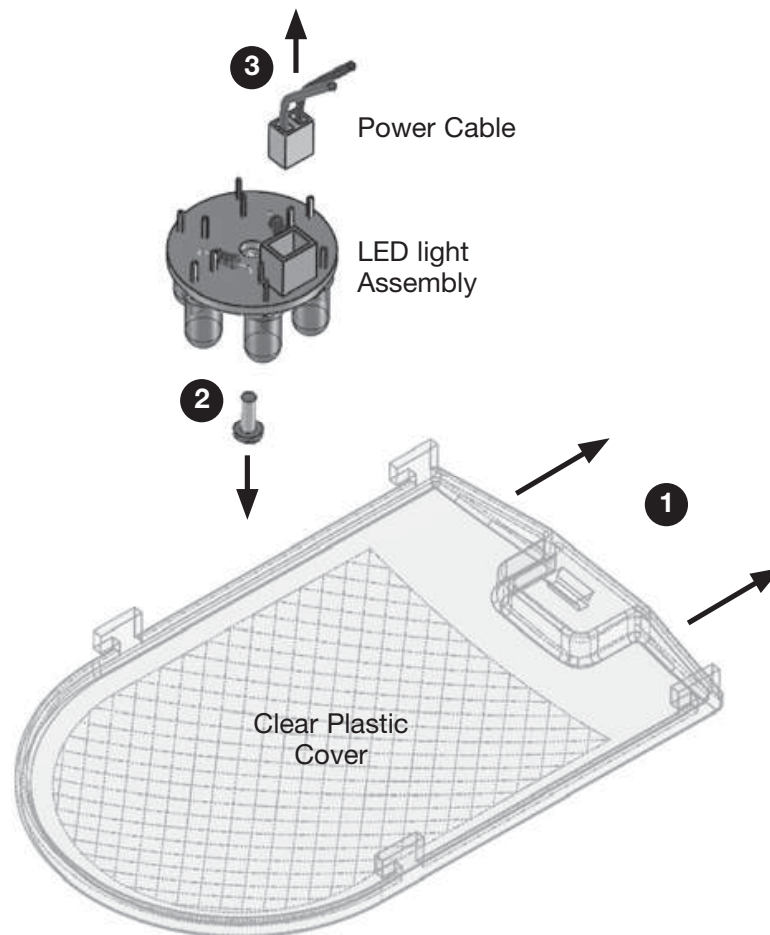

LED Light Diagram

# TROUBLESHOOTING

Problem	Recommended Adjustment
Wine cooler doesn't work.	<ul style="list-style-type: none"> <li>• Check for power failure.</li> <li>• Verify cooler is plugged into power outlet.</li> <li>• Check if control panel is on.</li> <li>• Check home fuse box to determine if a fuse has blown.</li> </ul>
Wine cooler is too cold.	<ul style="list-style-type: none"> <li>• Adjust thermostat to higher number.</li> </ul>
Wine cooler is not cooling sufficiently.	<ul style="list-style-type: none"> <li>• Adjust thermostat to lower number.</li> <li>• Ensure door is closed properly.</li> <li>• Door gaskets may be damaged.</li> <li>• Cooler may not have enough ventilation space around it.</li> <li>• Cooler in a hot area or in sunlight.</li> <li>• Something hot may have been placed in the cooler.</li> <li>• Overloading the wine cooler may block circulation of cool air.</li> </ul>
Wine cooler compressor runs for long periods.	<ul style="list-style-type: none"> <li>• Hot weather and/or frequent door opening will force the cooler to work harder to keep cool.</li> <li>• Do not overload the wine cooler.</li> <li>• Do not put hot beverages in the wine cooler.</li> </ul>
E or F is showing in the display.	<ul style="list-style-type: none"> <li>• Contact Tramontina's Customer Service Department for assistance.</li> </ul>
Flashing H within the display and emitting buzzer alarm.	<ul style="list-style-type: none"> <li>• Temperature in the cooler is too high. Press any key to cancel the alarm. Remove some bottles of wine to allow the cooler to properly chill.</li> </ul>
Flashing L within the display.	<ul style="list-style-type: none"> <li>• Temperature in the cooler is too low.</li> </ul>
Wine cooler door does not close properly.	<ul style="list-style-type: none"> <li>• Cooler may be tilted – adjust front legs to level unit.</li> </ul>
Side panel of wine cooler is hot.	<ul style="list-style-type: none"> <li>• The cooler has a pipe that heats up to remove condensation. Does not indicate a malfunction.</li> <li>• Usually happens when door is opened and closed frequently, or when operated in high temperature weather. Results from dissipation of heat from within the unit. Do not touch the panel. Does not indicate a malfunction.</li> </ul>
Condensation forms along the seals or on the outside of the wine cooler.	<ul style="list-style-type: none"> <li>• Condensation forms under situations of high humidity; does not indicate a failure. Wipe condensation with dry towel.</li> </ul>
Sound of trickling water.	<ul style="list-style-type: none"> <li>• This is the refrigerant flowing. Does not indicate a malfunction.</li> </ul>
Buzzing sound.	<ul style="list-style-type: none"> <li>• A buzzing noise is typically generated by the compressor when starting up or shutting down.</li> </ul>
Odor.	<ul style="list-style-type: none"> <li>• Cooler may require cleaning.</li> </ul>

# SAFETY WARNINGS

**DANGER** - Risk of fire or explosion.

- Refrigerant is both flammable and poisonous.
- Do not puncture refrigerant tubing.
- Do not breathe in refrigerant.
- **Cooler is to be repaired ONLY by trained service personnel.**
- **Consult this guide before attempting to service this product.**

## DISPOSAL

Dispose of cooler in accordance with federal and local regulations.

**REMOVE WINE COOLER DOOR BEFORE DISPOSING UNIT.**

### ***SUFFOCATION HAZARD:***

The shelves should remain in the wine cooler for disposal. This deters children from climbing into the unit, becoming trapped and potentially suffocating.

All safety precautions must be followed.

---

# CUSTOMER SERVICE

In the unlikely event this item is damaged or missing parts, please do not return it to the store. Instead, please contact our customer service department listed below for assistance so we can work quickly and efficiently to resolve product issues.

**TRAMONTINA USA, Inc.**  
**Customer Service**  
12955 West Airport Blvd.  
Sugar Land, TX 77478-6119  
(800) 221-7809  
[www.tramontina-usa.com](http://www.tramontina-usa.com)

# 1 YEAR LIMITED WARRANTY

This product is warranted by **TRAMONTINA** to be free of defects in material and workmanship for a period of one year from the date of the original purchase, provided the unit is used under normal operating conditions intended by the manufacturer. Any piece will be repaired or replaced at no charge with the same item or one of equal or better value if it is found to be defective under normal, noncommercial single-family household use and when cared for according to the manufacturer's instructions. This warranty does not cover lost or stolen items, any food loss due to product failure, or defects caused by accidents, fire, flood, improper installation or abuse or misuse of the product, including but not limited to improper placement of item, outdoor use or neglect, alteration or use in commercial establishments.

For warranty inquiries, you must first contact TRAMONTINA'S Customer Service Department to receive instructions and/or return authorization. In most cases, our Customer Service Department can assist with many operation/use questions, product manuals or trouble shooting tips, and the return of the unit is usually not necessary.

Tramontina reserves the right to repair or provide replacement parts which may have become defective.

This warranty gives you specific legal rights, and you may also have other rights, which vary according to country, state or province.

**Rental exception.** For products used in a rental environment, Tramontina's warranty only covers labor and parts for 90 days. No other warranty applies.

Any question regarding this warranty and/or the use and care of this product should be directed to:

**TRAMONTINA**

**TRAMONTINA USA, Inc.**

**Customer Service**

12955 West Airport Blvd.

Sugar Land, TX 77478-6119

(800) 221-7809

**[www.tramontina-usa.com](http://www.tramontina-usa.com)**

*For faster assistance, please register your product online at [www.tramontina-usa.com](http://www.tramontina-usa.com)*

**MADE IN CHINA**



## Product & Warranty Registration Card

Thank you for purchasing this Tramontina product. We appreciate you taking a few minutes to complete this card and mailing it back to us, or registering online for faster assistance. The information we receive will help us develop new products and services to meet your expectations. Please contact us if you have any comments or questions about our products.  
**(800) 221-7809 | tusa@tramontina-usa.com | www.tramontina-usa.com**

### Model #80901/103 4.6 Cu. Ft. Wine cooler

Name \_\_\_\_\_  Male  Female

Address \_\_\_\_\_

City \_\_\_\_\_ State \_\_\_\_\_ Zip Code \_\_\_\_\_

Phone \_\_\_\_\_ Date of Purchase \_\_\_\_\_

e-mail \_\_\_\_\_

Where did you purchase this product? \_\_\_\_\_

Rate each of the following items in terms of their importance in your decision to buy this product.

(1 Least - 5 Most)

Tramontina Brand  
1 2 3 4 5

Price/Value  
1 2 3 4 5

Quality  
1 2 3 4 5

Design  
1 2 3 4 5

Features  
1 2 3 4 5

Packaging  
1 2 3 4 5

Store Display  
1 2 3 4 5

Recommendation  
1 2 3 4 5

Warranty  
1 2 3 4 5

Which features did you find most important about this product? \_\_\_\_\_

What features would you like to see added to this product? \_\_\_\_\_

**Thank you for registering!**

TRAMONTINA USA, Inc. • 12955 West Airport Blvd. Sugar Land, TX 77478-6119  
(800) 221-7809 • (281) 340-8400 • Fax (281) 340-8410  
[www.tramontina-usa.com](http://www.tramontina-usa.com)

---

---

---

PLEASE PLACE  
STAMP HERE  
POST OFFICE  
WILL NOT MAIL  
WITHOUT POSTAGE

***TRAMONTINA USA, Inc.***

12955 West Airport Blvd.  
Sugar Land, Texas 77478-6119



Fold Here

▼ Use tape to seal card ▼

