

# INSTRUCTION MANUAL

Rev02

PISF1

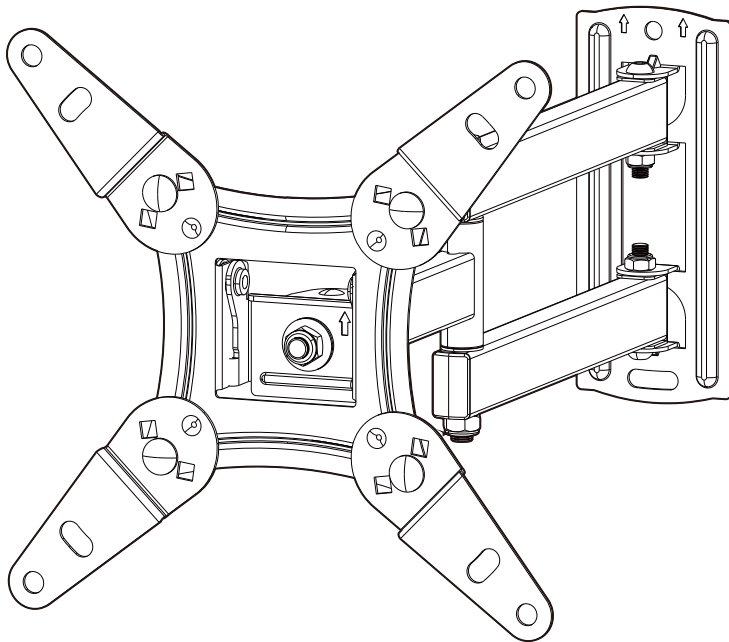

## Full-Motion TV Wall Mount

1-800-556-9829 (US/CA)  
44-808-196-3885 (UK)

✉ [support@pipishell.net](mailto:support@pipishell.net)

 [www.pipishellav.com](http://www.pipishellav.com)

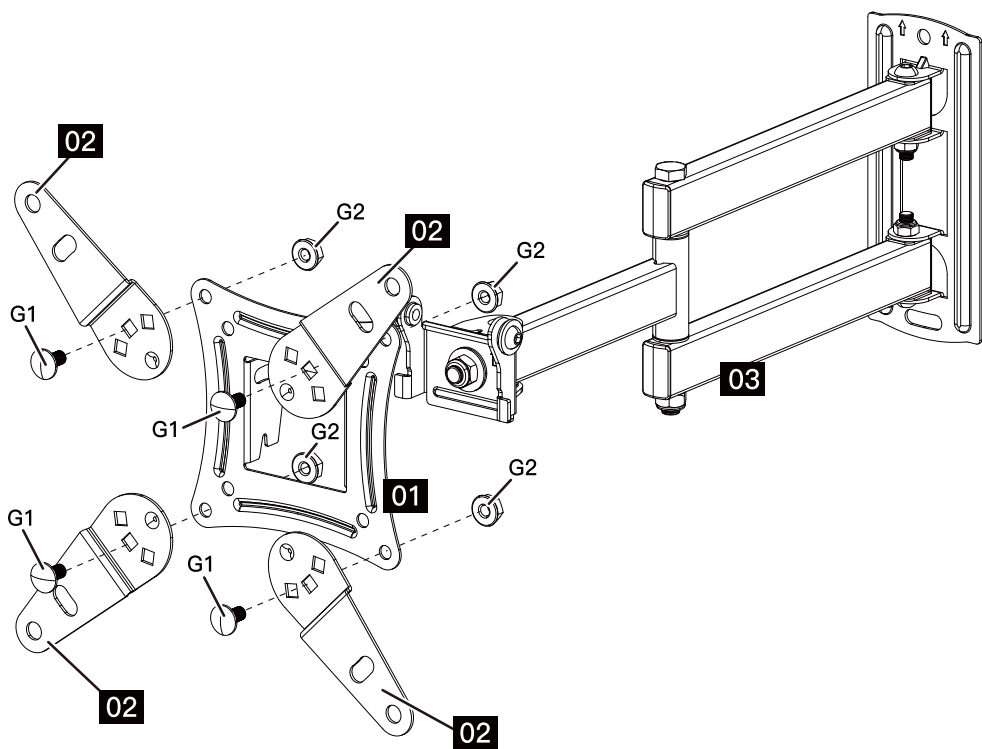

# IMPORTANT SAFETY INFORMATION

## NOTE

- Please carefully read all instructions before attempting installation. If you do not understand the instructions or if you have any questions or concerns, please call technical support or email customer service.
- Before starting assembly, check all parts are included and undamaged. Do not use damaged or defective parts. If you require replacement parts, please call technical support or email customer service.
- Not all hardware included in this package will be used.

## CAUTION

- Avoid the risk of personal injury or property damage!
- Do not use this product for any purpose that is NOT explicitly specified in this manual. Do not exceed the maximum weight capacity. We are not liable for damage or injury caused by incorrect assembly, improper mounting, or inappropriate use.

## WARNING

- This product is designed for use in wood stud, solid concrete, and brick walls. DO NOT install on drywall alone.
- The wall must be capable of supporting four times the weight of the TV and mount combined.
- This product contains small parts that may pose a choking hazard.

### Note for Wood Stud Installation (Page 11 to Page 12)

- Avoid the risk of personal injury or property damage! Tighten the lag screws only until they are pulled firmly against the wall plate (DO NOT overtighten). Do not use a drill; only use a socket wrench.
- Do not use wall anchors for this mounting option. Wall anchors are used for solid concrete, and brick installations only.
- Minimum wood stud size: 1 1/2" (W) x 3 1/2" (D) (38 x 89mm)

### Note for Solid Concrete, or Brick Walls Installation (Page 12 to Page 13)

- Avoid the risk of personal injury or property damage! Tighten the lag screws only until they are pulled firmly against the wall plate (DO NOT overtighten). Do not use a drill; only use a socket wrench.
- Mount the arm assembly / wall plate directly on the concrete surface.
- Minimum solid concrete thickness: 8" (203mm)
- Never drill into the mortar between bricks.

Before getting started, make sure this mount is compatible.

# 1

## VESA Pattern Compatibility

- ☒ 75 x 75mm
- ☒ 100 x 100mm
- ☒ 100 x 200mm
- ☒ 200 x 100mm
- ☒ 200 x 200mm

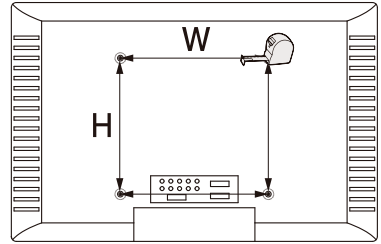

Max: 200 x 200mm (7.9 x 7.9")  
Min: 75 x 75mm (3 x 3")

# 2

If the TV weighs more than 44 lbs (20kg), do not use this product.



# 3

Suitable for use in wood stud, solid concrete or brick walls. DO NOT install on drywall alone.

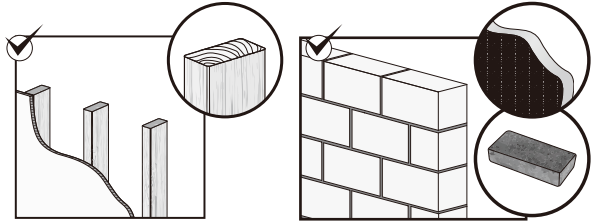

# 4 Tools Needed (Not Included)



Tape Measure

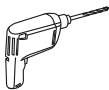

Drill



Pencil



Phillips Screwdriver

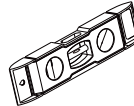

Level



7/16" (11mm)  
Socket Wrench



1/2" (13mm)  
Wrench

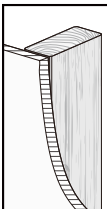

Stud Finder



Awl



5/32" (4mm)  
Wood Drill Bit

For Wood Stud Walls

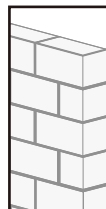

Hammer



3/8" (10mm)  
Concrete Drill Bit

For Solid Concrete or Brick Walls

Supplied Parts and Hardware

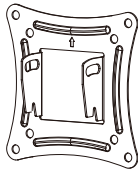

Faceplate  
**01** x 1

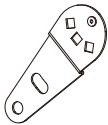

Extender Bracket  
**02** x 4



Bolt  
M6 x 12mm  
**G1** x 4



Nut  
M6  
**G2** x 4

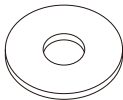

Washer  
M4/M5  
[B1] x 4

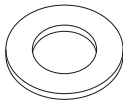

Washer  
M6/M8  
[B2] x 4



Spacer  
L2.5mm  
[F1] x 4

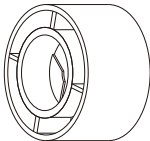

Spacer  
L10mm  
[F2] x 8

M4

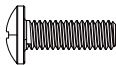

TV Bolt  
M4 x 12mm  
[C1] x 4



TV Bolt  
M4 x 30mm  
[C2] x 4

M6

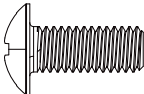

TV Bolt  
M6 x 15mm  
[D1] x 4

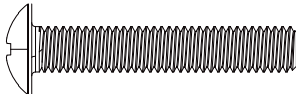

TV Bolt  
M6 x 35mm  
[D2] x 4

M8

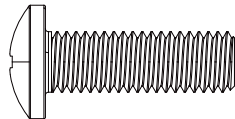

TV Bolt  
M8 x 25mm  
[E1] x 4

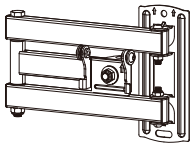

Arm Assembly / Wall Plate  
**03** x 1

ST 1/4 x 2 3/4"  
Lag Screw  
**A1** x 2

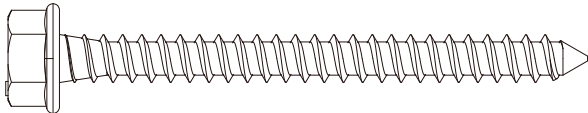

Wall Anchor  
**A2** x 2

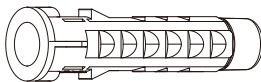

**⚠ CAUTION!**  
This anchor is for concrete or  
brick walls ONLY. DO NOT use  
them in drywall or wood studs.

5/32" (4mm)  
Allen Key  
**H** x 1



Step 1 Secure the Extender Brackets to the Faceplate (Optional)

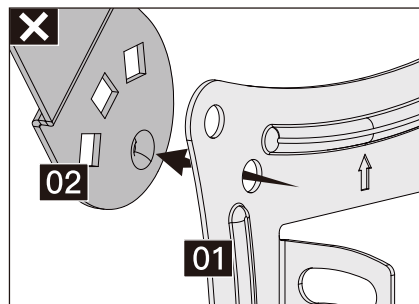
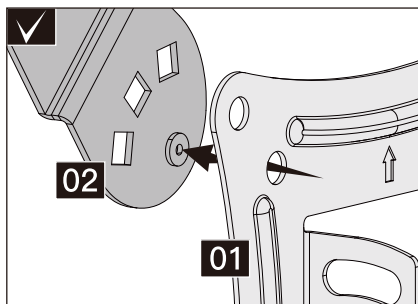
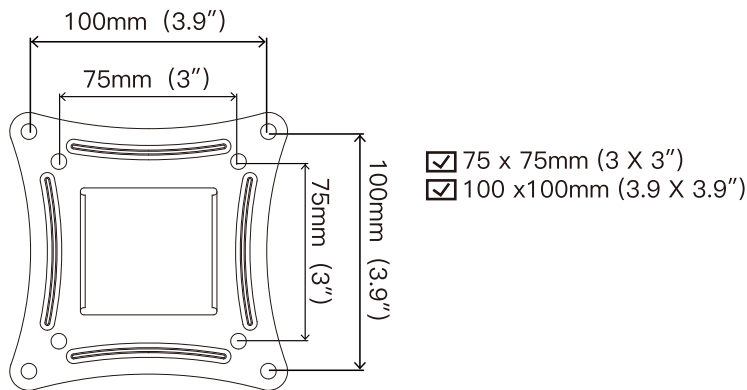

Please DO NOT fully tighten the bolts [G1] and nuts [G2] until Step 2 is finished. The small bump on the extender bracket [02] should be aligned with the hole on the faceplate [01].

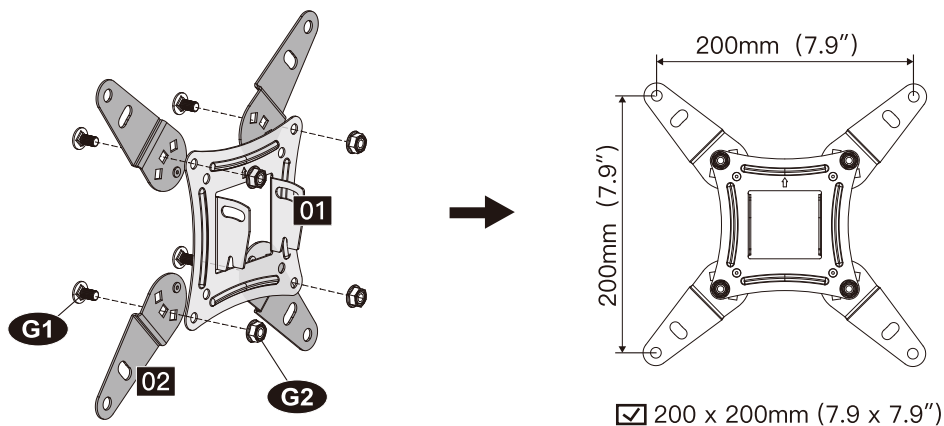

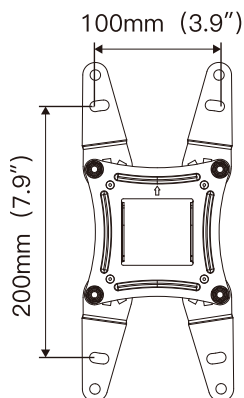
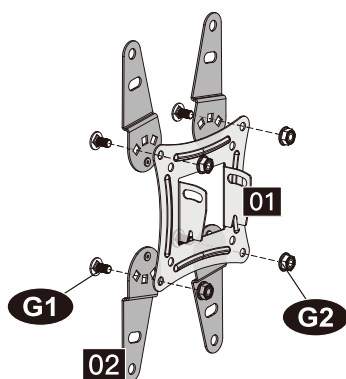

✓ 100 x 200mm (3.9 x 7.9")

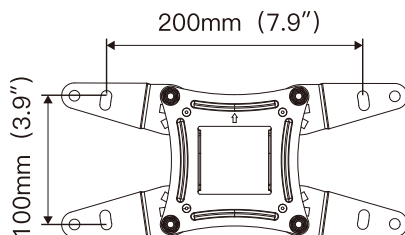
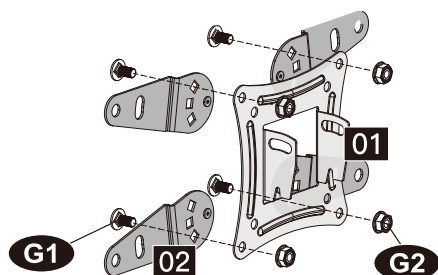

✓ 200 x 100mm (7.9 x 3.9")

## Step 2 Secure the Faceplate with the Extender Brackets to the TV

### 2-1 Select TV Bolts

Hand thread bolts into the threaded inserts on the back of your TV to determine which bolt (M4, M6 or M8) to use. A minimum of 4–5 turns into the threading is required. Do not turn past the bottom of the hole.

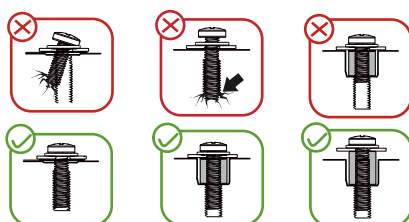
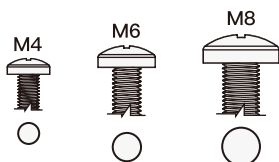
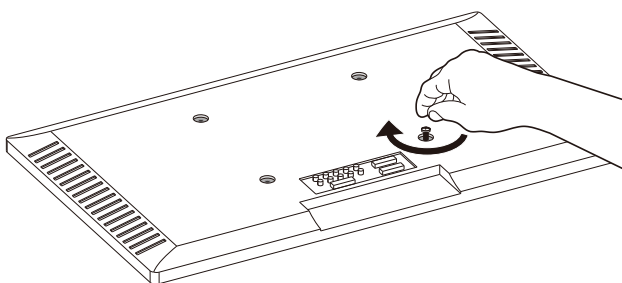

## 2-2 Spacer and Bolt Configurations

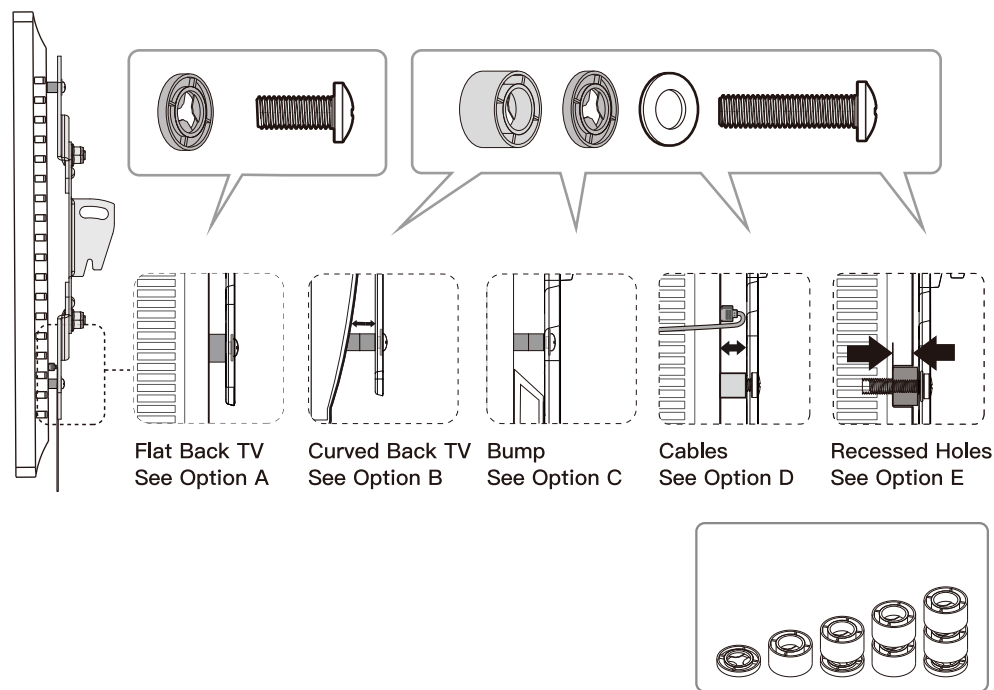

## 2-3 Attach the Faceplate with the Extender Brackets to Your TV

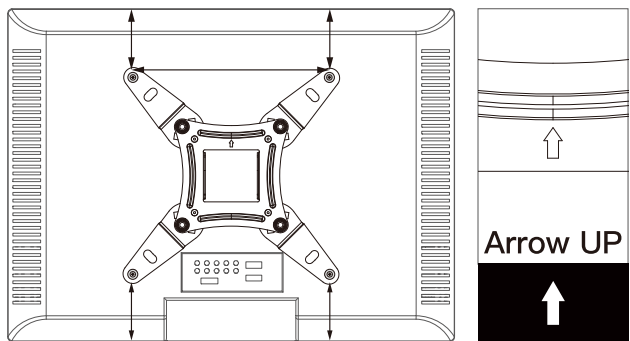



## Option A (For Flat Back TVs)

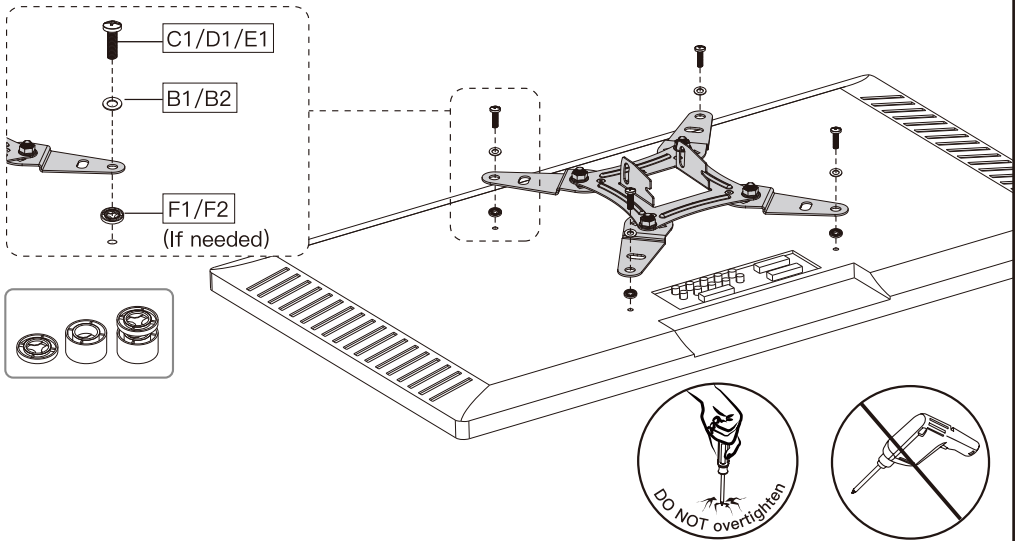

Add spacers if needed to fit the bolt length and TV back.

## Option B (For Curved Back TVs)

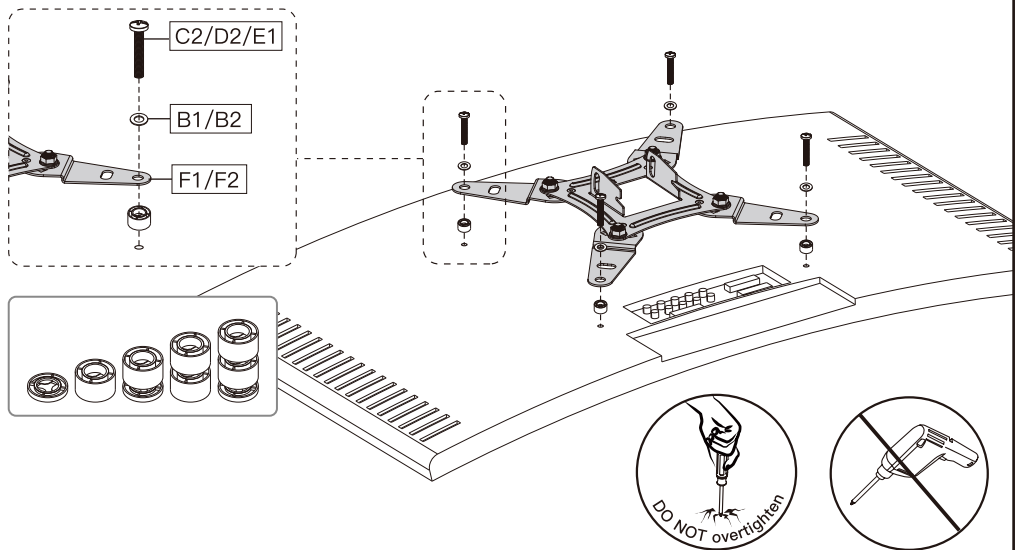

Spacers must be tall enough so that the curved back of the TV does not interfere with the mounting plate.

## Option C (For TVs with a Bump)

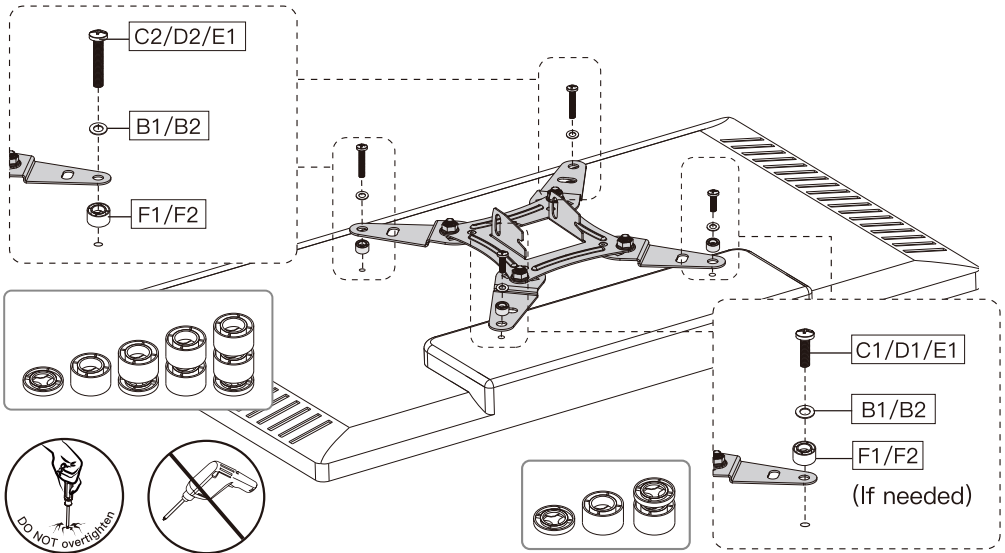

The faceplate must be flush on the bump and leveled by spacers on the gap.

## Option D (For TVs with Protruding Cables)

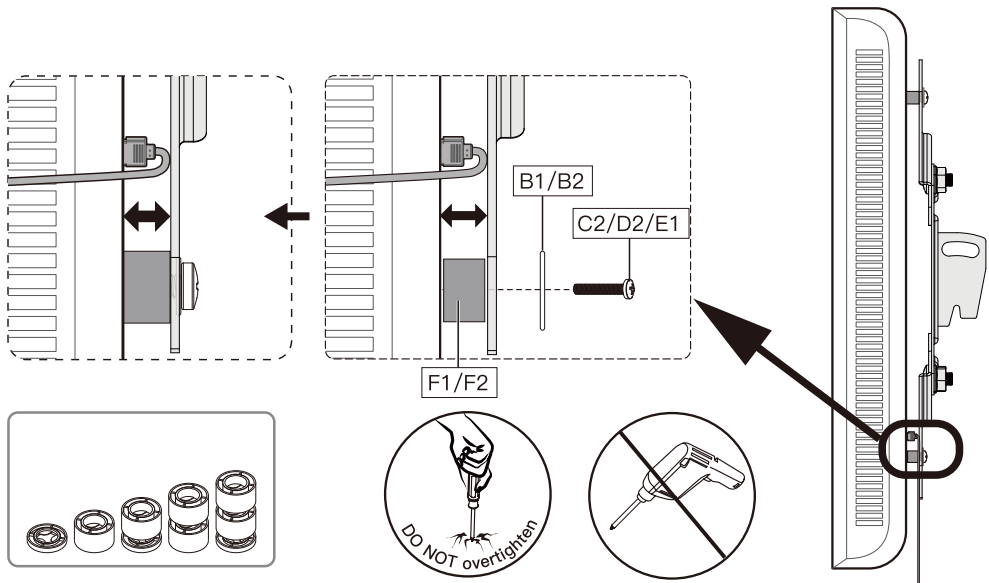

Use spacers to create extra space between the TV and faceplate.

## Option E (For TVs with Recessed Holes)

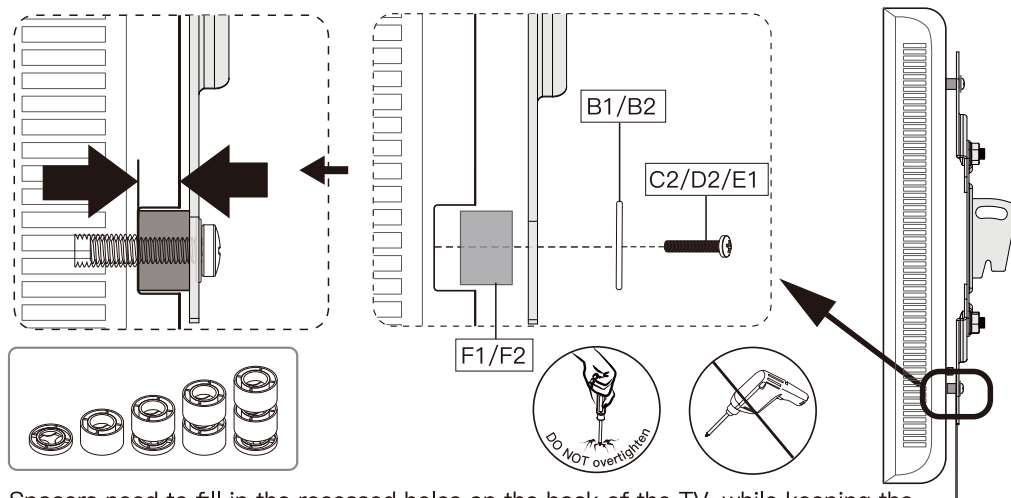

Spacers need to fill in the recessed holes on the back of the TV, while keeping the faceplate as close to the TV as possible.

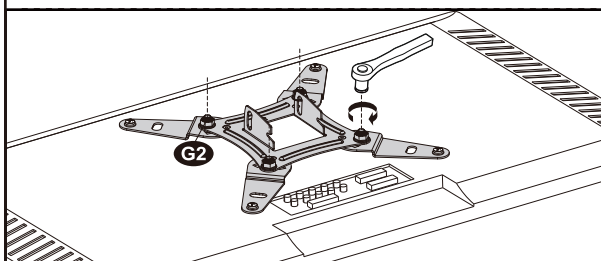

When you finish securing the TV bolts into the TV, remember to tighten nuts [G2].

7/16" (11mm)  
Socket Wrench  
(Not Included)

## Step 3 Mount the Arm Assembly / Wall Plate on the Wall

For Wood Studs, follow Page 11 to Page 12.

For Solid Concrete or Brick Walls, follow Page 12 to Page 13.

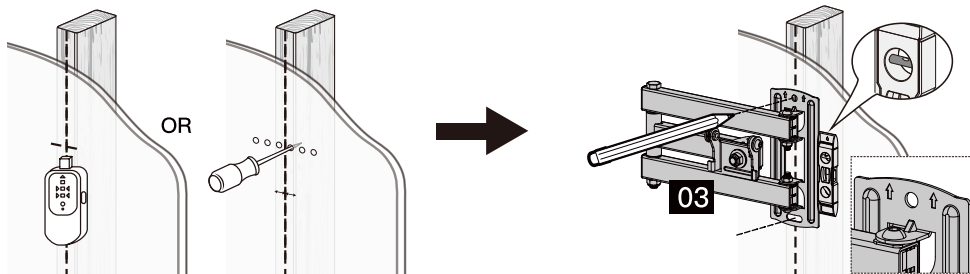
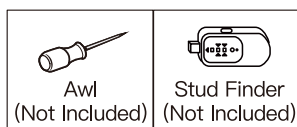

Use a stud finder to locate wood studs, or use an awl to find the edges. Mark the edge and center positions. Position the arm assembly / wall plate [03] at your desired height and line up the holes with your stud centerline. Level the wall plate and mark the holes.

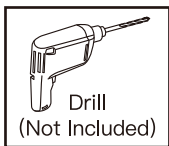

2 3/4" (70mm)

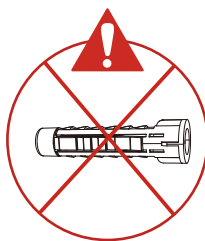
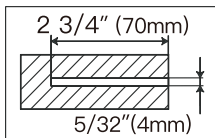
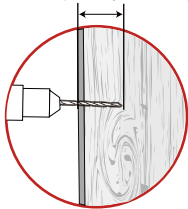

7/16" (11mm)  
Socket Wrench  
(Not Included)

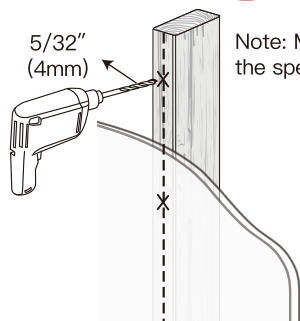

Note: Make sure to use the specified drill bit.

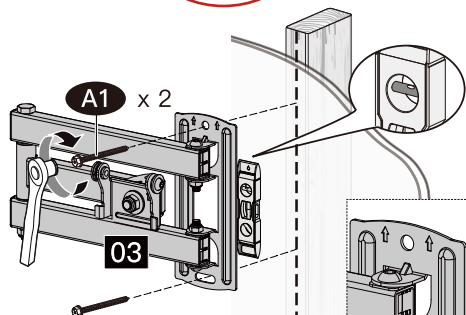

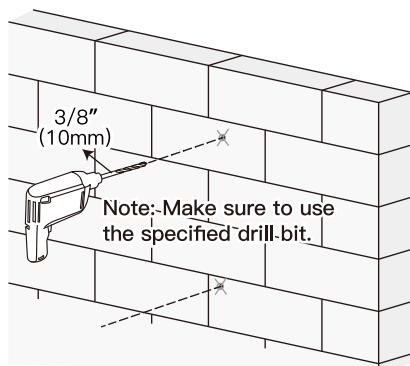
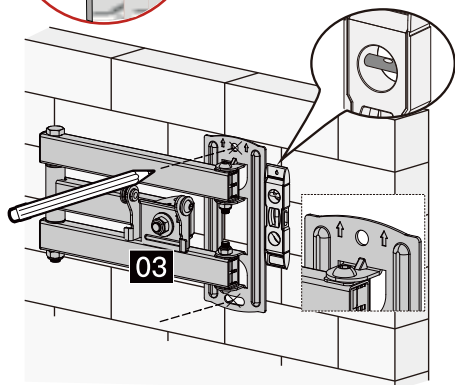
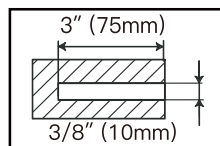
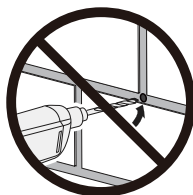
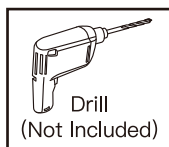
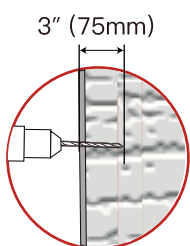

Drill 2 pilot holes using a 5/32" (4mm) diameter drill bit. Make sure the depth is not less than 2 3/4" (70mm). Mount the arm assembly / wall plate [03] on the wall using the lag screws [A1]. Tighten the lag screws only until they are pulled firmly against the wall plate (DO NOT overtighten).

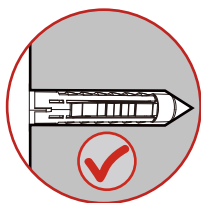

Note: Make sure to use the specified drill-bit.

Position the arm assembly / wall plate [03] at your desired height. Level the wall plate and mark the holes. Drill 2 pilot holes using a 3/8" (10mm) diameter drill bit. Make sure the depth is not less than 3" (75mm). Never drill into the mortar between bricks.



 Hammer (Not Included)	 7/16" (11mm) Socket Wrench (Not Included)
--	--

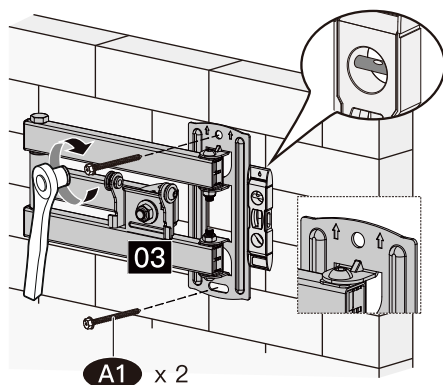
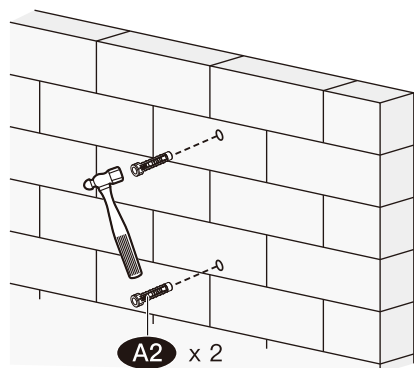

Use a hammer to tap the anchors [A2] into the drilled holes. Ensure the anchors are seated flush with the concrete or brick surface. Mount the arm assembly / wall plate [03] on the wall using the lag screws [A1] and anchors [A2]. Tighten the lag screws only until they are pulled firmly against the wall plate (DO NOT overtighten).

## Step 4 Verify that the Mount is Firmly Mounted

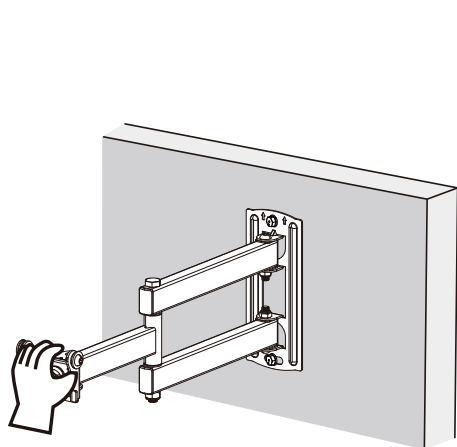

44 lbs  
20kg

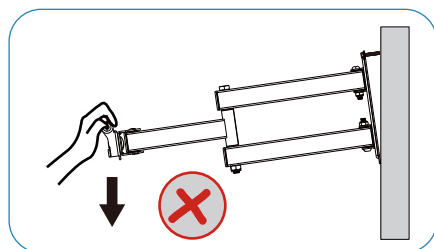
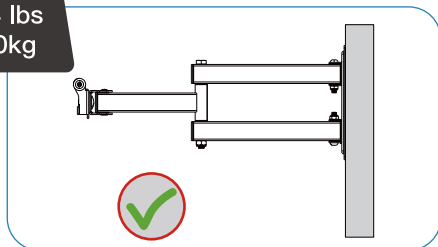

## Step 5 Hang the TV on the Arm Assembly / Wall Plate

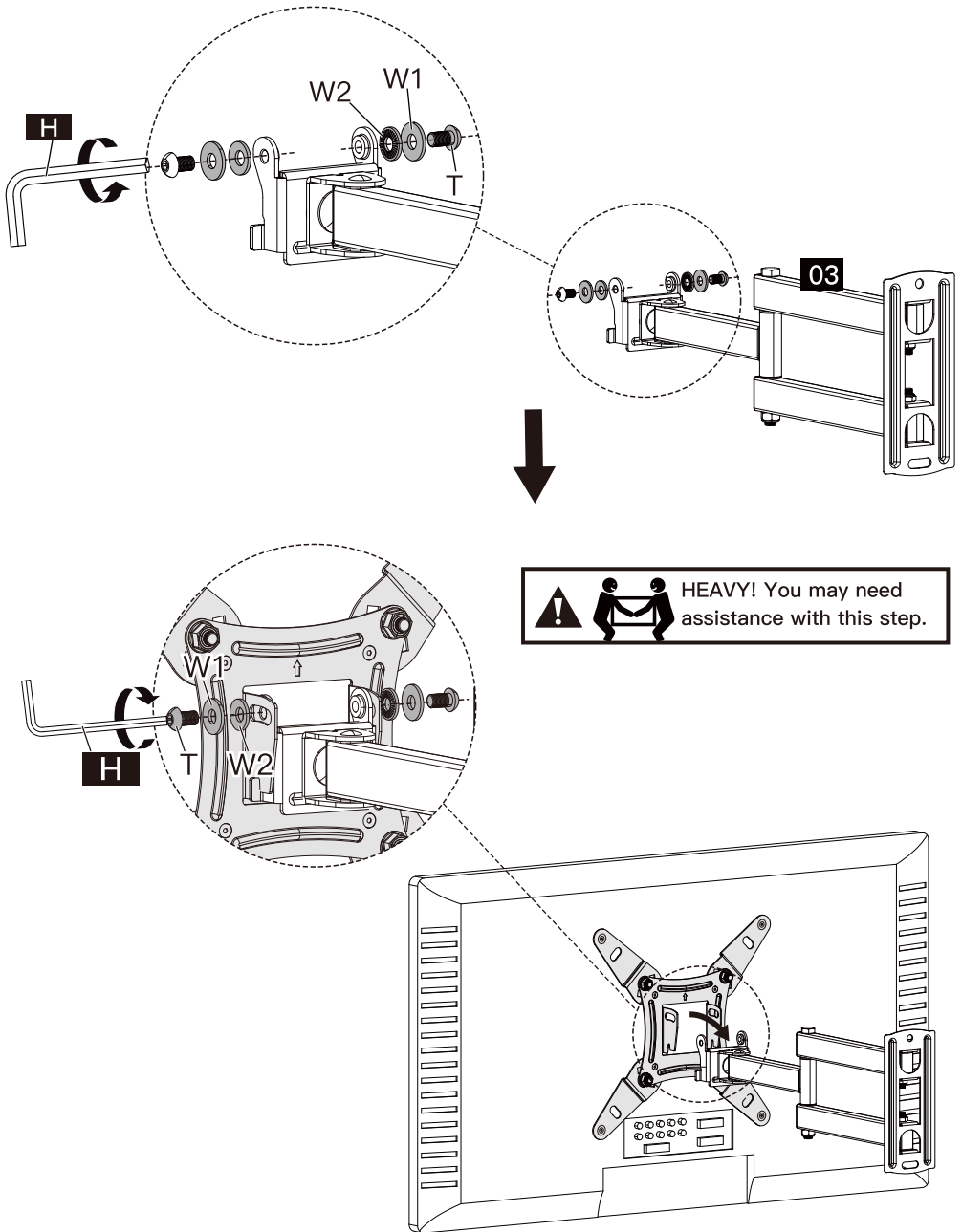

Remove preassembled bolts [T] and washers [W1] and [W2] from the arm assembly. Hang the TV on the arm assembly, then secure the TV in place with the parts removed before.

## Step 6 Adjust the Tilt Angle of the TV

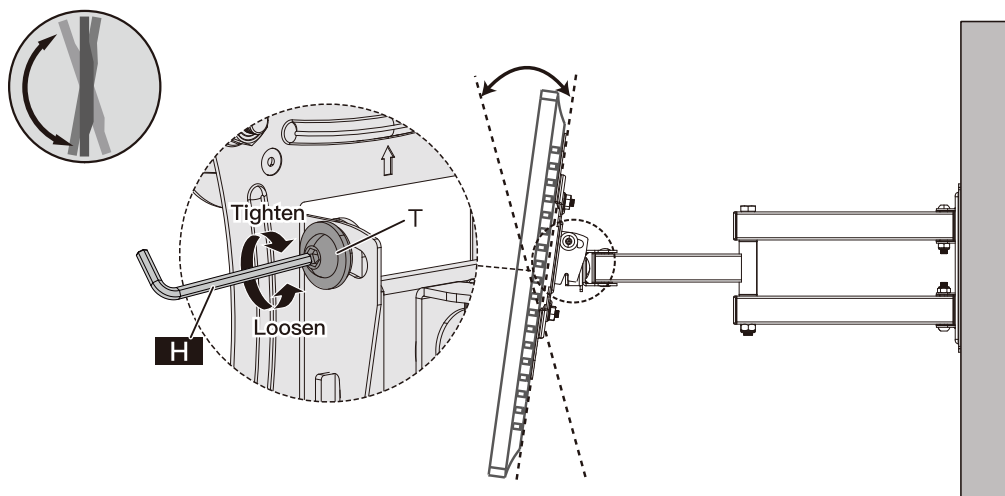

Tilt your TV to the desired angle. You may need to slightly loosen the 2 tilt bolts [T]. Retighten the tilt bolts [T] to lock the tilt angle. DO NOT overloosen or overtighten the bolts.

## Step 7 Level the TV

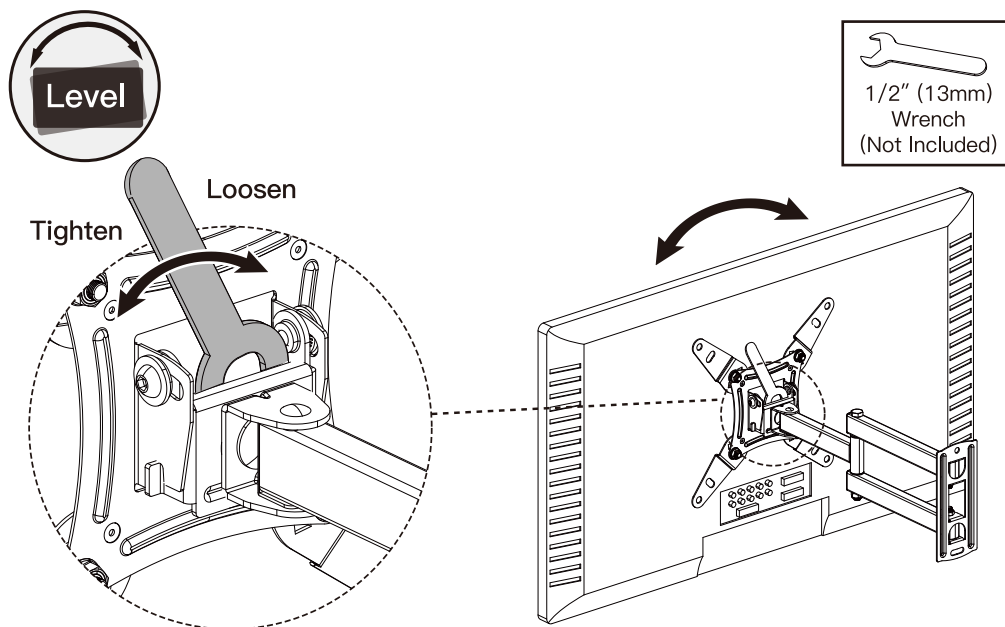

Level your TV using the level (not included). You may need to slightly loosen the preassembled nut. Retighten the nut to hold the TV in position. DO NOT overloosen or overtighten the nut.