

# BASE HITTING NET INSTRUCTIONS

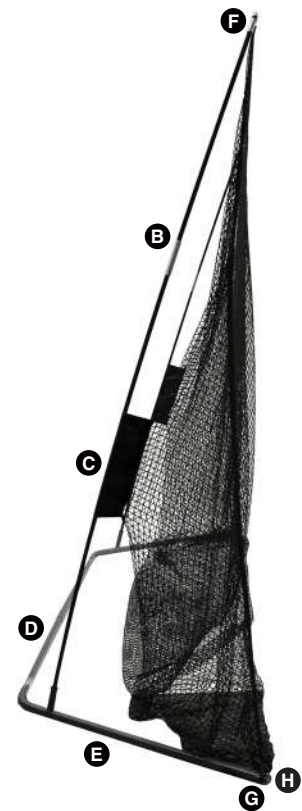

## KEY:

- |                              |                          |
|------------------------------|--------------------------|
| A. Hitting Target            | G. Base Hooks            |
| B. Vertical Frame Poles (2)  | H. Bottom Securing Loops |
| C. Side Securing Sleeves (2) | I. Sewn-In Tabs          |
| D. Straight Base Poles (2)   | J. Black Threaded Cord   |
| E. Angled Base Poles         | K. Spring Loaded Holder  |
| F. Top Securing Loops        | L. Ground Stakes         |

## INCLUDES:



Carry Case

## SETUP INSTRUCTIONS

### STEP 1

Lay hitting net with **Side Securing Sleeves (C)** facing ceiling. The 2 corners with gray strap will become bottom of hitting net.

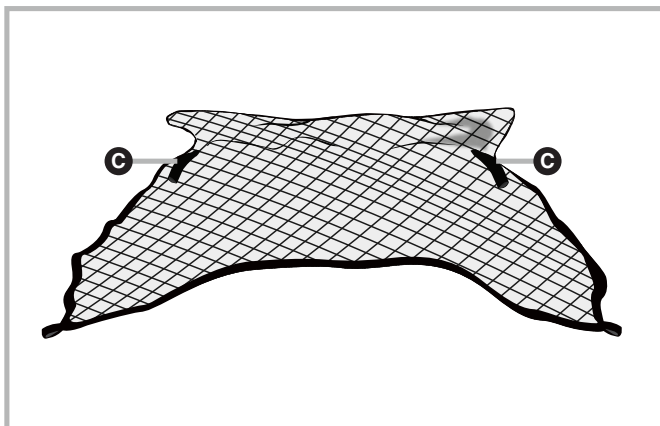

### STEP 2

Connect the 2 **Straight Base Poles (D)** by pushing spring lock button in. Line button up with hole & push until you hear a click. Locate the 2 **Angled Base Poles (E)** & connect to each end of connected straight base poles. The base hooks at the end of each angled base pole indicate the front of net.

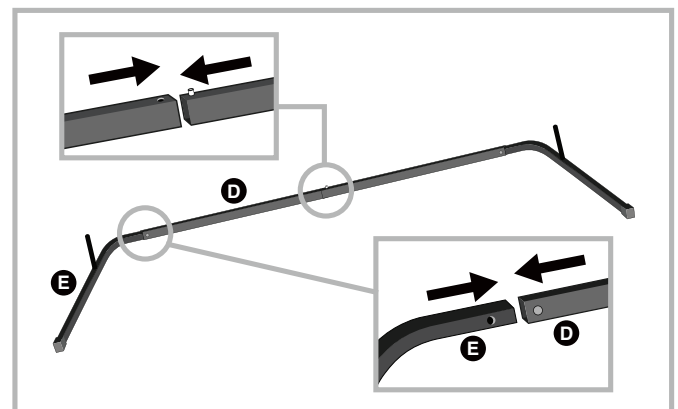

## STEP 3

Connect the **Vertical Frame Poles (B)** & slide through the **Side Securing Sleeve (C)** making sure the silver notched adapter is pointing toward the top of the net. Repeat on the other side.

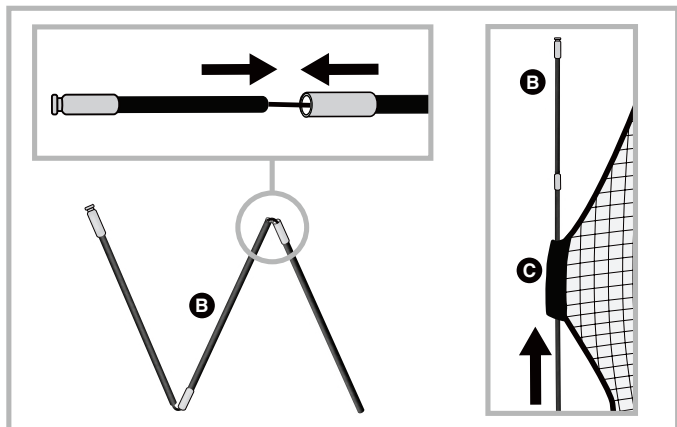

## STEP 4

Connect **Top Securing Loops (F)** at top of net to the silver adapter on the **Vertical Frame Poles (B)**. Repeat on the other side.

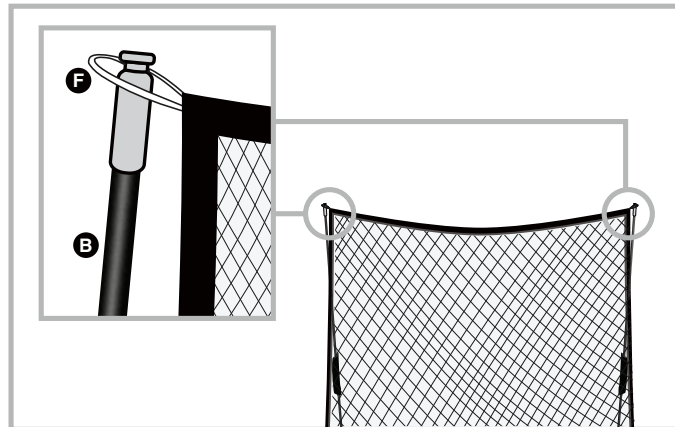

## STEP 5

Secure **Vertical Frame Poles (B)** to base by sliding end into opening on the **Angled Base Poles (E)**. Make sure **Side Securing Sleeve (C)** are facing away from **Base Hooks (G)** located at the end of the **Angled Base Poles (E)**.

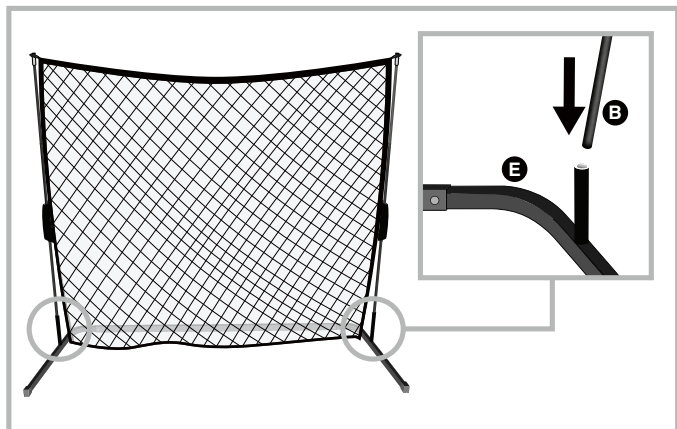

## STEP 6

Locate **Bottom Securing Loops (H)** at bottom corner of net & connect to the **Base Hooks (G)** located at the end of the **Angled Base Poles (E)**. Repeat on other side.

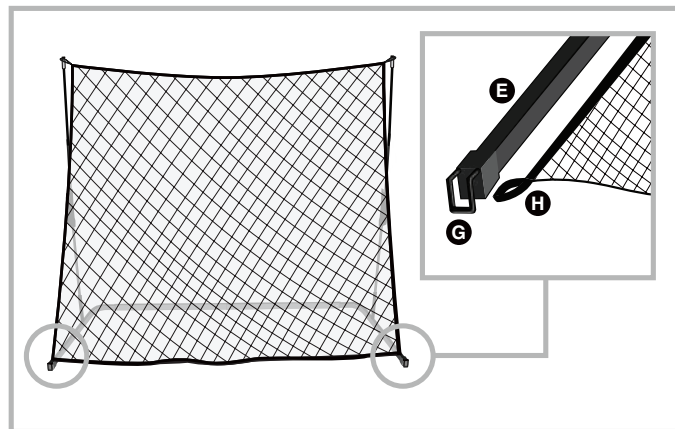

## STEP 7 (FIG. 1)

Attach **Hitting Target (A)** to net by locating the **Sewn-In Tabs (I)** at top of net. Run the **Black Threaded Cord (J)** through the **Sewn-In Tab (I)** on each side of the net. Then loop the **Black Threaded Cord (J)** through the hole in the **Spring Loaded Holder (K)** to create a loop.

## STEP 8 (FIG. 2)

For outdoor use, place "U" shaped **Ground Stakes (L)** around each base pole. Press firmly into ground to secure.

