

GoveeLife

Model: H7151

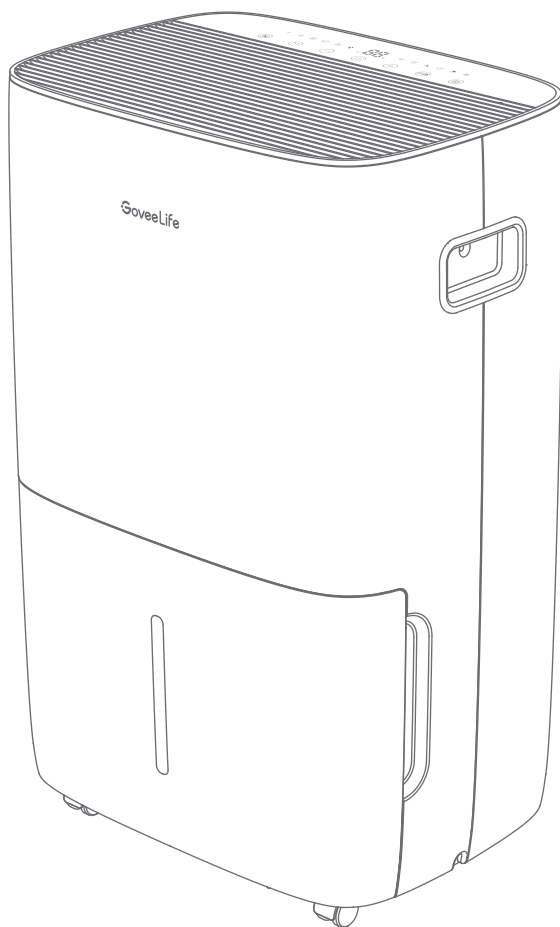

User Manual

GoveeLife Dehumidifier

Contents

READ AND SAVE THESE INSTRUCTIONS	01
Included in the Box	05
Introduction	05
Getting Started	10
Govee Home App	11
Using Your Dehumidifier	12
Care & Maintenance	15
Troubleshooting	16
Appendix	18

GoveeLife Dehumidifier User Manual

READ AND SAVE THESE INSTRUCTIONS

SAFETY WARNINGS

When using the unit, please read the following safety instructions:

- Follow local grid interconnection rules while installing the dehumidifier and ensure that it is properly grounded. If you have any question on electrical installation, follow the instructions of the manufacturer and if necessary, ask a professional electrician to install it.
- Place the machine in a flat and dry place and keep a distance of above 50cm between the machine and the surrounding objects or walls.
- When drainage pipes are installed, ensure that the drainage pipes are properly connected, and are not distorted or bended.
- Keep the air inlet and outlet free from obstructions.
- The appliance shall be installed in accordance with national wiring regulations.
- After the dehumidifier is installed, ensure that the power plug is intact and firmly plugged into the power outlet and place the power cord orderly to prevent someone from being tripped or pulling out the plug.
- Do not put any object into the air inlet and outlet of the dehumidifier.
- Maintenance and repair requiring the assistance of other skilled personnel shall be carried out under the supervision of the person competent in the use of flammable refrigerants.
- All working procedure that affects safety means shall only be carried by competent persons.
- The dehumidifier is only suitable for indoor use, and is not suitable for other applications.
- When moving the machine, make sure that it is in an upright position.
- The machine should stay away from gasoline, flammable gas, stoves and other heat sources.
- Don't disassemble, overhaul and modify the machine arbitrarily, otherwise it will cause a machine malfunction or even bring harm to persons and properties. To avoid danger, if a machine failure occurs ask the manufacturer or professionals to repair it.
- Do not pull the plug to turn off the machine.
- Do not place cups or other objects on the body to prevent water or other liquids from spilling into the dehumidifier.
- Do not use insecticide sprays or other flammable substances near the dehumidifier.
- Do not wipe or wash the dehumidifier with chemical solvents such as gasoline and alcohol. When you need to clean the dehumidifier, you must disconnect the power supply, and clean it with a half-wet softcloth. If the machine is really dirty, scrub with a mild detergent.
- Children shall not play with the appliance. Cleaning and maintenance shall not be made by children without supervision.
- If the supply cord is damaged, it must be replaced by the manufacturer, its service agent or similarly qualified persons in order to avoid a hazard.
- The appliance shall be stored so as to prevent mechanical damage from occurring.

- Plug into a grounded 3 prong outlet.
- Do not use an extension cord.
- Do not remove ground prong.
- Do not use an electrical adapter.
- Unplug the dehumidifier before servicing.

Special Safety Instructions for using flammable refrigerant:

1. Transport of equipment containing flammable refrigerants

- Compliance with the transport regulations

2. Marking of equipment using signs

- Compliance with local regulations

3. Disposal of equipment using flammable refrigerants

- Compliance with national regulations

4. Storage of equipment/appliances

- The storage of equipment should be in accordance with the manufacturer's instructions.

5. Storage of packed (unsold) equipment

- Storage package protection should be constructed such that mechanical damage to the equipment inside the package will not cause a leak of the refrigerant charge.
- The maximum number of pieces of equipment permitted to be stored together will be determined by local regulations.

6. Information on servicing

6.1 Checks to the area

- Prior to beginning work on systems containing flammable refrigerants, safety checks are necessary to ensure that the risk of ignition is minimised. For repair to the refrigerating system, the following precautions shall be completed prior to conducting work on the system.

6.2 Work procedure

- Work shall be undertaken under a controlled procedure so as to minimise the risk of a flammable gas or vapour being present while the work is being performed.

6.3 General work area

- All maintenance staff and others working in the local area shall be instructed on the nature of work being carried out. Work in confined spaces shall be avoided. The area around the workspace shall be sectioned off. Ensure that the conditions within the area have been made safe by control of flammable material.

6.4 Checking for presence of refrigerant

- The area shall be checked with an appropriate refrigerant detector prior to and during work, to ensure the technician is aware of potentially toxic or flammable atmospheres.
- Ensure that the leak detection equipment being used is suitable for use with all applicable refrigerants, i.e. non-sparking, adequately sealed or intrinsically safe.

6.5 Presence of fire extinguisher

- If any hot work is to be conducted on the refrigeration equipment or any associated parts, appropriate fire extinguishing equipment shall be available to hand. Have a dry powder or CO2 fire extinguisher adjacent to the charging area.

6.6 No ignition sources

- No person carrying out work in relation to a refrigeration system which involves exposing any pipe work that contains or has contained flammable refrigerant shall use any sources of ignition in such a manner that it may lead to the risk of fire or explosion.
- All possible ignition sources, including cigarette smoking, should be kept sufficiently far away from the site of installation, repairing, removing and disposal, during which refrigerant can possibly be released to the surrounding space. Prior to work taking place, the area around the equipment is to be surveyed to make sure that there are no flammable hazards or ignition risks. "No Smoking" signs shall be displayed.

6.7 Ventilated area

- In addition, a set of calibrated weighing scales shall be available and in good working order. Hoses shall be complete with leak-free disconnect couplings and in good condition.
- Before using the recovery machine, check that it is in satisfactory working order, has been properly maintained and that any associated electrical components are sealed to prevent ignition in the event of a refrigerant release.
- Consult manufacturer if in doubt.
- The recovered refrigerant shall be returned to the refrigerant supplier in the correct recovery cylinder and the relevant Waste Transfer Note arranged.
- Do not mix refrigerants in recovery units and especially not in cylinders.
- If compressors or compressor oils are to be removed, ensure that they have been evacuated to an acceptable level to make certain that flammable refrigerant does not remain within the lubricant.
- The evacuation process shall be carried out prior to returning the compressor to the suppliers.
- Only electric heating to the compressor body shall be employed to accelerate this process.
- When oil is drained from a system it shall be carried out safely.
- This appliance is not intended for use by persons (including children) with reduced physical sensory or mental capabilities, or lack of experience and knowledge, unless they have been given supervision or instruction concerning use of the appliance by a person responsible for their safety. Children should be supervised to ensure that they do not play with the appliance.

- When moving or relocating the dehumidifier, consult experienced service technicians for disconnection and re-installation of the unit.
- Do not place any other electrical products or household belongings under the unit. Condensation dripping from the unit might get them wet, and may cause damage or malfunction of your property.
- To keep ventilation openings clear of obstruction.
- The appliance shall be stored in a well-ventilated area where the room size corresponds to the room area as specified for operation.
- The appliance shall be stored in a room without continuously operating open flames (for example:an operating gas appliance) and ignition sources(for example operating electric heater).
- Any person who is involved with working on or breaking into a refrigerant circuit should hold a current valid certificate from an industry-accredited assessment authority, which authorise their competence to handle refrigerants safely in accordance with an industry recognised assessment specification.
- Servicing shall only be performed as recommended by the equipment manufacturer.
- Maintenance and repair requiring the assistance of other skilled personnel shall be carried out by the person competent in the use of flammable refrigerants.
- The pipe-work shall be complianced with national gas regulations.
- The maxmum refrigerant charge amount is 0.45kg.
- The installation of pipe-work shall be kept to minimum.

If the refrigerant is flammable the dehumidifier equipment shall have red, Pantone Matching System(PMS)#185 marked service ports,pipes,hoses,and other devices through which the refrigerant is serviced.This colour shall be present at all service ports and where service puncturing or otherwisecreating an opening from the refrigerant circuit to the atmosphere might be expected. (e.g.,process tubes).The colour mark shall extend at least 25 mm(1 inch from the refrigerant servicing point and shall be replaced if removed.

<div data-bbox="115 1123 321 1287">  </div> <div data-bbox="107 1311 330 1406"> <p>Caution, risk of fire Avertissement: risqued'incendie/ matériaux inflammables</p> </div>	<div data-bbox="369 1066 470 1086"> <p>WARNING</p> </div> <div data-bbox="355 1094 991 1246"> <ul style="list-style-type: none"> • Do not use means to accelerate the defrosting process or to clean, other than those recommended by the manufacturer. • The appliance shall be stored in a room without continuously operating ignition sources (for example. open flames, an operating gas appliance or an operating electric heater) • Do not pierce or burn. • Be aware that refrigerants may not contain an odour. </div>
	<div data-bbox="369 1270 546 1291"> <p>AVERTISSEMENT</p> </div> <div data-bbox="355 1299 971 1450"> <ul style="list-style-type: none"> • Ne pas utiliser de produits permettant d'accélérer le dégel ou de produits de nettoyage autres que ceux recommandés par le fabricant. • L'appareil doit etre entrepose dans un endroit sans source dallumage fonctionnant en continu (par exemple: flamme nue, appareil au gaz en marche ou radiateur électrique en marche) • Ne pas percer ni brûler. • Attention: les frigorigenes peuvent etre inodores. </div>

Included in the Box

Item	Quantity
Dehumidifier	1
Drain Hose	1
User Manual	1
Quick Start Guide	1

Introduction

Part Names

- a. Display Panel

b. Touch Control Panel

c. Air Outlet Grille

d. Built-in Handle (Both Sides)

e. Front Panel

f. Bucket Handle (Both Sides)

g. Water Level Window

h. Water Bucket

i. Universal Caster
- j. Air Intake Grille

k. Air Filter (Over the Grille)

l. Drain Outlet Cap

m. Cable Clip

n. Power Cord

o. Power Plug

p. Rear Panel

q. Plug Holder

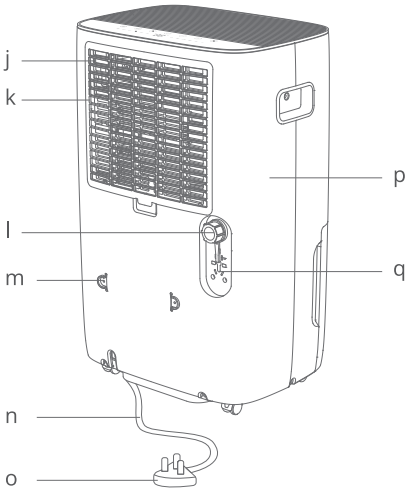
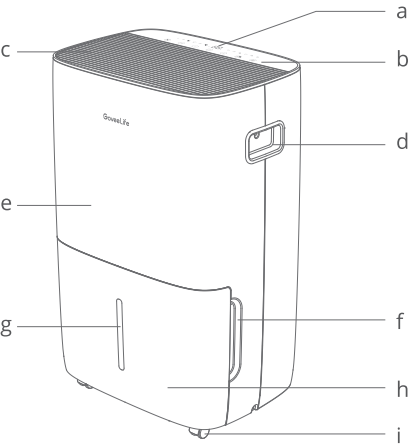

- r. Drain Hose
- s. Continuous Drain Hose Outlet
- t. Internal Drip Tray
- u. Water Tank Cover

- v. Water Tank Handle
- w. Float
- x. Hose Adapter

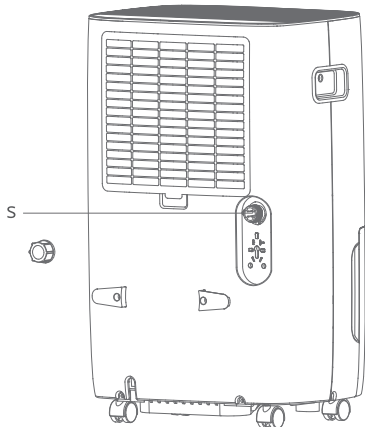
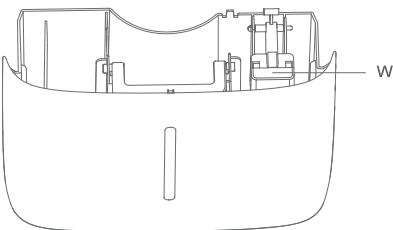
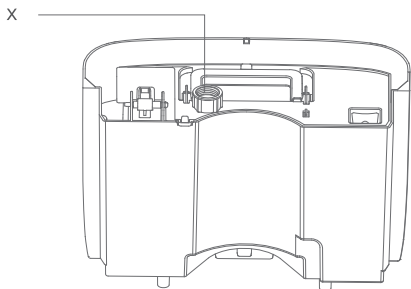
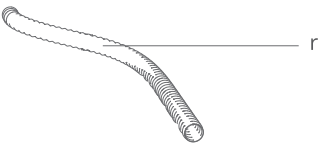
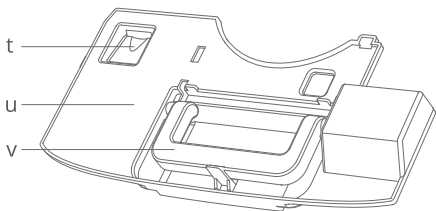

Controls & Functions

You can access additional features using Govee Home App.

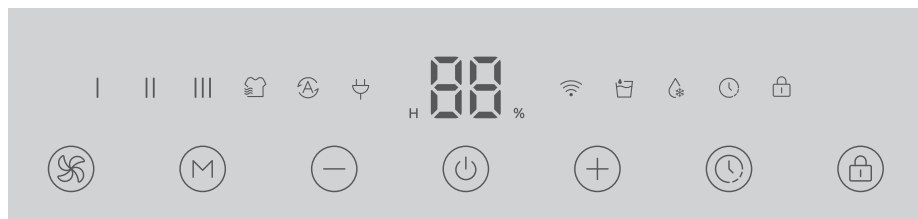

Power Button

Touch to turn the dehumidifier on or off.

Note:

- When powering the dehumidifier on or off, the compressor will respond with a short vibration.
- Follow the in-app instructions to press the power button when pairing with the app.



Speed Button

Touch to cycle through Low (I), Medium (II), High (III) speed. At high speed, the dehumidifier reduces moisture and dampness to a maximum extent. When the humidity has been lowered, switch to low speed to let the dehumidifier run quietly.

Note: In Speed Mode, the dehumidifier continuously reduces the moisture. If you wish to stop dehumidifying when your room humidity reaches the target value, touch the Mode Button to turn on Auto Mode.



Mode Button

Touch to switch between Auto Mode and Laundry Drying Mode.

Auto Mode: The dehumidifier automatically turns on or off and adjusts its speed based on the current humidity. In this mode, touch \oplus or \ominus to increase or decrease the current ambient humidity value displayed on the panel to set your target humidity by 5% within the range between 30% to 80%. After you finish adjusting the target value, wait for 5 seconds for the setting to work.

Note:

- 1.The setting of target humidity only works in Auto Mode.
2. The fans will continue working for 3 more minutes when the target humidity is reached to dry the condensed water inside and prolong the lifespan of the dehumidifier.

Laundry Drying Mode: The dehumidifier continuously operates at high speed with lower running costs compared to a conventional tumble dryer.

Note: In Auto Mode and Laundry Drying Mode, the speed cannot be manually adjusted.



Timer Button

Timer: Touch to set a timer and touch \oplus or \ominus to increase or decrease the time by 1 hour. After you finish setting the time, wait for 5 seconds for the timer to work. Read the countdown by hour on the display panel and check any remaining time on the app.



Touch Lock

Lock: Long press for 3 seconds to turn the touch lock on or off.



Recovery Button

Long press for 5 seconds until all indicators flash once, then the dehumidifier will be restored to factory settings, disconnect from Wi-Fi and Bluetooth, and automatically reboot. This button is for restoring all preset functions if the dehumidifier cannot function properly.

Note: After restoring the dehumidifier to factory settings, go to “My Devices” page on the app to delete this dehumidifier first, otherwise it cannot be added to the app again.

Memory Function

The dehumidifier will save its previous settings when powered off (such as its speed, mode, and Wi-Fi connection). When it is powered back on, the settings will resume.









3-Minute Compressor Operating Protection

After the dehumidifier has stopped, it cannot be restarted to dehumidify in the first 3 minutes in order to protect its compressor and expand its lifespan. It will automatically restart after 3 minutes.

8-Minute Compressor Operating Protection

After 8 hours of continuous dehumidification, the compressor will automatically stop running for 8 minutes without notice. Nothing needs to be done to release this action. After the fans have worked for 8 minutes, the compressor will restart.

Indicator Status

Indicator	Working Status	Light Status
	Powered On	Solid White
I	Continuous Dehumidification at Low Speed	Solid White
II	Continuous Dehumidification at Medium Speed	Solid White
III	Continuous Dehumidification at High Speed	Solid White
	Auto Mode	Solid White
	Laundry Drying Mode	Solid White
	Timer	Solid White
	Locked	Solid White
	Unlock	Dim
	Lock Reminder	Triple Flashes
	Auto Defrost	Solid Red
	Water Bucket is Full	Solid Red
	Full Reminder	Triple Flashes
88 %	Humidity Value	Solid White
H 88	Hour	Solid White
88	Current Value	Solid White
	Last Stage Setting	Slowly Flashes
	Ready for Connecting	Slowly Flashes White
	Connecting	Quickly Flashes White
	Connected	Solid White
	Not Connected	Dim

Note:

1. The bucket indicator will also light up when the bucket is pulled out. You can go to “Device Settings” page to turn on “Full Bucket Alert”, then you will get notifications from the app when the bucket is full of water or is being pulled out.
2. If the dehumidifier detects internal frosting, it will automatically trigger Auto Defrost until there is no frost any more. In Auto Defrost Mode, the dehumidifier will stop dehumidifying.

Getting Started

Before getting started, leave the dehumidifier to stand upright for 24 HOURS so the oil in the compressor can settle from the move since the dehumidifier may have been tilted or placed upside down during shipping, otherwise this will affect the performance or lifespan of the dehumidifier.

1. Place the dehumidifier on a smooth level floor strong enough to support the unit with a full bucket of water.

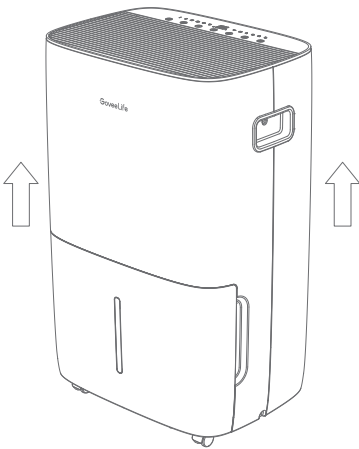

2. Allow at least 8 inches of air space on all sides of the unit for air circulation (at least 16 inches for air outlet). Place the unit away from any clothes dryer, heater or radiator.

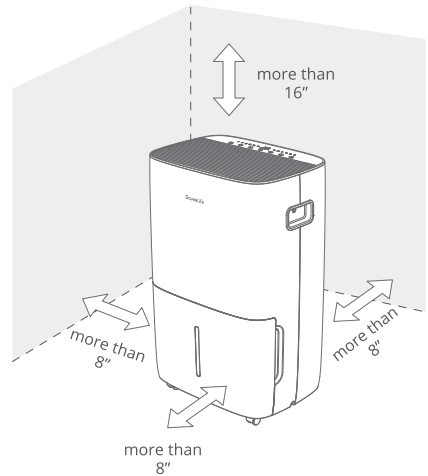

3. Plug the dehumidifier into a 120 V socket. Now your Smart Dehumidifier is ready to use!

Note:

1. Place the dehumidifier in places where the temperature will not fall below 41°F (5°C) since its coil may frost in low temperatures and affect the performance.
2. Close all doors, windows, and other openings to the room when using the dehumidifier so as to achieve the best performance.

Govee Home App

You can access more features using Govee Home App.

Downloading Govee Home App

To download Govee Home App, scan the QR code or search for "Govee" in the Apple App Store® (iOS) or Google Play Store (Android).



Govee Home App



Note:

- Choose "Allow" to the permissions requested when opening Govee Home App for the first time. These permissions allow the app's features to function normally and are not used to record personal, private information.
- Due to ongoing updates, Govee Home App may be slightly different than shown in this manual. In case of any differences, always follow the in-app instructions.

Pairing with Govee Home App

1. Turn on your smartphone's Bluetooth. Connect to your Wi-Fi router's 2.4GHz network. 5GHz is not supported.
2. Android users turn on Location Services; IOS users choose Location ->Always On in the pop-up window while adding devices.

Note:

- For IOS users, if you chose Location->Never, it might result in notifications/alert exceptions. It is recommended to follow Settings ->Govee Home ->Location ->Always On to obtain the best experience.
- Govee Home WILL NOT collect, use, or share your location in any way.

3. Open Govee Home App, tap the "+" icon in the top right corner and search for "H7151."
4. Tap the device icon and follow the in-app instructions to complete the Bluetooth and Wi-Fi connection.

Note:

- Method to turn off Bluetooth and Wi-Fi connection: Press and hold the Power Button and Speed Button for 5s to restore the device to factory settings, then go to "My Devices" page on the app to delete this dehumidifier first, otherwise it cannot be added to the app again.
- You can use Govee Home App to connect your dehumidifier to Amazon Alexa or Google Assistant. Follow the in-app instructions to connect to each voice assistant.
- Govee Home App is being continually updated and its features do expand.

Using Your Dehumidifier

Empty the Bucket

The bucket indicator will light up when the water bucket is full and the dehumidifier will automatically shut down until the bucket has been emptied and secured back in place.

1. When the bucket indicator is on, slowly pull out the bucket. Grip the left and right handles securely, and carefully pull out straight to prevent the water from spilling out. Do not put the bucket on any surface because the bottom of the bucket is uneven, otherwise this may spill the water.

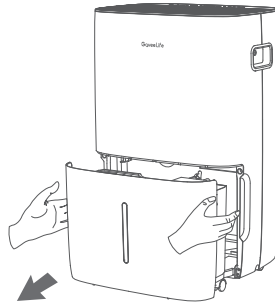

2. Invert the bucket to empty the water.

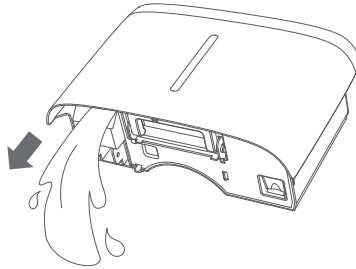

3. The bucket indicator will go out when the bucket is put back in place and the dehumidifier will start working again.

Note:

1. Do not pull the bucket out when it is not full because when the dehumidifier stops working, it will still drip some water, which may wet the floor or cause danger. If you still want to pull it out, wait for several minutes after the dehumidifier is turned off.
2. Do not remove the float from the water bucket, otherwise the water level cannot be properly detected and cause overflow.
3. When putting the water bucket back, ensure that it is properly placed to avoid overflow.

Drying Clothes

Turn on Laundry Drying Mode to dry your clothes faster and efficiently especially during the humid weather seasons.

Step 1: Hang the washed clothes in a small space such as cloakroom, bathroom, or storage room. Keep the dehumidifier away from the water dripping from the washed clothes.

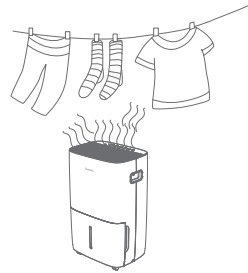

Step 2: Turn on the dehumidifier and choose Laundry Drying Mode, and direct the air outlet towards the clothes.

Note: The drying effect varies from the thickness, the amount of clothes, and the size of the drying space. Theoretically, the effect will be better when clothes are few, thin, and the space is small. The drying process would take 3-8 hours.

Continuous Draining

The included drain hose will automatically empty the water into a floor drain. You can use the included hose or a standard US garden hose.

Using the included hose:

1. Take the hose adapter away from the water tank cover.

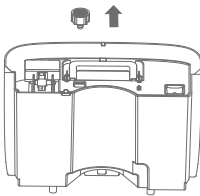

2. Unscrew the cap on the back of the unit to access the hose adapter.

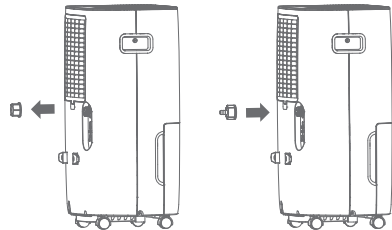

3. Thread the drain hose (included) onto the hose adapter, leading to a floor drain.

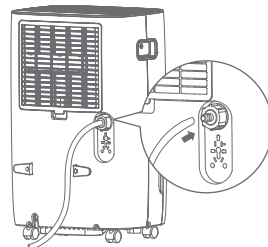

Using the garden hose (not included):

Note: The thread standard of garden hose is GHT or "garden hose thread". The standard size of the thread is 25.4mm.

1. Unscrew the cap on the back of the unit.

2. Fit the garden hose into the continuous drain hose outlet and make sure they are connected firmly.

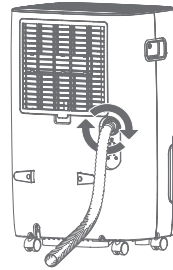
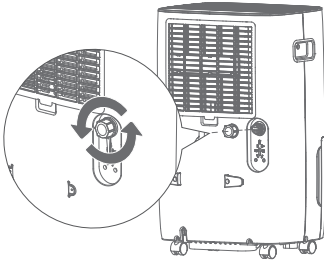

Note:

1. Ensure that the connection is tight and there is no leaking.
2. Lead the water hose to the floor drain or a suitable drainage facility. The drainage facility should be lower than the drain outlet of the dehumidifier.
3. Be sure to run the water hose sloping downward to let the water flow out smoothly. No kinks or bends.
4. If you need to use the hose to drain the condensate water out to an external container, be sure not to submerge the other end of the hose into the water.
5. When the dehumidifier is not continuously draining, remove the hose from the outlet, dry the outlet and screw the drain outlet cap on tightly.
6. It is recommended to use a short hose. If the drain hose is too long, water may not drain completely, which can lead to stagnant water and mildew building up inside the hose.

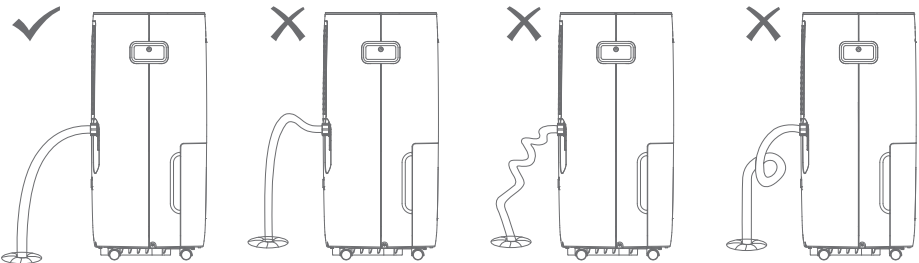

Care & Maintenance

Note: Before cleaning, turn the dehumidifier off and unplug it from power.

Cleaning

1. The Grille and Case

- Use a soft damp cloth to clean. Do not splash water directly into the unit, otherwise this may cause an electrical shock, deteriorate the insulation, or rust the grille or the case.
- Use water and a mild detergent. Do not use bleach or abrasives.
- The air intake and outlet may get dirty during operation, use a vacuum cleaner or a brush to clean.

2. The bucket

- Clean the bucket thoroughly every few weeks to prevent the growth of mold, mildew, and bacteria.
- Fill half of the bucket with clean water and mild detergent, swirl them around, pour out, and rinse the bucket out.

3. The air filter

- Pull the filter outwards to remove it.
- Use a vacuum cleaner to gently suck the dust on the surface of the filter. If the filter is very dirty, wipe it with warm water and a gentle cleaner and dry it completely.
- Insert the filter back into the dehumidifier.

Note: Do not operate the dehumidifier without the filter, otherwise this may reduce the performance and damage the dehumidifier.

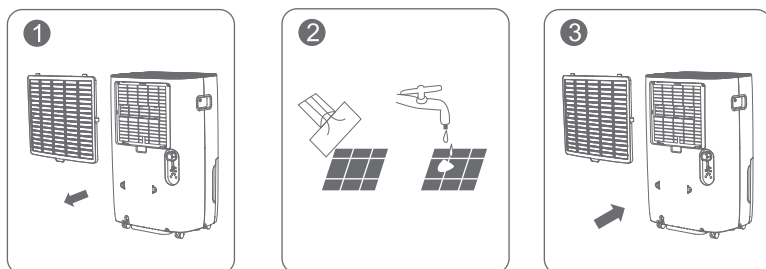

Maintenance

When not using the dehumidifier for a long period of time:

- Let it rest for a whole day to naturally dry out before storing.
- Clean the body, water bucket, and air filter.
- Wrap the cord with the cable clip.
- Put the power plug into the plug holder.
- Cover the dehumidifier with a plastic bag.
- Store it upright in a dry well-ventilated area.

Troubleshooting

The troubleshooting section below is for solving frequently asked questions. If your problem persists, please contact Customer Support.

For Dehumidifier

Problem	Possible Solution & Reason
The dehumidifier does not work.	Check if the power plug is firmly connected into the wall outlet.
	Check the house fuse/circuit breaker box.
	The dehumidifier has reached target temperature in Auto Mode or the water bucket is already full.
	The float in the tank is stuck and is not properly positioned. Push the float down to the lowest position.
The drain hose is leaking water when the dehumidifier is continuously draining.	Water bucket is not in the proper position, put it back in place.
	The drain hose is not connected correctly or the other end of the drain hose is blocked, so the water cannot be appropriately discharged.
Dehumidifier does not dry the air as it should.	Ensure that both ends of the drain hose are unimpeded after connecting the water pipe to the drain outlet. Keeping the drain hose in an inclined state is more conducive to gravity drainage.
	The time is not enough to remove the moisture.
	The ambient humidity is too low, affecting the performance of dehumidifying.
	Make sure there are no curtains, blinds or furniture blocking the top or back of the dehumidifier.
	The dehumidifier is in Auto Mode and its target humidity is higher than the ambient humidity.
	Check if all doors, windows, and other openings are securely closed.
	Room temperature is too low, below 41°F (5°C). Heat up the room.
	There is a water vapor source in the room such as a humidifier.
The dehumidifier makes a loud noise when running.	The air filter is dirty. Clean the air filter.
	The air filter may be dirty. Follow the previous instruction to clean it.
	The dehumidifier is tilted. Put it upright.
	The floor surface is not level.
	Check if the filter is properly positioned.

Frost appears on the coils.	This is a normal phenomenon when the dehumidifier is running at low ambient temperature.
	The dehumidifier will automatically start defrosting, and the whole process may take 15 to 20 minutes. When the dehumidifier completes defrosting, it will automatically restart dehumidifying.
Water on floor.	The hose port may be loose.
	Intended to use the bucket to collect water, but the back drain outlet cover is not in place.
The dehumidifier produces a strange noise when it is turned on.	The refrigerant may not be stable yet. Keep the device working for an hour and observe whether the strange noise has disappeared.

For App & Connectivity

1. Cannot connect to Govee Home App.

- Make sure your smartphone is powered on and is not connected with other Bluetooth devices.
- Enable the smartphone's Location Services.
- Try connecting with another smartphone.
- Make sure your app is updated to the latest version.
- Make sure you connect to your Wi-Fi router's 2.4GHz network and that the network is working correctly.
- Make sure the Wi-Fi password you entered is correct.
- Shorten the distance between the dehumidifier, Wi-Fi router, and the smartphone.
- Make sure your dehumidifier and the Wi-Fi router are located away from appliances that produce electromagnetic radiation (e.g. microwave ovens, refrigerators, etc.)
- If you are using a VPN, try turning it off and then connecting the dehumidifier.
- Disable portal authentication for your Wi-Fi network. If portal authentication is enabled, this dehumidifier will not be able to access your Wi-Fi network and setup will fail. Portal authentication means that you need to sign in to your Wi-Fi network through a web page before you can use the Internet.

2. Cannot find the device on Bluetooth Device Nearby page of the app.

- The dehumidifier may be connected with another smartphone. Disconnect it from the other smartphone first.

3. The dehumidifier is offline.

- Make sure the dehumidifier is plugged in and powered on, then refresh "My Devices" in Govee Home App by swiping down on the screen.
- Make sure your router is connected to the internet and your smartphone's network connection is working.
- If the Wi-Fi password has been changed, the dehumidifier will automatically go offline. Try connecting it to the network again.
- Delete the offline dehumidifier from Govee Home App, then add and reconfigure the dehumidifier again in the app.

Appendix

After-Sales Service

-  Warranty: 12-Month Limited Warranty
-  Support: Lifetime Technical Support
-  Email: support@govee.com
-  Official Website: www.govee.com
-  @Govee  @goveeofficial  @govee.official
-  @GoveeOfficial  @GoveeOfficial

Specifications

Power Source	115V AC 60Hz
Rated Power	525W
Rated Current	4.63A
Total Input Current	7.5A
Operating Conditions	Temperature: 41~95°F (5~35°C)
	Humidity: <95%RH
Noise Level	≤53dB(A)
Moisture Removal (65°F, 60%RH)	49.72 Pints/Day
Moisture Removal (80°F, 60%RH)	66 Pints/Day
Moisture Removal (86°F, 80%RH)	109 Pints/Day
Input Power (65°F, 60%RH)	850W
Input Current (65°F, 60%RH)	7.5A
IEF (65°F, 60%RH)	1.90 liters/kWh
Motor FLA	0.58A
Motor Compressor	RLA: 4.3A LRA: 24.9A
Refrigerant	R32/150g (5.3ozs)
Maximum Allowable Pressure	3.72MPa
Maximum Operating Pressure High	3.72MPa
Maximum Operating Pressure Low	2.07MPa
Unit Dimensions	15.3 X 11.6 X 24.4inch/38.9 X 29.5 X 62.0cm
Unit Weight	39.3 lb / 17.8 kg

Compliance Information

FCC Statement

This device complies with Part 15 of the FCC Rules.

Operation is subject to the following two conditions: (1) this device may not cause harmful interference, and (2) this device must accept any interference received, including interference that may cause undesired operation.

Warning: Any changes or modifications not expressly approved by the party responsible for compliance could void the user's authority to operate the equipment.

Note: This equipment has been tested and found to comply with the limits for a Class B digital device, pursuant to Part 15 of the FCC Rules. These limits are designed to provide reasonable protection against harmful interference in a residential installation.

This equipment generates uses and can radiate radio frequency energy and, if not installed and used in accordance with the instructions, may cause harmful interference to radio communications. However, there is no guarantee that interference will not occur in a particular installation. If this equipment does cause harmful interference to radio or television reception, which can be determined by turning the equipment off and on, the user is encouraged to try to correct the interference by one or more of the following measures:

- (1) Reorient or relocate the receiving antenna.
- (2) Increase the separation between the equipment and receiver.
- (3) Connect the equipment into an outlet on a circuit different from that to which the receiver is connected.
- (4) Consult the dealer or an experienced radio/TV technician for help.

FCC Radio Frequency Exposure Statement

The device has been evaluated to meet general RF exposure requirements. The device can be used in fixed/mobile exposure condition. The min separation distance is 20cm.

The following importer is the responsible party

Name: GOVEE MOMENTS (US) TRADING LIMITED

Address: 2501 Chatham Rd Suite R Springfield IL 62704

Email: support@govee.com

Contact information: <https://www.govee.com/support>



FOR INDOOR USE ONLY

The Bluetooth® word mark and logos are registered trademarks owned by Bluetooth SIG, Inc. and any use of such marks by Shenzhen Qianyan Technology LTD is under license.

The trademark GoveeLife has been authorised to Shenzhen Qianyan Technology LTD.
Copyright ©2021 Shenzhen Qianyan Technology LTD. All Rights Reserved.



Govee Home App

For FAQs and more information,
please visit: www.govee.com