

# HAND BLENDER SET

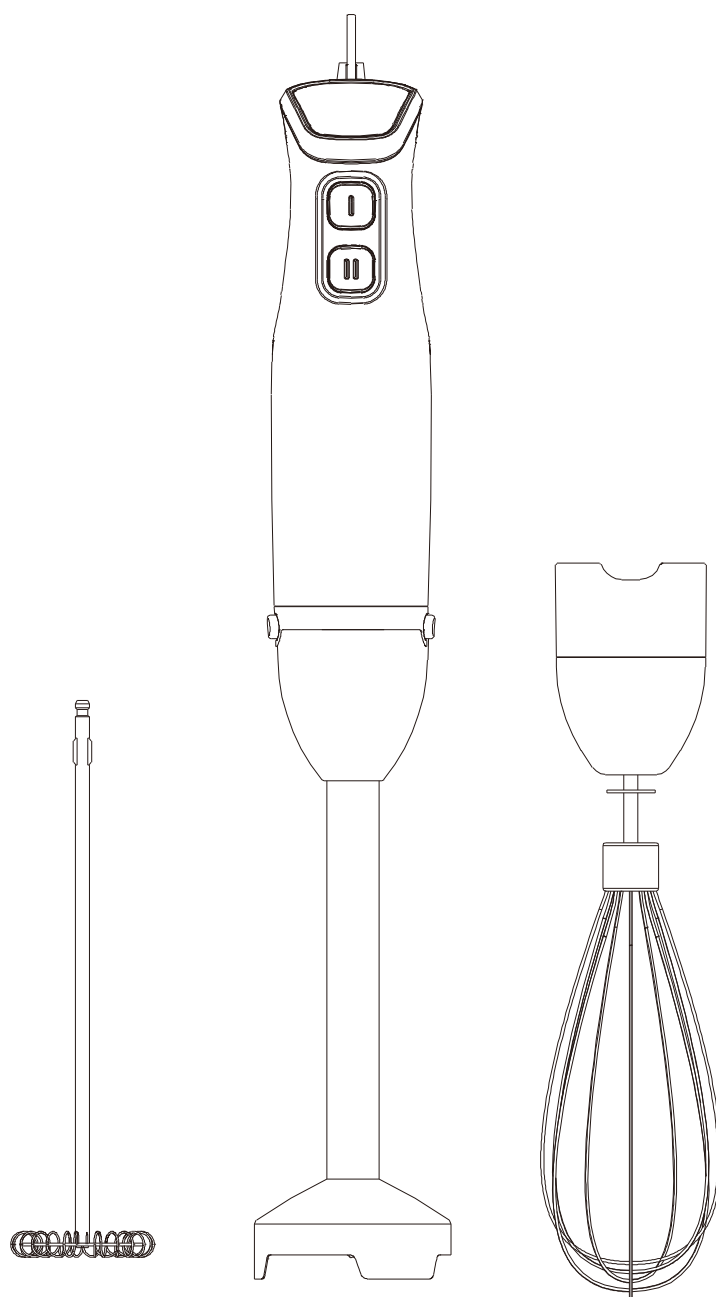

Please read the instruction manual carefully before using it and keep it properly!

**IMPORTANT SAFEGUARDS AND CAUTIONARY INFORMATION**  
**SAVE THESE INSTRUCTIONS**  
FOR HOUSEHOLD USE ONLY

**When using electrical appliance, basic safety precautions should always be used, including the following:**

- Caution! To avoid the risk of electric shock, never immerse the cord, plug, or power base in water or other liquids.
- The use of attachments not recommended or sold by the manufacture may cause fire, electric shock, or injury.
- Unplug the appliance when it is not use. Make sure the appliance is unplugged before assembling, disassembling, adding additional parts, and cleaning.
- Do not pull, twist, or mistreat the power cord.
- Do not let the cord hang over the edge of the counter or table.
- Do not let cord to contact hot surfaces, including stove.
- Periodically inspect the cord and plug for damage. Do not operate any appliance with a damaged cord or plug. If the appliance malfunctions, or is dropped or damaged in any manner, discontinue use. Contact customer service for assistance in obtaining a replacement.
- Avoid contact with moving parts.
- Keep hands and utensils away from the cutting blade while chopping or blending food to reduce the risk of severe personal injury or damage to the device.
- Never allow the motor to run for more than one minute at a time, as it can cause permanent damage to the motor and other parts. If the motor stops working, unplug the Power base and wait for twenty minutes to let it cool down before attempting to use it again. Your appliance has an internal thermal breaker that shuts off the unit when it overheats. The Power Base will reset when the unit is unplugged and the thermal breaker cools down.
- To reduce the risk of injury, make sure the blade is securely screwed onto the container before connecting with the Power Base and operating the appliance.
- Never leave the appliance unattended while it is in use.
- Close supervision is necessary when any appliance is used by or near children.
- Do not use the appliance outdoors if exposed to inclement weather elements such as rain or in wet conditions.
- Blades are sharp. Handle carefully when removing, inserting, or cleaning them.
- Check gasket to make sure it is completely seated in the cross blade unit before each use.
- The appliance is not intended for use in the microwave. Do not place the power base or accessories in the microwave as this may result in damage to the appliance.
- Never blend carbonated beverages. Built-up pressure from released gases can cause burst of container, resulting in possible injury.
- Do not blend the hot liquids in any of the blending vessels.
- Do not run the appliance when the containers are empty.

**FOR YOU SAFETY, CAREFULLY READ ALL INSTRUCTIONS BEFORE OPERATING YOUR APPLIANCE.**

## PARTS LIST

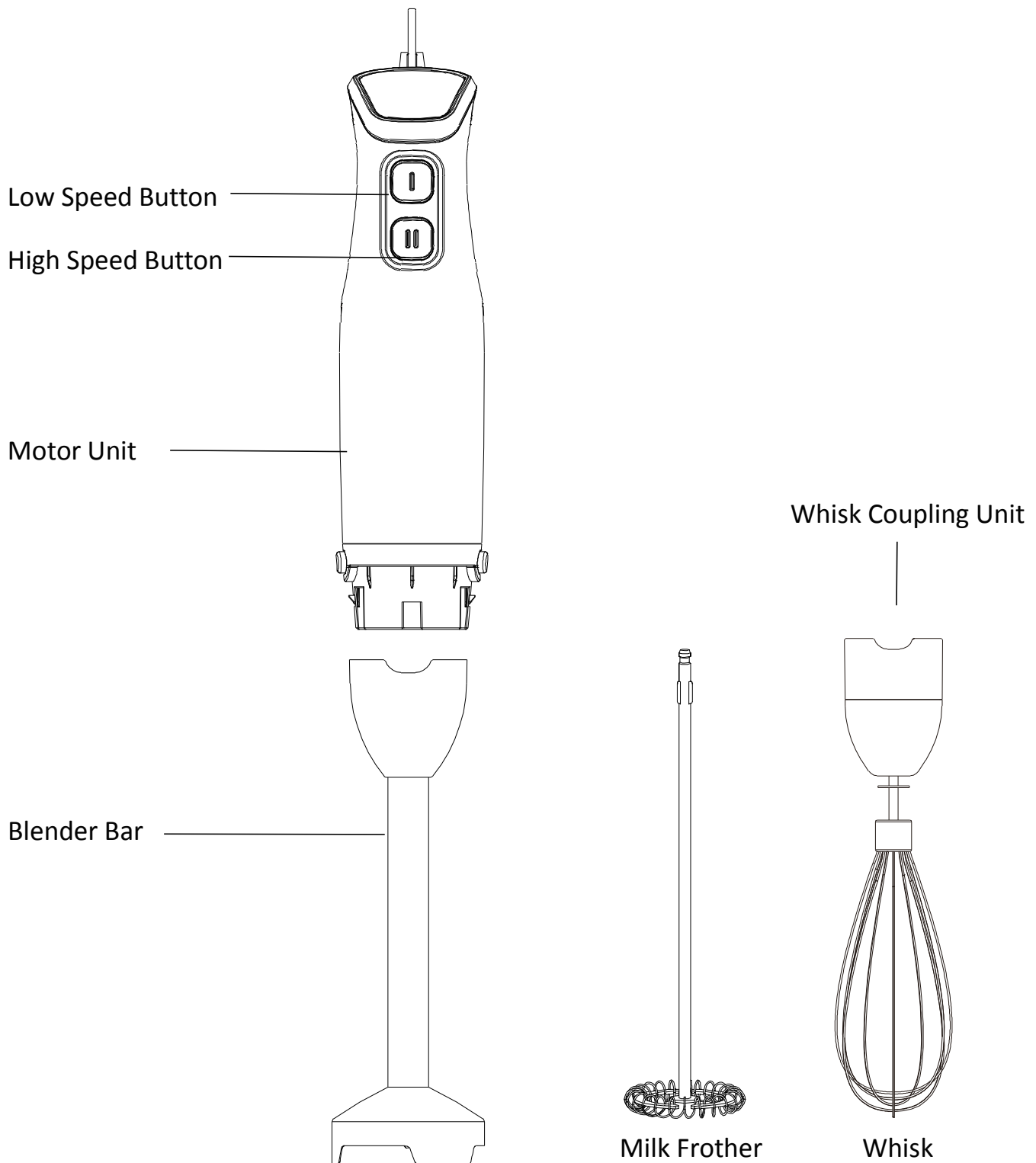

## SPECIFICATIONS

Model No.	<b>HB836BC</b>	Voltage	<b>120V, 60Hz</b>
Protection against electric shock		<b>Type II</b>	

## ATTENTION:

- The product cannot process the very hard food, e.g., crude drugs, kneading dough.
- According to the food you wish to process, select the most suitable attachment and insert it into the motor body.

## Using the appliance:

### 1. Hand blender

The hand blender is intended for:

- Blending liquids, e.g. dairy products, sauces, fruit juices, soups, mixed drinks and shakes.
- Mixing soft ingredients.

### How to Use

1. Insert the blender bar into the motor body so that it can snap into the motor unit.
  2. Immerse the blade guard completely in the ingredients.
- NOTE: Do not let any liquid contact with the Motor Body .**
3. Press and hold the low or high speed button to start. Move the appliance slowly up and down and in circles to blend the ingredients.
  4. To turn the hand blender OFF, release the speed button. The motor will stop.
  5. Unplug the unit after use.

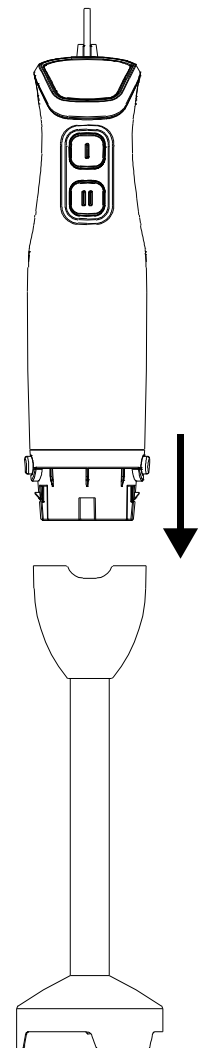

**IMPORTANT:** Make sure it does not exceed 600ml. Do not hold the speed button longer than 30 seconds at a time. Please take half an hour to let it cool down after 5 times continuous working.

## 2. Whisk

The whisk is intended for:

-Whipping cream, whisking egg whites, desserts etc.

### How to Use

1. Insert the whisk into the whisk coupling unit.
2. Insert the coupling unit into the motor body to snap into the motor body.
3. Put the ingredients in a large and deep bowl. Immerse the whisk completely in the ingredients.

**NOTE: Do not let any liquid contact with the Motor Body .**

4. Press and hold the speed button to start. Move the appliance slowly in circles to whisk.

NOTE: To avoid splashing, start processing at low speed.

5. To turn the whisk OFF, release the speed button. The motor will stop.
6. Unplug the unit after use.

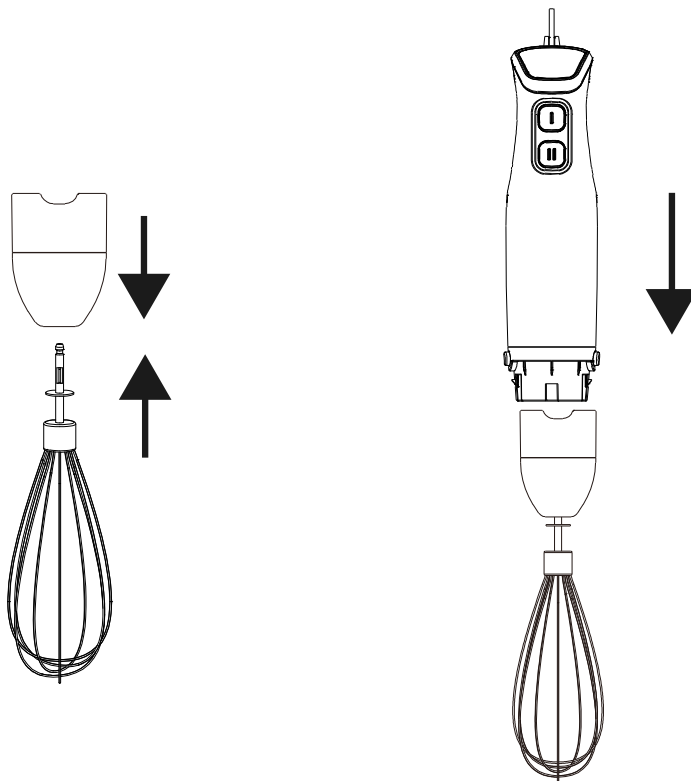

**IMPORTANT: Do not hold the speed button longer than 60 seconds at a time. Please take half an hour to let it cool down after 5 times continuous working.**

### 3. Milk Frother

The milk frother is intended for:

-Making delicate and rich milk bubbles.

#### How to Use

1. Insert the milk frother into the whisk coupling unit.
2. Insert the coupling unit into the motor body to snap into the motor body.
3. Pour the milk about 35g into a measuring cup with a diameter of 90 \* 160 or a 600ml mixing cup. (Hot milk about 50 degrees is easier to make fine milk bubbles.)
4. Immerse the milk bubbler into the milk.

**NOTE: Do not let any liquid contact with the Motor Body .**

5. Press and hold the high speed button to start. Rotate the milk bubbler back and forth according to the rotation direction. Stir continuously for no more than 1 minute, fine and rich milk bubbles will be made.
6. To turn the milk frother OFF, release the speed button. The motor will stop.
7. Unplug the unit after use.

**IMPORTANT:** Do not hold the speed button longer than 60 seconds at a time. Please take half an hour to let it cool down after 5 times continuous working.

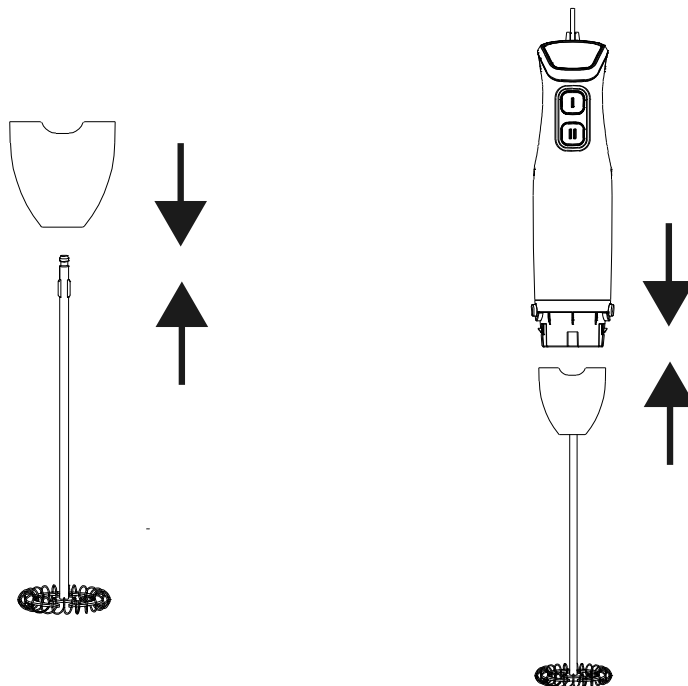

**IMPORTANT:** Do not hold the speed button longer than 60 seconds at a time. Please take half an hour to let it cool down after 5 times continuous working.

## CLEAN AND MAINTAIN

- Always unplug and disassemble the attachments before cleaning.
- To clean the motor base, always use a dry cloth to wipe it; never flush or dip it in water.
- You can clean the accessories in water.
- Always unplug the product when not in use.
- Store the product disassembled and clean in a dry place, away from the reach of children.

**Do not immerse the motor body in water.**



**CAUTION: The cutting edges of the blades are very sharp.  
Take extra care when cleaning it.**

## Environment

- Do not dispose of electrical appliances as unsorted municipal waste, use separate collection facilities.
- Contact your local government for information regarding the collection systems available. If electrical appliances are disposed of in landfills or dumps, hazardous substances can leak into the groundwater and get into the food chain, damaging your health and well-being.



## We'd love to hear from you !

Thank you for purchasing our SANGCON product. Hope you will be pleased with both the product and service you received, and your praise and encouragement are greatly appreciated.

If you have any questions about your product, please use the Amazon Buyer-Seller Messaging Service and we will be at your service within 24 hours.

**Never stop to provide you better products and service.**

Ningbo Kajafa Electric Appliance Co., Ltd  
Add: No.53, North 1 Ring Road, Zhangqi  
Town, Cixi City, Zhejiang Province, China  
**Post-sale service: [Service@Sangcon.com](mailto:Service@Sangcon.com)**