

||DYLLIS™

ITEMS #617641, #611779

**5.0 / 7.1 CU. FT.
CHEST FREEZER**

MODELS #IF50CM23NW, #IF71CM33NW

Français p. 17

Español p. 33

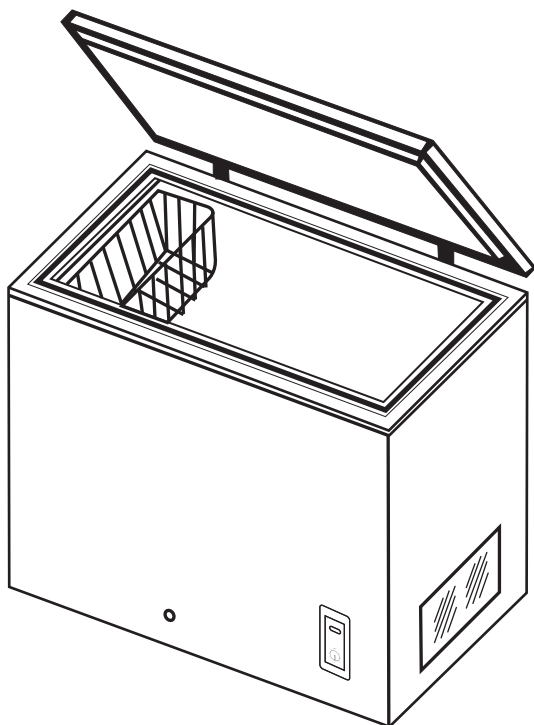

ATTACH YOUR RECEIPT HERE

Serial Number _____ Purchase Date _____



Questions, problems, missing parts? Before returning to your retailer, call our customer service department at 1-877-337-3639, 8 AM EST to 8 PM EST 7 days a week.



0070513414

www.lowes.com

||DYLLIS®

TABLE OF CONTENTS

Package Contents3

Safety Information4

Installation Instructions7

Operating Instructions9

Care and Maintenance..... 12

Troubleshooting 14

Warranty..... 16

PACKAGE CONTENTS

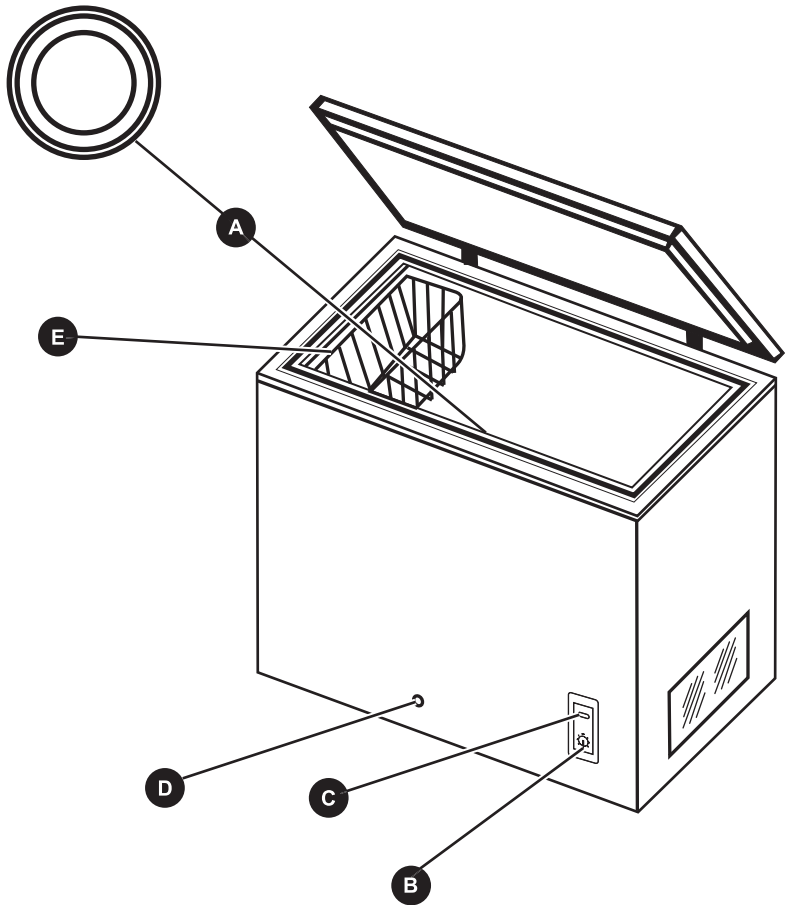

PART	DESCRIPTION
A	Interior Drain Plug (see Insert)
B	Temperature Control Adjustment
C	Power-On Indicator (green switch) (NOTE: This indicator light is only active on the IF71CM33NW)
D	Exterior Drain Plug
E	Wire Basket (To order additional baskets call 877-337-3639 and provide part #0070104494)

IMPORTANT SAFETY INSTRUCTIONS

⚠ WARNING To reduce the risk of fire, electrical shock, injury to persons, or damage when using the freezer follow basic precautions, including the following:

- This freezer must be properly installed and located in accordance with the Installation Instructions before it is used.
- Unplug the freezer before making repairs or cleaning.
NOTE: Power to the freezer cannot be disconnected by any setting on the control panel.
NOTE: Repairs must be performed by a qualified Service Professional.
- Replace all parts and panels before operating.
- Do not store or use gasoline or other flammable vapors and liquids in the vicinity of this or any other appliance.
- Do not store explosive substances such as aerosol cans with a flammable propellant in this appliance.
- Do not use an extension cord.
- To prevent suffocation and entrapment hazards to children, remove the lid from any freezer before disposing of it or discontinuing its use.
- To avoid serious injury or death, children should not stand on, or play in or with the appliance.
- Children and persons with reduced physical, sensory or mental capabilities or lack of experience and knowledge can use this appliance only if they are supervised or have been given instructions on safe use and understand the hazards involved.
- This appliance is intended to be used in household and similar applications such as: staff kitchen areas in shops, offices and other working environments; farm houses; by clients in hotels, motels, bed & breakfast and other residential environments; catering and similar non-retail applications.

⚠ CAUTION To reduce the risk of injury when using your refrigerator, follow these basic safety precautions.

- Do not clean freezer with warm water when it is cold. Components may break if exposed to sudden temperature changes or impact, such as bumping or dropping.
- Keep fingers out of the "pinch point" areas; clearances between the lid and cabinet are necessarily small. Be careful closing lid when children are in the area.
- Do not touch the cold surfaces in the freezer compartment when hands are damp or wet, skin may stick to these extremely cold surfaces.
- Do not refreeze frozen foods which have thawed completely.

SAFETY INFORMATION

STATE OF CALIFORNIA PROPOSITION 65 WARNINGS:

WARNING

This product contains one or more chemicals known to the State of California to cause cancer and birth defects or other reproductive harm.

WARNING



EXPLOSION HAZARD

Keep flammable materials and vapors, such as gasoline, away from freezer. Failure to do so can result in fire, explosion, or death.

WARNING



EXPLOSION HAZARD Flammable Refrigerant

This appliance contains isobutane refrigerant, R600a, a natural gas with high environmental compatibility. However, it is also combustible. Adhere to the warnings below to reduce the risk of injury or property damage.

- 1)** When handling, installing and operating the appliance, care should be taken to avoid damage to the refrigerant tubing.
- 2)** Service shall only be performed by authorized service personnel. Use only manufacturer-authorized service parts."
- 3)** Dispose of refrigerator in accordance with Federal and Local Regulations. Flammable refrigerant and insulation material used require special disposal procedures. Contact your local authorities for the environmentally safe disposal of your refrigerator.
- 4)** Keep ventilation openings in the appliance enclosures or in the built-in structure clear of obstruction.
- 5)** Do not use mechanical devices or other means to accelerate the defrosting process.
- 6)** Do not damage refrigerant circuit.
- 7)** Do not use electrical appliances inside the food storage compartment of the appliance.

SAFETY INFORMATION

PROPER DISPOSAL OF YOUR OLD APPLIANCE

⚠ WARNING SUFFOCATION AND ENTRAPMENT HAZARD

Failure to follow these disposal instructions can result in death or serious injury.

IMPORTANT: Child entrapment and suffocation are not problems of the past. Junked or abandoned appliances are still dangerous even if they will sit for “just a few days.” If you are getting rid of your old appliance, please follow the instructions below to help prevent accidents.

Before You Throw Away Your Old Appliance:

- Take off the door.
- Leave the shelves in place so that children may not easily climb inside.

Refrigerant and Foam Disposal:

Dispose of refrigerator in accordance with Federal and Local Regulations. Flammable refrigerant and insulation material used require special disposal procedures. Contact your local authorities for the environmentally safe disposal of your refrigerator.

INSTALLATION INSTRUCTIONS

1. Remove all packaging material. This includes the foam base and all adhesive tape holding the freezer accessories inside and outside.
2. Inspect and remove any remains of packing, tape or printed materials before powering on the freezer.

⚠ WARNING

Risk of Fire or Explosion due to puncture of refrigerant tubing. Flammable refrigerant used. Handle with care when moving freezer to avoid either damaging the refrigerant tubing or increasing the risk of a leak.

ADJUSTING YOUR FREEZER

- Your freezer is designed for freestanding installation only. It should not be recessed or built-in.
- Place the freezer on a floor strong enough to support it fully loaded.
- When moving the freezer, never tilt it more than a 45° angle. This could damage the compressor and the sealed system.
- If the freezer is tilted, let it stand in an upright position for at least 24 hours prior to plugging. This is to allow the refrigerant to settle.

PROPER AIR CIRCULATION

- To assure your freezer works at the maximum efficiency it was designed for, you should install it in a location where there is proper air circulation, plumbing and electrical connections.
- The following are recommended clearances around the freezer:
Sides 2 in.(5.08cm)
Back 2 in.(5.08cm)

ELECTRICAL REQUIREMENT

- Make sure there is a suitable power outlet (115 volts, 15 amps outlet) with proper grounding to power the freezer.
- Avoid the use of three plug adapters or cutting off the third grounding pin in order to accommodate a two plug outlet. This is a dangerous practice since it provides no effective grounding pin for the freezer and may result in shock hazard.

INSTALL LIMITATIONS

- Do not install your freezer in any location not properly insulated or heated, e.g. garage, etc. Your freezer was not designed to operate in temperature settings less than 0 or more than 110° Fahrenheit.
- Select a suitable location for the freezer on a hard, even surface away from direct sunlight or heat sources, e.g. radiators, baseboard heaters, cooking appliances, etc. Any floor unevenness should be corrected.
- Do not install the freezer in a location exposed to rain water or direct sunlight.

INSTALLATION INSTRUCTIONS

ELECTRICAL REQUIREMENTS

⚠ WARNING



ELECTRICAL SHOCK HAZARD

Plug into a grounded 3-prong outlet.

Do not remove the ground prong from the power cord plug.

Do not use an adapter.

Do not use an extension cord.

Failure to follow these instructions can result in death, fire, or electrical shock.

Do not, under any circumstances, cut or remove the third (ground) prong from the power cord. For personal safety, this appliance must be properly grounded.

The power cord of this appliance is equipped with a 3-prong (grounding) plug which mates with a standard 3-prong (grounding) wall outlet to minimize the possibility of electric shock hazard from this appliance.

Have the wall outlet and circuit checked by a qualified electrician to make sure the outlet is properly grounded.

Where a standard 2-prong wall outlet is encountered, it is your personal responsibility and obligation to have it replaced with a properly grounded 3-prong wall outlet.

The freezer should always be plugged into its own individual electrical outlet which has a voltage rating that matches the rating plate.

A 115 Volt AC, 60 Hz, 15- or 20-amp fused, grounded electrical supply is required. This provides the best performance and also prevents overloading house wiring circuits which could cause a fire hazard from overheated wires.

Never unplug your freezer by pulling on the power cord. Always grip plug firmly and pull straight out from the outlet.

Immediately discontinue use of a damaged supply cord. If the supply cord is damaged, it must be replaced by a qualified service professional with an authorized service part from the manufacturer.

When moving the freezer away from the wall, be careful not to roll over or damage the power cord.

OPERATING INSTRUCTIONS

- Once the freezer is in its proper place, plug it in an electrical outlet having 115 volts and 15 amps.
- Set the temperature on the temperature control knob, "1" being the warmest and "7" being the coldest. Initially set the temperature on "4". Place food inside the freezer (green light will come on indicating that the freezer is in operation). After using the freezer for 24 hours, set the freezer to your desired setting.
- In case you unplug your freezer or experience an electrical outage, allow 5 minutes before plugging it back in.

ADJUSTABLE TEMPERATURE DIAL

- Your freezer will automatically maintain the temperature level you select. The temperature control dial has 7 settings plus OFF. "1" is the warmest, "7" is the coldest. Turning the dial to OFF stops cooling the freezer. Set the dial to "4" and allow 24 hours to pass before adjusting the temperature to your needs.

(NOTE: If the freezer has been placed in a horizontal or tilted position for any period of time, wait 24 hours before plugging the unit in,)

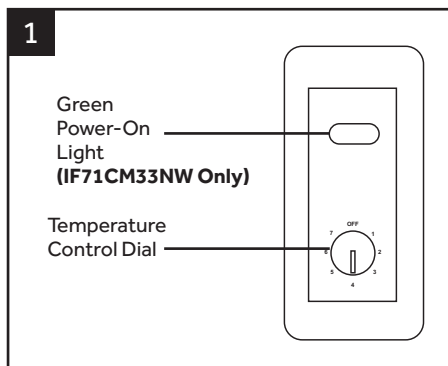

NOTE: This indicator light is only active on the IF71CM33NW.

FOOD STORAGE BASKET

- The removable basket allows you to store food more accessibly or you can remove it if not needed.

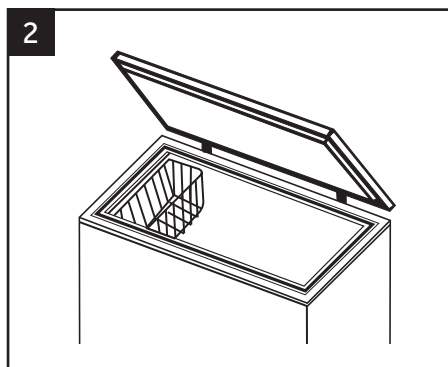

OPERATING INSTRUCTIONS

FOOD STORAGE INFORMATION

Frozen Food:

- Wipe containers before storing to avoid needless spills.
- Hot food should be allowed to cool before storing in the freezer. This will prevent unnecessary energy use.
- When storing meats, keep in the original packaging or rewrap as necessary.
- Proper freezer storage requires correct packaging. All foods must be in packages, which do not allow the flow of air or moisture in, or out. Improper storage will result in odor and taste transfer and will result in the drying out of the improperly packaged food.
- Follow package or container instructions for proper storage.
- Packaging Recommendations:
 - Plastic containers with air tight lids
 - Heavy duty aluminum foil
 - Plastic wrap made from saran film
 - Self-sealing plastic bags
- Do not refreeze defrosted/thawed foods.
- It is recommended that the freezing date be marked on the packaging.

These are some suggestions for safe storage:

- | | |
|------------------------------------|-------------|
| • TV Dinners | 3-4 months |
| • Fresh Shrimp, scallops, crawfish | 3-6 months |
| • Hamburger & stew meats | 3-4 months |
| • Ground Turkey, veal, pork | 3-4 months |
| • Chops | 4-6 months |
| • Steaks | 6-12 months |
| • Chicken or turkey, whole | 1 year |

For detailed storage chart, visit the FDA website:

www.fda.gov/downloads/food/foodborneillnesscontaminants/ucm109315.pdf

OPERATING INSTRUCTIONS

DEFROSTING AND DRAINING THE FREEZER

- Defrost whenever the frost becomes 1 / 4 in. thick. Never use a sharp or metallic instrument to remove the frost as it may damage the cooling coils. A punctured coil will void the warranty.

⚠ WARNING

Risk of Fire or Explosion due to puncture refrigerant tubing. Flammable refrigerant used. Do not use metal instruments to defrost freezer. Do not puncture refrigerant tubing.

- Turn the temperature control to OFF position and unplug the unit. Remove the drain plug from the inside of the freezer. Defrosting usually takes a few hours. To defrost faster, keep the freezer door open.
- For draining, place a tray beneath the outer drain plug. Pull out the drain dial and rotate it so that the arrow points downward. This will let the water flow out in the tray. When done, push the drain dial in and turn the arrow to the up position. Re-plug the drain plug inside the freezer compartment.

NOTE: monitor the container under the drain to avoid overflow.

- Wipe the interior of the freezer and replace the electrical plug in the electrical outlet.
- Reset the temperature control to the desired setting.

NORMAL OPERATING SOUNDS YOU MAY HEAR

- Boiling water, gurgling sounds or slight vibrations that are the result of the refrigerant circulating through the cooling coils.
- The thermostat control will click when it cycles on and off.

CARE AND MAINTENANCE

⚠ WARNING

To avoid electric shock, always unplug your freezer before cleaning. Ignoring this warning may result in death or injury.

⚠ CAUTION

Before using cleaning products, always read and follow manufacturer's instructions and warnings to avoid personal injury or product damage.

GENERAL

- Prepare a cleaning solution of 3 - 4 tablespoons of baking soda mixed with warm water. Use sponge or soft cloth, dampened with the cleaning solution, to wipe down your freezer.
- Rinse with clean warm water and dry with a soft cloth.
- Do not use harsh chemicals, abrasives, ammonia, chlorine bleach, concentrated detergents, solvents or metal scouring pads. Some of these chemicals may dissolve, damage and/or discolor your freezer.

DOOR GASKETS

- Clean door gaskets every three months according to general instructions. Gaskets must be kept clean and pliable to assure a proper seal.
- Petroleum jelly applied lightly on the hinge side of gaskets will keep the gasket pliable and assure a good seal.

POWER INTERRUPTIONS

- Occasionally there may be power interruptions due to thunderstorms or other causes. Remove the power cord from AC outlet when a power outage occurs. When power has been restored, replug power cord to AC outlet. If outage is for a prolonged period, inspect and discard spoiled or thawed food in freezer. Clean freezer before reusing.

VACATION AND MOVING CARE

- For long vacations or absences, empty food from freezer, move the temperature DIAL to the OFF position and clean the door gaskets. Prop doors open so air can circulate inside. When moving, always move the freezer vertically. Do not move with the unit lying down. Possible damage to the sealed system could occur.

MAINTENANCE

⚠ WARNING

Risk of Fire or Explosion. Flammable refrigerant used. Do not puncture the refrigerant tubing. To be repaired only by trained authorized service personnel. Consult Repair Manual before attempting to service this product. All Safety Precautions Must be followed. Component parts shall be replaced with like components to minimize the risk of possible ignition due to incorrect parts or improper service.

CARE AND MAINTENANCE

LID REMOVAL

⚠ CAUTION

LIFTING HAZARD

The lid is heavy. Use both hands to secure the lid before lifting.

⚠ CAUTION

HINGE SPRING UNDER TENSION

If it is necessary to remove the lid, follow these steps:

1. Remove the lower part of the hinge cover and then remove the upper part.

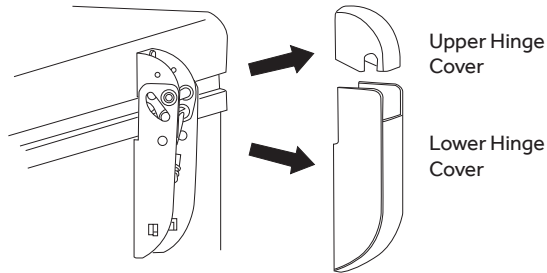

2. Open the lid to the maximum position. (The hinges are loosest at this position.)
3. Remove the 4 screws from the upper part of the hinge and the lid. Do this for each of the 2 hinges.

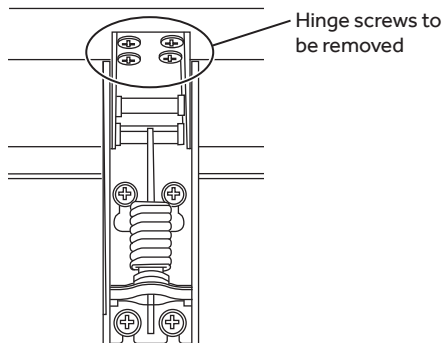

4. To reinstall lid follow steps in reverse. Tighten all hinge screws but avoid over-tightening to prevent stripping. Reinstall hinge covers.

TROUBLESHOOTING

PROBLEM	POSSIBLE REMEDY
Freezer does not operate	<ul style="list-style-type: none"> A. Make sure thermostat control is not in the "OFF" position. B. Make sure freezer is plugged in. C. Make sure there is power at the AC outlet by checking the circuit breaker. D. Wait for 30 - 40 minutes to see whether freezer will start. Compressor cycle must be complete to operate.
Food temperature appears too warm	<ul style="list-style-type: none"> A. Avoid frequent door openings. B. Allow time for recently added warm food to reach freezer temperature. C. Check gaskets for proper seal. D. Adjust temperature control to colder setting.
Food temperature is too cold	<ul style="list-style-type: none"> A. Adjust to a warmer setting and allow several hours for temperature to adjust.
Freezer runs too frequently	<ul style="list-style-type: none"> A. This may be normal to maintain constant temperature during high temperature and humid days. B. Check gasket for proper seal. C. Make sure doors are completely closed. D. Check freezer compartment for blockage from frozen food packages, containers, etc.
Freezer has an odor	<ul style="list-style-type: none"> A. Interior needs cleaning. B. Foods improperly wrapped or sealed are giving off odors. Properly wrap/seal food.

NOTES



WARRANTY

This warranty covers all defects in workmanship or materials for a period of: 12 months for labor, 12 months for parts

The warranty commences on the date the item was purchased and the original purchase receipt must be presented to the authorized service center before warranty repairs are rendered.

This warranty covers:

1. The mechanical and electrical parts which serve as a functional purpose of this appliance for a period of 12 months. This includes all parts except finish and trim.
2. The components of the sealed system, e.g. hermetic compressor, condenser and evaporator, from manufacturing defects for a period of 1 year from the date of purchase. Any damages to such components caused by mechanical abuse or improper handling or shipping will not be covered.

What will be done?

1. We will repair or replace, at our discretion, any mechanical or electrical part which proves to be defective in normal usage during the warranty period so specified.
2. There will be no charge to the purchaser for parts and labor on any covered items during the initial 12 month period. Labor is not provided and must be paid by the customer.
3. Contact your nearest authorized service center. For the name of the nearest service center please call 1-877-337-3639, 8 AM EST to 8 PM EST 7 days a week.

THIS WARRANTY COVERS APPLIANCES WITHIN THE CONTINENTAL UNITED STATES, PUERTO RICO AND CANADA.

IT DOES NOT COVER THE FOLLOWING:

- Damages from improper installation.
- Damages in shipping.
- Defects other than manufacturing.
- Damage from misuse, abuse, accident, alteration, lack of proper care and maintenance or incorrect current or voltage.
- Damage from other than household use.
- Damage from service by other than an authorized dealer or service center.
- Decorative trims or replaceable light bulbs.
- Transportation and shipping. Labor (after the initial 12 months).

THIS LIMITED WARRANTY IS GIVEN IN LIEU OF ALL OTHER WARRANTIES, EXPRESSED OR INCLUDING THE WARRANTIES OF MERCHANTABILITY AND FITNESS FOR A PARTICULAR PURPOSE.

The remedy provided in this warranty is exclusive and is granted in lieu of all other remedies. This warranty does not cover incidental or consequential damages, so the above limitations may not apply to you. Some states do not allow limitations on how long an implied warranty lasts, so the above limitations may not apply to you. This warranty gives you specific legal rights, and you may have other rights which vary from state to state.