

BELL+HOWELL BIONIC FLOODLIGHT PRO

SEPARATED **SOLAR PANEL** DESIGN

**SOLAR
POWERED**



- 2000 Lumens
super bright
- 6500 K
bright white
- Motion Activated
up to 11 meters
- Motion Sensitivity
adjustment

INSTRUCTIONS

PARTS & FEATURES

1. Multi-directional panels with total of 193 LEDs
2. Motion sensor
3. Motion sensor controls (day/night and distance)
4. Sensor time switch (30s, 60s or 120s)
5. 1K (1000lm brightness) - OFF 2K (2000lm brightness) Switch
6. Adjustment knob
7. Mounting plate (unit)
8. Adapter
9. Solar Panel
10. Mounting plate (solar panel)
11. Solar panel cable
12. Solar panel port
13. Stake
14. Ground spike
15. Screws (x6)
16. Plastic anchors (x6)

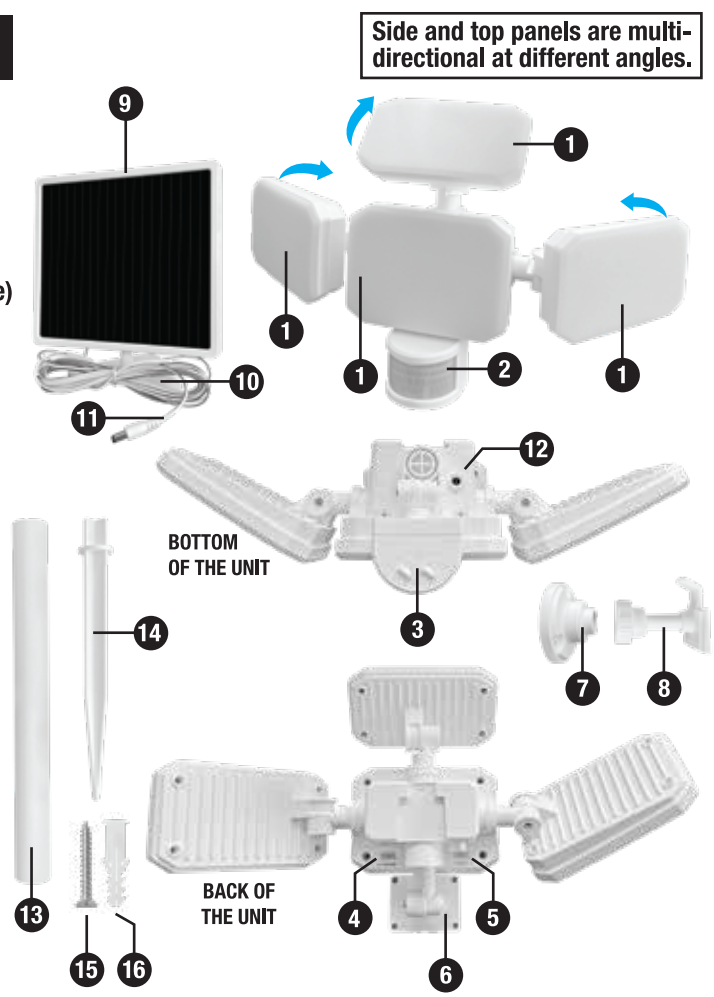

INSTALLATION

PLEASE READ THIS MANUAL CAREFULLY BEFORE USE AND KEEP IT FOR FUTURE USE.

- When picking a place to install the solar panel of the Bionic Solar Floodlight Pro, **CHOOSE A LOCATION WITH MAXIMUM SUN EXPOSURE DURING THE DAY.**
- Do not use the floodlight to force the stake into the ground. First, insert the stake into the ground and then place floodlight over the stake.
- Avoid areas under trees or bushes as this will prevent a proper charge of the Bionic Solar Floodlight Pro.
- Do not install Bionic Solar Floodlight Pro near an existing outdoor light. The built-in sensor will prevent it from turning the solar lights on.
- When using the Bionic Solar Floodlight Pro in the fall and winter, please note that due to fewer daylight hours, the batteries might not charge fully. This may affect the amount of time the Bionic Solar Floodlight Pro will be on.

MOUNTING FLOODLIGHT

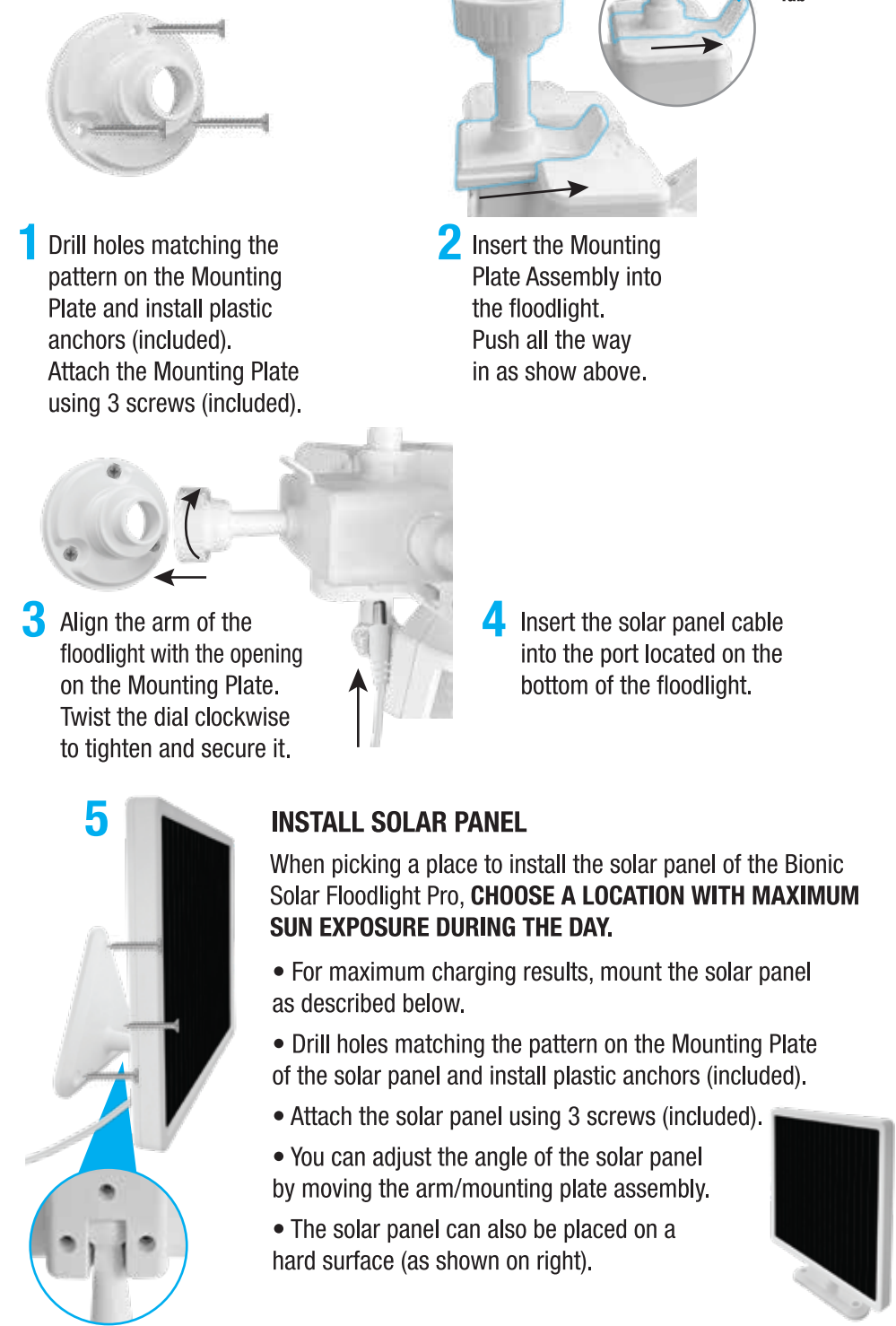

1 Drill holes matching the pattern on the Mounting Plate and install plastic anchors (included). Attach the Mounting Plate using 3 screws (included).

2 Insert the Mounting Plate Assembly into the floodlight. Push all the way in as show above.

3 Align the arm of the floodlight with the opening on the Mounting Plate. Twist the dial clockwise to tighten and secure it.

4 Insert the solar panel cable into the port located on the bottom of the floodlight.

5

INSTALL SOLAR PANEL

When picking a place to install the solar panel of the Bionic Solar Floodlight Pro, **CHOOSE A LOCATION WITH MAXIMUM SUN EXPOSURE DURING THE DAY.**

- For maximum charging results, mount the solar panel as described below.
- Drill holes matching the pattern on the Mounting Plate of the solar panel and install plastic anchors (included).
- Attach the solar panel using 3 screws (included).
- You can adjust the angle of the solar panel by moving the arm/mounting plate assembly.
- The solar panel can also be placed on a hard surface (as shown on right).



INSTALLING FLOODLIGHT IN-GROUND

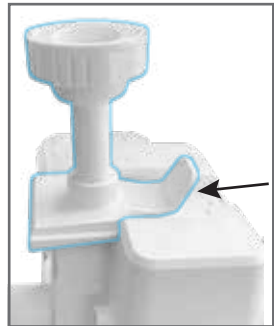

1 If needed, remove the Mounting Plate Assembly by pulling on the release tab and sliding the mounting plate out.

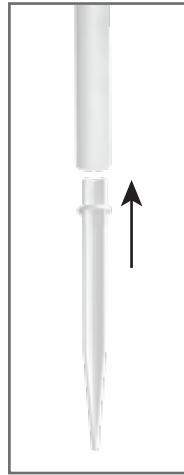

2 Insert Ground Spike into the Stake.

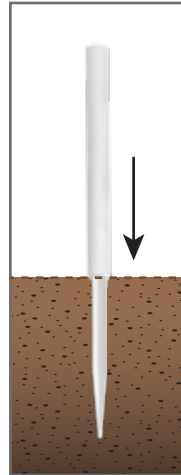

3 Make sure the soil is softened with water. Insert Stake into the ground.

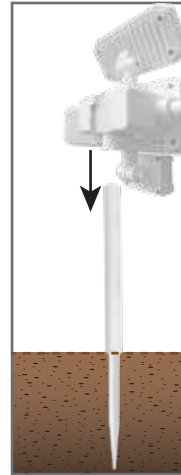

4 Insert floodlight over the Stake.



5 Insert the solar panel cable into the port located on the bottom of the floodlight.



INSTALL SOLAR PANEL

When picking a place to install the solar panel of the Bionic Solar Floodlight Pro, **CHOOSE A LOCATION WITH MAXIMUM SUN EXPOSURE DURING THE DAY.**

- For maximum charging results, mount the solar panel as described below.
- Drill holes matching the pattern on the Mounting Plate of the solar panel and install plastic anchors (included).
- Attach the solar panel using 3 screws (included).
- You can adjust the angle of the solar panel by moving the arm/mounting plate assembly.
- The solar panel can also be placed on a hard surface (as shown on right).



USAGE

SENSOR MODE

CHOOSE BRIGHTNESS:
1000 LUMENS (LOW)
or 2000 LUMENS (HIGH)



1K OFF 2K

When using for the first time, turn the Floodlight ON by sliding the switch to 1K or 2K.

Leave the solar panel under direct sunlight for solar charging for 24 hours.

UNIT NEEDS TO BE FULLY CHARGED BEFORE INITIAL USE.

To turn the unit off, move the switch to OFF position.

CHOOSE SENSOR TIME:
30 SEC, 60 SEC or 120 SEC



30S 60S 120S

The “30S / 60S / 120S” switch determines the amount of time the light will stay on after all motion has stopped.

The light will turn off automatically once the set time has passed.

ADJUSTING LUX LEVEL AND SENSOR DISTANCE

Turn the dials located on the bottom of the motion sensor to adjust the settings to your preference.



NIGHT

Set the dial so the **slanted end** is on the left (☾). On this setting, the light will turn on at **night**, when motion has been detected.



ALL DAY USE

Rotate the dial 270° to the right (☀). On this setting, the light will turn on **any time of day**, when motion has been detected.

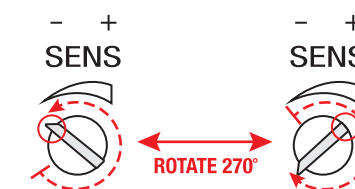

— SHORTER SENSOR DISTANCE

Set the dial so the **slanted end** is on the left (—). This is a setting for **shorter** sensor distance.

+ LONGER SENSOR DISTANCE

Rotate the dial 270° to the right (+). This is a setting for **longer** sensor distance.

ADJUSTING ANGLES

1. To adjust the angle of the motion sensor, loosen the adjustment knob by turning it counterclockwise. Once desired angle has been selected, turn it clockwise to tighten the knob.

2. If unit is mounted, swivel the arm of floodlight to direct the light where needed. All 3 of the light panels are multi-directional at different angles. Move each panel to select the best angle.

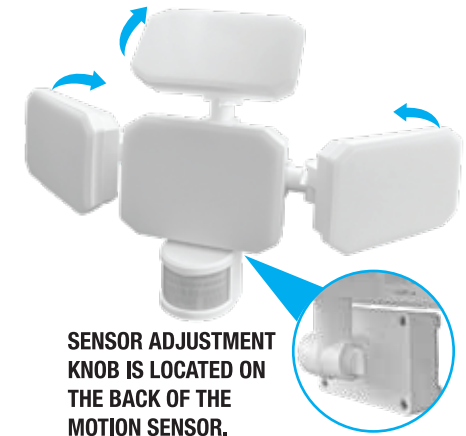

SENSOR ADJUSTMENT KNOB IS LOCATED ON THE BACK OF THE MOTION SENSOR.

CLEANING

Wipe down the unit using water and a soft, damp cloth only. Do not use harsh chemicals. Do not spray with a hose or power washer.

TECHNICAL INFORMATION

LED counts: 193pcs LED

Lumens: High mode: 2000±100lm Low mode: 1000±50lm

Product Size (inches)/ WT (lbs):

Solar panel: 8.27"x7.72"x3.07"/1.17LBs

Light: 15.79"x8.15"x4.37"/1.37LBs

Cord length: 14.9ft

Battery: Li 18650 2x1800mAh rechargeable batteries

Color Temperature: 6000-7000K

Waterproof rating: IP65



BELL+HOWELL® BIONIC SOLAR FLOODLIGHT PRO ITEM NO. 9422ENL
DISTRIBUTED BY EMSON® NEW YORK, NY 10001, USA ©2023 EMSON®
ALL RIGHTS RESERVED. MADE IN CHINA.