



INSTRUCTION MANUAL

Dehumidifier – PD08G



Please read this instruction manual carefully
before operating, and save for future reference.

CATALOG

IMPORTANT SAFETY INSTRUCTIONS	4
• Before First Use	4
• Warning	4
MACHINE CONSTRUCTION	6
• Parts Description	6
• Control Panel	6
OPERATION INSTRUCTION	7
• Setting	7
• Display Status Description	9
• Instructions for Drying Clothes	10
• Fault Phenomenon	10
• Drainage Guide	11
CARE&CLEANING	14
PRODUCT SPECIFICATIONS	16

01 IMPORTANT SAFETY INSTRUCTIONS

■ Before First Use

- ▶ Thank you for purchasing our dehumidifier, wishes that our products and services can bring convenience to your work and life. To familiarize yourself with the controls, functions, and full potential of your new HOGARLABS dehumidifier, please read this manual thoroughly before using.
- ▶ The dehumidifiers may have been tilted or placed upside down during shipping. Leave the dehumidifier to stand upright for 24 hours so the oil in the compressor can settle from the move, not doing so can affect the performance or lifespan of the dehumidifier, as shown in the figure.

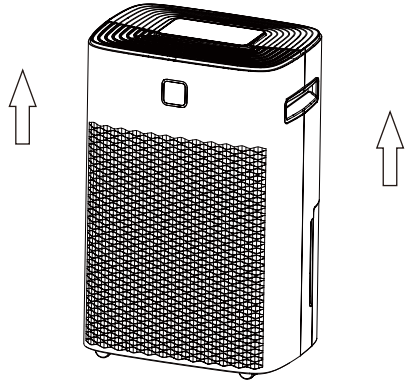

To prevent injury and property damage, the following instructions must be followed when using the dehumidifier.

■ Warning

- ▶ Do not place the dehumidifier near a heater.
- ▶ Do not use the dehumidifier near flammable gas or combustibles, such as gasoline, benzene, thinner, etc.
- ▶ Always plug into a grounded outlet properly.
- ▶ Do not use if the power cord is broken or damaged.
- ▶ Do not use the socket if it is loose or damaged.
- ▶ Do not modify power cord length or share the outlet with other dehumidifiers.
- ▶ Never try to take apart or repair the dehumidifier by yourself.
- ▶ Do not place a heavy object on the power cord and make sure that the cord is not compressed.
- ▶ Do not place flower vases or other water containers on top of the dehumidifier.
- ▶ Do not operate or turn off the dehumidifier by plugging in or unplugging the dehumidifier. Use the control panel instead.
- ▶ Make sure to turn off and unplug the dehumidifier before cleaning.
- ▶ Do not clean the dehumidifier with water. If water enters the dehumidifier, turn off the dehumidifier immediately.
- ▶ Care should be taken when using the dehumidifier in a room: infants, children, and the elderly.
- ▶ Disconnect the power if strange sounds, odors, or smoke come from the dehumidifier.
- ▶ Hold the plug by the head when taking it out.

- ▶ Turn off and disconnect the power when not using the dehumidifier for a long time.
- ▶ Use a soft cloth to clean. Do not use wax, thinner, or a strong detergent.
- ▶ Be sure to replace the bucket properly after emptying to prevent water from dripping on the floor.
- ▶ Do not climb on or sit on the dehumidifier.
- ▶ Never insert your finger or other foreign objects into grills or openings. Take special care to warn children of these dangers.
- ▶ The functioning temperature range is between 41°F (5°C) and 95°F (35°C).
Maintain a minimum clearance of 7.9 inches (20 cm) on the sides and back of the dehumidifier and 15.7 inches (40 cm) on the top of the dehumidifier to allow for proper air circulation, as shown in the figure.
- ▶ Children should be supervised to ensure that they do not play with the appliance.
- ▶ This appliance is not intended for use by persons (including children) with reduced physical, sensory or mental capabilities, or lack of experience and knowledge, unless they have been given supervision or instruction concerning use of the appliance by a person responsible for their safety.

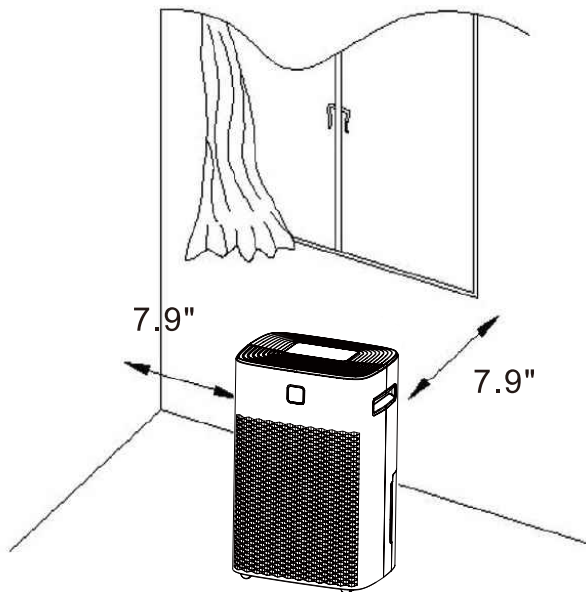

02 MACHINE CONSTRUCTION

■ Parts Description

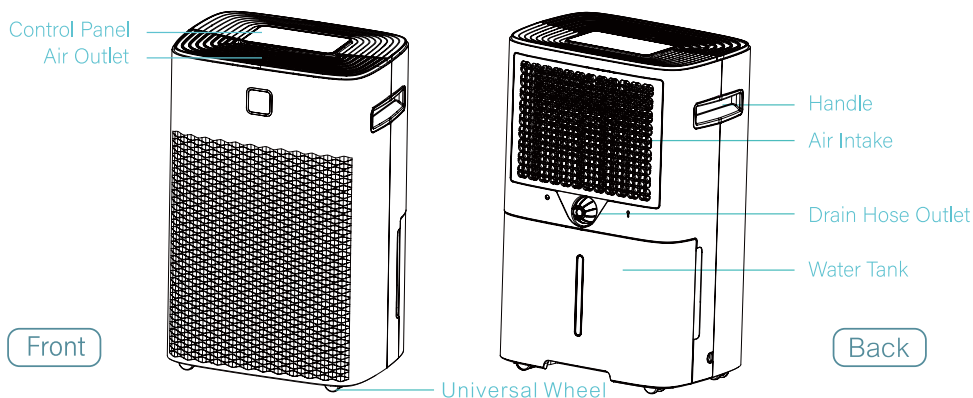

NOTE: Do not cover or block the air inlet or outlet.

■ Control Panel

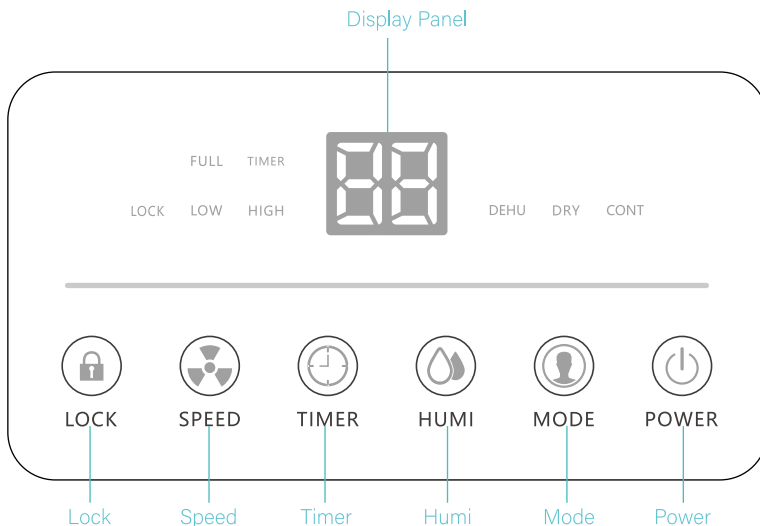



Power Button

Press to turn the dehumidifier on and off



Mode Button

Press mode button to choose function



Lock

It is used to open and release the child lock function.



HUMI Button

Control the humidity setting up/down



Timer Button

Press to initiate the auto start and auto stop feature



Speed Button

Control the fan speed

03 OPERATION INSTRUCTION

■ Setting

- ▶ **Mode Setting:** The dehumidifier has three modes: Dry Clothes Mode, Dehumidify Mode, Continuous Dehumidify Mode. When Power On, press the "MODE" button, the device will cycle through the Dry Clothes, Dehumidify, and Continuous Dehumidify modes. Each time you press the mode button, the working mode will switch accordingly.
 - a. Dry Clothes Mode: Humidity and fan speed cannot be set.
 - b. Dehumidify Mode: Humidity and fan speed can be set.
 - c. Continuous Dehumidify Mode: Humidity cannot be set, fan speed can be set.
- ▶ **Humidity Setting:** The humidity level can be set within a range of 30%RH to 80%RH in 5% increments, when it starts work, it will first automatically detect and show the room humidity, in dehumidification mode (other modes are invalid), press the "HUMI" button to change the humidity selection in 5% increments, the "88" icon flash and show the setting humidity. When the "88" icon flashing, you can set the humidity within a range of 30%RH to 80%RH in 5% increments. Press "HUMI" button to make the humidity setting increase by 5%RH. If the machine hasn't been operate for 5s, the "88" icon will show the actual current room humidity.





- a. When the humidity is above or below the humidity value you have set, the dehumidifier will automatically on or off.
 - b. When the humidity level is set at 30%RH, the dehumidifier will be work at continuous dehumidifying mode.
- **Timer Setting:** With this button you can preset the time when the dehumidifier automatically starts and shuts down, Setting an AUTO-ON timer when the dehumidifier is off and setting an AUTO-OFF timer when the dehumidifier is on.
- a. Press the "TIMER" button to select the timer by 1-hour increments. You can set the timer up to 24 hours. It will start to do the countdown when you start the timer.
 - b. Press and hold the "TIMER" button for several seconds to make the selection of the timer faster.
 - c. If the time is set to 00, this is called the invalid time, If you set the timer successfully, the indicator light above the "TIMER" button will light up. The led screen will show several seconds time, and show the current humidity.
- **LOCK(2S):** When the unite is turned on, press "LOCK" and hold for 3-5 seconds, the control panel and other buttons will be locked, to unlock the control panel and buttons, press and hold the "LOCK" button again for 3-5 seconds.
- **Speed Button:** Controls the fan speed. Press to select either High or Low fan speed. Higher fan speed will result in quicker moisture removal. Set the fan control to High for maximum moisture removal. When the humidity has been reduced and quiet operation is preferred, set the fan control to Low.
- **Power Off Memory Function:**
- a. The device automatically restores the working state after power on.
 - b. If the device is turned on and a power interruption occurred, after starting the unit again, it will keep the parameters or settings that was setup.
 - c. If the device is turned off and power interruption happened, the device will still be in a power off status when turned on.
- **Overflow Protection:** When the tank full of water, the machine will turn off automatically. The "🚰" indicator light will flash, and the buzzer will alarm for a few seconds. After you empty the water from the bucket, the "🚰" indicator light will turn off and the machine will restart to work.
- Caution: Water tank must place in right position, other wise will cause the waterfull alarm.**

- ▶ **Auto Defrost Function:** When the dehumidifier is running at a lower temperature, the system will automatically determine whether there is a presence of frost. If the machine determines there is a presence of a frost, it will defrost automatically. When the machine is defrosting, the fan will run at high wind speed and the compressor stops.

■ Display Status Description

- ▶ After setting the circuit of the equipment, the "Power" button will light up when the dehumidifier is in standby (power off) state.
- ▶ Timer indicate light "o" : If the timer is setup properly, the indicator will light up, otherwise the indicator light will be off.
- ▶ High-speed indicate light "HIGH" : If you set the unit to high speed fan mode, the indicator will light up.
- ▶ Low-speed indicate light "LOW" : If you set the unit to low speed fan mode, the indicator will light up.
- ▶ Dry clothes light indicate "DRY" : When dry clothes mode is selected, it will be on, otherwise it will be off.
- ▶ Dehumidify mode light indicator "DEHU" : When the device starts to dehumidify, the indicator light will on. When the room environment humidity reach the preset humidity, the light will be flashing. Otherwise it will be off.
- ▶ Continuous dehumidification mode indicator "CONT": when continuous dehumidification mode is selected, it will be on, otherwise it will be off.
- ▶ Water full light indicator "A": When the water tank or bucket is full, this indicator will be flashing.
- ▶ When the device is alarm, the display panel will appear alarm error. (The alarm error and humidity data will be flashing rotation.)
- ▶ When the device is on working, the data " " on the display panel is the humidity value.

■ Description of front prompt light

- ▶ $0\% \leq \text{Current ambient humidity} \leq 39\%$, the scene light shows "light green" 
- ▶ $40\% \leq \text{Current ambient humidity} \leq 60\%$, the scene light shows "green" 
- ▶ $61\% \leq \text{Current ambient humidity} \leq 80\%$, the scene light shows "blue" 
- ▶ $81\% \leq \text{Current ambient humidity} \leq 100\%$, the scene light shows "orange" 

■ Instructions for Drying Clothes

The dehumidifier can be used for drying clothes in rainy weather.

Step 1: Hang the washed clothes in a small space such as cloakroom, bathroom, or storage room. Note: Keep away the unit from the water drip from the washed clothes.

Step 2: Open the dehumidifier and choose the "DRY" mode. It is best if you let the air outlet of the dehumidifier to blow air to the clothes directly.

a. The drying effect will vary from the thickness of clothes, the number of clothes and the size of the drying space. Theoretically, the effect will be better when clothes are few, thin and space is small.

b. The drying process would take 3-8 hours, and we suggest that continuous drainage mode is more suitable when drying clothes.

■ Fault Phenomenon

General Customer Feedback Phenomenon	Frequently Reason	Processing Method
The drain hose was properly connected and Water leakage or the water still drained to the tank.	Connected to the hose without pulling out the gray rubber plug of the water outlet.	Pull out the grey rubber plug of the water outlet before connecting the water pipe (please refer to the schematic diagram of continuous drainage function page in the manual for details)
	The pipe is not connected properly, the other end of the pipe is blocked and the water cannot be discharged properly.	Ensure that both ends of the water pipe are unimpeded after connecting the water pipe. Keeping the water pipe in an inclined state is more conducive to gravity drainage.
The dehumidifier is started but doesn't work.	The tank is full or not installed properly.	Empty the tank and reinstall it in place.
	The sensor float in the tank got stuck and didn't reposition properly.	Push the float down to the lowest position for the correct float position.
	The dehumidifier is in the defrosting process, it is normal the compressor ceases while defrosting process.	The defrosting process may take 15 to 20 minutes. When the defrosting is complete, the dehumidifier automatically starts to continue the dehumidification process.
Humidity always shows "25%RH"(there is a big difference from the actual humidity)	Humidity sensor failure?	Set the humidity to 30%RH, the dehumidifier can still continue to work, and can be used normally.
		Repair and replace the humidity sensor.
Humidity always shows "99%RH"(there is a big difference from the actual humidity)	1. Water on the surface of humidity sensor? 2. Humidity sensor failure?	The dehumidifier is not affected and can continue to work, and can be used normally.
		Please let the dehumidifier keeps working for a period of time, after the water on the surface of the humidity sensor is removed, it will return to normal.
		Repair and replace the humidity sensor.

■ Drainage Guide

There are two ways to remove collected water.

► **Use the Water Tank:** When the water tank is already full, the Full Tank Alert indicator will light up, the dehumidifier will automatically shut down until the tank has been emptied and placed back to the unit. The water in the tank shall be emptied as follows:

- a. Do not move the dehumidifier at this time in case the water spills on the floor. Gently remove the water bucket from the dehumidifier;
- b. To remove the bucket to empty the collected water, gently remove the water bucket from the dehumidifier;
- c. When the water tank is placed, hold the tank tightly with your hand. If the tank is not properly placed, the water-full sensor will still be activated and the dehumidifier will not operate.

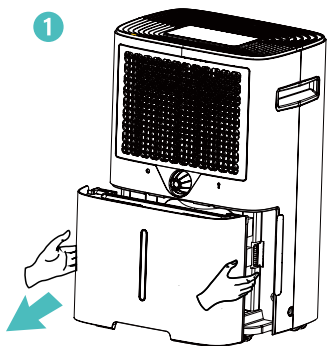

Pull the water tank out from the bottom with your hand

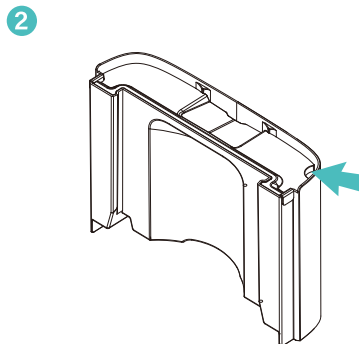

Open the cover of the water tank

- **Continuous Drainage:** Remove the power supply, take out the water tank, open the drain cover, insert the water pipe into the continuous drain port and push it back into the water tank. Connect the power supply to start the operation and keep the water tank installed, then the continuous drainage function can be carried out.

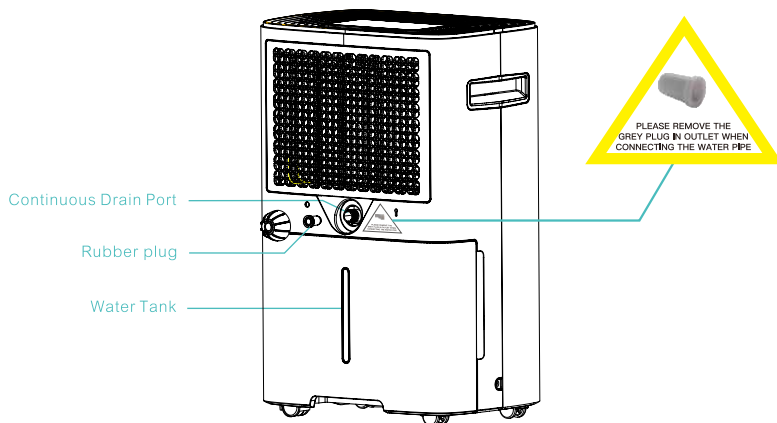
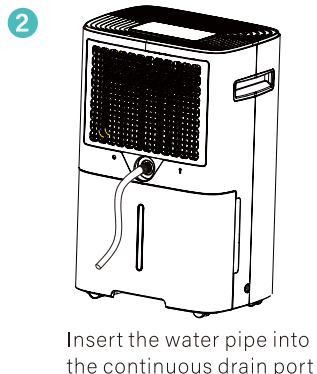
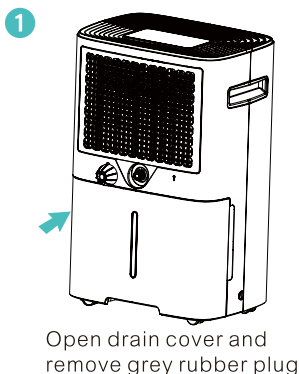

Note: a. Make sure the connection is tight and there is no leaking.

b. Be sure to run the water hose sloping downward to let the water flow out smoothly. No kinks or bent.

c. If the condensation water would be drained out to an external container via the hose, be sure NOT to submerge the other end of the hose into the drained out water.

d. When the continuous drain feature is not being used, remove the drain hose from the outlet and screw the drain outlet cover on.

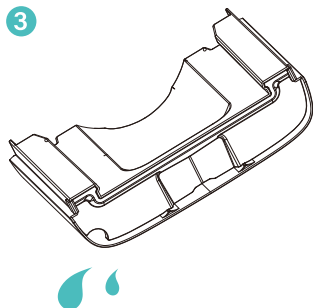

Invert the water tank to empty the water

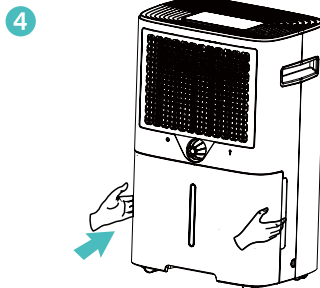

Put the water tank back in place, the water full indicator will go out

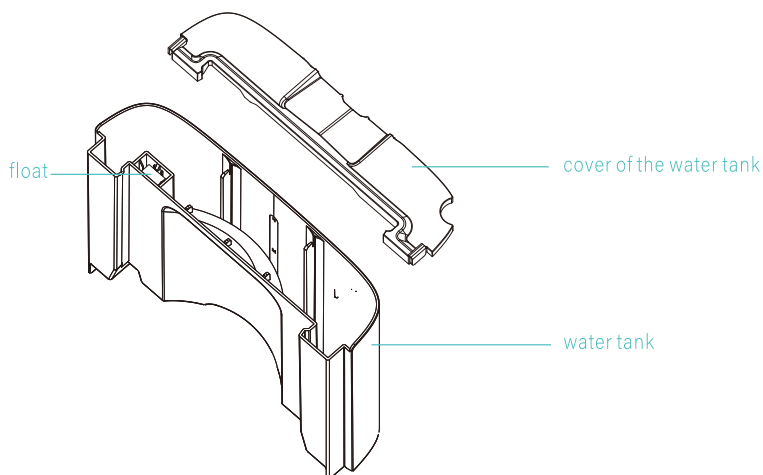

Note: **a.** Do not remove the float from the water tank. If the float in the water tank is removed, the sensor may not be able to determine the water level stored in the tank properly that may lead to water overflow leak from the water tank.

b. If the water tank is dirty, just use cold water or warm water to clean it. Do not use detergent, steel wool, chemically treated dust cloth, gasoline, benzene or other solvents. Otherwise, it may damage the water tank and cause it to leak.

c. When placing back the water tank, use your hands to press the tank back in its place. If the water tank is not placed properly, protections from water overflow may not operated.

04 CARE&CLEANING

To avoid possible electric shock, ensure to turn the dehumidifier off and disconnect the plug from the power source before performing any cleaning or maintenance!

- **Clean the Vent and Case:** Wipe the dehumidifier with a soft and slightly wet towel, Do not splash water directly onto the dehumidifier. Doing so may cause an electric shock or the insulation to deteriorate, or cause the dehumidifier to rust. The air intake and outlet vents get soiled easily, please clean it regularly and timely.
- **Filter Cleaning:** Use a vacuum cleaner to gently suck the dust on the surface of the filter. If the filter is very dirty, wipe it with warm water and a gentle cleaner and dry it completely, Then insert the filter back into the dehumidifier, as shown in the figure below:

Note: DO NOT operate the dehumidifier without a filter because dirt and lint will clog it, reducing performance.

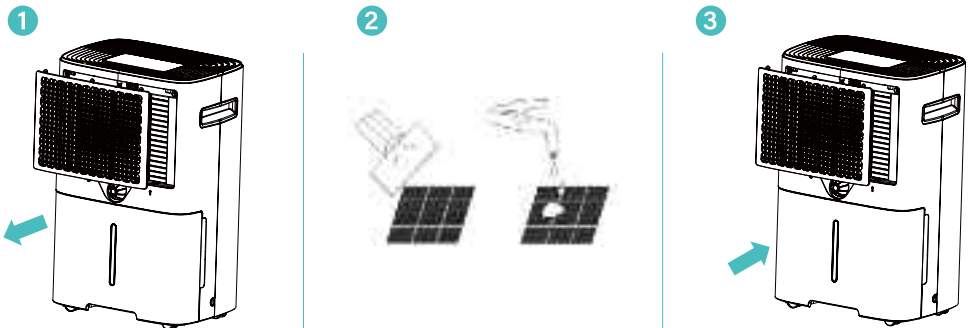

- **Clean the Reservoir:** Every few weeks, clean the reservoir to prevent the growth of mold, mildew, and bacteria. Follow the below steps to open the water bucket correctly to clean:
- a. Pick up the handle at an angle of 45° and then pull one side of the handle outward horizontally to take the handle off;
 - b. Partially fill the reservoir with clean water and add a little mild detergent;
 - c. Swish it around in the reservoir, empty and rinse.
- **Dehumidifier Storage:** When not using the dehumidifier for a long period, please follow the below steps to clean the dehumidifier and store it properly, pay attention to the following steps:
- a. Operate the dehumidifier on high fan mode for half a day, and then wait 1 day before emptying the reservoir.
 - b. Clean the dehumidifier housing, water reservoir, and air filter. Ensure the whole dehumidifier is clean and dry.
 - c. Take out the water bucket, put the plug and as possible cord into the water bucket, and then replace the bucket in the dehumidifier.
 - d. Cover the dehumidifier with a plastic bag.
 - e. Store the dehumidifier upright in a dry, well-ventilated place.

05 PRODUCT SPECIFICATIONS

Model	PD08G
POWER SOURCE	120V~60Hz
RATED POWER	400W
RATED CURRENT	3.6A
MOISTURE REMOVAL CAPACITY(65°F,60%RH)	14 Pints/Day
MOISTURE REMOVAL (80°F,60%RH)	22 Pints/Day
MOISTURE REMOVAL (86°F,80%RH)	40 Pints/Day
MOISTURE REMOVAL (95°F,90%RH)	50 Pints/Day
INPUT POWER(65°F,60%RH)	200W
INPUT CURRENT(65°F,60%RH)	1.8A
IEF(65°F,60%RH)	1.30 liters/kWh
MOTOR FLA	0.23A
MOTOR COMPRESSOR	RLA:2.2A LRA:14.0A
REFRIGERANT	R134a/160g(5.64ozs)
MAXMUM OPERATING PRESSURE HIGH	3.5MPa
MAXMUM OPERATING PRESSURE LOW	1.6MPa
LOW PRESSURE	0.7MPa



CUSTOMER SERVICE

For each HOGARLABS product, you'll get:

- ⊗ One year free return or refund service;
- ⊗ Two years of free replacement service;
- ⊗ Lifetime maintenance service.

All the costs are covered by HOGARLABS, please feel free to contact our Customer Assurance Team [✉ support@hogarlabs.com](mailto:support@hogarlabs.com)