

INSTALLATION

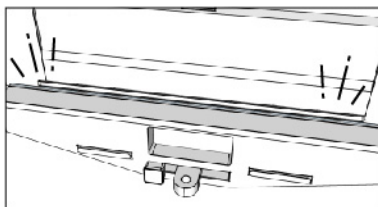

STEP 7

Test the Redline LED Bar again for function.

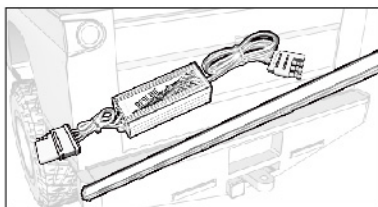

If you experience any error codes or dash lights, please install the optional Tailgate Module between the vehicle and Redline LED bar sold separately.

DISCLAIMER

OPT7 Lighting is not liable for damages, injuries, or death while installing this product. The Installation Guide is intended as assistance to reduce setup time. OPT7 Lighting assumes no responsibility for improper installation. If you are unfamiliar with your vehicle or inexperienced with aftermarket upgrades, please seek professional assistance.



NEED HELP?

Scan for tutorial videos, troubleshooting tips, and more.

2 YEAR WARRANTY

REDLINE TAILGATE

INSTALLATION GUIDE

WHAT'S INCLUDED

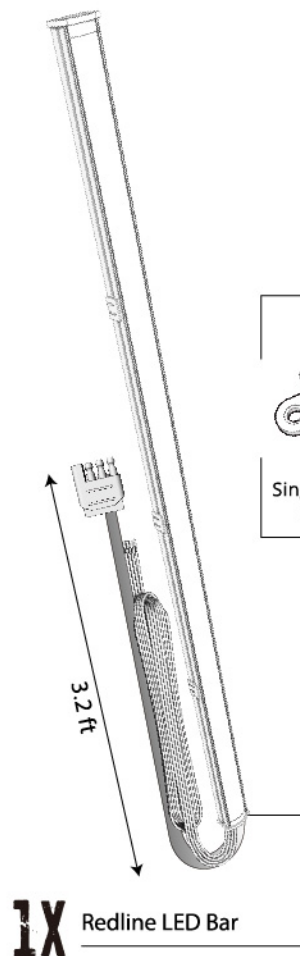

1X Redline LED Bar

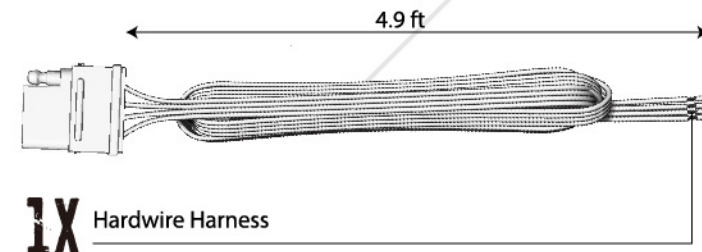

1X Hardwire Harness

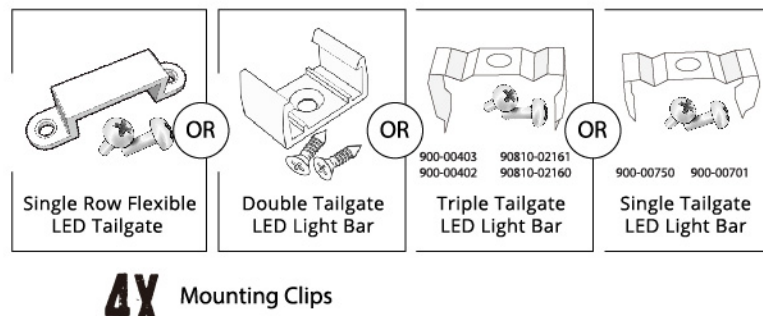

4X Mounting Clips

7X Scotch-Lok Wiring Connectors

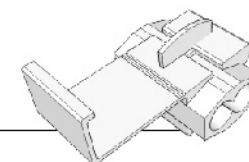

1X Adhesive Promoter

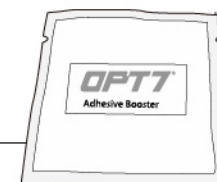

INSTALLATION

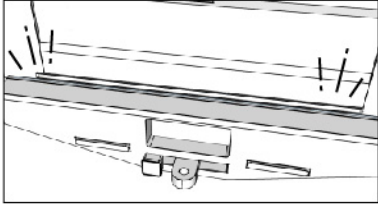

STEP 1

Test the Redline LED Bar for function before mounting on vehicle.

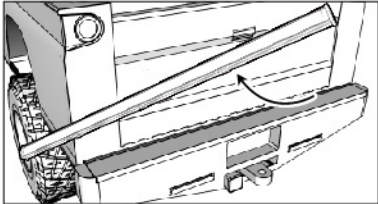

STEP 2

Remove tailgate from vehicle

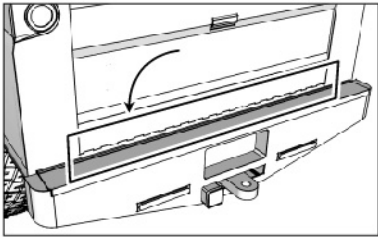

STEP 3

Thoroughly clean the area where the Redline LED Bar will be mounted.

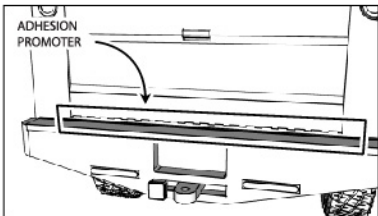

STEP 4

Apply the Adhesive Promoter to the cleaned area.

OR

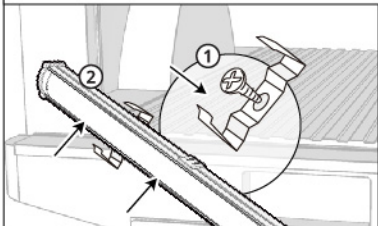

STEP 4

*Does not apply to Redline Flexible

Mark out where you want to mount the included clips taking straightness and placement into consideration.

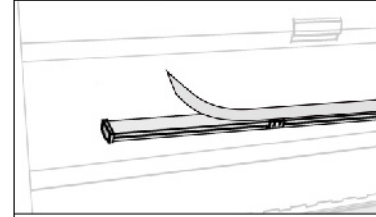

STEP 5

On the Redline LED Bar, peel the back off of the adhesive and apply firmly to the cleaned area.

OR

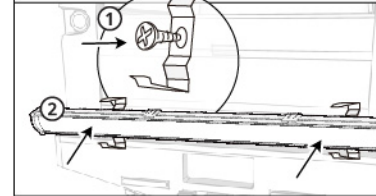

STEP 5

*Does not apply to Redline Flexible

Use the included screws and clips to solidly mount the Redline LED bar to the vehicle.

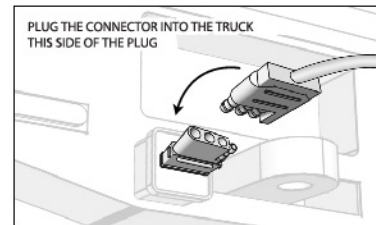

STEP 6

Plug the 4-pin flat connector into the proper receptacle on the vehicle.

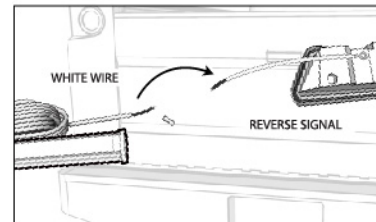

STEP 7

FOR TRIPLE TAILGATE ONLY

Splice the white wire coming from the Redline LED Bar into the reverse signal on the vehicle.

STEP 8

Optional: If hard-wiring, use image below to identify wire color functions and pair them to appropriately identified wires on vehicle.

TO REDLINE LED BAR

Ground
Running Light
Left Turn & Brake
Right Turn & Brake

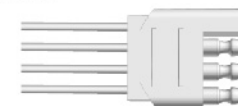

TRAILER HARDWIRE HARNESS

White/Ground
Brown/Running Light
Yellow/Left Turn & Brake
Green/Right Turn & Brake

