

VEAGASO

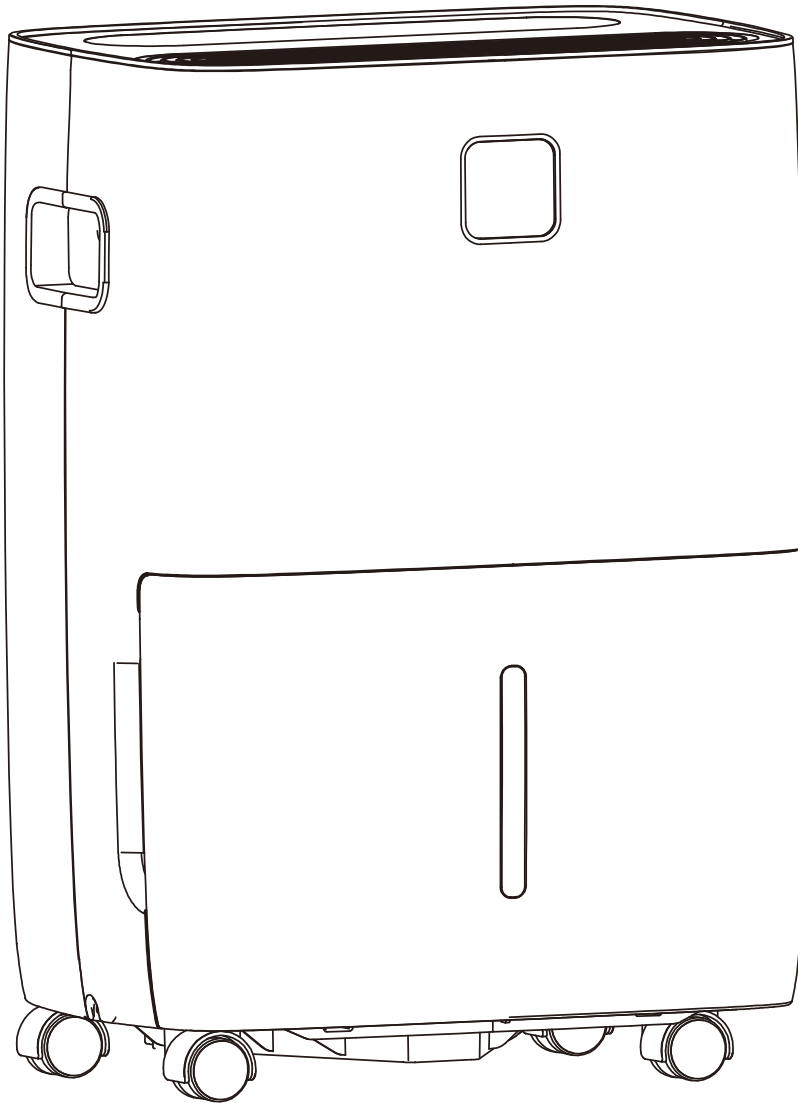

ENERGY STAR® qualified units remove moisture with less energy than conventional dehumidifiers.

# DEHUMIDIFIER

## Owner's Manual

Model: VG360  
KEEP THESE INSTRUCTIONS  
FOR FUTURE REFERENCE

# CONTENTS

▪ THANK YOU .....	01
▪ WARRANTY .....	01
▪ SAFETY WARNINGS .....	02
▪ FEATURES .....	08
▪ TECHNICAL DATA .....	09
▪ PRODUCT OVERVIEW .....	10
▪ OPERATING INSTRUCTIONS .....	11
▪ REMOVING COLLECTED WATER .....	13
▪ CLEANING & MAINTENANCE .....	15
▪ TROUBLESHOOTING .....	16
▪ SELF-DIAGNOSING CODES .....	17

## THANK YOU

Thank you for purchasing a VEAGASO Dehumidifier. This User Manual is intended to provide you with important information needed to set up, operate, maintain and troubleshoot this product.

Please take a few moments to read the instructions and familiarize yourself with all the operational aspects of your new VEAGASO Dehumidifier.

## WARRANTY

Our dehumidifier comes with one-year warranty. However, in order to activate the warranty, you need to send your order number to: **support@veagaso.com**

If you have any questions or product issues during this period, please contact our official service team via email: **support@veagaso.com**

We will reply and answer your questions within 1 working day. Please don't worry we will stand always behind our products and provide you with the best service.

Please contact the seller if you want to return the product, all items can be returned within 30 days after delivery. You will receive a full refund back to the original payment method as long as the product and accessories are returned in their original packaging intact.

## SAFETY WARNINGS

**When using the unit, please read the following safety instructions:**

- Follow local grid interconnection rules while installing the dehumidifier and ensure that it is properly grounded. If you have any questions on electrical installation, follow the instructions of the manufacturer. And if necessary, ask a professional electrician to install it.
- Place the machine in a flat and dry place and keep a distance of above 50cm between the machine and the surrounding objects or walls.
- When drainage pipes are installed, ensure that the drainage pipes are properly connected, and are not distorted or bended.  
Keep the air inlet and outlet free from obstructions.
- The appliance shall be installed in accordance with national wiring regulations.
- After the dehumidifier is installed, ensure that the power plug is intact and firmly plugged into the power outlet, and place the power cord orderly to prevent someone from being tripped or pulling out the plug.
- Do not put any object into the air inlet and outlet of the dehumidifier.
- Maintenance and repair requiring the assistance of other skilled personnel shall be carried out under the supervision of the person competent in the use of flammable refrigerants.
- All working procedure that affects safety means shall only be carried by competent persons.
- The dehumidifier is only suitable for indoor use, and is not suitable for other applications.
- When moving the machine, make sure that it is in an upright position.
- The machine should stay away from gasoline, flammable gas, stoves and other heat sources.

- Don't disassemble, overhaul and modify the machine arbitrarily, otherwise it will cause a machine malfunction or even bring harm to persons and properties. To avoid danger, if a machine failure occurs, ask the manufacturer or professionals to repair it.
- Do not pull the plug to turn off the machine.
- Do not place cups or other objects on the body to prevent water or other liquids from spilling into the dehumidifier.
- Do not use insecticide sprays or other flammable substances near the dehumidifier.
- Do not wipe or wash the dehumidifier with chemical solvents such as gasoline and alcohol. When you need to clean the dehumidifier, you must disconnect the power supply, and clean it with a half-wet soft cloth. If the machine is really dirty, scrub with a mild detergent.
- Children shall not play with the appliance. Cleaning and maintenance shall not be made by children without supervision.
- If the supply cord is damaged, it must be replaced by the manufacturer, its service agent or similarly qualified persons in order to avoid a hazard.
- The appliance shall be stored so as to prevent mechanical damage from occurring.
- Plug into a grounded 3 prong outlet.
- Do not use an extension cord.
- Do not remove ground prong.
- Do not use an electrical adapter.
- Unplug the dehumidifier before servicing.

## Special Safety Instructions for using flammable refrigerant:

### 1. Transport of equipment containing flammable refrigerants

Compliance with the transport regulations

### 2. Marking of equipment using signs

Compliance with local regulations

### 3. Disposal of equipment using flammable refrigerants

Compliance with national regulations

### 4. Storage of equipment appliances

The storage of equipment should be in accordance with the manufacturer's instructions.

### 5. Storage of packed (unsold) equipment

- Storage package protection should be constructed such that mechanical damage to the equipment inside the package will not cause a leak of the refrigerant charge.
- The maximum number of pieces of equipment permitted to be stored together will be determined by local regulations.

### 6. Information on servicing

#### 6-1 Checks to the area

- Prior to beginning work on systems containing flammable refrigerants, safety checks are necessary to ensure that the risk of ignition is minimised.
- For repair to the refrigerating system, the following precautions shall be complied with prior to conducting work on the system.

#### 6-2 Work procedure

- Work shall be undertaken under a controlled procedure so as to minimise the risk of a flammable gas or vapour being present while the work is being performed.

#### 6-3 General work area

- All maintenance staff and others working in the local area shall be instructed on the nature of the work being carried out. Working in confined spaces shall be avoided.
- The area around the workspace shall be sectioned off. Ensure that the conditions within the area have been made safe by control of flammable material.

#### **6-4 Checking for presence of refrigerant**

- The area shall be checked with an appropriate refrigerant detector prior to and during work, to ensure the technician is aware of potentially flammable atmospheres.
- Ensure that the leak detection equipment being used is suitable for use with flammable refrigerants, i.e. non-sparking, adequately sealed or intrinsically safe.

#### **6-5 Presence of fire extinguisher**

- If any hot work is to be conducted on the refrigeration equipment or any associated parts, appropriate fire extinguishing equipment shall be available to hand.
- Have a dry powder or CO2 fire extinguisher adjacent to the charging area.

#### **6-6 No ignition sources**

- No person carrying out work in relation to a refrigeration system which involves exposing any pipe work that contains or has contained flammable refrigerant shall use any sources of ignition in such a manner that it may lead to the risk of fire or explosion.
- All possible ignition sources, including cigarette smoking, should be kept sufficiently far away from the site of installation, repairing, removing and disposal, during which flammable refrigerant can possibly be released to the surrounding space.
- Prior to work taking place, the area around the equipment is to be surveyed to make sure that there are no flammable hazards or ignition risks "No Smoking" signs shall be displayed.

#### **6-7 Ventilated area**

- In addition, a set of calibrated weighing scales shall be available and in good working order.
- Hoses shall be complete with leak-free disconnect couplings and in good condition.
- Before using the recovery machine, check that it is in satisfactory working order, has been properly maintained and that any associated electrical components are sealed to prevent ignition in the event of a refrigerant release.
- Consult manufacturer if in doubt.
- The recovered refrigerant shall be returned to the refrigerant supplier in the correct recovery cylinder and the relevant Waste Transfer Note arranged.

- The evacuation process shall be carried out prior to returning the compressor to the suppliers.
- Do not mix refrigerants in recovery units and especially not in cylinders.
- If compressors or compressor oils are to be removed, ensure that they have been evacuated to an acceptable level to make certain that flammable refrigerant does not remain within the lubricant.
- Only electric heating to the compressor body shall be employed to accelerate this process.
- When oil is drained from a system it shall be carried out safely.
- This appliance is not intended for use by persons (including children) with reduced physical, sensory or mental capabilities, or lack of experience and knowledge, unless they have been given supervision or instruction concerning use of the appliance by a person responsible for their safety. Children should be supervised to ensure that they do not play with the appliance.
- When moving or relocating the dehumidifier, consult experienced service technicians for disconnection and reinstallation of the unit.
- Do not place any other electrical products or household belongings under the unit. Condensation dripping from the unit might get them wet, and may cause damage or malfunction of your property.
- To keep ventilation openings clear of obstruction.
- The appliance shall be stored in a well-ventilated area where the room size corresponds to the room area as specified for operation.
- The appliance shall be stored in a room without continuously operating open flames (for example: an operating gas appliance) and ignition sources (for example operating electric heater).
- Any person who is involved with working on or breaking into a refrigerant circuit should hold a current valid certificate from an industry-accredited assessment authority, which authorise their competence to handle refrigerants safely in accordance with an industry recognised assessment specification.
- Servicing shall only be performed as recommended by the equipment manufacturer.
- Maintenance and repair requiring the assistance of other skilled personnel shall be carried out by the person competent in the use of flammable refrigerants.
- The pipe-work shall be compliance with national gas regulations.
- The maximum refrigerant charge amount is 0.45kg.
- The installation of pipe-work shall be kept to minimum.



If the refrigerant is flammable the dehumidifier equipment shall have red, Pantone Matching System (PMS)#185 marked service ports, pipes, hoses, and other devices through which the refrigerant is serviced. This colour shall be present at all service ports and where service puncturing or otherwise creating an opening from the refrigerant circuit to the atmosphere might be expected (e.g., process tubes). The colour mark shall extend at least 25 mm (1 inch) from the refrigerant servicing point and shall be replaced if removed.

 <p>Caution, risk of fire Avertissement: risqué d'incendie/ matériaux inflammables</p>	<p><b>WARNING</b></p> <ul style="list-style-type: none"> <li>• Do not use means to accelerate the defrosting process or to clean, other than those recommended by the manufacturer.</li> <li>• The appliance shall be stored in a room without continuously operating ignition sources (for example, open flames, an operating gas appliance or an operating electric heater)</li> <li>• Do not pierce or burn.</li> <li>• Be aware that refrigerants may not contain an odour.</li> </ul>
	<p><b>AVERTISSEMENT</b></p> <ul style="list-style-type: none"> <li>• Ne pas utiliser de produits permettant d'accélérer le dégel ou de produits de nettoyage autres que ceux recommandés par le fabricant.</li> <li>• L'appareil doit être entreposé dans un endroit sans source d'allumage fonctionnant en continu (par exemple: flamme nue, appareil au gaz en marche ou radiateur électrique en marche)</li> <li>• Ne pas percer ni brûler.</li> <li>• Attention: les frigorigènes peuvent être inodores.</li> </ul>

## FEATURES

### **Powerful Dehumidifying Capability**

Taking advantage of refrigeration technology, the dehumidifier powerfully removes moisture from the air to decrease the humidity level of the room and keep the indoor air dry and comfortable.

### **Unique Portable Design**

The dehumidifier is built to be compact and lightweight. The casters on the bottom of the unit make it easy to move from room to room.

### **Customized Mode**

Allows you to set specific dehumidity percentage and operation mode for most frequently-using rooms in which you are using your dehumidifier (Sleeping Area-55%, Living Area-50% or Basement-45%).

### **Digital Mirage Display**

Easily monitor humidity changes from across the room.

### **Adjustable Humidistat**

Different dehumidification levels can be selected according to different room requirements.

### **Save Money**

This dehumidifier is Energy-Star rated, and could quickly remove moisture from the air without running up your utility bill. Energy Star units not only save energy for the environment, but also cost 30% less to save your money comparing to non-Energy Star units.

### **Automatic Defrost**

When frost builds up on the evaporator coils, the compressor will cycle off and the fan will continue to run until the frost disappears. When the coils are completely defrosted, the compressor or fan (depending on the model) will automatically restart and dehumidification will resume.

## TECHNICAL DATA

Model	VG360
Power Source	115 V / 60 Hz
Power Input (Watts)	295 W
Rated Current (Amps)	2.6 A
MOISTURE REMOVAL CAPACITY(65°F,60%RH)	25 Pints/Day
MOISTURE REMOVAL CAPACITY(80°F,60%RH)	35 Pints/Day
MOISTURE REMOVAL CAPACITY(86°F,80%RH)	50 Pints/Day
MOISTURE REMOVAL CAPACITY(95°F,90%RH)	70 Pints/Day
Bucket Capacity	8.5 Pints
Air Flow Volume (H/M/L)	131/116/101 CFM
Noise Leve	≤53dB(A)
Weight	32 lbs
Dimensions (W × D × H)	13.8" W × 10.2" D × 19.7" H
Energy Star	Yes

- These specifications are for reference only. For actual data, please refer to the rating label on the back of the unit.

## PRODUCT OVERVIEW

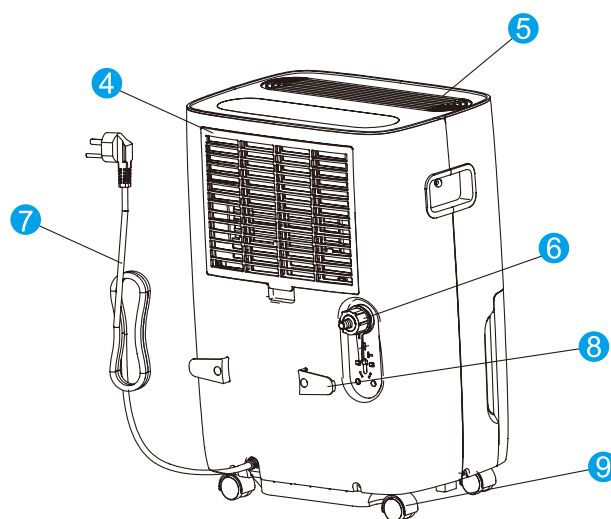
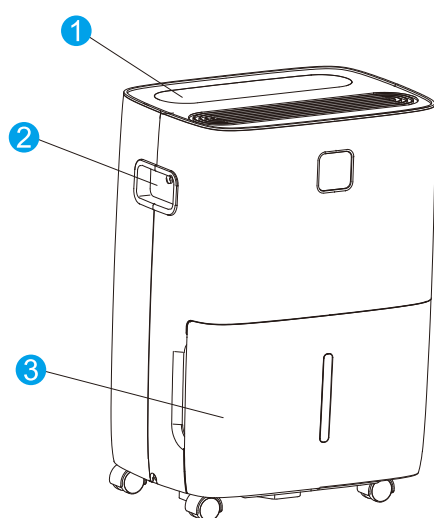

① Control Panel

② Handle

③ Water bucket

④ Air Filter

⑤ Air Outlet Grille

⑥ Drain Hose Outlet

⑦ Power Cord

⑧ Power Cord Buckle

⑨ Caster

⑩ Drain Hose  
Connector



⑪ Cloth Storage Cover

## OPERATING INSTRUCTIONS

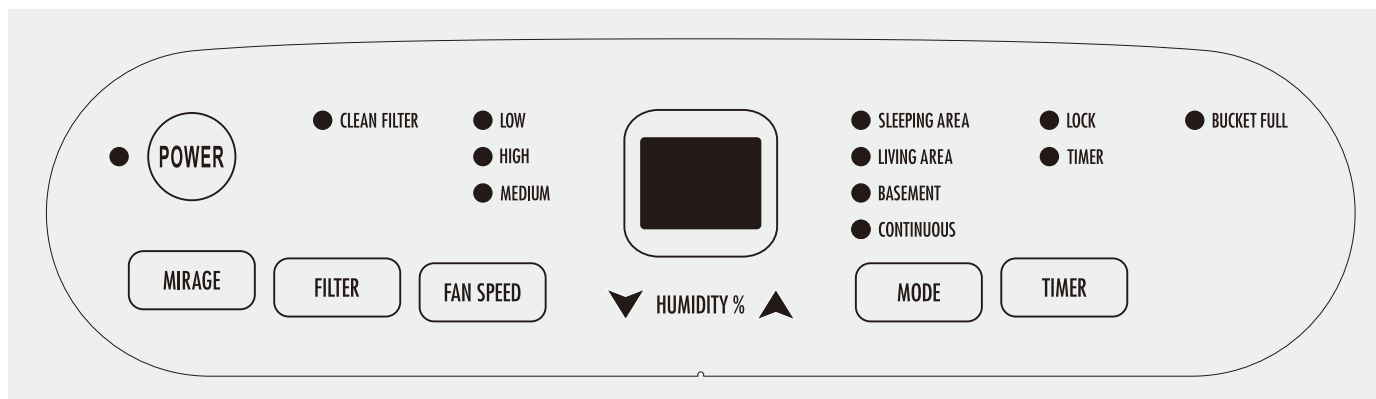

### POWER Button

Press to turn the dehumidifier on and off.

### FILTER Button

When the Filter Alert Light is ON, it is time to clean the filter. Switch the unit OFF and carefully remove the filter from the unit and clean. Replace the filter and switch ON the unit.

### FAN SPEED Button

Press to cycle through High, Medium, or Low fan modes. Higher fan speeds lead to increased moisture removal. When humidity has been reduced or quiet operation is preferred, set the fan to Medium or Low.

### HUMIDITY Button

When the unit is switched ON, the Display Screen shows the current humidity percentage. Press ▲ or ▼ to select your preferred humidity level. The humidity is adjusted in increments of 5% by pressing ▲ or ▼. The adjustable Relative Humidity (RH) range is between 35% RH to 80% RH. If you want the dehumidifier to operate continuously regardless of the room humidity, press the MODE button until you see "CO" on the digital display. This will enable continuous operation and the "Continuous" indicator will light up on the control panel.

**MODE Button**

Preset humidity level settings allow the user to easily move the dehumidifier room-to-room and select the corresponding mode for the location in which the dehumidifier is operating for optimum performance. Press the MODE button to choose from Sleeping Area (55%), Living Area (50%) or Basement (45%).

**TIMER Button**

- **Timer Auto On** - To program the unit to automatically turn on, press the TIMER button when the unit is off. Press ▲ or ▼ to increase or decrease the timer in (30 min increments) 0.5 hours up to 10 hours. After 10 hours, each press of the ▲ or ▼ buttons will increase the timer in 1 hour increment up to 24 hours. Once the desired time is reached, the unit will automatically turn on.
- **Timer Auto Shut - Off** - To program the unit to automatically turn off, press the TIMER button when the unit is on. Each press of the ▲ or ▼ buttons will change the timer setting in (30 min increments) 0.5 hours up to 10 hours. After 10 hours, each press of the ▲ or ▼ buttons will increase or decrease the timer in 1 hour increment up to 24 hours. Once the desired time is over, the unit will automatically power off.
- **Child-Lock Mode** - To lock the control panel, press and hold the TIMER button for 3 seconds. Locking the control panel prevents someone from accidentally changing the settings. When locked, the LOCK indicator will light up. Press and hold the TIMER button for 3 seconds to unlock the control panel.

**MIRAGE Button**

Backlit display on the front of the dehumidifier that shows the actual humidity level in the room to be easily seen from across the room. Press the MIRAGE button to turn the Mirage Display on and once again to turn the Mirage Display off.

## REMOVING COLLECTED WATER

There are 2 options to remove water collected by your dehumidifier.

### Option 1: Drain Bucket

When the drainage bucket is full, the bucket full indicator light will turn on, the operation will stop automatically and the buzzer will beep 3 times to alert the user, that the water need to be emptied from the drainage bucket.

#### Emptying the Drainage bucket

1. Lightly press on the sides of the bucket with both hands and pull the bucket out gently.
2. Drain the collected water.

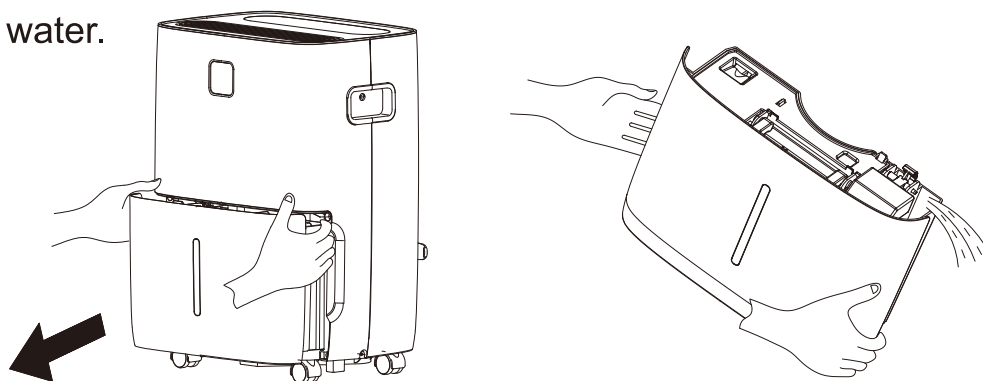

#### NOTE

1. Do not remove the float from the water bucket. The water full sensor will no longer be able to detect the water level correctly without the float and water may leak from the water bucket.
2. If the drainage bucket is dirty, wash it with cold or lukewarm water. Do not use detergent, scouring pads, chemically treated dust cloths, gasoline, benzene, thinner, or other solvents, as these can scratch and damage the bucket and cause water leakage.
3. When replacing the drainage bucket, press the bucket firmly into place with both hands.

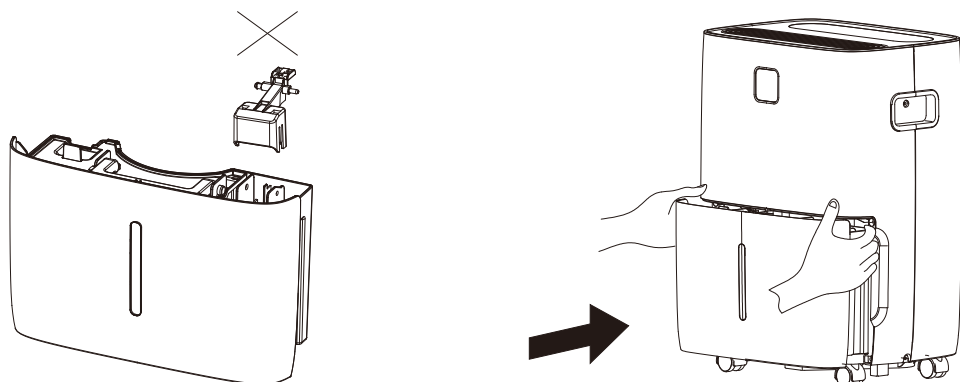

## Option 2: Continuous Drainage

### Garden Hose Installation Setup

Water can be automatically emptied by attaching a garden hose to the continuous drainage port on the back of the dehumidifier. **When installing hoses, drain hose connectors (placed in the bucket) are required.** This will allow the unit to run continuously (depending on the selected humidity level) without having to empty the water bucket. To drain, simply attach a standard garden hose (not included). The thread standard for garden hoses in the US and its territories is known as GHT or "garden hose thread" which has an outer diameter of 11/16 inches (1.0625 inches or 27.0 mm) and a pitch of 11.5 TPI.

1. Place dehumidifier on a level surface
2. Unscrew the cap on the back of the unit to access the garden hose nozzle
3. Thread a garden hose (not included) onto the accessible nozzle, lead to a floor drain and cut to length
4. Make sure that there are no kinks or knots in the garden hose (See picture below)
5. Turn on the unit and press the MODE button until set to CONTINUOUS

### Garden Hose Installation Reference Guide

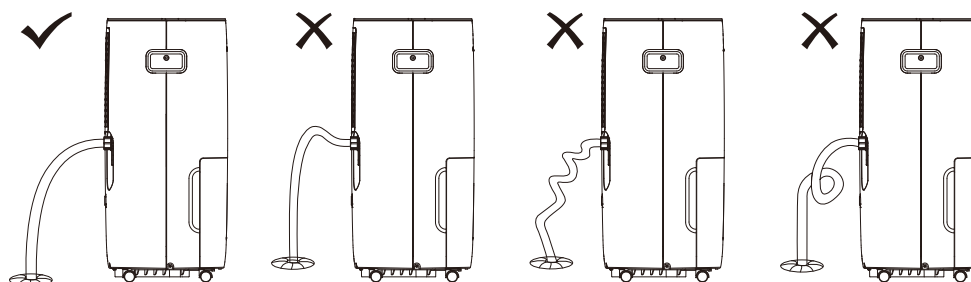

### IMPORTANT NOTES:

Placing the dehumidifier on an uneven surface or improper hose installation may result in water filling up the bucket and cause the unit to shut off. Empty bucket if shut-off occurs, then check dehumidifier location and hose for proper setup. The bucket must be in place and securely seated for the dehumidifier to operate.



## CLEANING & MAINTENANCE

**WARNING:** Always switch OFF the dehumidifier and unplug it from the electrical outlet before attempting any cleaning or maintenance of this product.

### Clean the Grill and Case

Use water and a mild detergent. Do not use bleach or abrasives.

### Clean the bucket

Every few weeks, clean the bucket thoroughly to prevent growth of mold, mildew and bacteria. Partially fill the bucket with clean water and mild detergent. Swish it around in the bucket, empty and rinse.

### Clean the air filter

1. To remove the filter, pull filter outwards.
2. Wash the filter with clean water then dry.
3. Re-install the filter, replace bucket.

### Storing the dehumidifier

1. Before storing the unit, let it rest for one full day so that the system can dry out naturally.
2. Clean the unit, water bucket and air filter.
3. Wrap the cord with the power cord buckle.
4. Cover the unit with a plastic bag.
5. Store the unit upright in a dry, well-ventilated area.

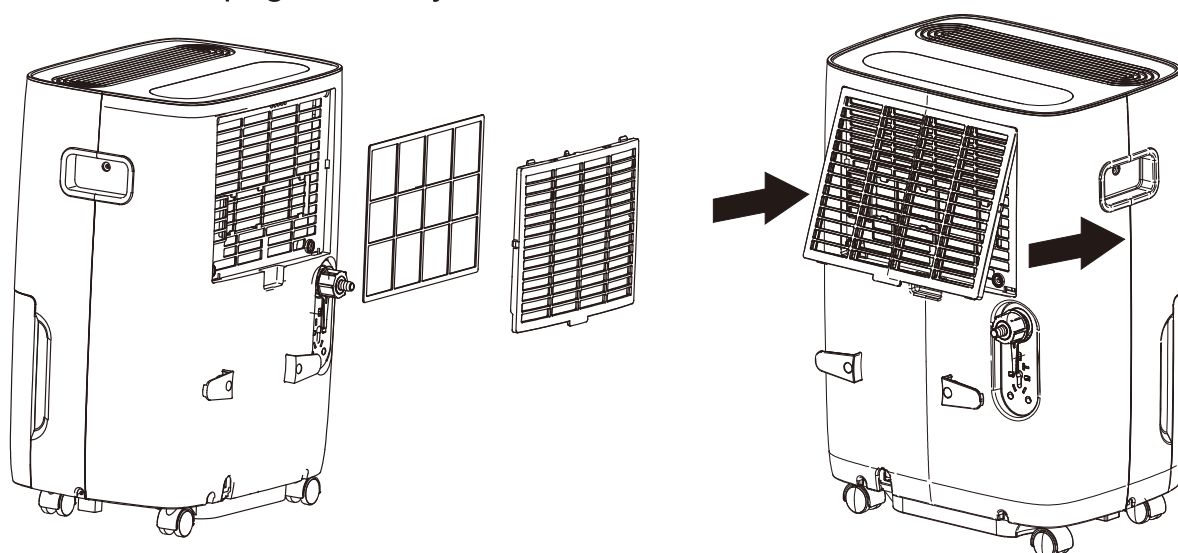

## TROUBLESHOOTING

Problem	Solutions
<b>Dehumidifier does not start</b>	Make sure the dehumidifier's plug is pushed completely into the outlet.
	Check the house fuse / circuit breaker box and replace fuse or reset breaker.
	Dehumidifier has reached its preset level or bucket is full.
	Water bucket is not in the proper position.
	There is a protective time delay (up to 3 min) to prevent trip ping of the compressor overload. For this reason, the unit may not start normal dehumidification for 3 min after it is powered back on.
<b>Dehumidifier does not dry the air as it should</b>	Not enough time to remove the moisture.
	Make sure there are no curtains, blinds, or furniture blocking the front or back of the dehumidifier.
	The humidity control may not be set low enough.
	Check that all doors, windows and other openings are securely closed.
	Room temperature is too low, below 5°C (41°F).
	There is a water vapor source in the room.
<b>The unit makes a loud noise when operating</b>	Air filter may be dirty. Clean filter. Refer to Care and Cleaning section.
	The unit is tilted instead of upright as it should be.
	The floor surface is not level.
<b>Frost appears on the coils</b>	This is normal. The dehumidifier has Auto defrost feature.
<b>Water on floor</b>	Intended to use the bucket to collect water, but the back drain plug is removed.
	Hose to connector or hose connection may be loose.
<b>Pump Mode is on, but water is draining in bucket</b>	Make sure that the included plastic drain tube and nozzle adapter are tightly installed.
<b>Continuous Mode is on, but water is draining in bucket</b>	Garden hose must be used while operating Continuous Mode.

## SELF-DIAGNOSING CODES

CODE	POSSIBLE CAUSE	Resolution
E1	Compressor Overheat Protection	Please contact support@veagaso.com
E2	Condenser Overheat Protection	Please contact support@veagaso.com
EH	Humidity Sensor Malfunction	Please contact support@veagaso.com
E5	Internal Pump Malfunction	Please contact support@veagaso.com