

Smart Water Leak Detector

USER MANUAL



WASSERSTEIN

Thoughtful Products for your Smart Home

In the Box



1 x water sensor



1 x probe cable



1 x holder



1 x 3 volt battery
(in water sensor)



2 x screws



2 x wall anchors

Parts

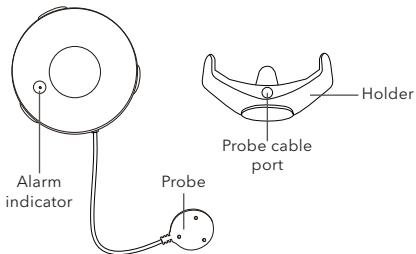

Setup

1. Peel off the cover from the back of the holder to reveal the adhesive tape and screw hole. Place one screw through the front and mount it accordingly.

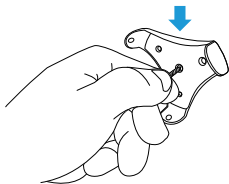
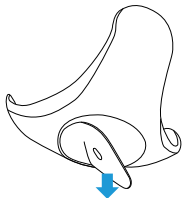

2. Click the water sensor onto the holder. Line up the probe cable port with the indented flange on the bottom of the water sensor.

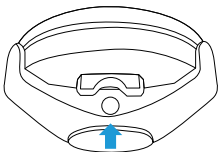

3. Plug the probe cable into the cable port.

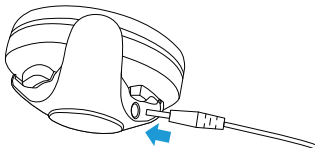

4. Test the water sensor by placing the probe in a small puddle of water. If the water sensor has been installed correctly, it will beep when it touches water.

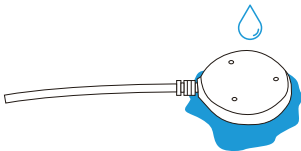

App Setup

Minimum requirements:

- Smartphone or tablet running iOS 9.0 or later / Android 5.0 or later.
- 2.4 GHz WiFi Network (not compatible with 5 GHz connections).
- Upload speed of at least 2 Mbps.

1. Download the App by scanning the QR code or by searching "Wasserstein App" in Google Play Store or the App Store.



2. Sign up for a new account or Login to an existing account.
3. Click "Add Device" or "+" in the top right corner. Then, select "Add Manually" or "Auto Scan".

To use Auto Scan, please enable Bluetooth on your mobile device.

1.

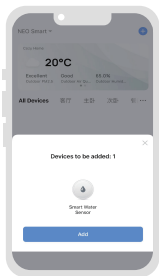

2.

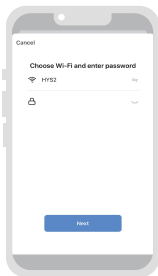

3.

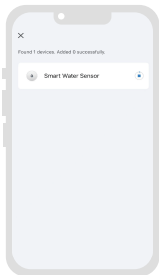

4.

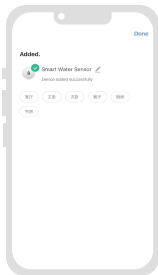

Use the App to control the settings of your Smart Water Sensor, including the alarm and low battery mode, as well as view your device record.

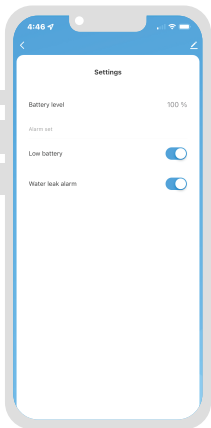
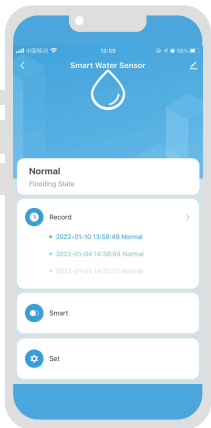

Resetting the Device

1. Open up the water sensor and remove the battery.

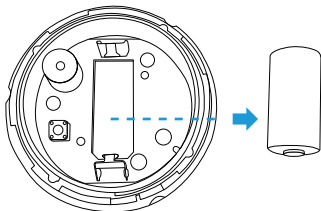

2. Put the battery back in. Press and hold the button until the light starts blinking.

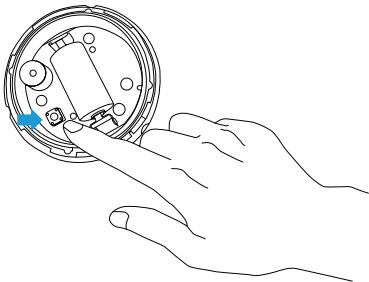

Specifications

Power:	CR123A - 3V
Working Current:	80 -110 mA
Sleep current:	27.8 uA
Wireless type:	2.4 GHz
Wireless range:	147.6 ft
Size:	2.6 x 2.6 x 0.9 in 2.7 x 2.7 x 1.3 in (with holder)
Supported Wi-Fi Standard:	IEEE 802.11b/11bgn mixed/11bg mixed

Get More Support

Scan the QR code below or email us at contact@wasserstein-home.com.

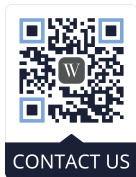

WASSERSTEIN

www.wasserstein-home.com

Wasserstein is a trademark of Dropcases Ltd.

Made in China