

# **Spring assisted knife**

## **GW 6681**

- overall dimensions
- knife specification
- assembly instruction



**MULTIFUNCTIONAL  
SPRING ASSISTED  
FOLDING  
POCKET**

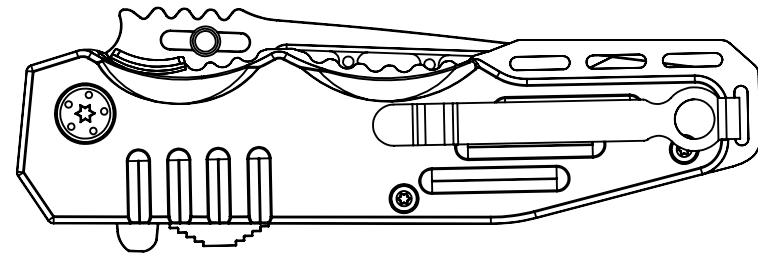
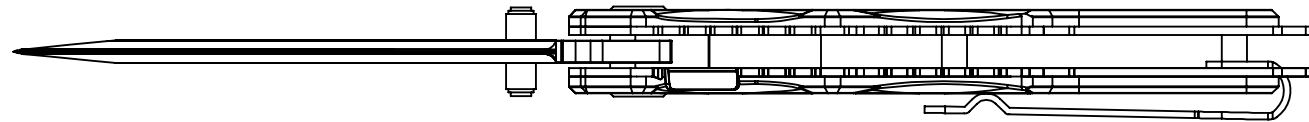
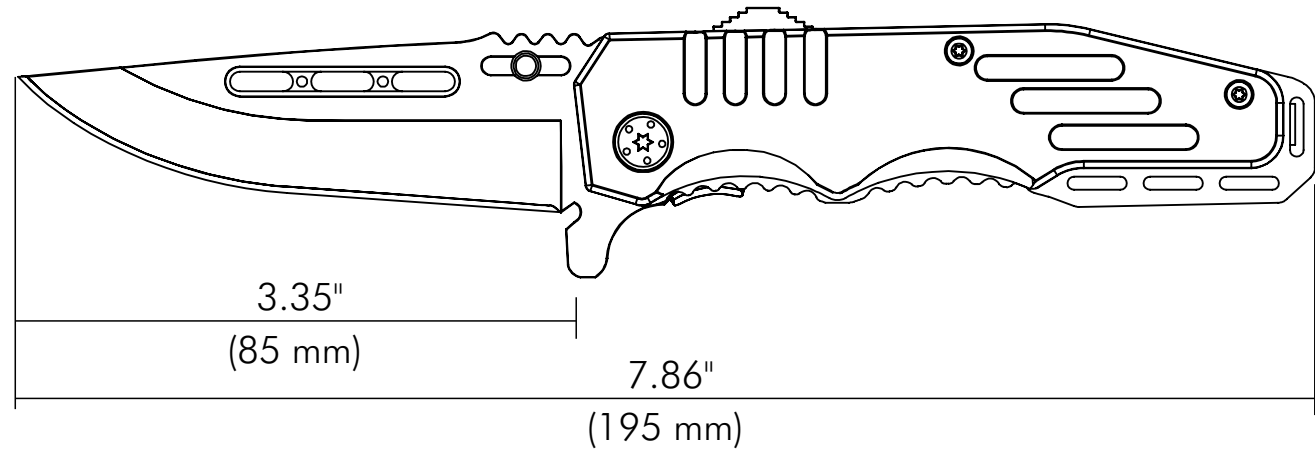

SURFACE OF  
THE BLADE: BLACK OXIDE

HANDLE  
MATERIAL: ALUMINIUM

STEEL MARK: 440C

WEIGHT: 4.30 oz

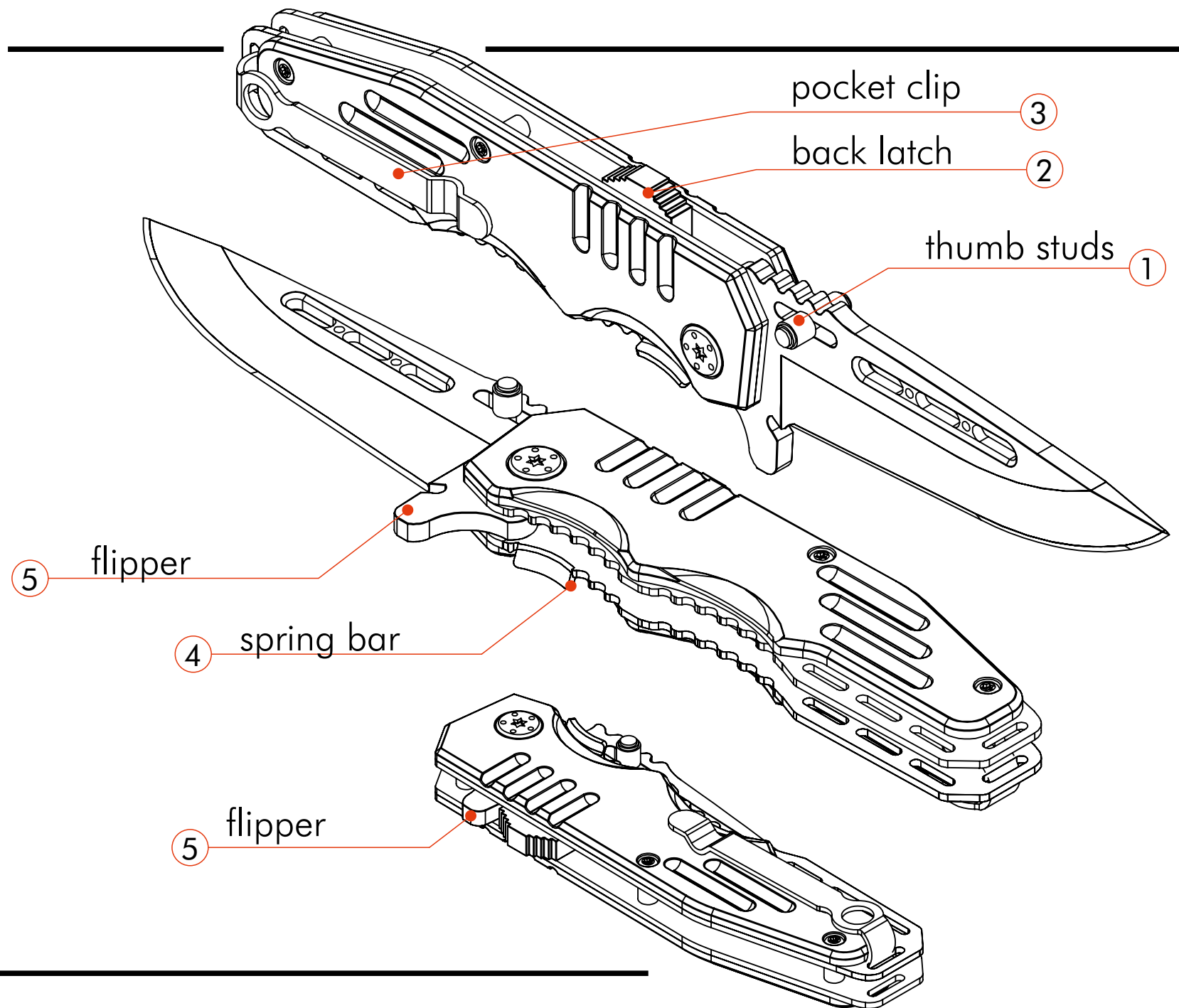
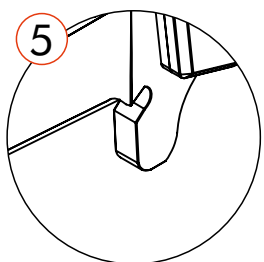
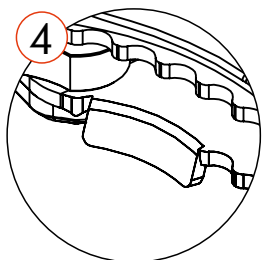
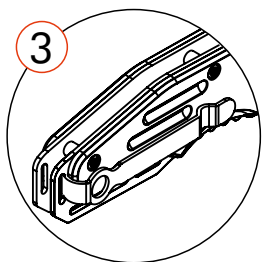
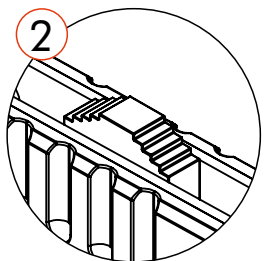
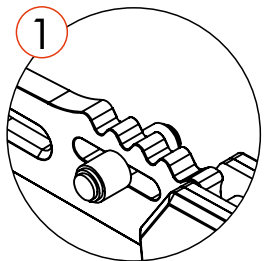

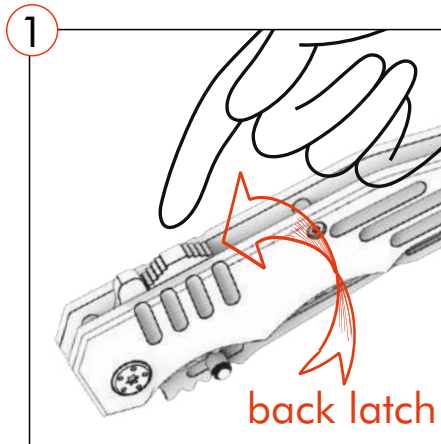

1. Find the back latch.  
Now the knife is closed.

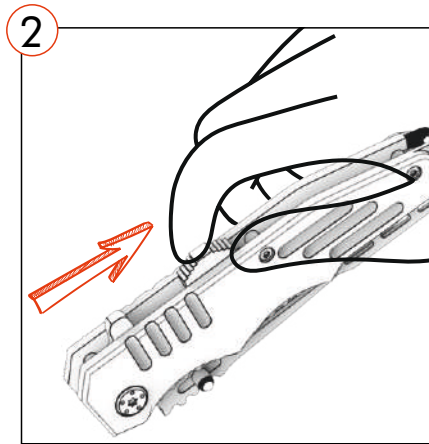

2. Move the back latch  
to open position.

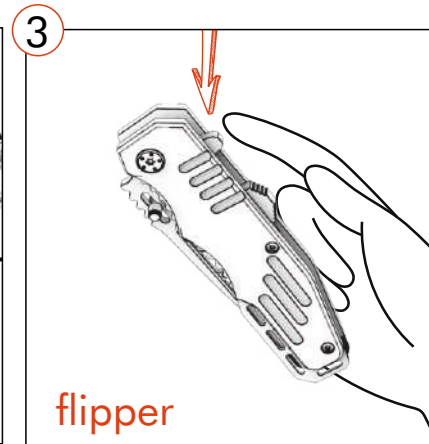

3. Find the flipper and  
press it.

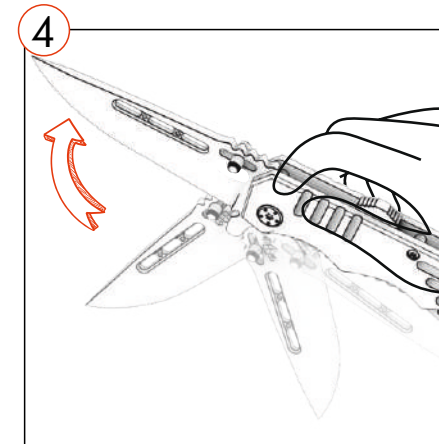

4. Now you can unfolding  
the knife.

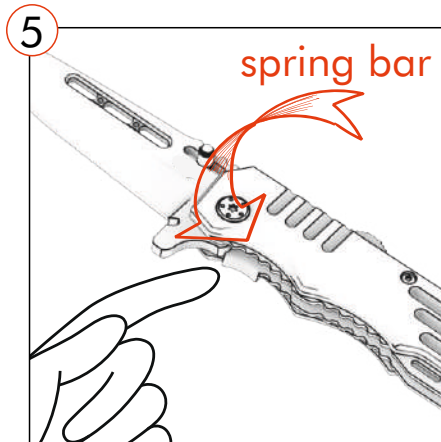

5. Find the spring bar.

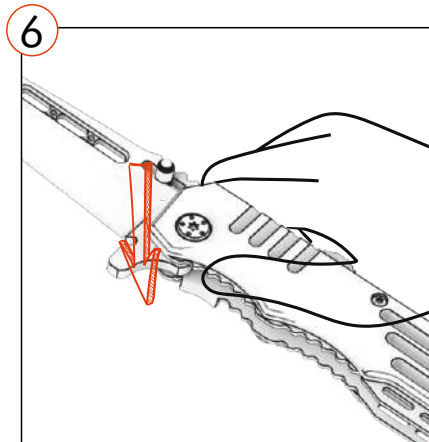

6. Press the spring bar  
toward the clip.

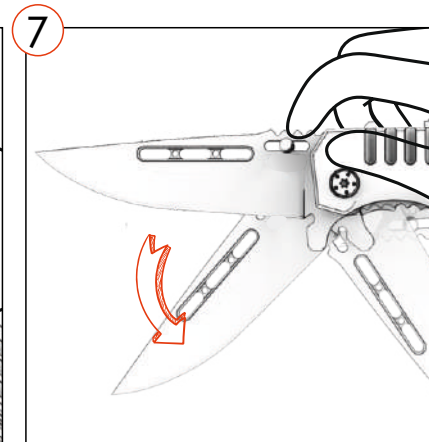

7. Now you can folding  
the knife.

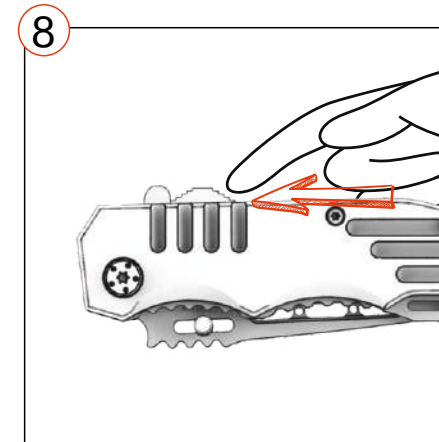

4. Close the back latch

# CAUTION: For users and Bystanders:

- ❗ Sharp Blades. Improper use, chiseling, ice picking, prying, applying force onto back of blade, or contact may result in injury.
  - ❗ Always keep blades away from fingers and body.
  - ❗ When not in use, store in the sheath or a safe place.
  - ❗ Keep out of reach of children.
- 
- ❌ Do not use if blades are dull, bent, chipped, loose at its pivot or otherwise damaged or if the handle is broken or loose.  
Handle with care.
  - ❌ Do not pick it up by the blade. Contact with the hard object can result in blade chipping.
  - ❌ Do not use to strike with or against another tool, hardened nails, or other hard objects.