

KENWOOD

Freestanding Dishwasher KDW60S20/KDW60W20

installation / instructions manual



contents

safety warnings	5
unpacking.....	8
location	9
product overview.....	13
front view	13
rear view	13
upper basket.....	13
lower basket	13
cutlery basket	13
internal view	13
control panel & display window	14
before operating	15
opening the door	15
closing the door	15
items not suitable for use in the dishwasher	15
adding detergent	16
adding rinse aid.....	17
adjusting the rinse aid setting.....	18
testing your water hardness	19
adjusting salt consumption	20
adding salt.....	21
loading the dishwasher.....	22
before loading the dishwasher	22
upper basket.....	23
adjusting the upper basket	23
hinged cup rack	24
Loading the Upper Basket for 12 Place Settings.....	24
Loading the Lower Basket for 12 Place Settings.....	25
Loading the Cutlery Basket for 12 Place Settings	25
loading the dishwasher for maximum efficiency	26
upper basket.....	26
lower basket	26
cutlery basket	27
incorrect loading	27
wash cycle table	28
using the dishwasher.....	29
changing the programme	29
cancelling a programme	29

at the end of the programme	29
switching the dishwasher off	30
delay start.....	30
half load.....	30
tablet option	31
extra hygiene option	31
extra rinse option	31
extra dry option	31
child lock.....	32
cleaning the dishwasher.....	33
external care.....	33
the door and the door seal	33
the control panel.....	33
unloading the dishwasher	33
energy saving tips	33
internal care.....	34
filtering system	34
spray arms.....	35
frost precaution	36
moving the dishwasher.....	36
maintenance for a prolonged period of non-operation.....	36
hints and tips	37
fault codes	37
technical problems	38
disposal of the dishwasher	40
disposal of packing material	40
product fiche and specifications	41

safety warnings

- Read all instructions carefully before using the dishwasher and keep them for future reference.
- Retain the manual. If you pass the dishwasher onto a third party, make sure to include this manual.
- This appliance can be used by children aged from 8 years and above and persons with reduced physical, sensory and mental capabilities, or lack of experience and knowledge if they have been given supervision or instruction concerning use of the appliance in a safe way and understand the hazards involved. Children shall not play with the appliance. Cleaning and user maintenance shall not be made by children without supervision.
- Keep ventilation openings in the dishwasher enclosure clear of obstructions.
- Choose a location for your dishwasher away from heat sources such as radiators or fires.
- Young children should be supervised to ensure that they do not play with the dishwasher.
- Keep mains cable out of reach from children.
- Keep children away from detergents and rinse aids. These may cause chemical burns in the mouth, throat and eyes or asphyxiation.
- Keep children away from the dishwasher when the door is open.
- Switch off water and power and unplug before fitting or removing tools/ attachments, after use and before cleaning.
- Keep your fingers away from moving parts and fitted attachments.
- Never use a damaged machine.
- If the mains cable is damaged, it must be replaced by the manufacturer, its service agent or a qualified technician in order to avoid a hazard.
- Keep the power unit, mains cable and plug away from water.
- Never exceed the maximum capacities.
- 2 people are required to lift this dishwasher.
- Only use the dishwasher for its intended indoor domestic use. The company responsible for this product, DSG Retail Limited, will not accept any liability if the appliance is subject to improper use, or failure to comply with these instructions.
- Do not use with an extension lead or external timer.

WARNING



IT IS HAZARDOUS FOR ANYONE OTHER THAN AUTHORISED SERVICE PERSONNEL TO CARRY OUT SERVICING OF REPAIRS WHICH INVOLVE THE REMOVAL OF COVERS.



TO AVOID THE RISK OF AN ELECTRICAL SHOCK DO NOT ATTEMPT REPAIRS YOURSELF.

- Do not sit or stand on the door or dish rack.
- Do not move your dishwasher by holding the door or its edges. Hold the dishwasher around its sides or base when moving it.
- Do not touch the heating element during or immediately after use.
- Do not operate your dishwasher unless all enclosure panels are properly in place. Open the door very carefully when there is a programme running, as there is a risk of hot water spraying out of the appliance.
- Do not place any heavy objects on the open door. The appliance could tip.
- When loading items to be washed:
 1. Locate sharp items so that they will not damage the door seal;
 2. Warning: Knives and other utensils with sharp points must be loaded in the basket with the sharp points downwards or placed horizontally.
- Do not allow plastic items to come into contact with heating element.
- Check that the detergent receptacle is empty after completion of the wash cycle.
- Do not wash plastic items unless they are marked dishwasher safe or equivalent.
- Use only detergent and rinse aids designed for an automatic dishwasher.
- The mains plug must be made easily accessible or an easily accessible switch must be incorporated in the fixed wiring with at least 3mm contact separation in all poles.
- The door should not be left in the open position since this could present a tripping hazard.
- For energy saving, always remember to switch the dishwasher off when you have finished using it.
- The dishwasher should not be left unattended when in use.
- Remove the door to the washing compartment when removing an old dishwasher from service or discarding it.
- During installation, the power supply cord must not be excessively or dangerously bent or flattened.

- Do not dismantle, repair or modify the Dishwasher. This may invalidate your guarantee and could lead to a malfunction and cause fire or injury.
- Do not tamper with controls.
- The appliance is to be connected to the water mains using new hose sets.
- The maximum number of place settings to be washed is 12.
- The maximum permissible inlet water pressure is 1Mpa, and the minimum permissible inlet water pressure is 0.03Mpa.
- It is recommended to switch off the power and water when the appliance is not in use.
- Capacity - 12 place settings.
- Product dimensions - 850 mm (H) x 598 mm (W) x 598 mm (D)
- For supporting and fixing the appliance see the Installation section.

Earthing Instructions

WARNING: THIS APPLIANCE MUST BE EARTHED.



- This appliance is equipped with a mains cable having an equipment-earthing conductor and an earthing plug.
- The plug must be plugged into an appropriate outlet that is installed and earthed in accordance with local standards and requirements.

installation

Thank you for purchasing your new Kenwood Dishwasher.

These operating instructions will help you use it properly and safely.

We recommend that you spend some time reading this installation/instruction manual in order that you fully understand all the operational features it offers.

Read all the safety instructions carefully before use and keep this installation/instruction manual for future reference.

unpacking

Remove all packaging from the unit. Retain the packaging. If you dispose of it please do so according to local regulations.

The following items are included:

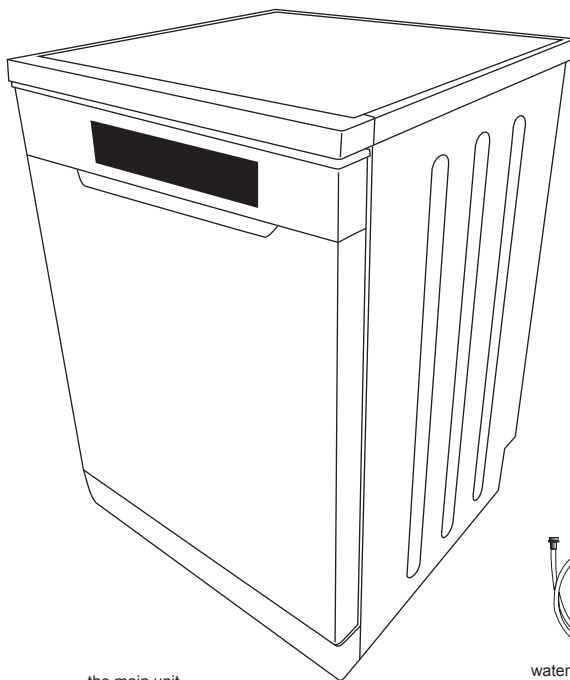

the main unit

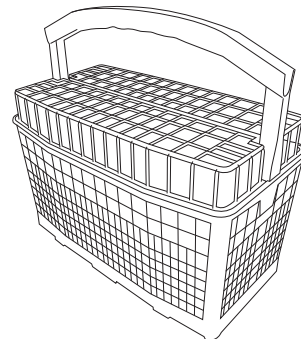

cutlery basket



water supply hose X 1



U-shape hose holder X 1



This product has been wet tested to ensure correct operation. As a result some water may remain inside the unit. This is normal and safe. Remove any water droplets from the exterior if necessary.



If items are missing or damaged please contact Partmaster (UK only).
Tel: 0344 800 3456 for assistance. Parts are available from 10 years after purchase.

* All images are for reference only; please refer to your individual unit for actual item.

installation

location

When selecting a position for your dishwasher you should make sure the installation surface is flat and firm, and the room is well ventilated. Avoid locating your dishwasher near a heat source, e.g. cooker, boiler or radiator. Extreme cold ambient temperatures may also cause the appliance to not perform properly. This dishwasher is not designed for use in a garage or outdoor installation.



All parts removed must be saved to do the reinstallation in the future. Ensure the dishwasher is unplugged and empty. We recommend that 2 people handle the dishwasher during installation.

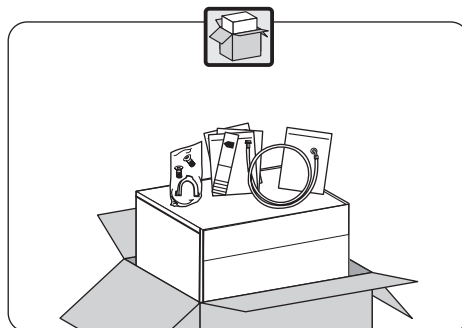

1. Please ensure the dishwasher is installed by a qualified technician. Refer to the tools required (not included).



The supplied door template contains installation information which will assist installation.

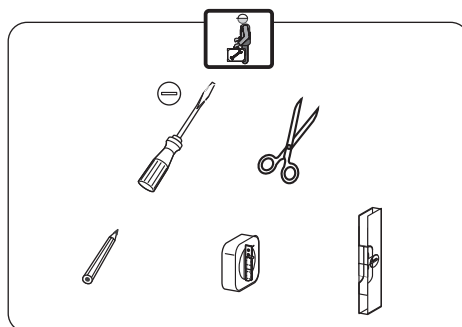

2. Ensure there is sufficient clearance on each side of the unit to allow slight sideways movement for servicing when required. Good levelling is essential for correct closure and sealing of the door. When the unit is correctly levelled, the door should not catch the inner liner on either side of the cabinet. The adjustable feet may be loosened or tightened in order to obtain the optimum levelling of the unit.

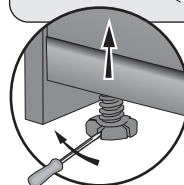
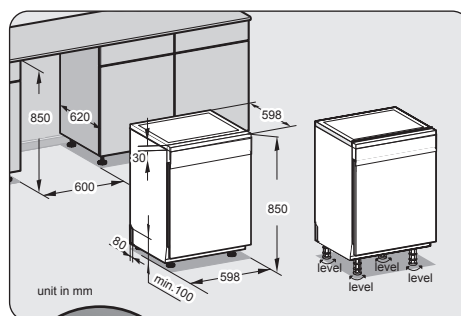

* All images are for reference only; please refer to your individual unit for actual item.

installation

3. Do not connect the unit to the mains socket before installation. Ensure you are not installing the unit right in front of the mains socket. This is to avoid potential damage to the back of the unit.

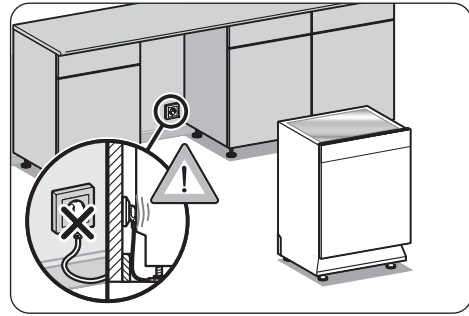

4. Position the dishwasher next to a water tap and a drain. Ensure the water inlet and drain hoses are not kinked or squashed. The unit must not stand on the mains cable.

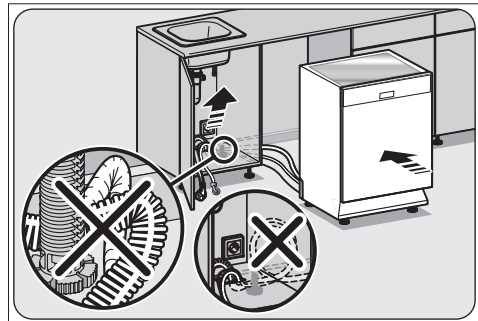

* All images are for reference only; please refer to your individual unit for actual item.

installation

5. Make sure your plumbing is suitable for use with the dishwasher. If in doubt contact a qualified plumber. This unit **MUST BE** connected to **COLD WATER MAINS** using the new water supply hose. **OLD HOSE SETS MUST NOT BE RE-USED.** The water pressure from the water mains needs to be at a minimum of 0.04 MPa and a maximum of 1.00MPa.

- Connect one end of the water supply hose to your dishwasher, and then connect the other end of the hose to your water mains. Please ensure the black rubber seal is in place.
- After connecting the hose, turn on your water mains and check for leaks.
- Connect the dishwasher to the mains socket.

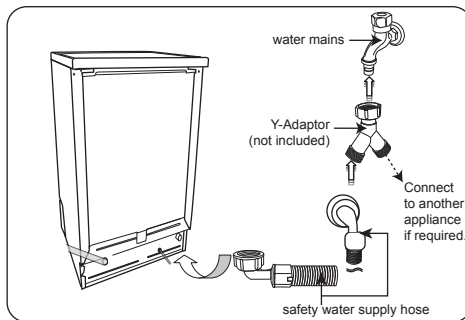

You may use a Y-adaptor (not included) for an additional water feed for another appliance, for example a washing machine. This is only applicable to the cold water mains. A Y-adaptor is available from most DIY stores.

- Do not bend or kink your drain hose.

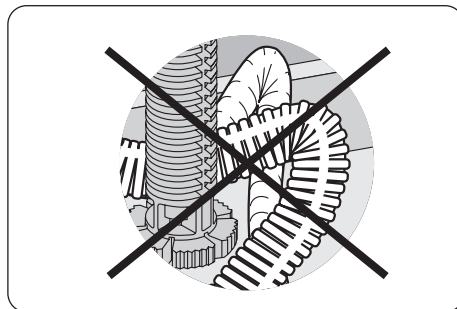

- You may use the U-shaped drain hose holder to secure your drain hose and to avoid kinking it.

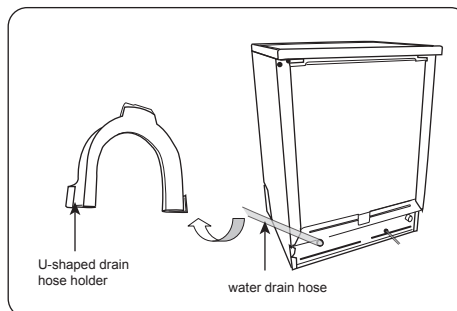

* All images are for reference only; please refer to your individual unit for actual item.

installation

- Secure the water drain hose to the waste pipe to avoid it coming off during the washing process.



- The waste pipe must only be connected to the foul drains and not the surface water drainage system.
- The water drain hose should be placed between 40 cm and 100 cm from the floor level and must not be extended, otherwise the unit may not be able to expel the waste water properly.

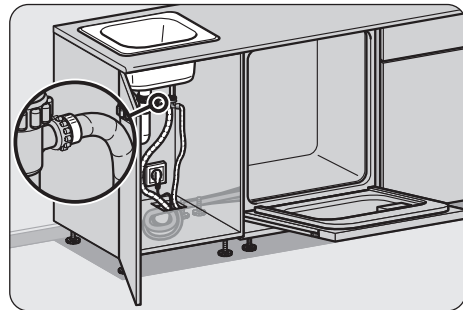
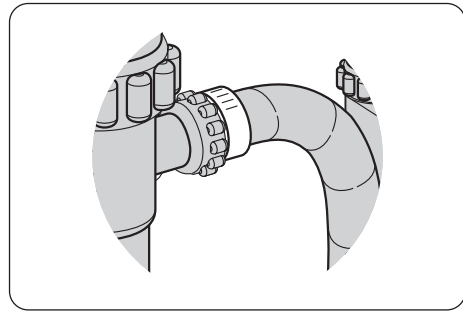

* All images are for reference only; please refer to your individual unit for actual item.

product overview

front view

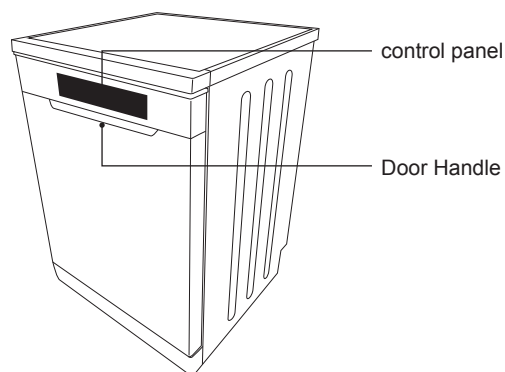

rear view

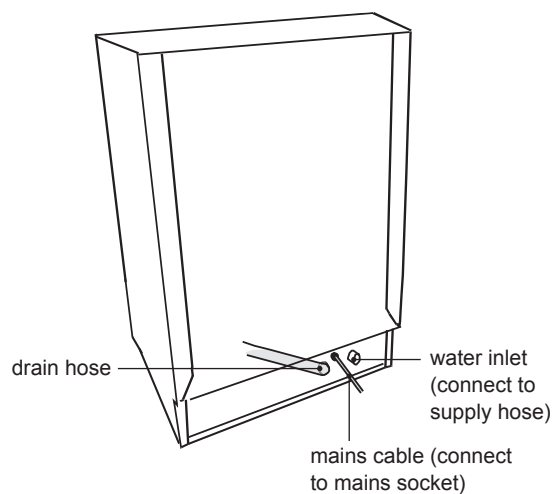

upper basket

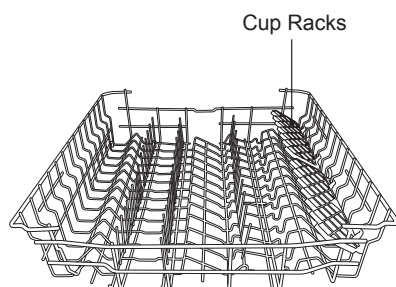

lower basket

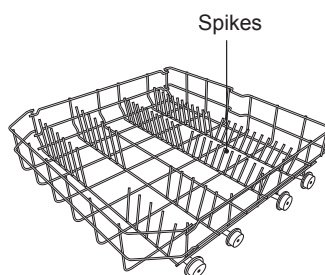

cutlery basket

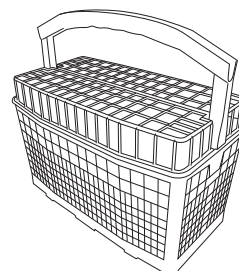

internal view

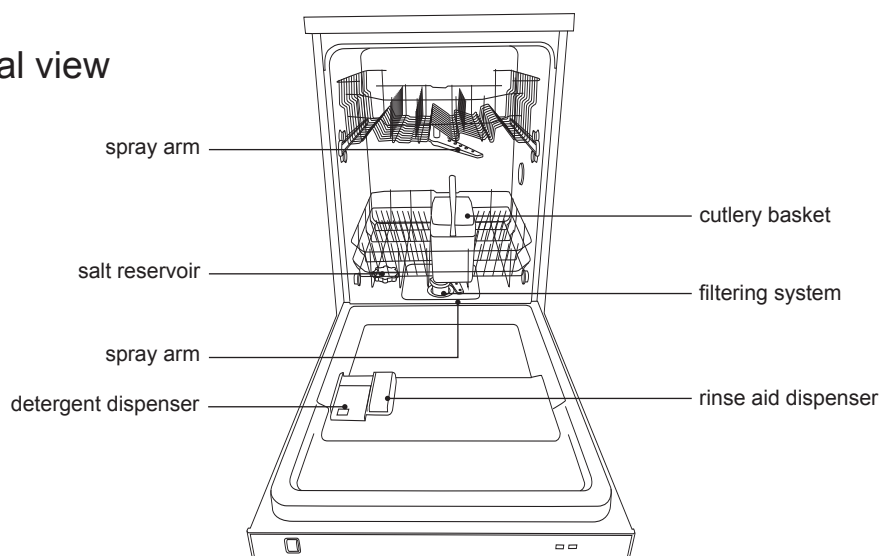

* All images are for reference only; please refer to your individual unit for actual item.

control panel & display window

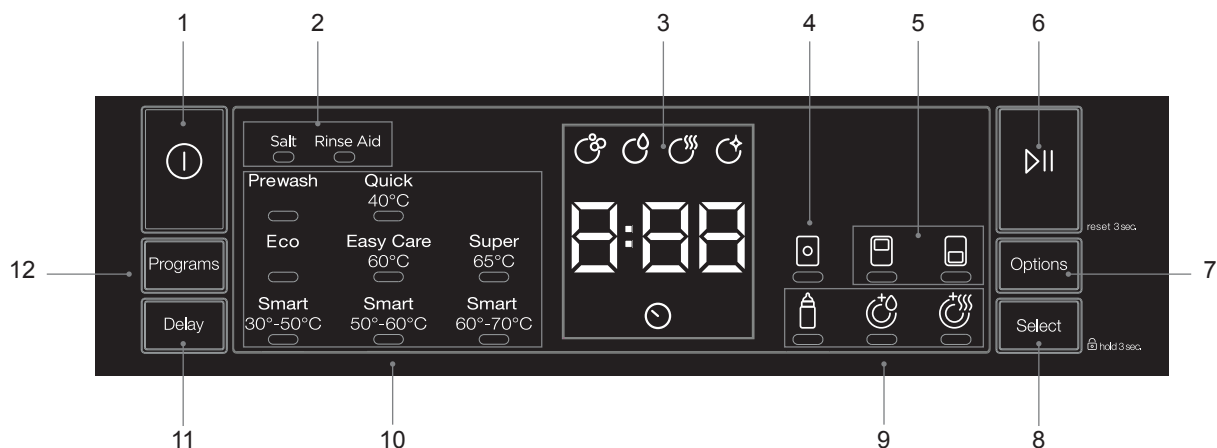

1. ON/OFF button

- turns the dishwasher on and off.

2. salt low warning indicator light

- illuminates when there is not sufficient softening salt in the dishwasher.

rinse aid low indicator light

- illuminates when there is not sufficient rinse aid in the dishwasher.

3. display

- displays programme time.
- shows the wash progress.
- shows if a delay time is set.

4. tablet indicator

- displays when the tablet option is selected.

5. half load indicator LED

- displays when half load has been selected. Top or bottom basket.

6. play/pause button

- starts or pauses a programme. When paused the selected programme indicator will flash.
- press and hold to reset a programme.

7. options button

- press to scroll through the available extra options.

8. select button

- press to select extra options.
- press and hold for 3 seconds to lock the display panel.

9. extra hygiene indicator light

- illuminates when extra hygiene has been selected.

extra rinse indicator light

- illuminates when extra rinse options has been selected.

extra dry indicator light

- illuminates when extra dry options has been selected.

10. programme indicator LEDs

- displays selected programme..

11. delay timer button

- delays the start of a preset washing programme by up to 23 hours.
- each press increases the delay time by 1 hour.

12. programme button

- selects your required washing programme.

* All images are for reference only; please refer to your individual unit for actual item.

before operating

opening the door

- Pull the door handle.
- If the door is opened during operation, first open the door slightly to avoid water spillage.



If the door is opened during operation, all functions are automatically interrupted.

closing the door

- After loading the dishes, push the baskets fully into the dishwasher.
- Lift the door upwards and push until it clicks into position.
- Do not slam the dishwasher door.

items not suitable for use in the dishwasher

When purchasing new crockery and cutlery, please make sure it is dishwasher-proof. Some items are not suitable for dishwashers.

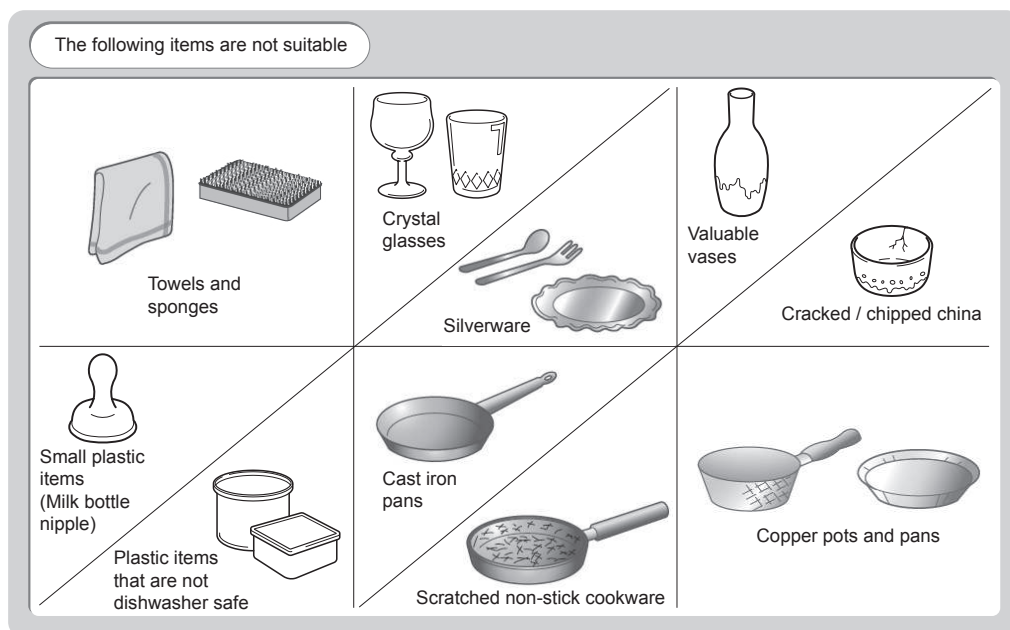

- Wooden cutlery and crockery or items with wooden parts may discolour and fade. The glue used in these items is not dishwasher-proof and wooden handles may come loose after being washed in a dishwasher.
- Craft items, antiques, valuable vases and decorative glassware are also not suitable for dishwashers.
- Plastic items (e.g. tupperware) which are not heat resistant may melt or lose shape due to the high temperature in the dishwasher.
- Copper, brass, tin and aluminium items may discolour or become matt.
- Clouding may occur on glasses and delicate glassware after frequent washing. Do not wash delicate glassware or glassware containing lead crystal, in a dishwasher. Wash delicate glassware by hand instead.
- Silver and aluminium parts have a tendency to discolour during washing. Residues like egg white, egg yolk and mustard often cause discolouring and staining on silver. Therefore, please clean the residues from silver immediately after use.

* All images are for reference only; please refer to your individual unit for actual item.

adding detergent

Only use detergents specifically designed for use in dishwashers. To be more environmentally friendly, please use no more than the correct amount of detergent. Fill the detergent dispenser with detergent power or tablet.



- Keep detergents and bleaches out of the reach of children.
- Irritating to eyes.
- Avoid contact with eyes. In case of contact with eyes, rinse immediately with plenty of water and seek medical advice.
- If swallowed, seek medical advice immediately.

Please follow the steps below to fill the detergent dispenser.

1. Push the button on the lid of the detergent dispenser the flap with slide open.

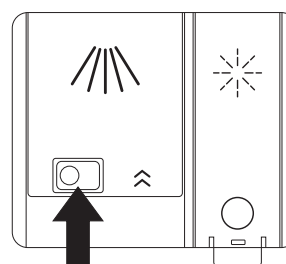

Push to open

2. Fill the detergent dispenser with detergent powder or insert the detergent tablet. The marking indicates the filling level.

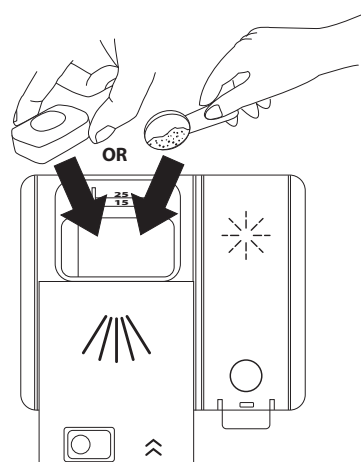

Slide to close

3. Slide the lid firmly so that it clicks into place.

* All images are for reference only; please refer to your individual unit for actual item.

adding rinse aid

Rinse aid helps to ensure that washed crockery dries quickly and is free of marks. Only use rinse aid that is made for domestic dishwashers. This model is designed to use liquid rinse aids only. The correct amount needed will be dispensed automatically.

Please follow the steps below to fill the rinse aid reservoir.

1. Open the rinse aid compartment.
 2. Fill with the compartment with rinse aid up to the MAX level mark. Be careful not to overfill the reservoir. Wipe up any spills.
 3. Close the rinse aid compartment.
- The rinse aid warning light will illuminate when the reservoir need refilling.

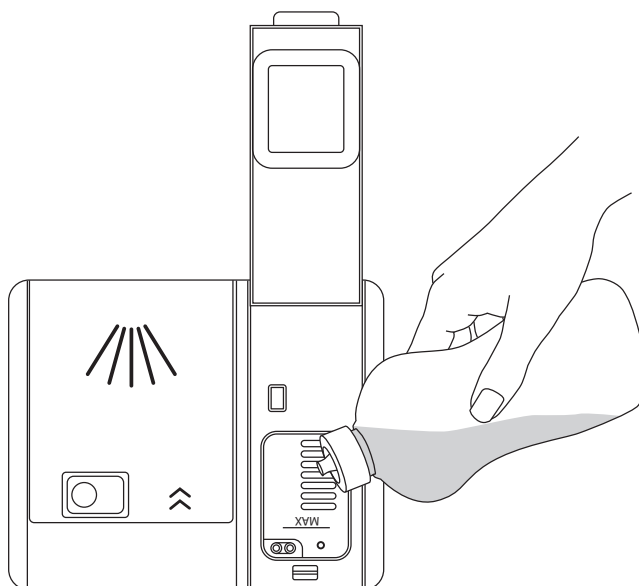

- If the water in your area is soft, you may not need rinse aid as it may cause white film to develop on your dishes.



- If you decide to use a detergent tablet, you may not need to add rinse aid into the rinse aid reservoir.

* All images are for reference only; please refer to your individual unit for actual item.

adjusting the rinse aid setting

The rinse aid reservoir has five settings. Both the recommended setting and the factory setting is "4." If the dishes are not drying properly or are spotted, adjust to the next higher number until your dishes are spot-free. If you find they are spotted with rinse aid when the cycle has finished, reduce the level.

1. Immediately after turning the Dishwasher on, press and hold the P button for 5 seconds until you see 'rA' in the display.

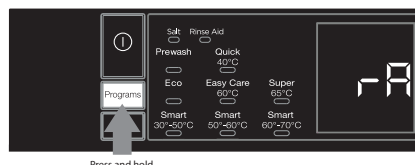

2. Press the P button to scroll through the levels. The r number will change with each press. See the table below for details.
3. Switch the Dishwasher OFF to save the setting.

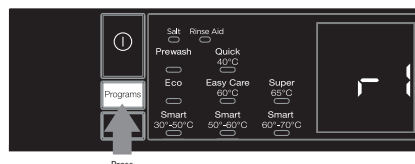







rinse aid level	rinse aid dose	rinse aid level indicator
1	No rinse aid released	
2	1 dose is dispensed	
3	2 doses are dispensed	
4	3 doses are dispensed	
5	4 doses are dispensed	

testing your water hardness

The washing effectiveness of your machine depends on the softness of the tap water. For this reason, your machine is equipped with a system that reduces the hardness in mains water supply. The washing effectiveness will increase when the system is correctly set. To find out the water hardness level of water in your area, contact your local water board or determine water hardness level by using the test strip (if available).

1. Open the testing strip.
2. Run your cold tap for a minute then fill a cup/glass with water.
3. Dip the testing strip into the water for 1 second.
4. Shake off the excess water and wait 1 minute for the result.

results table

Level 1		No Lime
Level 2		Very low lime content
Level 3		Low lime content
Level 4		Medium lime content
Level 5		Medium/High lime content
Level 6		High lime content

Now you have your water hardness result you can set your dishwashers salt consumption level to match.

adjusting salt consumption

Salt consumption must be adjusted to correspond to the water hardness level in your area. If you don't know how hard the water in your home is, please ask the company that supplies water in your area.

It is recommended that adjustments should be made in accordance with the following chart.

water hardness level	German hardness dH	French hardness dF	British hardness dE	hardness level indicator
1	0-5	0-9	0-6	
2	6-11	10-20	7-14	
3	12-17	21-30	15-21	
4	18-22	31-40	22-28	
5	23-31	41-55	29-39	
6	32-50	56-90	40-63	



1°dh (German degree) = 0.18 mmol/l
 1°fh (French degree) = 0.1 mmol/l
 1°Clark (British degree) = 0.142 mmol/l

To adjust your dishwasher for the local water hardness, please follow these steps and refer to the table above.

1. With the dishwasher switched on press and hold the P button SL will appear in the display.

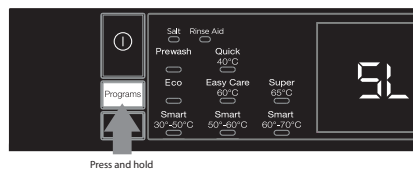

2. Press the P button to scroll through the levels. The L number will change with each press. See the table above for details.

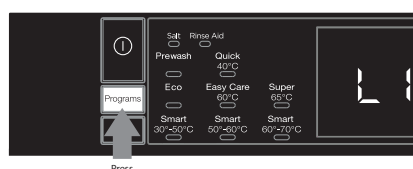

3. To save your setting switch the dishwasher off by pressing the POWER button.

adding salt

If you live in a hard water area deposits may form on your dishes and utensils. Using salt softens the water and reduces the formation of deposits.

Please follow the steps below to fill the salt reservoir. The water hardness level will also need to be set.

1. Remove the lower basket and turn the reservoir cap anticlockwise.
2. Pour in approximately 1 kg of dishwasher salt.
3. Fill the reservoir with water until it overflows (first use only).
4. Clean any excess salt from around the reservoir opening and then screw the cap on again firmly.
5. Run the "Rinse" programme P1 immediately (without any crockery in the dishwasher) to remove any traces of salt from the compartment.

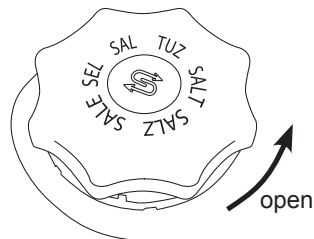

- The salt low warning indicator on the control panel will illuminate when the reservoir is running out of salt and requires refilling.
- Once refilled, the salt low warning indicator will cease to illuminate within a few days, depending on how quickly the salt dissolves.



- Do not use everyday table salt or cooking salt as they contain insoluble substances which could damage the dishwasher.
- Do not pour detergent into the salt container. This will damage the dishwasher.

* All images are for reference only; please refer to your individual unit for actual item.

loading the dishwasher

before loading the dishwasher

Please observe the following notes before loading your cutlery and crockery into the basket.

- Remove lipstick stains and any food residues from crockery and dishes. Rinse if necessary.

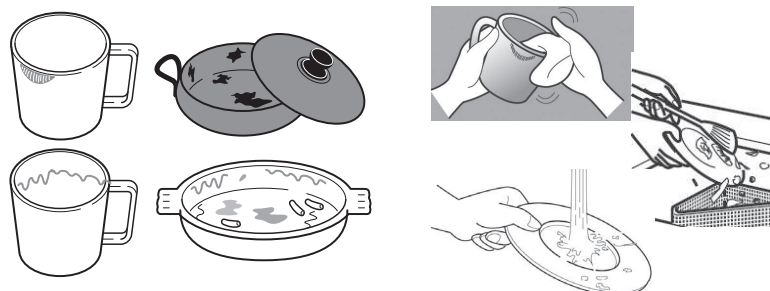

- Dishes and cutlery must not lay inside one another, or cover each other.
- Load your cutlery and crockery so that water can access all surfaces.

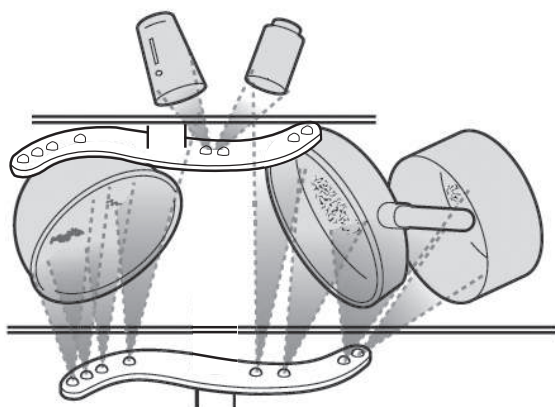

- Ensure all items are securely positioned.
- Hollow items such as cups, glasses, pans, etc. must be placed upside down in the basket.
- Wide based items should be placed at an angle so that water can run off them freely.
- The spray arms must not be blocked by items which are too tall or hang through the baskets. If in doubt, test for free movement by manually rotating the spray arms.
- Ensure that small items cannot fall through the holders in the baskets.



Do not wash items soiled with ash, sand, wax, lubricating grease or paint in the dishwasher. Ash does not dissolve and can distribute in the dishwasher. Wax, sand, lubricating grease and paint can cause damage to the dishwasher.

* All images are for reference only; please refer to your individual unit for actual item.



For safety reasons, do not operate the dishwasher without the upper and lower baskets in place.

upper basket

Use the upper basket for small and lightweight items such as cups, saucers, glasses, dessert bowls, etc. Shallow pans or casserole dishes can also be placed in the upper basket.

Long items such as soup ladles, mixing spoons and long knives should be placed lying down across the front of the upper basket.

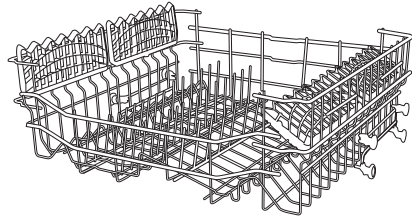

adjusting the upper basket

More space can be created for large items on the upper or lower baskets by adjusting the height of the upper basket.

To adjust the height of the upper basket:

1. Push back the rail stops on both sides.
2. Slide the basket out from the rails and replace at the desired height.
3. Replace the rail stops to their original positions.

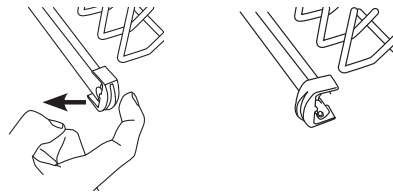

Position of upper basket	Maximum plate diameter	
	Top basket	Bottom basket
Upper position	190 mm	300 mm
Lower position	240 mm	250 mm

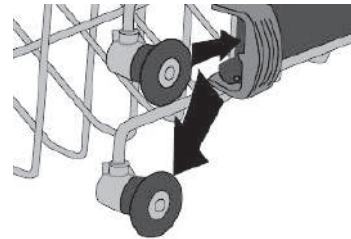

* All images are for reference only; please refer to your individual unit for actual item.

hinged cup rack

The cup racks on the upper basket can be lifted up or removed to make room for taller items e.g. you can lean tall glasses against them.



To prevent water dripping from the upper basket onto the dishes in the lower basket, we recommend that you empty the lower basket first.

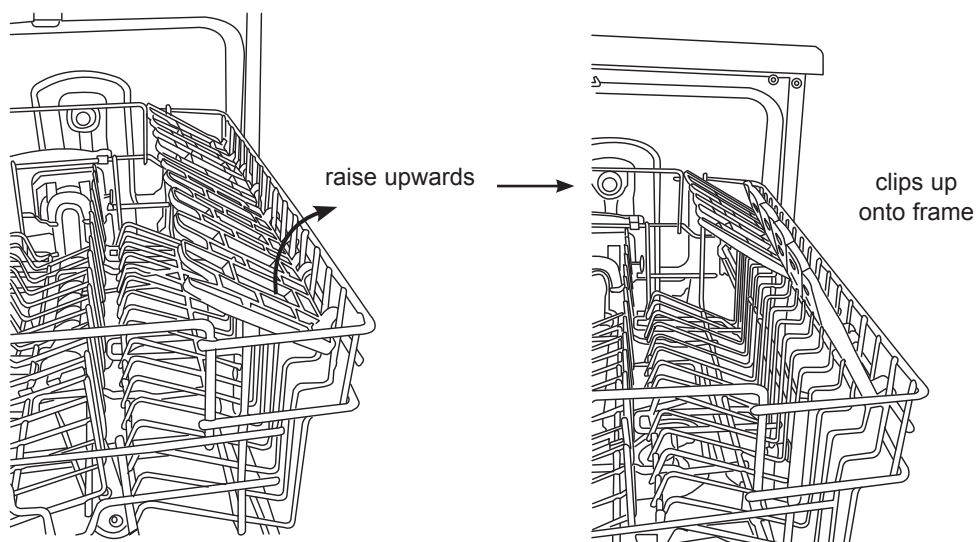

Loading the Upper Basket for 12 Place Settings

For optimum loading of crockery in the upper basket, please refer to the below table and image.

Number	Item
1	Cups
2	Large serving bowl
3	Medium serving bowl
4	Glasses
5	Saucers
6	Small serving bowl

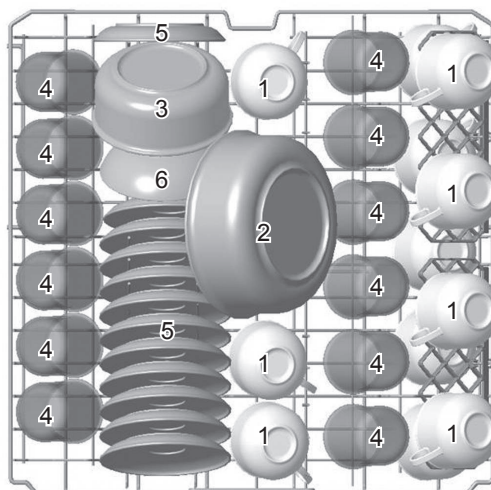

* All images are for reference only; please refer to your individual unit for actual item.

Loading the Lower Basket for 12 Place Settings

For optimum loading of crockery in the lower basket, please refer to the below table and image.

Number	Item
1	Oval platter
2	Dessert dishes
3	Soup plates
4	Dinner plates
5	Cutlery basket

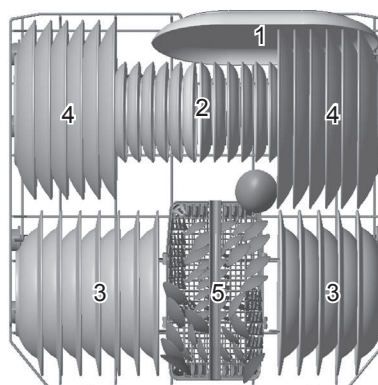

Cutlery Basket

Loading the Cutlery Basket for 12 Place Settings

To make unloading much easier, cutlery should be grouped in zones and placed in the cutlery basket. Please refer to the table below for placement method.

Number	Item
1	Spoons
2	Forks
3	Knives
4	Teaspoons
5	Dessert spoons
6	Gravy ladle
7	Serving spoons
8	Serving fork

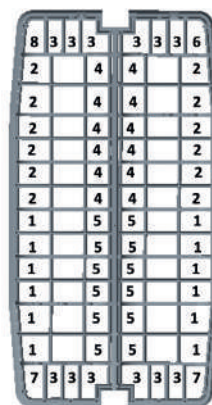

- Do not let any items extend through the bottom of the baskets.
- To avoid the risk of injury, load knives and forks with handles upwards. Do not hold them by the sharp edge.
- The cutlery basket comes with covers which are designed so you can load cutlery into the appropriate slots. If you use the basket without the covers, washing results may be reduced.
- Ensure the covers are securely fixed to the basket before operation.
- To comply with Standards of Performance, all cutlery must be loaded according to the instructions in this manual.

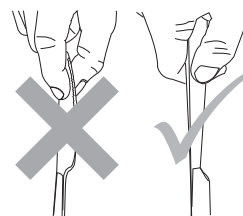

* All images are for reference only; please refer to your individual unit for actual item.

loading the dishwasher for maximum efficiency

The loading diagrams in this section show you how the dishwasher was loaded to achieve its energy certification. Loading your dishwasher like this will deliver the best wash results and lowest energy consumption.

upper basket

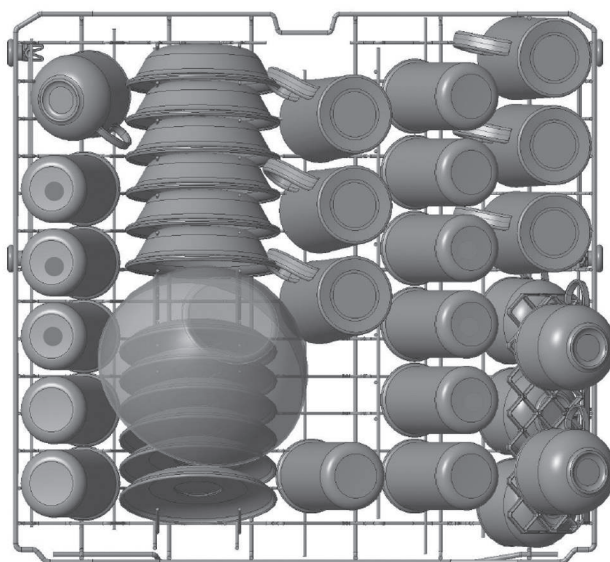

lower basket

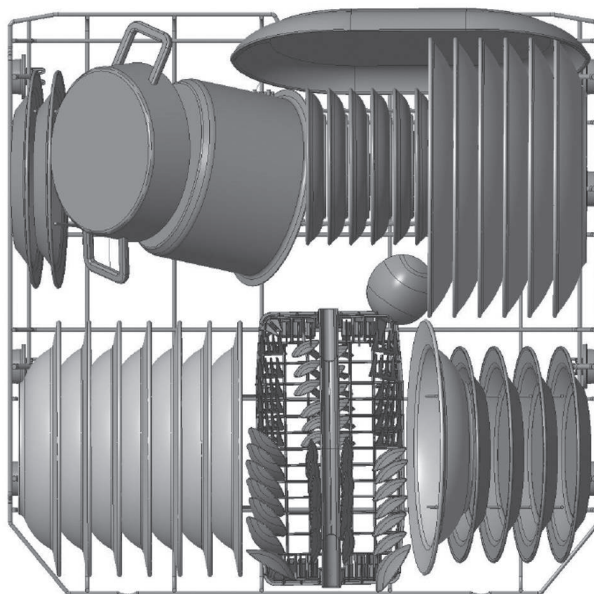

cutlery basket

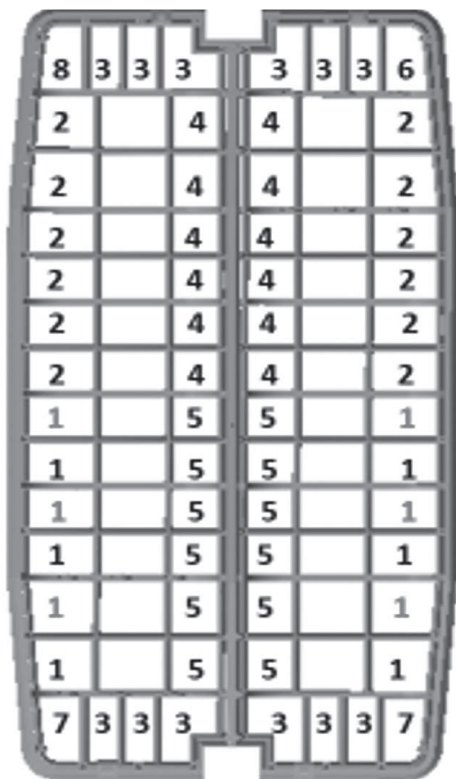

incorrect loading

Incorrect loading can cause poor washing and drying performance and increase energy and water consumption.

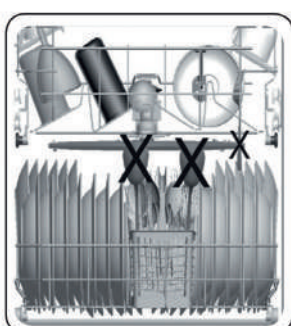
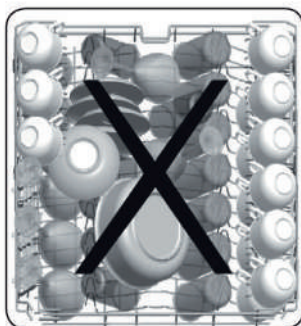

- Place items the correct way around so water will drain off them.
- Don't stack items on top of each other.
- Check the wash bars can rotate and they are not been impeded.

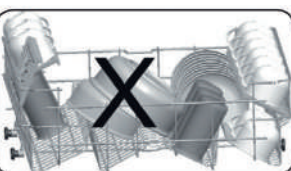

wash cycle table

programme	cycle selection information	level of soil	detergent amount	running time (hours:min.)	energy consumption (kWh)	water consumption (L)
P1 Prewash	Suitable to rinse dishes that you plan to wash later. Using Prewash will increase energy and water consumption and is therefore not recommended.	Light	None	00:15	-	4.2
P2 Quick 30'	Suitable for lightly soiled dishes and quick wash.	Light	25g	00:30	--	10.9
P3 Eco	Standard program for normally soiled daily using dishes with reduced energy and water consumptions.	Medium	25g	03:42	0,923	9.0
P4 Easy Care 60°C	Coffee, milk, tea, cold meats, vegetables not dried on.	Medium	25g	01:34	--	14.4
P5 Super 50'	Suitable for normally soiled daily dishes with faster program.	Heavy	25g	00:50	--	9.5
P6 Smart 30°C - 50°C	Auto program for normally soiled delicate dishes.	Medium	25g	01:09 - 01:32	--	10.6 - 17.7
P7 Smart 50°C - 60°C	Auto program for normally soiled dishes.	Medium	25g	01:29 - 02:01	--	10.9 - 18.5
P8 Smart 60°C - 70°C	Auto program for heavily soiled dishes.	Heavy	25g	01:37 - 02:58	--	11.8 - 24.0

The values declared above are the values obtained under laboratory conditions according to relevant standards. These values can change depending on conditions of product's use and environment (network tension, water pressure, water input temperature and environment temperature).



Condensing dry technology

- Energy is saved by drying the dishes using the remaining heat after the last rinse cycle.
- Wash cycle times are extended due to this drying method.

using the dishwasher

1. Ensure the unit is connected to the mains power and the water supply is on.
2. Open the door and load the baskets. It is recommended that the lower basket is loaded first, and then the upper basket. Push the baskets back into the dishwasher.
3. Pour in the detergent or place the detergent tablet in the detergent compartment and close firmly afterwards.
4. Press the **ON/OFF** button.
5. Select the wash cycle programme based on the loading and soil requirements. Please refer to the section "Wash Cycle Table".
6. The display will indicate the selected programme.
7. Close the dishwasher door. A click should be heard when the door is closed correctly. Do not slam the door.
8. Press the **START/PAUSE** button, the washing cycle will begin shortly.



If you open the dishwasher door during the washing cycle and then close it, the dishwasher will continue the current washing programme after 10 seconds.

changing the programme

To change the programme once a washing cycle has already started, follow the steps below.

1. Press the **START/PAUSE** button to pause the programme.
2. Open the door slightly to avoid water spillage before opening the door fully. Check if the unit has dispensed the detergent or detergent tablet. This will depend on how long the washing cycle was running for. The last selected programme will appear on the display.
3. If the detergent dispenser lid is opened, we suggest that you allow the wash cycle to finish.
4. If the detergent dispenser lid is still closed, press and the **PROGRAMS** button to select another programme and close the dishwasher door.
5. Press the **START/PAUSE** button and the new washing cycle will start shortly.

cancelling a programme

You can cancel a programme at any time.

1. Press and hold the **START/PAUSE** button for 3 seconds, the programme will stop and the dishwasher will discharge any water, this will take around 30 seconds.

at the end of the programme

At the end of the programme, the dishwasher will beep and the word **End** will be displayed.

switching the dishwasher off

To save energy, remember to switch the dishwasher off using the ① **ON/OFF** button. The dishwasher will continue to use electricity until it is switched off with the ① **ON/OFF** button.



If the dishwasher is not going to be used for a long period of time, e.g., you are going on holiday, please disconnect the dishwasher from the mains supply and switch off the water supply.

delay start

You can set a delay timer on your dishwasher, you can delay the start of a programme for up to 23 hours.

1. After selecting your desired programme, press the **DELAY** button, continue pressing the button to increase the delay time up to 23 hours. To deactivate a delay time either continue pressing the button until 0 is displayed or switch the dishwasher OFF.

Close the door and press **START/PAUSE** the programme will start, after your selected delay time has expired.

half load

A half load option can be selected if you do not have enough dishes for a full load. There are three options that can be selected: lower basket, upper basket and both baskets. This will help save hot water and electricity. To use these functions, please follow the steps below.

1. Open the dishwasher door and load your soiled dishes and crockery onto the basket. Remember if you want to only wash the top or bottom baskets then just load your chosen basket.
2. Press the **ON/OFF** button to turn on the dishwasher.
3. Select your preferred programme.
4. Half load options:

Upper Basket

If you have only a few dishes in the upper basket, press the **OPTIONS** button until the top Basket is highlighted then press the **SELECT** button to confirm that option.

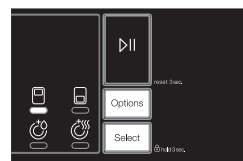

Lower Basket

If you have only a few dishes in the lower baskets, press the **OPTIONS** button until the lower Basket is highlighted then press the **SELECT** button to confirm that option.

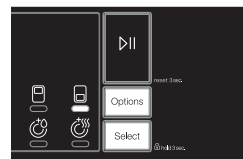

Both Baskets

If you have only a few dishes in both lower and upper baskets, press the **OPTIONS** button until the top basket is highlighted then press the **SELECT** button to confirm that option. Then press the **OPTIONS** button until the bottom basket is highlighted then press the **SELECT** button to confirm that option. Both upper and lower indicators should be lit.

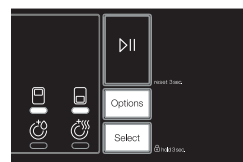

5. Press **START/PAUSE** the programme will start.

tablet option

When you are using an all-in-one tablet you can select the Tablet option. This will just use the tablet to clean the crockery, salt and rinse aid will not be dispensed.

1. Press the **OPTIONS** button until the tablet option is highlighted.
2. Press the **SELECT** button to confirm the option.
3. Press the **START/PAUSE** button to start your programme.

Adding an extra option will effect the programme time and energy usage.



extra hygiene option

You can add an extra hygiene option to wash programmes. Extra hygiene will increase the temperature and duration of the wash ensuring more hygienic wash results.

1. Press the **OPTIONS** button until the extra hygiene option is highlighted.
2. Press the **SELECT** button to confirm the option.
3. Press the **START/PAUSE** button to start your programme.

Adding an extra option will effect the programme time and energy usage.

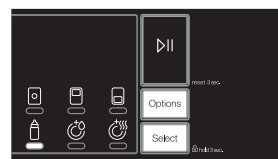

extra rinse option

You can add an extra rinse option to wash programmes. Extra rinse will add extra rinse cycles to the wash ensuring your crockery is spotlessly clean.

1. Press the **OPTIONS** button until the extra rinse option is highlighted.
2. Press the **SELECT** button to confirm the option.
3. Press the **START/PAUSE** button to start your programme.

Adding an extra option will effect the programme time and energy usage.



extra dry option

You can add an extra dry option to wash programmes. Extra Dry will add an extra heating and drying stage to the wash ensuring your dishes are dryer at the end of a wash cycle.

1. Press the **OPTIONS** button until the extra dry option is highlighted.
2. Press the **SELECT** button to confirm the option.
3. Press the **START/PAUSE** button to start your programme.

Adding an extra option will effect the programme time and energy usage.

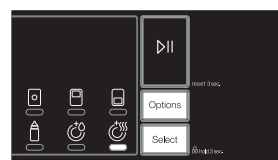

child lock

The buttons on your dishwasher can be locked to prevent a child changing any settings while the dishwasher is operating.

1. Select a programme and start it.
2. To activate the child lock press and hold the **SELECT** button for 3 seconds. All the indicators will flash and 'CL' will briefly appear in the display. The display will now be locked, if a button is pressed 'CL' will appear in the display to indicate the child lock is active.
3. To switch off the child lock press and hold the **SELECT** button for 3 seconds, all the indicators will flash and you'll be able to use all the buttons again.

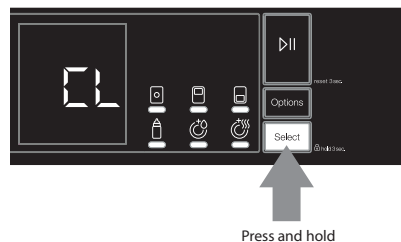

unloading the dishwasher

Allowing dishes to cool down before unloading is important as dishes tend to break and chip more easily when they are hot.

Unload the lower basket first, followed by the cutlery basket and then the upper basket. This will prevent water drops from the upper basket from falling onto the dishes in the lower basket.

energy saving tips

- Eco programme is suitable to clean normally soiled tableware, for this use, it is the most efficient programme in terms of its combined energy and water consumption, and that it is used to assess compliance with the EU ecodesign legislation.
- Washing tableware in a household dishwasher usually consumes less energy and water in the use phase than hand dishwashing when the household dishwasher is used according to the manufacturer's instructions.
- Short programs do not include drying.
- To assist drying, we recommend slightly opening the door after a cycle is complete.
- Use the half load option if you're only washing a small amount of dishes, this will reduce the energy consumption and water usage.
- Always load the dishwasher correctly. Loading the dishwasher incorrectly could result in poor wash results and more energy consumption (see the 'loading the dishwasher' section for correct loading procedure).

cleaning the dishwasher

external care

the door and the door seal

- Clean the door seals regularly with a soft damp cloth to remove food deposits.
- When the dishwasher is being loaded, food and drink residues may drip onto the sides of the dishwasher door. These surfaces are outside the wash cabinet and are not accessed by water from the spray arms. Any deposits should be wiped off before the door is closed.

the control panel

If cleaning is required, the control panel should be wiped with a soft damp cloth ONLY.



- To avoid penetration of water into the door lock and electrical components, do not use a spray cleaner of any kind.
 - Never use abrasive cleaners or scouring pads on the outer surfaces because they may scratch the finish. Some paper towels may also scratch or leave marks on the surface.
-

internal care

filtering system

The filtering system in the base of the wash cabinet retains coarse debris from the washing cycle. The collected coarse debris may cause the filters to clog. Check the condition of the filters regularly and clean them if necessary under running water.

Follow the steps below to clean the filters in the wash cabinet.

1. Ensure the dishwasher is switched off.
2. Turn the coarse filter anti-clockwise and gently lift it out.

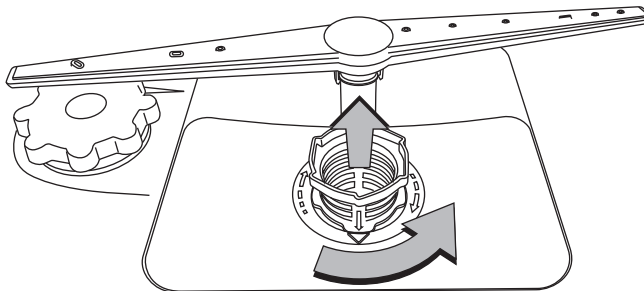

3. Gently lift the metal filter and pull out.

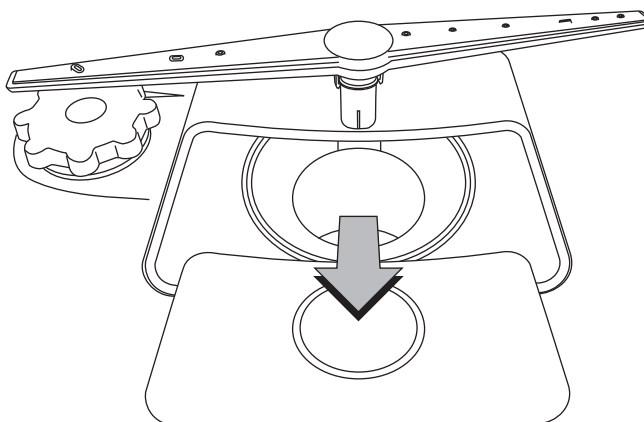

4. The centre of the filter can be removed by gently pulling it apart. Rinse all the filters under running water, including the filter cylinder, and then refit all filters in the reverse order.
5. Carefully refit the main filter.
6. Gently turn the coarse filter in clockwise direction until the arrows align and it clicks into place.

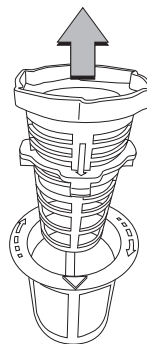

- Do not over tighten the filters.
- Put the filters back in sequence securely, otherwise coarse debris could get into the system and cause a blockage.
- **NEVER** use the dishwasher without the filters in place. Improper replacement of the filters may reduce the performance level of the appliance and damage dishes and utensils.

* All images are for reference only; please refer to your individual unit for actual item.

spray arms

Particles of food can get stuck in the spray arm jets and block them. They should be checked and cleaned regularly.

1. Ensure the dishwasher is switched off.
2. Check the holes in the upper and lower spray arms for clogging. If there is any clogging, remove the spray arms and clean them under running water.
3. The lower spray arm can be removed by pulling it upwards, while the upper spray arm nut can be removed by turning the nut anticlockwise.
4. Be sure that the nut is perfectly tightened when refitting the upper spray arm.

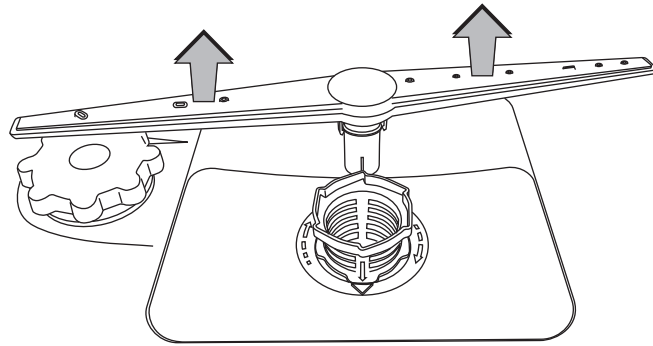

frost precaution

Avoid placing the dishwasher in a location where the temperature is below 0°C. If your appliance is left in an unheated place over the winter, you are advised to:

1. Disconnect the unit from the water inlet.
2. Turn on the unit. Select any washing cycle and let it run for 1 minute only. This will allow all the excessive water that remains in the unit to drain out.
3. Disconnect from the mains.
4. Empty the dishwasher.
5. Close the dishwasher's door.
6. Disconnect the unit from the water drain. Use a suitable receptacle to catch any residual water in the pipes.

Should you encounter any difficulties with the above steps, please ask a service technician for assistance.

moving the dishwasher

If you have to move the unit, for instance due to moving house, you are advised to:

1. Disconnect the dishwasher from the mains.
2. Disconnect the unit from the water inlet and drain. Use a suitable receptacle to catch the water.
3. Remove the unit from the current location with the hoses discharged.
4. Pull the unit out together with the hoses.



- Avoid over tilting the unit during transportation.
 - We recommend that 2 people handle the dishwasher during installation.
-

maintenance for a prolonged period of non-operation

If you are not going to use the unit for a prolonged period of time, you are advised to:

1. Disconnect the dishwasher from the mains.
2. Disconnect the dishwasher from the water inlet and drain. Use a suitable receptacle to catch any residual water in the pipes.
3. Slightly open the door to prevent unpleasant smells building up in the compartment.
4. Ensure the washing compartment of the dishwasher is clean.

Should you encounter difficulties to do the above steps, please ask a service technician for assistance.

hints and tips



- Repairs should only be carried out by a qualified technician in strict accordance with current local and national safety regulations. Unauthorised or incorrect repairs could cause personal injury or damage to the unit.
- Before calling for service, please refer to Hints and Tips to solve some general problems by yourself.

fault codes

Fault Code	Possible Causes	Remedy
FF	Inadequate water supply	<ul style="list-style-type: none">• Make sure the water input tap is totally open and that there is no water cut.• Close the water input tap, separate the water input hose from the tap and clean the filter at the connection end of the hose.• Restart your machine, contact your service agent if the error resumes.
F5	Pressure system failure	<ul style="list-style-type: none">• Contact your service agent.
F3	Shut off valve fault	<ul style="list-style-type: none">• Close the tap.• Contact your service agent.
F2	The waste water in the machine cannot be discharged	<ul style="list-style-type: none">• Water discharge hose is clogged.• The filters of your machine might be clogged.• Power off-on your machine and activate the program cancellation command.• If the error continues, contact your service agent.
F8	Intended water temperature could not be reached faulty heater	<ul style="list-style-type: none">• Contact your service agent.
F1	Alarm is active against water overflow	<ul style="list-style-type: none">• Power off your machine and close the tap.• Contact your service agent.
FE	Faulty electronic card	<ul style="list-style-type: none">• Contact your service agent.
F7	Overheating	<ul style="list-style-type: none">• Contact your service agent.
F9	Divisor position error	<ul style="list-style-type: none">• Contact your service agent.
F6	Faulty heater sensor	<ul style="list-style-type: none">• Contact your service agent.
HI	High voltage failure	<ul style="list-style-type: none">• Contact your service agent.
LO	Low voltage failure	<ul style="list-style-type: none">• Contact your service agent.

technical problems

problem	possible causes	remedy
The dishwasher does not start.	Your Dishwasher is not plugged in.	Plug your Dishwasher in.
	Your Dishwasher is not switched on.	Switch your Dishwasher on by pressing the On/Off button.
	Fuse blown.	Check your indoor fuses.
	Water inlet tap is closed.	Turn on the water inlet tap.
	Your Dishwasher door is open.	Close the Dishwasher door.
	Water inlet hose and machine filters are clogged.	Check the water inlet hose and machine filters and make sure they are not clogged.
Water remains inside the machine.	Water drain hose is clogged or twisted.	Check the drain hose, then either clean or untwist it.
	The filters are clogged.	Clean the filters.
	The programme is not finished yet.	Wait until the programme is finished.
Machine stops during washing.	Power failure.	Check mains power.
	Water inlet failure.	Check water tap.
Knocking noise in the wash cabinet.	A spray arms is knocking against an item in a basket.	Interrupt the programme and rearrange the items which are obstructing the spray arm. See the section "Loading the dishwasher".
	Dishes incorrectly placed.	
Partial food wastes remain on the dishes.	Dishes placed incorrectly, sprayed water not reaching affected dishes.	Do not overload baskets.
	Dishes leaning each another.	Place dishes as instructed in the section on loading your dishwasher.
	Not enough detergent used.	Use the correct amount of detergent, as instructed in the programme table.
	Wrong wash programme selected.	Use the information in the programme table to select the most appropriate programme.
	Spray arms clogged with food waste.	Clean the holes in the spray arms with thin objects.
	Filters or water drain pump clogged or filter misplaced.	Check the drain hose and filters are correctly fitted.

problem	possible causes	remedy
Dishes, cutlery and glasses are not dry.	The rinse aid reservoir is almost empty or amount of rinse aid may be insufficient.	Replenish the reservoir, adjust the rinse aid dispenser dial to a higher setting or change the brand of rinse aid.
	Crockery was taken out of the dishwasher too soon.	Leave the crockery in the dishwasher until you hear the audible sound.
White residue is visible on cutlery and crockery, clouding occurs on glassware; film can be wiped off.	Not enough rinse aid was used.	Replenish the reservoir, adjust the rinse aid dispenser dial to a higher setting or change the brand of rinse aid.
	There is not enough salt in the salt reservoir.	Fill the salt reservoir.
	The salt reservoir cap has not been screwed on correctly.	Ensure the cap is screwed back on correctly.
	Unsuitable detergent has been used.	Change your detergent. Use a dishwasher standard powder detergent or tablet.
Glassware is dull and discoloured; film cannot be wiped off.	The glassware is not dishwasher proof. The surfaces are affected.	Wash the non-dishwasher proof glassware by hand instead.
Tea or lipstick stains have not been completely removed.	The wash temperature of the selected programme was too low.	Select a programme with a higher wash temperature.
	The bleaching effect of the detergent used is too low.	Change your detergent.
	Forgot to pre-rinse or remove the stains with napkin prior washing.	Pre-rinse or remove the stains with napkin prior washing.
Rust stains form on the dishes.	Stainless-steel quality of the dishes is insufficient.	Use only dishwasher-proof sets.
	High level of salt in wash water.	Adjust the water hardness level using water hardness table.
	Salt compartment cap not closed properly.	Check that the salt compartment cap is closed properly.
	Too much salt spilled in the Dishwasher while filling it with salt.	Use funnel while filling salt to the compartment to avoid spillage.
Detergent remains in the detergent compartment.	Detergent was added when the detergent compartment was wet.	Make sure detergent compartment is dry before use.
None of the buttons work.	Child lock is active.	Switch the child lock off.

disposal of the dishwasher

- When disposing of your old dishwasher, first make it unusable. Disconnect from the electricity and water suppliers, cut off the cable and the plug from the cable. Make the door lock inoperative, so that children cannot accidentally shut themselves in. Make appropriate arrangements for the disposal of the dishwasher.
- At the end of its working life, the product must not be disposed of as urban waste. It must be taken to a special local authority differentiated waste collection centre or to a dealer providing this service. Disposing of a household appliance separately avoids possible negative consequences for the environment and health deriving from an inappropriate disposal and enables the constituent materials to be recovered to obtain significant savings in energy and resources. As a reminder of the need to dispose of household appliances separately, the product is marked with a crossed-out wheeled dustbin.
- Please ensure that it presents no danger to children while being stored for disposal.

disposal of packing material

Please dispose of the plastic wrappings and bags safely and keep out of the reach of babies and young children.

product fiche and specifications

Brand	Kenwood
Model	KDW60S20/KDW60W20
Product Type	Dishwasher
Mass of the Appliance	46kg
Dimensions	850 mm (H) x 598 mm (W) x 598 mm (D)
Capacity	12 Place Settings
Water Pressure Required	0.03 - 1.00MPa
Rated Voltage	230-240V~50Hz
Off Mode Power Consumption	0.5 W
Left-on Mode Power Consumption	1.00 W
Mounting	Freestanding

Features and specifications are subject to change without prior notice.



To view energy information about to your product scan the QR code on your Energy Label.

All the support you need.

currys.co.uk

UK: 0344 561 1234

Ireland: 1890 818 575

Partmaster
_____.co.uk

Visit Partmaster.co.uk today for the easiest way to buy electrical spares and accessories. With over 1 million spares and accessories available we can deliver direct to your door the very next day. Visit www.partmaster.co.uk or call **0344 800 3456** (UK customers only) Calls charged at National Rate.



The symbol on the product or its packaging indicates that this product must not be disposed of with your other household waste. Instead, it is your responsibility to dispose of your waste equipment by handing it over to a designated collection point for the recycling of waste electrical and electronic equipment. The separate collection and recycling of your waste equipment at the time of disposal will help conserve natural resources and ensure that it is recycled in a manner that protects human health and the environment.

For more information about where you can drop off your waste for recycling, please contact your local authority, or where you purchased your product.

DSG Retail Ltd. (co. no. 504877)
1 Portal Way, London, W3 6RS, UK

EU Representative
DSG Retail Ireland Ltd (259460)
3rd Floor Office Suite
Omni Park SC, Santry, Dublin 9, Republic of Ireland

Manufactured for DSG Retail Limited under Licence from Fisher & Paykel Appliances Italy SpA.
DSG Retail Limited is responsible for after sales service.

IB-KDW60S20/W20-210528V3