



***Gourmet Sizzler*[®] Electric Griddle**

OPERATING INSTRUCTIONS

EA-DCC10

Always follow basic safety precautions when using electrical appliances.
Read all instructions carefully.
Please keep this Operating Instruction at hand for easy reference.

INDEX

IMPORTANT SAFEGUARDS	2
PARTS NAMES	5
HOW TO USE	6
SAFETY MECHANISM	6
RECIPES	8
CLEANING AND MAINTENANCE	9
REPLACEMENT PARTS	9
TROUBLESHOOTING GUIDE	10
SPECIFICATIONS	10

IMPORTANT SAFEGUARDS

BASIC SAFETY PRECAUTIONS SHOULD ALWAYS BE FOLLOWED WHEN USING ELECTRICAL APPLIANCES, INCLUDING THE FOLLOWING:

1. Read all instructions thoroughly and keep these instructions for future use.
2. Avoid touching hot surfaces. The handles and knobs are provided for your safety and protection.
3. To prevent hazardous operation or electric shock, do not immerse the temperature control plug, power cord, power plug or heater set in water or other liquids.
4. Close supervision is necessary when the appliance is used by or near children.
5. Unplug from outlet when not in use and before cleaning. Allow the appliance to cool before adding or removing parts and before cleaning.
6. Do not leave the appliance unattended when in use.
7. Do not use or operate the appliance with a damaged cord or plug. If the appliance malfunctions or has been damaged in any manner, unplug the appliance and return it to the nearest authorized service facility or dealer for examination, repair or adjustment.
8. Do not use outdoors.
9. The use of accessories or attachments not recommended by the appliance manufacturer may be hazardous or may cause injuries.
10. Keep the power cord away from hot surfaces and do not let the cord hang over the edge of tables or counters.
11. Do not place the appliance on or near a heated surface such as a gas or electric stove, or in a heated oven.
12. Always use the appliance on a dry, level surface.
13. Always use extreme caution when moving appliances containing hot oil or liquids.
14. The plug to the appliance should be attached first before plugging the cord into a wall outlet. To disconnect, turn the power control to OFF. Then remove the plug from wall outlet.
15. To use, plug power cord into an electrical outlet. To disconnect, grasp the power plug and remove from outlet.
16. Do not use the appliance for other than intended or specified purposes.
17. Do not operate in the presence of explosive and/or flammable fumes.
18. This appliance is intended for household/domestic use only and not for commercial or industrial use.
19. To reduce the risk of fire, cook only with plate and guard properly in place.
20. Make sure the detachable plate, heater unit and guard are assembled and fastened properly according to the "HOW TO USE" section of this instruction before cooking. Only use temperature control plug for Model No. EA-DCC10.
21. This appliance is not intended for deep frying foods.

SAVE THESE INSTRUCTIONS

THIS APPLIANCE IS FOR HOUSEHOLD USE ONLY.

This appliance is supplied with a short power cord to reduce the risk of becoming entangled in or tripping over. Extension cords may be used if care is exercised in their use. If an extension cord is used, the marked electrical rating of the cord should be at least as great as the electrical rating of the appliance, and a longer cord should be arranged so that it will not drape over the countertop or tabletop where it can be pulled on by children or tripped over unintentionally.

This appliance has a polarized plug (one blade is wider than the other). To reduce the risk of electric shock, this plug was designed to fit into a polarized outlet in only one direction. If the plug does not fit fully into the outlet, do not attempt to force it or modify it in any way. Simply reverse the plug and insert. If it still does not fit, contact a qualified electrician.

To avoid circuit overload, do not operate another high wattage appliance on the same circuit.

These WARNINGS and CAUTIONS are intended to prevent property damage or personal injury to you and others.

■ The degree of danger or damage by the misuse of this product is indicated as follows:



WARNINGS

Indicates risk of serious injury or death.



CAUTIONS

Indicates risk of injury, household or property damage if mishandled.

■ Prohibited or required actions are indicated as follows:



Indicates a prohibited operation.



Indicates a requirement or instruction that must be followed.



WARNINGS



Do not modify the product. Only a repair technician may disassemble or repair this unit.

Attempting to do so may cause fire, electric shock or injury. Make any repair inquiries to Zojirushi Customer Service.



Do not plug or unplug the Power Plug if your hands are wet.

Doing so may cause electric shock or injury.



Do not immerse the product in water or splash it with water.

Doing so may cause short circuit or electric shock.



Do not use the product if the Power Plug or Power Cord is damaged or if the Power Plug is loosely inserted into the electrical outlet.

Doing so may cause electric shock, short circuit or fire.

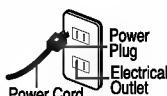

Do not use for deep-fry cooking.

Doing so may cause fire.

Do not attach pins on the Temperature Control Plug or soil it.

Doing so may cause electric shock, short circuit or fire.

Keep children from licking the Temperature Control Plug. Pay particular attention with infants.

Doing so may cause electric shock or injury.

Do not use a power source other than 120V AC.

Use of any other power supply voltage may cause fire or electric shock.

Do not allow children to use the product unsupervised. Keep it out of the reach of infants.

May cause burns, electric shock or injury. Pay particular attention to prevent burns and injury by the plate's edges.



Do not damage the Power Cord. Do not bend, pull, twist, fold, or attempt to modify the Power Cord. Do not place it on or near high temperature surfaces or appliances, under heavy items or between objects.

A damaged Power Cord can cause fire or electric shock.



Insert the Power Plug completely and securely into the electrical outlet.

A loosely inserted Power Plug may cause electric shock, short circuit, smoke or fire.

Use only an electrical outlet rated at 15 amperes minimum, and do not plug other devices into the same outlet.

Plugging other devices into the same outlet may cause the electrical outlet to overheat, resulting in fire.

Stop using immediately if you notice any of the following symptoms indicating a malfunction or breakdown.

Continued use of the product may cause smoke, fire, electric shock or injury.

- The Power Plug or Power Cord has become very hot.
- The Power Cord is deeply damaged or deformed.
- The electricity turns on and off when the Power Cord is touched or moved.
- There is a burning smell.
- You feel a tingle or slight electrical shock.
- The product does not operate even though the Temperature Control Dial is turned on.
- The Operation Light does not turn off even though the Temperature Control Dial is turned to OFF.

If any of the above occurs, unplug the product immediately and return to the store where you purchased it for check-ups and/or repairs.

This product is not intended for use by persons (including children) with reduced physical, sensory or mental capabilities, or lack of experience and knowledge, unless they have been given supervision or instruction concerning use of the product by a person supervised to ensure that they do not play with the product.



CAUTIONS



Do not heat cans or jars of food directly.

Doing so may cause burns or injury as the can or jar may break.



Do not use the product near walls or furniture.

Steam or heat may damage, discolor or deform walls or furniture.

● The illustrations used in this Operating Instructions may vary from the actual product you have purchased.

IMPORTANT SAFEGUARDS (cont.)



CAUTIONS



Do not use in dangerous locations such as unstable places, on table coverings that are vulnerable to heat, near an open flame or flammable substances, or in slippery places. Doing so may cause fire.

Do not use other Temperature Control Plugs than the one provided. Do not use the Temperature Control Plug for other appliances. Doing so may cause malfunction or fire.



Do not touch hot surfaces during or immediately after use. Touching hot surfaces may cause burns.



Unplug the Power Plug from the outlet when the product is not in use.

Leaving the Power Plug in an outlet may cause the insulation to become damaged, resulting in electric shock, short circuit or fire.



During preheating or cooking, move birds and small animals that may be sensitive to smoke or smells to other rooms, and open windows or turn on exhaust fans.

Always unplug the product by holding the Power Plug, not by pulling the Power Cord.

Pulling the Power Cord to unplug the product may cause electric shock, short circuit or fire.

Please allow the product to cool down before cleaning.

Touching hot areas may cause burns.

If the Temperature Control Plug is damaged, it must be replaced by an appropriate cord or assembly made available by the manufacturer or its service agent.

IMPORTANT

■ Plate and its Nonstick Coating

Please follow these instructions to ensure extended use of the Plate and for the protection of the nonstick coating:

- Do not use sharp-edged metal spatulas found in stores.
 - Do not scrape hard with the edge or corners of a spatula. Do not scrape the corners of the Plate.
 - Do not scratch the Plate with sharp objects such as knives or forks.
 - Do not cover the Lid while preheating, or preheat for an extended period of time. Do not place the Plate directly on the stovetop.
 - Do not use abrasive cleansers, scouring powders, nylon brushes, metal brushes or eraser pads.
 - Do not leave the surface or bottom of the Plate soiled.
- Acid (vinegar) and salt contents (sauce, soy sauce and salt) may cause corrosion. Foods left on the surface may also cause uneven cooking. Be sure to keep the product clean.
- Do not use detergents other than mild kitchen detergents such as chlorine based alkaline detergents or those containing acidic ingredients. Doing so may cause corrosion.

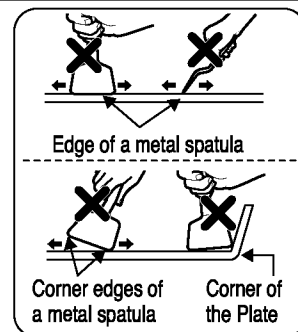

REMARKS: The nonstick coating may wear out with use.

The nonstick coating may eventually discolor or peel off. This will not affect the cooking performance or sanitary properties, and is harmless to your health. If concerned with the peeling of the nonstick coating, please replace the Plate by purchasing a new one.

■ Temperature Control Plug

- Only use the Temperature Control Plug provided.
- Always remove the Temperature Control Plug from the Heater Set after use.
- Never disassemble the Temperature Control Plug.
- Clean any grease from the Release Buttons after use.
- Always clean the Probe and Power Plug of dust, soil or foods.
- Do not bang, drop or handle the Temperature Control Plug roughly. Do not move the Temperature Control Plug up and down when plugging in or unplugging.

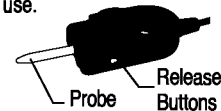

■ Use and Care

- Do not use the product for other than grilling or steaming foods.
- Handle the product gently; otherwise it may cause malfunction or breakdown.
- Do not use the Plate on a gas or electric stovetop burner. Doing so may cause the nonstick coating to peel off, corrode, or cause the Plate to deform or discolor.
- Do not use with a soiled Heat Shield Plate. Doing so may cause malfunction or deformation.
- Do not splash the Heat Shield Plate with water or soak in water. Do not use a metal brush to clean. If the surface becomes rusted or discolored, it may not shield heat properly, and cause fire, the Main Body Guard to deform, or the surface of the tabletop to become hot.
- Do not use on top of items such as newspapers that may obstruct the Air Holes beneath the Main Body Guard. Do not use on surfaces that are vulnerable to heat such as carpets, cushions, tatami mats or tablecloths. Doing so may cause fire, deform the Main Body Guard, or burn the surface.
- Do not use on top of glass surfaces such as a glass table. Doing so may cause the glass to break from the heat.

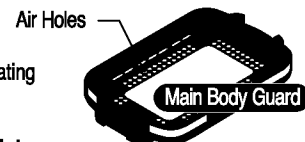

PARTS NAMES

● Do not bang or drop the Plate or handle roughly.

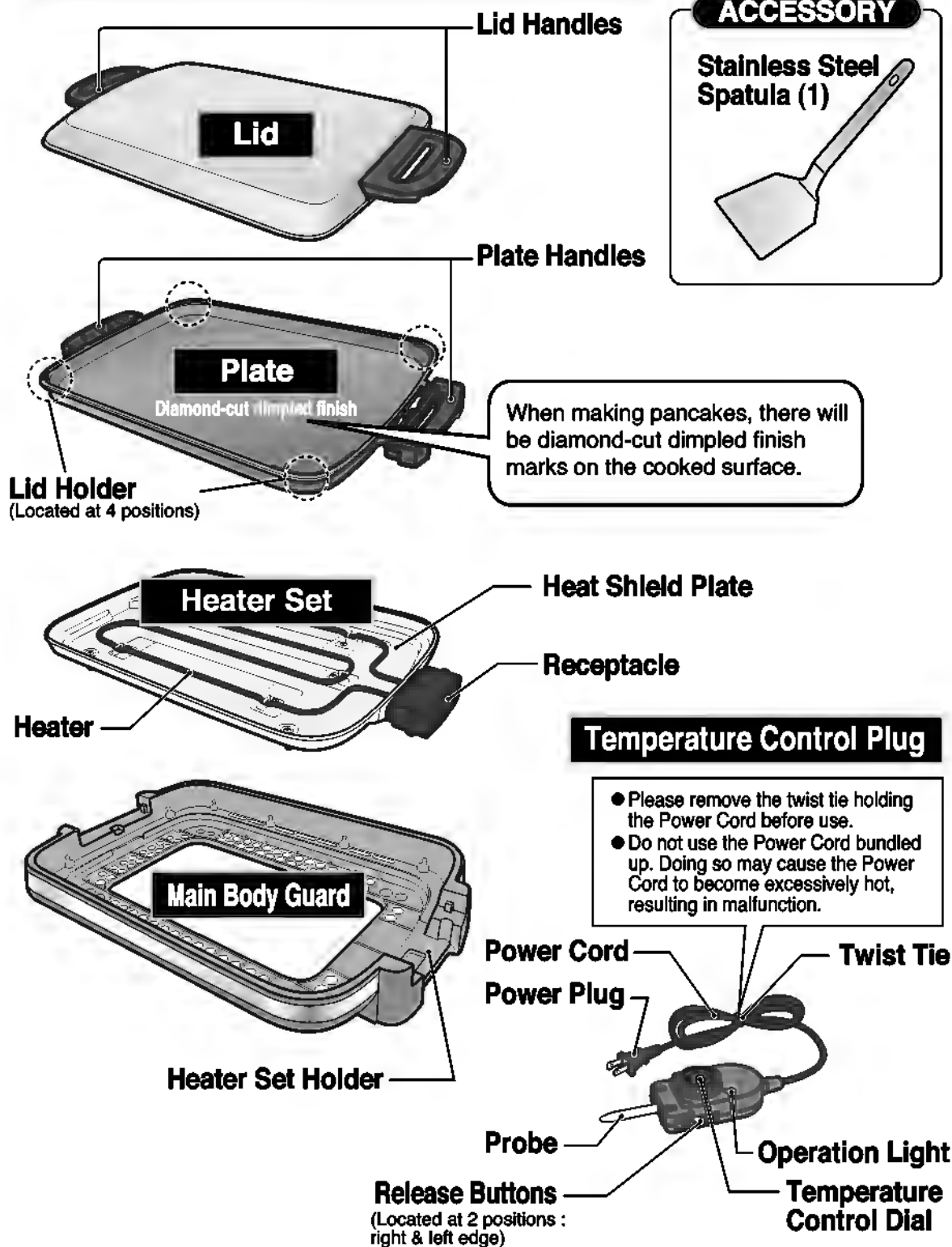

HOW TO USE

1 Preparation

- ① Place the Heater Set in the Main Body Guard.
- ② Set up the Plate.

- Set up in the right order; otherwise it may cause burns, injury or malfunction.
- Do not use the product without the Main Body Guard. Doing so may cause burns, injury or malfunction.

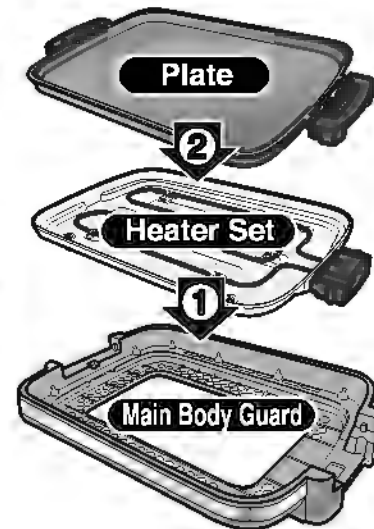

2 Insert the Temperature Control Plug

- ① Firmly insert the Temperature Control Plug to the Heater Set.
- ② Plug in the Power Plug to an electrical outlet.

● Make sure OFF aligns with the Operation Light.

- Do not use other Temperature Control Plugs than the one provided. Do not use the Temperature Control Plug for other products.
- Insert the Temperature Control Plug completely until the white crescent marks on both Release Buttons are completely visible. The Plate may not heat up properly if the Temperature Control Plug is not inserted completely. Incorrectly inserting the Temperature Control Plug may also cause accidents or malfunctions due to abnormal heat generation.

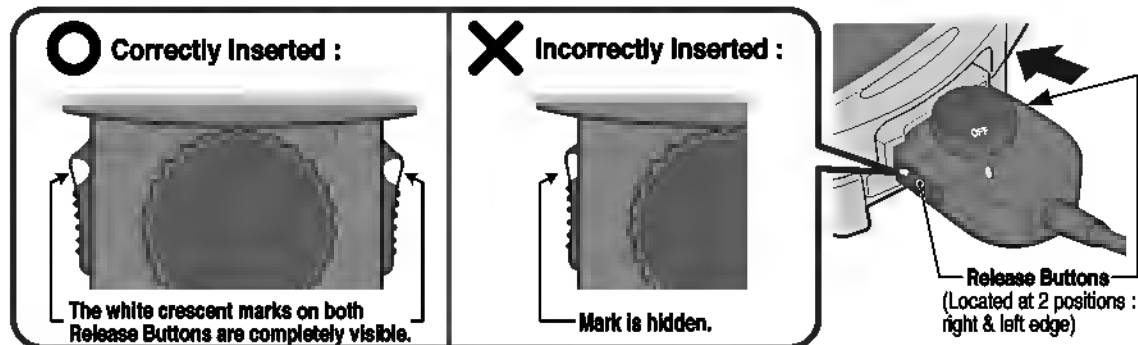

- To remove the Temperature Control Plug, pinch both Release Buttons and pull the Plug away.

SAFETY MECHANISM

This product is equipped with the following safety features:

- The Temperature Control Plug cannot be inserted if the Plate is not properly set up.
- The Plate cannot be removed from the Heater Set while the Temperature Control Plug is inserted.

Never force the Temperature Control Plug in or remove the Plate forcefully as doing so may cause malfunction.

- This product is for grilling and steaming foods. Do not use for other than intended purposes.
- Wipe the Plate and Lid clean before use.

3 Preheat and Cook

- ① Begin preheating by aligning the appropriate preheat temperature with the Operation Light. The Operation Light turns on and the Plate will begin to heat up.

- Do not cover the Lid while preheating.
- Do not preheat at a temperature higher than the Preheat Temperature.

Approximate time for preheating . . . 8 min.

- ② When preheating completes in about 8 minutes, turn the Temperature Control Dial to the desired cooking temperature and begin cooking.

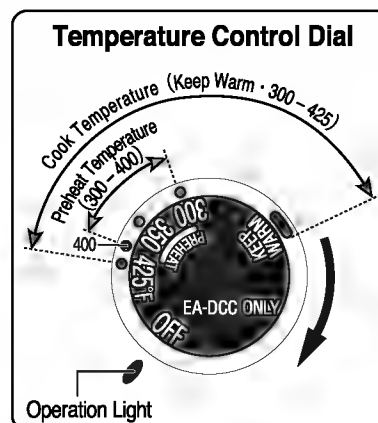

ESTIMATED COOKING TEMPERATURE

Dial		Menu
Preheat Temp.	Cook Temp.	
400	425	Yakiniku, steak and fried noodles etc.
	400	Okonomiyaki and gyoza etc.
350	350	Burgers and pancakes etc.
300	300	Crepe and thin-fried eggs etc.
—	KEEP WARM	Keep Warm

- The temperature is the estimated surface temperature of the Plate without the Lid.
- Cooking results may vary depending on size, room temperature and voltage. Use the chart as a guideline to achieve your preferred result.

- Use hot water to steam gyoza.
- To keep food warm, set the dial to Keep Warm.
- The product may make a creaking sound, but this is normal and does not indicate a malfunction.
- The Operation Light will turn on and off during cooking. This indicates that the temperature is being controlled and is not a malfunction.
- There may be some smoke or odor the first time the product is used, which is normal.

TIPS FOR USING THE LID

The surface temperature of the Plate increases by 86 to 104°F (30 to 40°C) when the Lid is used. Using the Lid will help speed up the cooking process.

WHEN REMOVING THE LID...

- The Lid Handles will become hot while cooking. Take precautions to prevent burns.
- Beware of steam or oil splattering from the gap between the Plate and the Lid to prevent burns.

NOTE

- Do not cover the Lid while preheating.
- Place the Lid on the Lid Holder of the Plate properly. If the Lid sits on the Main Body Guard, it may cause malfunction, deformation or burns.

4 After Use

- ① Turn the Temperature Control Dial to OFF (align with the Operation Light), then unplug the Power Plug from the electrical outlet.
- ② Wipe off burnt on foods with a soft paper or cloth while the Plate is warm.
- ③ Allow the Plate to cool (at least 30 minutes after use), then remove the Temperature Control Plug from the Heater Set and clean.

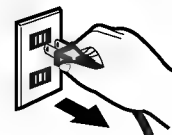

- The Lid, Plate, Heater Set (Heater, Heater Shield Plate, Receptacle) and the Temperature Control Plug's Probe will be hot for a while after use. Please take caution to prevent burns.
- Do not attempt to remove the Plate while the Temperature Control Plug is still inserted. Doing so may cause malfunction or damage.
- Do not hold the Heater Set by the Receptacle. Doing so may cause malfunction or damage.

RECIPES

NOTE

The measurements used in these Recipes:

1 Cup = 8 oz. (240 mL) 1 Tbsp. = 0.5 oz. (15 mL) 1 tsp. = 0.2 oz. (5 mL)

● Take extra care while cooking as oil may splatter.

W Serving Suggestion

Pork Chop

Ingredients (4 servings)

- 4 boneless pork chops, 1/2 inch thick
- 1/2 tsp. salt for seasoning meat
- 1/2 tsp. freshly ground black pepper for seasoning meat
- 1-1/2 Tbsp. olive oil
- 2 shallots, thinly sliced
- 4 oz. (113 g) Baby Bella mushrooms, stemmed, thinly sliced
- 1/3 cup Italian parsley, chopped
- 1/2 cup white wine
- 1-1/2 cups heavy cream
- A pinch of freshly ground black pepper for sauce
- 2 Tbsp. capers, drained, chopped

How to cook

- ① Pat the pork chops dry with paper towels to remove any moisture. Season pork chops on both sides with salt and black pepper for seasoning meat.
- ② Turn the Temperature Control Dial to 400. When preheating completes in about 8 minutes, turn the Temperature Control Dial to 425. Heat 1 Tbsp. olive oil and sear pork chops until brown on both sides – about 5 minutes for each side. Transfer seared pork chops onto a warmed plate and keep warm.
- ③ Turn the Temperature Control Dial to 400. Add remaining oil, sliced shallots and mushroom on the Plate and sauté until

mushrooms are browned – about 2 minutes. Add chopped parsley and white wine and cook until the liquid is mostly evaporated – about 1 minute.

- ④ Turn the Temperature Control Dial to 300. Add heavy cream and mix well.
- ⑤ Add cooked pork chops from step ③ back onto the Plate and let them submerge in the sauce. Cover with the Lid and cook until the pork chops are done – about 4-5 minutes.
- ⑥ When pork chops are done, season with black pepper for sauce, add chopped capers and stir to combine.
- ⑦ Place pork chops onto warm plates and spoon over sauce.

Preheat Temperature	400
Cook Temperature	425 - 400 - 300



Blueberry Whole Wheat Pancakes

Ingredients (12 pancakes)

- 1 cup (120 g) whole wheat pastry flour
- 1 cup (130 g) all purpose flour
- ① 3 Tbsp. sugar
- 1/2 tsp. salt
- 1 tsp. baking powder
- 1/2 tsp. baking soda
- 1-1/4 cups milk
- ② 2 large eggs, lightly beaten
- 1 Tbsp. unsalt butter, melted
- 2 tsp. vegetable oil
- 4 oz. (113 g) blueberries, fresh or frozen

Toppings

- Maple syrup, to taste
- Butter, to taste
- Fresh blueberries, to taste

How to cook

- ① In a large bowl, combine ingredients from ① using a whisk.
- ② Add ②; whisk gently until just combined (do not over-mix).
- ③ Turn the Temperature Control Dial to 350. Preheat the plate, about 8 minutes.
- ④ When preheating completes, turn the Temperature Control Dial

to 300. Brush the Plate with 1/2 tsp. vegetable oil. Pour about 1/4 cup batter from step ② per pancake onto the Plate. (Make 3 pancakes at once.)

- ⑤ Top each pancake with about 1 Tbsp. of blueberries.
- ⑥ Cook until the edges are set and bubbles form on the surface – about 2 minutes. Flip the pancakes and cook for 3-4 minutes, or until cooked through.
- ⑦ Dish the pancakes onto plates and serve with your favorite toppings.
- ⑧ When making the 9 remaining pancakes consecutively, follow steps ① - ⑦ after preheating for 6 minutes at 350.

Preheat Temperature	350
Cook Temperature	300



CLEANING AND MAINTENANCE

Be sure to clean thoroughly after every use. Leaving burnt foods on the Plate may cause scorching, and will become difficult to remove.

Clean the product after it has cooled down completely except for the Plate.

Heat Shield Plate (Heater Set)	<ol style="list-style-type: none"> ① Use a mild kitchen detergent and a soft cloth and wipe down. ② Wipe down with a well-wrung cloth. ③ Wipe dry with a soft dry cloth. <p>● Do not splash it with water or soak in water. Do not use a metal brush to clean. If the surface becomes rusted or discolored, it may not shield heat properly, and cause the Main Body Guard to deform, or the surface of the tabletop to become hot.</p>	<div data-bbox="1166 300 1308 331">CAUTION</div> <ul style="list-style-type: none"> ● Never wash the Heater Set and the Temperature Control Plug. Doing so may cause malfunction. ● Do not use abrasive cleansers, scouring powders, nylon brushes, steel brushes or eraser pads. Doing so may cause deformation, discoloration or scratches. ● Do not use detergents other than mild kitchen detergents such as chlorine based alkaline detergents or acidic detergents. Doing so may cause corrosion. ● Do not use a dishwasher or a dish-dryer. Doing so may cause discoloration. ● Be sure to remove the Heater Set when washing the Main Body Guard. Not doing so may cause malfunction. ● Do not leave or use the Plate soiled. Make sure to clean the surface and bottom, as well as the sides of the Plate. Leaving the Plate soiled will not only make it difficult to clean, but will also cause uneven heating. It may also cause malfunction or fire. ● Always clean thoroughly after using acid (vinegar) or salt contents (sauce, soy sauce or salt). Leaving them on may cause corrosion of the nonstick coating.
Main Body Guard Lid Stainless Steel Spatula	<ol style="list-style-type: none"> ① Use a diluted mild kitchen detergent and a sponge to wash. ② Rinse and then wipe dry with a soft dry cloth. <p>● Wash away burnt on foods with a sponge after soaking in warm water.</p> <p>● Water may collect inside the Main Body Guard. In that case, turn the Heater Set Holder side down and shake to drain the water.</p>  <p>↓ This side down and shake.</p>	
Temperature Control Plug Heater • Receptacle (Heater Set)	<p>Wipe down with a soft dry cloth.</p>	
Plate	<ol style="list-style-type: none"> ① Wipe off scorched foods with a soft paper or cloth while the Plate is still warm. ② Remove the Plate and wash with a sponge with warm water and mild kitchen detergent. ③ Rinse and then wipe dry with a soft dry cloth. <div data-bbox="462 1113 1075 1150">FOR STUBBORN SCORCHED FOOD, OR IF THE PLATE COOLED</div> <ol style="list-style-type: none"> ① Pour just enough hot water to cover the surface of the Plate and turn on the product. When the water reaches a boil, rub off the scorched food with a soft utensil such as a silicone spatula. ② When the Plate cools, discard the water and wash with a mild kitchen detergent using a sponge. ③ Rinse and then wipe dry with a soft dry cloth. <p>● Do not use the rough side of the sponge.</p> <p>● After cleaning the Plate, wipe thoroughly with a dry cloth, set in Main Body Guard and Heater Set, and turn the power on to allow it to dry completely. Be sure not to overheat the Plate. The product will become hot. Please take precautions to prevent burns.</p>	

REPLACEMENT PARTS

- Replacement parts may be available for an additional charge. Please replace damaged parts only with new parts.
- When replacing parts, please record the model number and part name beforehand. Then contact either the store where you purchased the product or Zojirushi Customer Service.

Zojirushi Customer Service
1-800-733-6270 www.zojirushi.com

Parts Names	Parts Number
Plate	BG197810GC-00
Stainless Steel Spatula	717011-00
Temperature Control Plug	BX145801A-00

TROUBLESHOOTING GUIDE

Please check the following points before calling for service.

Problems	Cause	Remedy
Temperature Control Plug (Probe) will not plug in.	● Are the Heater Set and the Plate properly set up?	Please set them correctly.
The Plate does not heat up.	● Is the Power Plug unplugged?	Insert the Power Plug securely.
	● Is the Temperature Control Plug connected correctly?	Insert the Temperature Control Plug completely until the white marks on the Release Buttons (located at 2 positions) are fully visible. (See pg.6)
The food does not cook well.	● Insufficient preheating.	Start cooking after preheating completes. (See pg.7)
Food is scorched.	● Is the Plate properly cleaned and maintained?	Perform Cleaning and Maintenance. (See pg.9)
Plate cannot be removed .	● Is the Temperature Control Plug still connected?	Remove the Temperature Control Plug.

SPECIFICATIONS

Model No.		EA-DCC10
Rating		AC 120 V 60 Hz
Electric Consumption		1350 W
Length of the Power Cord		6' 6" (2.0 m)
External Dimensions	(approx. inches)	23-5/8 (W) × 15 (D) × 4-3/8 (H)
	(approx. cm)	60 (W) × 38 (D) × 11 (H)
Weight		approx. 12 lbs. (5.5 kg)
Temperature Control		Keep Warm ~ 425°F (220°C)



www.zojirushi.com

EA-DCC ©B®A