



## **WiiM Pro Plus Hi-Res Music Streamer**

**Model: WiiM Pro Plus**

## CONTENTS

1.	INTRODUCTION .....	4
	TYPICAL USE CASES.....	4
	OTHER DEVICES NEEDED TO USE WIIM PRO PLUS.....	6
	AUDIO DEVICES WORK WITH WIIM PRO PLUS.....	6
2.	WHAT'S IN BOX.....	8
3.	TECHNICAL SPECIFICATIONS.....	9
4.	CONTROLS AND LIGHTS .....	11
	BUTTONS AND INPUT/OUT INTERFACE .....	12
5.	HOW TO SET UP .....	14
	CONNECT AUDIO INPUT to IN PORT ON WIIM PRO PLUS .....	14
	CONNECT WIIM PRO PLUS'S AUDIO OUT PORT.....	17
	SUMMARY OF DEVICE CONNECTIONS.....	17
	POWER THE WIIM PRO PLUS.....	19
	CONNECT TO YOUR NETWORK WITH THE WIIM HOME APP.....	19
	FILL YOUR HOME WITH SOUND .....	21
	USE 12 V TRIGGER OUT .....	21
	AUDIO OUTPUT VIA BLUETOOTH OUT.....	21
	AUDIO OUTPUT VIA AIRPLAY CAST .....	22
6.	VOICE CONTROL .....	23
	WORKS WITH ALEXA.....	23
	WORKS WITH SIRI .....	23
	WORKS WITH GOOGLE VOICE ASSISTANT.....	24
7.	DIRECT CONTROL VIA YOUR FAVORITE APP.....	25
	SPOTIFY CONNECT .....	25
	AIRPLAY 2.....	25
	TIDAL CONNECT.....	26
	AMAZON MUSIC CAST (ALEXA CAST).....	27
	CHROMECAST AUDIO .....	27

---

DLNA.....	28
8. ALL MUSIC IN ONE APP .....	29
9. MULTIROOM AND STEREO PAIRING .....	30
LINKPLAY MULTIROOM/STEREO PAIRING .....	30
AMAZON ALEXA MULTIROOM .....	30
MULTIROOM WITH CHROMECAST AUDIO DEVICES .....	31
10. AUDIO INPUT VIA LINE IN OR SPDIF IN .....	32
11. AUDIO OUTPUT VIA LINE/SPDIF/COAX/BT OUT .....	33
12. STREAM AUDIO WITH BLUETOOTH .....	34
13. ADVANCED FEATURES .....	35
FIRMWARE UPDATES .....	35
USE ETHERNET INSTEAD OF Wi-Fi .....	35
14. FAQ .....	36
15. IMPORTANT SAFETY INSTRUCTIONS.....	38
16. CE/FCC Statements .....	39

## 1. INTRODUCTION

At WiiM, our goal is to offer you the simplest and most affordable Hi-Fi, lossless audio systems. Every product we create showcases top-tier design and an intuitive user interface. With our patented audio streaming solution integrated into all our premium products and user-friendly mobile apps, you can effortlessly enjoy music throughout your entire home.

Introducing the WiiM Pro Plus, an exceptionally versatile network music streamer that stands out in the market. With features like Google Chromecast, AirPlay 2, Spotify Connect, TIDAL Connect, DLNA, Roon Ready, MQA, Alexa Cast, and seamless playback of Hi-Res 192k/24-bit lossless audio, it transforms your stereo system. Enjoy cloud-based music services or your own library via Wi-Fi or Ethernet.

It features a next-gen AKM 4493SEQ premium DAC, leveraging AKM's Velvet Sound Technology to deliver industry-leading low distortion and wide dynamic range. It boasts a Signal-to-Noise Ratio (SNR) of 121 dB (A-wt) and a Total Harmonic Distortion plus Noise (THD+N) of -113 dB across sample rates from 44.1k to 192k, courtesy of its ultra-low noise clock and optimized power and circuit design. Additionally, it features a cutting-edge TI Burr-Brown PCM1861 ADC, which achieves a 110 dB SNR for analog-to-digital conversion, making it ideal for input sources like turntables, MP3 players, or TVs.

Simply plug the WiiM Pro Plus into your stereo receiver, DAC, or amplifier, and control it using the user-friendly WiiM Home App, popular platforms like Spotify, TIDAL, Amazon Music, or any Chromecast-enabled apps. Voice control is also a breeze through iPhone, HomePod, compatible Echo and Google Home devices, as well as the Alexa App, Google Home, or Apple Home App.

Create synchronized groups with HomePods, Echoes, Google Home, AirPlay 2 devices, other Alexa-compatible devices, or additional WiiM Minis, Pros or Pro Plus, streaming music throughout your home or playing different tracks in separate rooms. Boasting both digital and analog audio inputs and outputs, the WiiM Pro Plus seamlessly integrates with your existing stereo setup.

Elevate your audio gear with the smart capabilities of the WiiM Pro Plus, delivering high-fidelity, gapless music through the exceptional innovation of WiiM.

## TYPICAL USE CASES

The WiiM Pro Plus is designed to enhance your existing audio setup by adding wireless streaming capabilities and smart features. Here are a few common use cases for the WiiM Pro Plus:

- I. **Upgrade your Favorite Legacy Audio Systems:** If you have a traditional stereo system or speakers that you want to integrate into your Apple AirPlay 2, Google Chromecast, Amazon Alexa or LinkPlay ecosystem, the WiiM Pro Plus allows you to wirelessly stream music to those speakers. It bridges the gap between your older audio equipment and the modern world of streaming music.
- II. **High-Quality Audio:** It supports bit-perfect, high-resolution audio formats and delivers rich, detailed sound, enhancing the listening experience of your existing audio system.
- III. **Streaming Services and Music Libraries:** The WiiM Pro Plus allows you to access various streaming services such as Spotify, Amazon Music, or Tidal, bringing a wide range of music to your existing audio setup. You can also connect it to your personal music library stored on a computer or network-attached storage device for seamless playback.
- IV. **Podcasts and Internet Radio:** In addition to streaming music, the WiiM Pro Plus provides access to a wide range of podcasts and internet radio stations. You can browse through different genres, podcasts, or specific radio stations to enjoy on your existing audio system.
- V. **Multi-Room Audio:** The WiiM Pro Plus seamlessly integrates with other 3<sup>rd</sup> party popular smart speakers and components, or another WiiM/Linkplay device, allowing you to create a whole-home audio system with synchronized music playback in multiple rooms.
- VI. **Smart Home Integration:** The WiiM Pro Plus supports voice control through platforms like Apple Siri, Amazon Alexa or Google Assistant, allowing you to control your music hands-free and integrate with other smart home devices.
- VII. **Vinyl or CD Integration:** If you have a turntable or CD player that you want to incorporate into your WiiM or AirPlay system, the WiiM Pro Plus can connect to the analog or digital outputs of these devices. This enables wireless audio streaming to other speakers via another WiiM or AirPlay compatible device, allowing you to relish the sound throughout your entire home, all in sync.
- VIII. **Home Theater Integration:** The WiiM Pro Plus can be used as a bridge between your home theater system and the WiiM ecosystem. By connecting the Pro Plus to your AV receiver or soundbar, you can stream music wirelessly to your home theater speakers and synchronize audio playback with other WiiM devices for a cohesive audio experience.

## OTHER DEVICES NEEDED TO USE WIIM PRO PLUS

To use the WiiM Pro Plus, you will need a few essential devices and components. Here's a list of what you'll need:

- **Audio System:** The WiiM Pro Plus is designed to connect to an existing audio system. This can be a stereo system, powered speakers, passive speakers with an amplifier/receiver, or a home theater setup with an AV receiver or soundbar. Make sure you have the appropriate audio system in place.
- **Wi-Fi Network:** The WiiM Pro Plus requires a stable Wi-Fi network connection to function. Ensure that you have a reliable Wi-Fi network available in the area where you plan to set up the WiiM Pro Plus. You'll need the Wi-Fi network credentials during the setup process.
- **Smartphone or Tablet:** You'll need a compatible smartphone or tablet (iOS or Android) with the WiiM Home app installed. The WiiM Home app is used for initial setup, configuration, and control of the WiiM Pro Plus.
- **Power Source:** The WiiM Pro Plus needs to be connected to a power source using the included power adapter and cable. Ensure that you have an electrical outlet nearby to power the device.
- **Ethernet Cable (optional):** While the WiiM Pro Plus primarily connects to your Wi-Fi network, it also has an Ethernet port. If you prefer a wired connection for added stability, you can use an Ethernet cable to connect the WiiM Pro Plus directly to your router or network switch.

These are the core components required to use the WiiM Pro Plus. It's important to have an audio system that you want to integrate with the Pro Plus, a stable Wi-Fi network, and a compatible device with the WiiM Home app for setup and control.

## AUDIO DEVICES WORK WITH WIIM PRO PLUS

The WiiM Pro Plus can work with your audio source devices, smart speakers and other legacy stereo systems, DAC, amplifier, speakers or soundbars etc. The audio source device includes TV, record player and MP3 player. The block diagram below shows how you can connect your audio system with the WiiM Pro Plus.

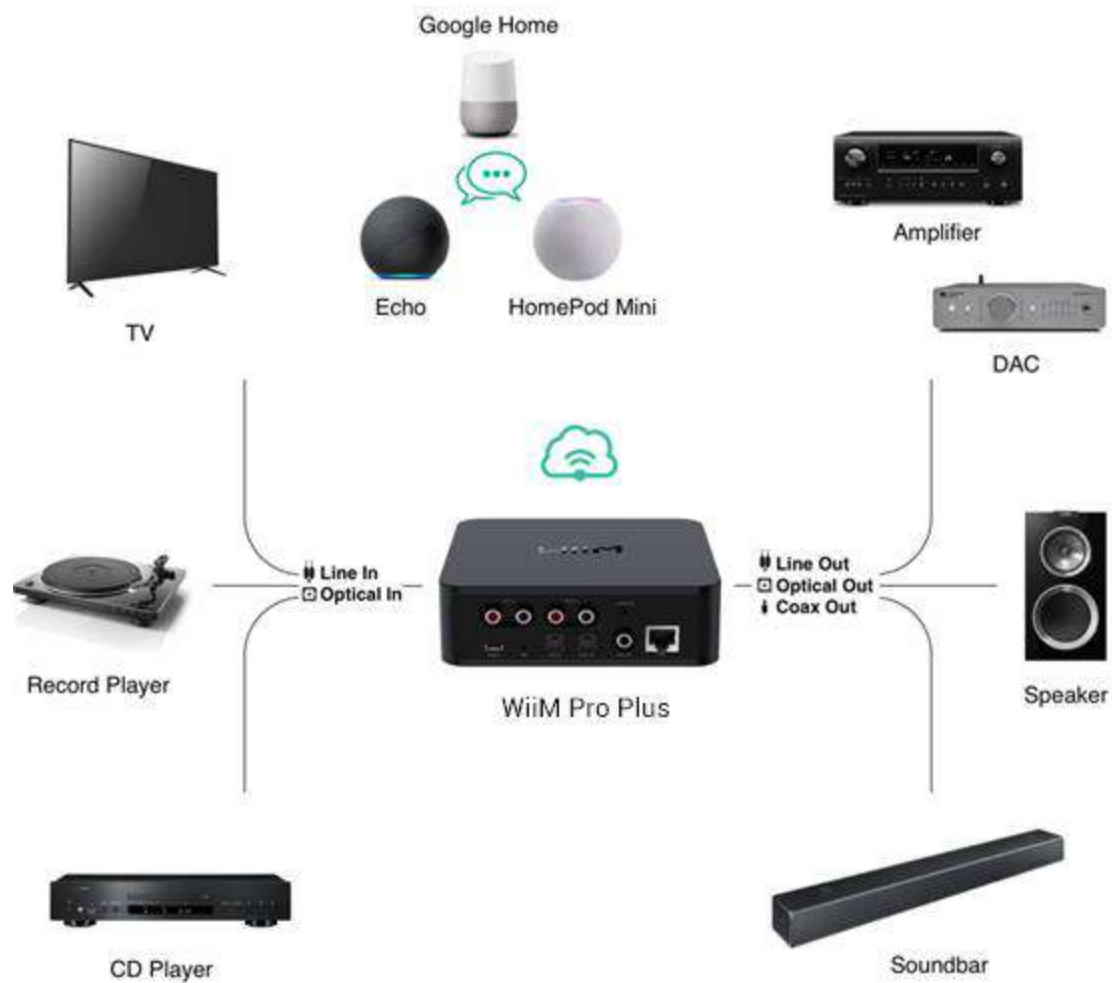

## 2. WHAT'S IN BOX

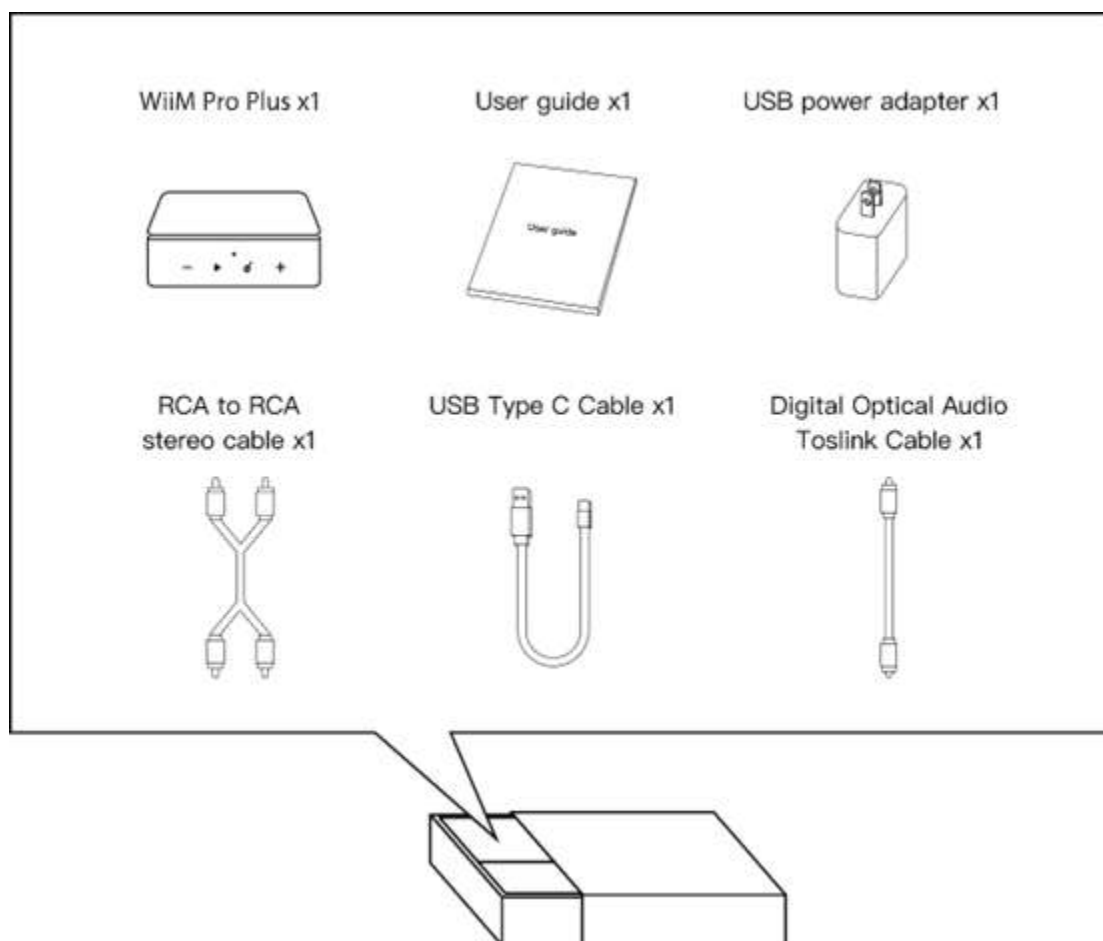



### 3. TECHNICAL SPECIFICATIONS

Feature	Description
Power Input	USB Type-C, requires 5V, 1.5A or higher Bundled adapter: 5V, 2A
Audio Quality	Digital Audio Output: Bit-perfect output, up to 192 kHz, 24-bit with digital optical or coaxial output. Analog Audio Output: It supports up to 384 kHz, 32-bit with its internal DAC. You won't lose precision when using volume control with analog output for 16-bit or 24-bit audio.
Network	802.11 b/g/n/ac 2.4 GHz and 5 GHz dual bands Wi-Fi 10/100M Ethernet
Bluetooth	Bluetooth 5.1, A2DP, AVRCP Support SBC, AAC Codec
Audio Input	1 x Analog RCA Line IN, 1 Vrms, 48 kHz/16-bit 1 x SPDIF Optical IN, up to 192kHz/24-bit
Audio Output	1 x Analog RCA Line OUT, 1 x Digital optical (SPDIF) OUT, 1 x Digital Coaxial OUT, up to 192kHz/24-bit
SNR (built-in DAC)	121 dB
THD+N (built-in DAC)	0.00025%, -113 dB
Audio Codec	MP3, AAC, ALAC, APE, FLAC, WAV, WMA, OGG, AIFF
Streaming Protocol	AirPlay 2, Chromecast Audio, DLNA, Spotify Connect, TIDAL Connect, Amazon Music Casting, Qplay 2.0, Squeezeelite, Roon Ready

<b>Streaming Services in App</b>	Spotify, Amazon Music, Deezer, TunesIn, Tidal, Qobuz, SoundCloud, Pandora, iHeartRadio, vTuner, Napster, Sound machine, etc.
<b>LED</b>	Three-color status LED - Red, Green, and White
<b>Button</b>	Capacitive touch buttons – Play/Pause, Volume +, Volume -, 1 x Preset
<b>Weight</b>	14.1 oz (400g)
<b>Dimension</b>	5.5 x 5.5 x 1.6 in (140 x 140 x 42 mm)

## 4. CONTROLS AND LIGHTS



## BUTTONS AND INPUT/OUT INTERFACE

Buttons / IO Interface	Functions
<b>Power</b>	USB Type-C power plug, 5V, 2A
<b>Play/Pause</b>	Play/Pause, network pairing, and restore to the factory setting
<b>Preset</b>	Start to play the preset content (short press) or save the favorite content as the preset (long press)
<b>Volume Up</b>	Increase volume
<b>Volume Down</b>	Decrease volume
<b>Analog audio in</b>	Standard RCA
<b>Analog audio out</b>	Standard RCA
<b>Digital Optical audio out</b>	SPDIF optical up to 192 kHz/24-bit
<b>Digital Coax audio out</b>	Digital coaxial port up to 192 kHz/24 bit
<b>Mic</b>	Activated solely for the purpose of automatically calculating audio latency to ensure seamless multiroom synchronization. This includes compatibility with various platforms like AirPlay 2, Alexa MRM, Chromecast MRM, and Linkplay MRM. The MIC is engaged only during latency measurement.
<b>12 V trigger</b>	2.5 mm port for cable connection to your amplifier for automated power control.  Note: Consult your amplifier's user guide for specifics on utilizing its 12V trigger input.
<b>LAN</b>	10/100Mbps Ethernet port

## LIGHTS

State	Color	Flashing/Solid
Boot-up	White	Flashing (fast)
OoBE/Ready to Setup	White	Flashing (slow)
BT ready to pair	Green	Flashing (slow)
Connecting to Wi-Fi	White, Green	Flashing (fast)
Connected to network	White	Solid
BT mode, paired	Green	Solid
Aux-in mode	Green	Solid
OTA	White, Green	Flashing (slow)
Restore to factory setting	White, Red	Flashing (slow)
Not connected to the network (and not in setup mode)	Red	Solid
Faulty Error	Red	Flashing (slow)

**NOTES:**

WGR: Three-color LED, no color mix

W: Wi-Fi as the audio source (product default mode)

G: Audio source from Analog, digital audio input, or BT

R: Error (Not connected to a network or faulty error)

Three modes: Solid, flashing slow, flashing fast

## 5. HOW TO SET UP

### CONNECT AUDIO INPUT to IN PORT ON WIIIM PRO PLUS

The WiiM Pro Plus features two distinct audio input interfaces: the analog LINE IN and the digital optical (TOSLINK) SPDIF IN.

This versatile device functions as both a preamplifier and a network audio transmitter through Wi-Fi or Ethernet. You have the capability to stream analog audio input from sources such as CD players, vinyl players, TVs, or computers to other WiiM Pro Plus, Pro, or Mini devices, as well as to AirPlay-enabled devices (using AirPlay Cast), either singly or in multiple combinations.

Scenario 1: Analog Audio Source Input (CD Player, Vinyl Player, or Computer)

Connect your source device to the WiiM Pro Plus's LINE IN port using a line-in cable. One of two types' cable as the follows might be used, i.e., RCA to RCA or Aux to RCA.

Connect to WiiM Pro Plus's Line IN port





Connect to CD player, vinyl player, TV or computer

Steps to set up the WiiM Pro Plus with the line-in input:

(Perform step 3/4/5 after WiiM Home App is installed)

1. Insert the line-in cable into the LINE IN port located at the back of the WiiM Pro Plus.
2. Connect the other end of the cable to the AUX or LINE OUT port on your audio source device (CD player, vinyl player, TV, or computer).
3. In the WiiM Home app, navigate to the 'Browse' tab, choose 'Select source on device,' then opt for 'LINE IN' to set it as your audio distribution source.
4. For creating a multiroom music group with your WiiM Pro Plus, access the Devices section in the WiiM Home app. Select the WiiM Pro Plus linked to your LINE-IN device, tap the group button (displaying a "link" icon within a box) in the upper-right corner of the device box, and choose the WiiM Pro Plus you wish to transmit audio to.
5. Once done, the music from the device connected to the WiiM Pro Plus will play across your multiroom music group.

#### Scenario 2: Digital Audio Source Input (TV or PC)

Connect your source device to the WiiM Pro Plus's SPDIF IN (optical) port using an optical cable.



Steps to set up the WiiM Pro Plus with the SPDIF IN are the same as Line-in, replacing Line-in with SPDIF IN.

**Notes:**

- You can also enable “Autosense” on the WiiM Pro Plus to automatically play your Line-In or Optical-In source when WiiM Pro Plus detects a signal. You can enable this feature from the WiiM Home App.
- WiiM Pro Plus has a built-in EQ to process the audio input based on your taste. You can also control the audio volume in the App remotely without adjusting your audio input.
- Some source devices may require a preamp. For example, some turntables do not have a preamp built-in, so you will need to connect your turntable to an external preamp and then connect the preamp to WiiM Pro Plus.



## CONNECT WIIM PRO PLUS'S AUDIO OUT PORT

The WiiM Pro Plus features three distinct audio output interfaces that offer flexibility in connecting your DAC, amplifier, or powered speaker. These interfaces include the analog LINE out, the digital optical (TOSLINK), and the Coaxial port. It's important to note that the WiiM Pro Plus is designed to output audio through a single one of these audio output options.

Setting Up WiiM Pro Plus Audio Output:

(Note: Perform steps 3, 4, and 5 after installing the WiiM Home App)

1. Depending on your preferred audio equipment, select the appropriate connection method: RCA cable, optical cable (TOSLINK), or COAX.
  - a. For RCA cable, plug it into the LINE OUT port on the back of the WiiM Pro Plus.
  - b. For optical cable (TOSLINK), plug it into the SPDIF OUT port.
  - c. For Coaxial cable, plug it into the COAX port.
2. Connect the other end of the cable to your audio equipment (DAC, amplifier, or powered speaker).
3. Within the WiiM Home App on your iOS or Android device, designate the desired output port. Remember that the WiiM Pro Plus only outputs audio through one of these options.
4. Enhance sound quality with customized sound equipment connection:
  - a. EQ settings
  - b. Calibration (latency from the WiiM Pro Plus to speaker)
  - c. Test music playback
5. You're now ready to begin playing audio on your selected output devices.

### Notes:

- *Selecting the appropriate audio output port is crucial to ensure sound output. Incorrect selection may result in no audio.*
- *For bit-perfect audio output, opt for the digital audio output and activate the fixed volume output, disable EQ and mono audio in the WiiM Home App's device settings.*
- *You have two ways to control the volume of your system:*
  - *Utilize your AVR or amplifier for volume control (When the 'Fixed Volume Output' is set on the WiiM Pro Plus).*
  - *Control volume through the WiiM Home App, but remember to disable fixed volume output for this option.*

## SUMMARY OF DEVICE CONNECTIONS

- ① If connecting to an audio/video receiver (AVR), DAC, or amplifier, utilize the Line Out, Optical Out, or Coaxial Out port.  
or
- ② When connecting directly to powered speakers or a soundbar, opt for the Line Out, Optical Out, or Coaxial Out port.  
or
- ③ For PC, TV, vinyl, or MP3 player connections, employ the Line In or Optical In port.

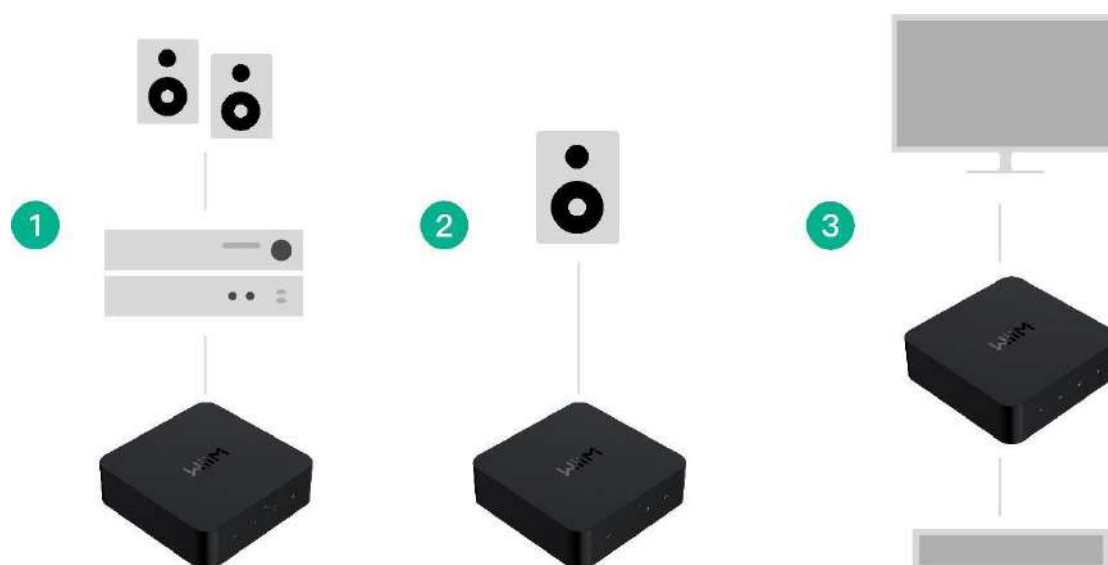

Wiim Pro Plus's Audio Ports						
Device	Line In	Line Out	SPDIF In	SPDIF Out	Coax Out	IN/OUT
TV	Y		Y			IN
Vinyl	Y		Y			IN
MP3	Y		Y			IN
CD	Y		Y			IN
Audio/Video Receiver (AVR)		Y		Y	Y	OUT
Powered Speaker/Sound bar		Y		Y	Y	OUT
DAC				Y	Y	OUT
Amplifier		Y		Y	Y	OUT

## POWER THE WIIM PRO PLUS

Please use the provided USB power adapter to power your WiiM Pro Plus. If you want to use your own linear power supply, please ensure it can support 5V, 1.5A or higher power.

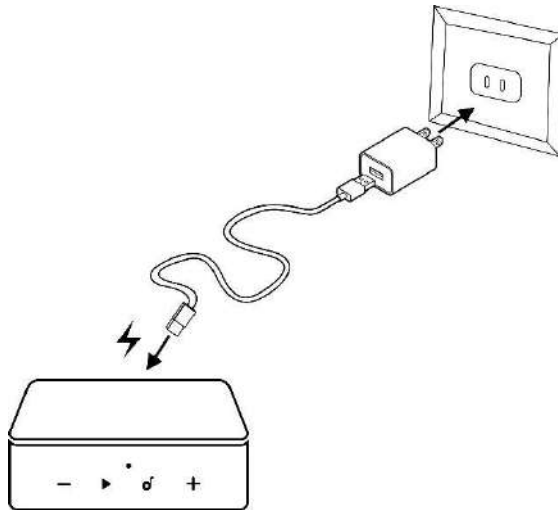

## CONNECT TO YOUR NETWORK WITH THE WIIM HOME APP

You can use Ethernet or Wi-Fi to connect WiiM Pro Plus to your network. Before the setup, please download the WiiM Home App. If you want to use the Wi-Fi to connect to WiiM Pro Plus, please have your network password ready.

- **DOWNLOAD THE WIIM HOME APP**



- **Wi-Fi OR ETHERNET SETUP**

- Power on speaker, audio/video receiver (AVR), amplifier, or DAC.
- Power on WiiM Pro Plus streamer and wait 30 seconds until it fully boots up.
- Open the WiiM Home App.
- Click on the device you want to configure.
- Select the network and enter the correct network password. (Ethernet doesn't have this step)
- Select the maximal bit depth and sample rate for your downstream audio device if you use the digital audio output of WiiM Pro Plus. Please note that some legacy DACs, amplifiers, or speakers can't support up to 24-bit/192k Hz audio via its digital audio interface. (Please check your DAC, amplifier, or speaker's manuals for details.)

If you use an **iOS system**, you can also use Apple Wireless Accessory Configuration (WAC) protocol or Home App to set up the device.

- **SETUP with Apple WAC**

- Power on speaker, audio/video receiver (AVR), amplifier, or computer.
- Open iPhone settings and tap your selected device's name on the WAC setup section

- **SETUP with Apple Home App**

- Tap the Home app located on the home screen of the iOS device.
- Tap the "+" button located at the top-right corner of the screen.
- Tap "Add Accessory."
- Tap "Don't Have a Code or Can't Scan?"
- Tap your selected device, which **MUST** be listed under "Nearby Accessories."

## FILL YOUR HOME WITH SOUND

Immerse yourself in your favorite music and radio stations through seamless Wi-Fi or Bluetooth streaming. With multiple WiiM Pro Plus devices, enjoy music throughout your entire home. Alternatively, connect stereo components like an amplified turntable, CD player, or MP3 player, and simultaneously cast music to multiple WiiM Pro Plus, WiiM Pro, or WiiM Mini connected speakers, or AirPlay compatible devices via AirPlay Cast.

Expand your audio experience by grouping with AirPlay 2-enabled devices, Amazon Echo, or Google Home, creating a synchronized whole-home audio setup across multiple rooms. Note that grouping with non-WiiM or LinkPlay devices requires the respective apps like Alexa or Google Home.

It's important to mention that when using Amazon Echo, or Google Home devices, the WiiM Pro Plus functions as the audio receiver. Please be aware that it cannot transmit its physical audio input (via Line-In or Optical-In) to non-WiiM devices or device that doesn't support AirPlay like Amazon Echo, or Google Home devices over Wi-Fi. However, it can transmit its audio input to AirPlay compatible speakers such as HomePod, Sonos etc.

## USE 12 V TRIGGER OUT

The WiiM Pro Plus raises the voltage on the 12v trigger rail as soon as the music playback starts. It lowers the trigger's voltage two and a half minutes after playback stops. The responsiveness of the connected amplifier to this voltage change varies based on the manufacturer and their individual timeout settings.

For external DAC or amplifier, the 12 V trigger can be utilized to detect music start or stop events. Please consult your device's manual that features with trigger input for details.

## AUDIO OUTPUT VIA BLUETOOTH OUT

You can use the WiiM Pro Plus as a Bluetooth source device, enabling seamless pairing with your Bluetooth speakers.

Bluetooth Pairing Procedure for Audio Output:

- 1) Launch the WiiM Home App on your iOS or Android device.
- 2) Select '**Device**' Tab and tap the gear icon for device settings.
- 3) Select the '**Audio Output**' setting and opt for '**Bluetooth**' to establish a connection with an external Bluetooth receiver, such as an amplifier or speaker.

- 4) Start playing music.

## AUDIO OUTPUT VIA AIRPLAY CAST

You can use the WiiM Pro Plus as an AirPlay source, seamlessly connecting with AirPlay-enabled speakers like the HomePod.

Here's how to set up AirPlay Cast step by step:

- 1) **Launch WiiM Home App:** Open the App and tap the 'Device' tab.
- 2) **Access Device Settings:** Select your WiiM device, then tap the Gear Setting icon to access the device-specific configurations.
- 3) **Navigate to Audio Output:** Go to 'Audio Output' to configure WiiM Pro Plus's output.
- 4) **Select AirPlay Receiver:** Choose the 'AirPlay Receiver' and tap the 'Connect' to pick your casting device.
- 5) **Choose Your Device:** A list of available AirPlay 2-enabled devices will appear. If your desired speaker isn't listed, tap the 'Refresh' icon to update your device list.
- 6) **Select Your Receiver:** Pick your AirPlay 2 receiver, even multiple devices.
- 7) **Play Your Audio:** Finally, select your preferred audio and hit 'Play'.

## 6. VOICE CONTROL

With voice control, you can navigate and interact with your device to search, play, stop, or skip music and more.

When voice control is configured, you can speak commands as you would act by touch.

### WORKS WITH ALEXA

Download the Amazon Alexa App and turn on Amazon devices or 3<sup>rd</sup> party Alexa built-in devices.

- Setup your Amazon account for your WiiM device
- If your WiiM device is not logged into your Amazon account in the WiiM Home App,
- Open WiiM Home App, click "Browse -> Amazon Alexa -> Sign in to Amazon."
  - Log in to your Amazon account
- Open the Amazon Alexa app
  - Tap the "Devices" at the bottom of the page.
  - Tap the "+" in the top right corner.
  - Tap "Combine speakers," then select "Multi-room music."
  - Select the configured Echo or other Amazon devices and the configured WiiM Pro Plus device
  - Click "Next" and choose the group name (i.e., Bedroom)
  - Amazon Alexa app prompts that the group has been created.
  - Try "Alexa, play some music in the Bedroom" for the multi-room audio with Echo.
- Or
- Choose the WiiM device as the preferred speaker. Thus, you don't need to say your device name when using Alexa.

### WORKS WITH SIRI

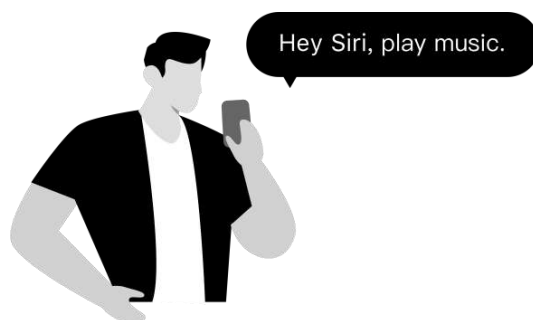

- Configure one to more devices
- Open a music app (like Apple Music) and select a track to play
- Tap .
- Select your speaker/speakers or Home Pod
- Say “Hey Siri, stop the music/Play music” on your phone or HomePod

## WORKS WITH GOOGLE VOICE ASSISTANT

Let’s assume you’ve set up your Google Home and WiiM Pro Plus separately. Now, you must link them together in the Google Home app for Android or iOS:

- Open the Google Home app, and you will find the WiiM Pro Plus enabled as a Chromecast audio device under “Local devices.”
- Tap the name of the WiiM Pro Plus and enter the device control UI.
- Tap the “Add to a room” button under the volume circle to add WiiM Pro Plus to one room.
- You can use voice to control the WiiM Pro Plus with your Google Home or Android devices.

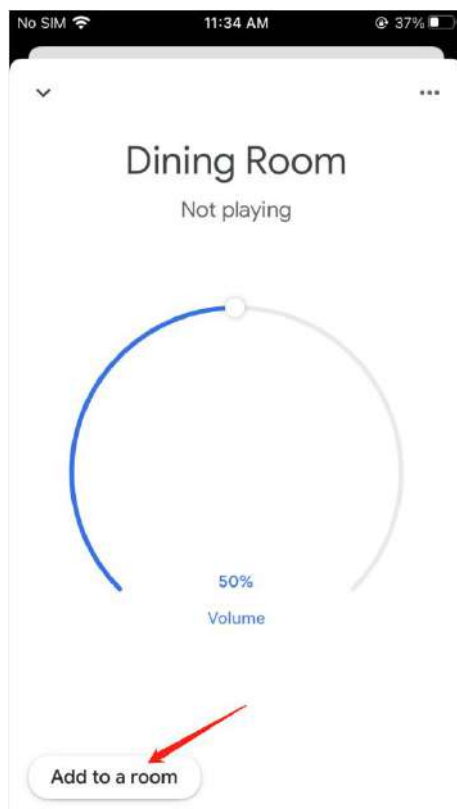



## 7. DIRECT CONTROL VIA YOUR FAVORITE APP

You can stream from your favorite apps directly to your WiiM Pro Plus with the following approaches.

Depending on your mobile devices and music service, there may be multiple ways to stream from your music app to WiiM devices. I.e., if you use Spotify App on iOS device, you can use either Spotify Connect or AirPlay 2. However, Spotify Connect gives you better audio quality compared with AirPlay 2 and liberate your phone for other tasks.

### SPOTIFY CONNECT

Spotify Connect is a way of playing Spotify through your wireless-compatible device over Wi-Fi. That means you can play your favorite tunes anywhere in the house without the need for convoluted Bluetooth pairing between devices whenever you want to listen to music.

Spotify Connect works from smart phone, tablet or PC that functions as a remote control for Spotify. Both free and premium account are supported. Go to [Spotify.com/connect](https://www.spotify.com/connect) to learn more. It's the best way to play Spotify on WiiM device giving the best possible audio quality and streaming experience.



The Spotify Software is subject to third-party licenses found here:  
<https://www.spotify.com/connect/third-party-licenses>

To use Spotify Connect with multiroom or stereo pairing, you can first group multiple WiiM devices on WiiM Home App then stream Spotify to the grouped devices. The group name is the same as the group master device.

### AIRPLAY 2

WiiM device turns your stereo into an AirPlay 2-enabled speaker to stream the music you love from iOS, Mac, and PC devices or stream audio from Apple TV. It's an easy and affordable way to connect your Apple devices to your favorite audio equipment and upgrade to an AirPlay 2 receiver.

AirPlay 2 lets you stream music from your iOS, MAC, PC, and Apple TV device to more than one product to create a multiroom audio experience over Wi-Fi.

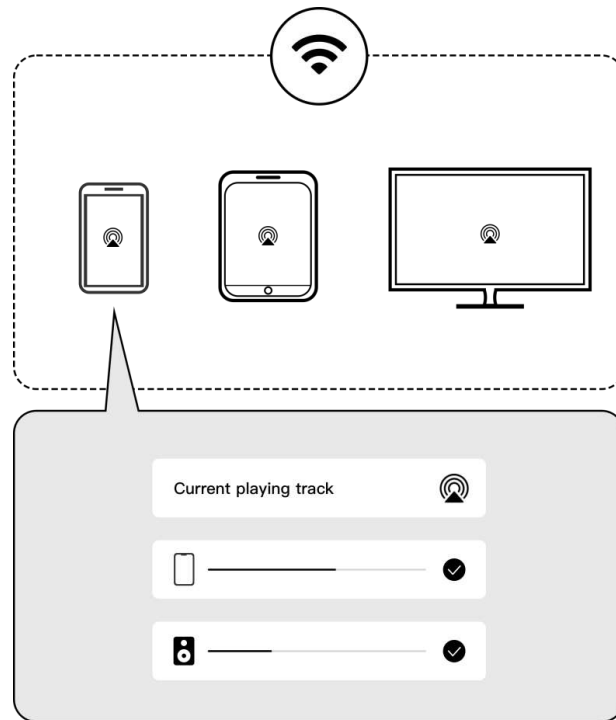
**NOTES:**

- To use AirPlay 2, you need an Apple device running iOS 11.4 or later.
- Your Apple device and WiiM device must be connected to the same Wi-Fi network.
- For more information about AirPlay 2, visit: <https://www.apple.com/airplay>

You can either start the AirPlay 2 streaming from the music App or the iOS control center. The steps are shown below for both cases.

**STREAM AUDIO FROM THE CONTROL CENTER**

1. On your Apple device, open the Control Center.
2. Tap and hold the audio card in the top-right corner of the screen, then tap the AirPlay icon .
3. Select your WiiM device.

**STREAM AUDIO FROM AN APP**

1. Open a music app (like Apple Music) and select a track to play.
2. Tap .
3. Select your WiiM device.

**TIDAL CONNECT**

TIDAL is a global music streaming platform bringing fans closer to artists through unique experiences and the highest sound quality. Stream your favorite music seamlessly from TIDAL App straight to your devices in the highest possible quality.

TIDAL Connect is a feature that allows you to stream music from the TIDAL App to compatible devices. It's similar to Apple AirPlay and Spotify Connect in that it lets users stream music to connected devices from within the App. This means you can use your smartphone or computer as a controller to play music on WiiM device.

WiiM Pro Plus also supports MQA decoder for the TIDAL Connect up to 24-bits/96 kHz if you subscribe to TIDAL Hi-Fi+ tier. If your external DAC or Amplifier can support MQA decoder or render, you can get even higher sample rate/bit depth than 24-bit/96 kHz.

To use Tidal Connect, you need to launch the Tidal App on your mobile device. Then find and play a song you like and head to the 'Now Playing' screen. Touch on the 'cast' icon at the top right on the 'Now Playing' screen and select a WiiM device from the list.

## **AMAZON MUSIC CAST (ALEXA CAST)**

Alexa Cast is a feature that allows you to play and control music on any of your Alexa devices from your Amazon Music iOS or Android app. You can discover all your Alexa devices from your music app. Your devices do not need to be on the same Wi-Fi network as your mobile device. You can target any device from anywhere. Once you pick a target device, the music you selected on your App will start playing on the chosen device. You can now follow along on your App. When you tap skip on your App, your device skips to the next track. Your App becomes a remote control for the device.

WiiM Pro Plus is one of the first devices that support Alexa Cast with bit-perfect output up to 192 kHz/24-bit. Thus, you can listen to your Amazon Music Ultra HD directly from the native Amazon Music to WiiM Pro Plus in the highest possible quality.

To use this, please log in to your Amazon account for Amazon Alexa on the WiiM Home App. Also, make sure you have the latest version of the Amazon Music app. Next, on the "Now Playing" screen, you will see a casting icon in the top right. Tapping the icon will bring up the list of all your available Alexa devices for you to select.

Once you have started casting, you can still use voice to control the music playing on the device. You can switch between using your voice and your App based on your convenience. When you want to stop casting to a device and resume playing on your phone, you will have to pull up the device list and tap the disconnect button.

## **CHROMECAST AUDIO**

Chromecast audio lets you instantly stream your favorite music, radio, or podcasts from your favorite Chromecast-enabled apps on the mobile device to your speakers over Wi-Fi. Once you have set up WiiM Pro Plus, you can enable Chromecast from the WiiM Home companion app. Then, open a compatible app on your smartphone or tablet and tap the Cast button. This will allow you to select your WiiM Pro Plus and start streaming audio to it.

Most music apps on both iOS and Android already support Chromecast such as Spotify, Apple Music, TIDAL, Amazon Music, YouTube Music and Deezer. You can also cast any audio from your Chrome browser by selecting Menu > Cast.

Chromecast can also be used for multi-room audio, playing music in sync to multiple speakers from compatible brands and WiiM Pro Plus, using the Google Home app.

## **DLNA**

DLNA stands for Digital Living Network Alliance. It is a trade organization that sets standards and guidelines for home networking devices, including PCs, smartphones, tablets, smart TVs, Blu-ray Disc players, home theater receivers, and media streamers, among others. When a DLNA certified device is added to a home network, it can automatically communicate and share media files with other connected DLNA products on the network.

WiiM Pro Plus is the DLNA digital media render. When it's connected to the same network as your other DLNA devices or apps, it appears in the menus of other networked components. Your computer and other media devices discover and recognize the WiiM Pro Plus without any setup.

You can control the WiiM Pro Plus from other DLNA digital media player or controller. You can also play content to the WiiM Pro Plus from other DLNA digital media servers, all without additional setup.

## 8. ALL MUSIC IN ONE APP

With the free WiiM Home App, you can control your content and devices from one place. We support many popular music streaming services in the App, such as Spotify, iHeartRadio, Tidal, Amazon Prime Music and Unlimited, SoundCloud, Qobuz, Pandora, Deezer, TuneIn & more to come. You can also play music stored in your mobile device, local network media servers, or personal cloud server.

The App supports the unified search across multiple music services and your local network for artist, track, station, playlist, etc. It's a powerful tool to discover your favorite content from your online and local library.

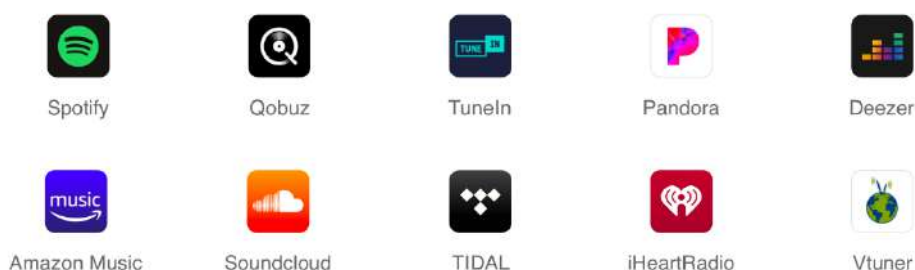

The WiiM Home App supports equalization (EQ) with two options: 24 EQ presets or a 10-band graphical EQ. These EQ settings can be assigned to different sources, such as AUX in, online music, or Bluetooth streaming.

The App has twelve music presets that allow you to save your favorite station, playlist, album, etc., and access them later with the preset button on the Pro Plus, remote, or the App with one tap.

## 9. MULTIROOM AND STEREO PAIRING

With the WiiM Pro Plus, it's easy to build your wireless multiroom sound system with other AirPlay 2 speakers, Amazon Echo (or Alexa built-in devices) or Google Home. You can create an even more flexible multiroom sound system with multiple WiiM Pro Plus, Pros Minis, and your existing audio devices.

### LINKPLAY MULTIROOM/STEREO PAIRING

With our proprietary multiroom scheme, all types of audio input, including Wi-Fi, BT, analog Line in, or digital SPDIF in, can be used as the audio source for the multiroom system.

In addition, you can group two speakers connected with WiiM devices as a stereo pair for a wider, more immersive sound stage. It supports all four input options too. Thus, it can work with almost every music listening option.

To use this, please follow the steps below.

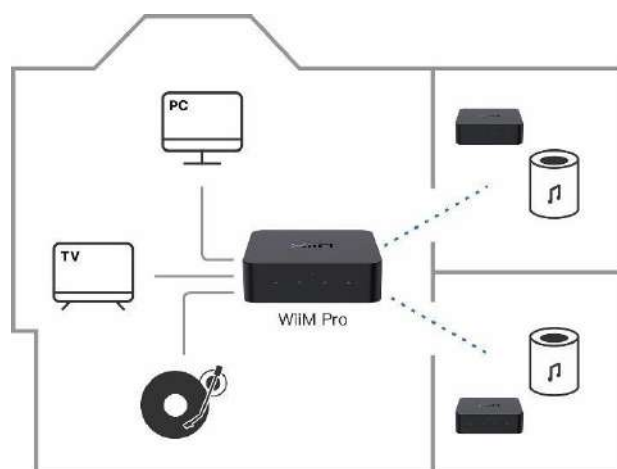

- Configure two or more devices.
- Open WiiM Home App.
- Select the device and click the plus sign in the upper right corner “+”
- Select the other WiiM device, click “Done”
- Click the LR icon “L” and set the device to “L/R/LR”
- Select Browse tab, choose your music to play.

### AMAZON ALEXA MULTIROOM

**TIP:** Download Amazon Alexa App and get ready with Echo or other Amazon devices. For detailed steps please refer to 6.1.

Since the WiiM Pro Plus is an Alexa Cast audio receiver, not a transmitter, it can't transmit the Line-in or Optical-in audio to other Alexa-enabled devices such as Echo.

## MULTIROOM WITH CHROMECAST AUDIO DEVICES

You can group WiiM Pro Plus with other Google Home or Chromecast audio enabled devices to play the same music on all devices via the Google Home App.

- Enter Google Home App, tap the “+” in the top left corner
- Tap “Create speaker group” to create a speaker group
- Select the devices that are in the same network
- Give a group name
- Stream music to the group

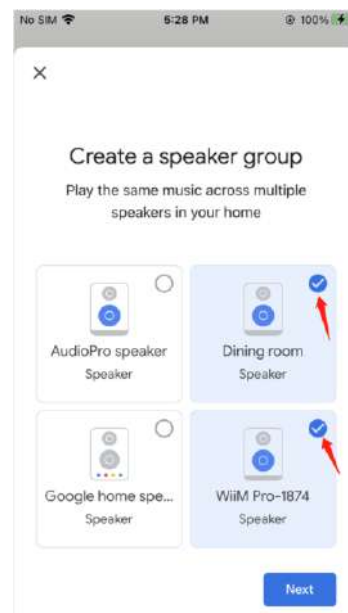

Since the WiiM Pro Plus is a Chromecast audio receiver, not a transmitter, it can't transmit the Line-in or Optical-in audio to other Chromecast audio devices such as Google Home.

## 10. AUDIO INPUT VIA LINE IN OR SPDIF IN

Unlock the full potential of the WiiM Pro Plus by employing it as a preamplifier and network audio transmitter via Wi-Fi or Ethernet. You can seamlessly stream analog or digital audio input from devices like CD players, vinyl players, TVs, or computers to other WiiM connected devices, or AirPlay compatible speakers such as HomePod or Sonos.

To set up your WiiM Pro Plus with Line-IN:

1. Insert the line-in cable into the LINE IN port on the WiiM Pro Plus's rear.
2. Connect the other end of the cable to your record player.
3. In the WiiM Home app, navigate to 'Browse' tab > Select source on device > LINE IN, and designate LINE IN as the audio source.
4. Form a multiroom music group with your WiiM Pro Plus. In the WiiM Home app, go to Devices and choose the WiiM Pro Plus linked with your LINE-IN device. Tap the group button (depicted by a "link" icon within a box) at the upper right corner of the device box. Select the desired WiiM Pro Plus for audio transmission.
5. To cast audio to a wide array of AirPlay 2-enabled devices, please select from the list of the AirPlay receivers on "Now Playing" UI or device settings.

Upon completion, the music from the connected device will play across your multiroom music group.

You can follow the same procedure using the SPDIF input port of the WiiM device if your source device offers a digital audio output via SPDIF.

Additionally, you can enable the "Autosense" feature on the WiiM device, allowing it to automatically play your Line-In or Optical-In source upon detection of a signal. This feature can be activated within the WiiM Home App.

The WiiM device features a built-in EQ to tailor audio input to your preferences. Moreover, you can control audio volume remotely through the app, eliminating the need to adjust the audio input directly.

Note that certain source devices may require a preamp. For instance, some turntables lack a built-in preamp, necessitating connection to an external preamp before linking to the WiiM Pro Plus.



## 11. AUDIO OUTPUT VIA LINE/SPDIF/COAX/BT OUT

There are three separate audio output interfaces on WiiM Pro Plus that you can use to connect your DAC, Amplifier, or powered speaker. These are the analog LINE out, the digital optical (TOSLINK), and the Coaxial port. Please note that WiiM Pro Plus only outputs audio to one of the audio outputs.

It's important to select the correct audio output port. Otherwise, you may not be able to hear the sound.

If you want the bit-perfect audio output, please use the digital audio output and enable the fixed volume output. You can do so from the device setting on the WiiM Home App.

Thus, you have two ways to control the volume of your system.

- Control volume from your AVR or amplifier (Fixed volume output)
- Control the volume from the WiiM Home App. To do so, you need to turn off the fixed volume output.

### AUDIO OUTPUT VIA SPDIF/COAX/LINE OUT

- Depending on the output you prefer to use, plug the SPDIF/RCA/COAX end of the cable into the corresponding output port on the WiiM Pro Plus.
- Open the WiiM Home App on your iOS or Android device.
- Start playing on the output devices.

### AUDIO OUTPUT VIA BT OUT (BT sourcing mode)

- Open the WiiM Home App on your iOS or Android device.
- Select Device Tab, and tap the device setting gear icon.
- Tap the Audio Output setting and select Bluetooth to connect to an external Bluetooth device (such as an amplifier or speaker)
- Start playing music.

## **12.       STREAM AUDIO WITH BLUETOOTH**

With Bluetooth wireless technology, you can stream tunes from various devices like smartphones, tablets, TVs, and laptops. To start streaming, first pair your device with the WiiM Pro Plus. Initiate pairing mode by holding down the volume '+' and '-' buttons simultaneously for 2 seconds.

The Bluetooth feature is compatible with A2DP and AVRCP profiles, and supports both SBC and AAC codecs.

## **13. ADVANCED FEATURES**

### **FIRMWARE UPDATES**

- WiiM Pro Plus updates automatically when connected to your Wi-Fi network.
- Upgrades happen from 2:00-5:00 a.m. in your time zone. During the silent upgrade, there will be no sound and no indication. Upon opening the App, you will see the latest updates made to WiiM Pro Plus.

### **USE ETHERNET INSTEAD OF Wi-Fi**

When an Ethernet cable is connected, the WiiM Pro Plus will automatically switch off Wi-Fi to use the Ethernet network. To confirm which connection is active, open the WiiM Home App, go to the 'Browse' tab, and scroll down to the 'Select Audio Source' section at the bottom. If Ethernet is being used, it will display 'Ethernet' instead of 'Wi-Fi.'

## 14. FAQ

If you experience problems with the audio streamer, try these solutions first:

- What can I do if my WiiM Home App can't find the device?
  - Make sure your network is available and the device is powered on properly.
  - Check the LED on the device is solid white.
  - Make sure your device and WiiM Pro Plus are connected to the same Wi-Fi network.
  - Make sure you have the latest version of the WiiM Home App on your device.
  - Try restarting your device, WiiM Pro Plus, and router.
  - If still can't find, reconfigure the device to the network.

- What can I do if my device has no sound?

If you are not getting any sound from your WiiM Pro Plus, make sure you have checked the following things:

- The volume level on both the WiiM Home app and your receiver or device that you have connected to WiiM Pro.
- The input source on your receiver or device that matches the output of WiiM Pro Plus.
- The right audio output from WiiM Pro Plus is selected on the WiiM Home App.
- The physical connections between WiiM Pro Plus and your receiver or device, are plugged in correctly and securely.

- Audio dropout or no sound on AirPlay 2?

If you experience no sound with AirPlay 2 but has sound with other service, please check if the progress bar of music app on your Apple device is moving.

- Check network connectivity: Ensure the signal of your WiiM Pro Plus and your streaming device are strong. Move the WiiM Pro Plus and the streaming device closer to your wireless router or access point to improve the signal strength.
- Restart your network devices: Power cycling your network devices, including your router, modem, WiiM Pro Plus, and streaming devices, can often resolve connectivity issues.
- Update firmware and software: Ensure that your WiiM Pro Plus and all devices involved in the AirPlay 2 setup have the latest firmware and software updates installed. Additionally, update your streaming device (e.g., iPhone, iPad, Mac) to the latest version of iOS, iPadOS or macOS.
- Reset the WiiM Pro Plus: As a last resort, you can try performing a factory reset on your WiiM Pro Plus and set it up again.

- What can I do if my device cannot power on normally?
  - Check the device LED status and ensure it's on.
  - Ensure the original power adapter or 5V, 2A rating USB power adapter is

used.

## **SUPPORT**

If you are unable to resolve your issue, please send us a ticket through the App or send us an email about the issue you're experiencing.

WiiM Home App: Settings > Feedback, Settings > FAQ

Website: [faq.wiimhome.com/support/solutions](http://faq.wiimhome.com/support/solutions)

Email: [support@wiimhome.com](mailto:support@wiimhome.com)

Product User Guides: [wiimhome.com/guides](http://wiimhome.com/guides)

## **RESETTING WIIM PRO PLUS**

Press and hold the play/pause for 10s until you will hear the voice prompts of "Restore to factory setting" and see the light flashing red and white.

Factory reset clears all source, volume, and network settings for WiiM Pro Plus and returns it back to the original factory settings.

## 15. IMPORTANT SAFETY INSTRUCTIONS

IMPORTANT, RETAIN FOR FUTURE REFERENCE: READ CAREFULLY

1. Read these instructions.
2. Keep these instructions.
3. Heed all warnings.
4. Follow all instructions.
5. Do not use this apparatus near water.
6. Clean only with a dry cloth.
7. Do not block any ventilation openings. Install in accordance with the manufacturer's instructions.
8. Do not install near any heat sources such as radiators, heat registers, stoves, or other apparatus (including amplifiers) that produce heat.
9. Protect the power cord from being walked on or pinched particularly at plugs, convenience receptacles, and the point where they exit from the apparatus.
10. Only use attachments/accessories specified by the manufacturer.
11. Unplug this apparatus during lightning storms or when unused for long periods of time.
12. Refer all servicing to qualified personnel. Servicing is required when the apparatus has been damaged in any way, such as external power supply, power-supply cord or plug is damaged, liquid has been spilled or objects have fallen into the apparatus, the apparatus has been exposed to rain or moisture, does not operate normally, or has been dropped.
13. To reduce the risk of fire or electrical shock, do NOT expose this product to rain, liquids or moisture.
14. Do NOT expose this product to dripping or splashing, and do not place objects filled with liquids, such as vases, on or near the product.
15. Keep the product away from fire and heat sources. Do NOT place naked flame sources, such as lighted candles, on or near the product.
16. Do NOT make unauthorized alterations to this product.
17. Do NOT use in vehicles or boats.
18. Use this product only with the power supply provided.
19. Where the mains plug or an appliance coupler is used as the disconnect device, the disconnect device shall remain readily operable.
20. Due to ventilation requirements, does not recommend placing the product in a confined space such as in a wall cavity or in an enclosed cabinet.
21. Contains small parts which may be a choking hazard. Not suitable for children under age 3.
22. This product contains magnetic material. Consult your physician on whether this might affect your implantable medical device.
23. Do not place or install the bracket or product near any heat sources, such as fireplaces, radiators, heat registers, or other apparatus (including amplifiers) that produce heat.

## 16. CE/FCC Statements

**RF Exposure Information:** To maintain compliance with FCC RF exposure requirements, use the product that maintains a 20cm separation distance between the user's body and the host. MPE limit for RF exposure at prediction frequency and satisfy RF exposure compliance.

**FCC Statement:**

This device complies with part 15 of the FCC rules. Operation is subject to the following two conditions:

- (1) this device may not cause harmful interference, and
- (2) this device must accept any interference received, including interference that may cause undesired operation.

NOTE: The manufacturer is not responsible for any radio or TV interference caused by unauthorized modifications or changes to this equipment. Such modifications or changes could void the user's authority to operate the equipment.

NOTE: This equipment has been tested and found to comply with the limits for a Class B digital device, pursuant to part 15 of the FCC Rules. These limits are designed to provide reasonable protection against harmful interference in a residential installation. This equipment generates uses and can radiate radio frequency energy and, if not installed and used in accordance with the instructions, may cause harmful interference to radio communications. However, there is no guarantee that interference will not occur in a particular installation. If this equipment does cause harmful interference to radio or television reception, which can be determined by turning the equipment off and on, the user is encouraged to try to correct the interference by one or more of the following measures:

- Reorient or relocate the receiving antenna.
- Increase the separation between the equipment and receiver.
- Connect the equipment into an outlet on a circuit different from that to which the receiver is connected.
- Consult the dealer or an experienced radio/TV technician for help.

**CE Statement:**

RF exposure information: The Maximum Permissible Exposure (MPE) level has been calculated based on a distance of d=20 cm between the device and the human body. To maintain compliance with RF exposure requirement, use product that maintain a 20cm distance between the device and the human body.

Do not use the device in the environment at too high or too low temperature, never expose the device under strong sunshine or too wet environment. The suitable temperature for the product and accessories is 0°C-40°C.

**Operating frequency range and maximum transmit power**

Bluetooth: 2402MHz ~ 2480MHz, <9.11 dBm EIRP  
WLAN 2.4GHz: 2412MHz ~ 2472MHz, <20 dBm EIRP  
WLAN 5GHz: 5150MHz ~ 5825MHz, <20 dBm EIRP

The device for operation in the band 5150~5350 MHz is only for indoor use to reduce the potential for harmful interference to co-channel mobile satellite systems.

	AT	BE	BG	HR	CY	CZ	DK
	EE	FI	FR	DE	EL	HU	IE
	IT	LV	LT	LU	MT	NL	PL
	PT	RO	SK	SI	ES	SE	UK
	CH	IS	LI	NO	TR		

**This product can be used across EU member states.**

**EU Regulatory Conformance**

Hereby, Linkplay Technology Inc. Corporation declares that this device is in compliance with the essential requirements and other relevant provisions of Directive 2014/53/EU.

