

# ELECTRIC TEA KETTLE

USER MANUAL

CEK-207



INTASTING

Designed By INTASTING in California

INTASTING

## **CUSTOMER SUPPORT**

**INTASTING** offers a 2- years product warranty

If you have any questions or concerns  
please contact our customer support team with order number.

**EMAIL:** [support@intasting.com](mailto:support@intasting.com)

**PHONE:** +1 833 721 2799 (US) Mon-Fri 9 am - 5 pm (PST)

**THANK YOU FOR  
YOUR PURCHASE!**

# GENERAL SAFETY

Before use, please read these safety warnings carefully and use the kettle properly. These safety warnings are indicated for the safe and proper use of this product, to prevent danger to the user or others, and damage to property. When using electrical appliances, basic safety precautions should always be followed, including the following:

- Do not place on or near a hot gas burner or electric burner, in a heated oven, or in a microwave.
- Do not touch the hot surfaces of the product. Use the handle at all times.
- To protect against fire, electric shock, and injury to persons, do not immerse the cord, plug, or any other part of the kettle or base in water or other liquid.
- Never leave Kettle unattended when in use (including when in HOLD mode). Close supervision is necessary when any appliance is used by or near children. Do not use within a child's reach.
- Do not allow children to use or play with the kettle.
- Do not touch the base of the kettle or the metal pad immediately after the kettle has finished boiling, or while it is still boiling.
- Unplug from the outlet when not in use and before cleaning. Allow cooling before putting on or taking off parts and before cleaning the appliance.
- To disconnect from the power source, press the main button to switch "OFF" and then remove the plug from the outlet. Do not pull on the cord itself as it may damage the cord and eventually cause an electric shock.
- Ensure that your main supply voltage is the same as that marked on the underside of your kettle 120V.
- To avoid an electrical overload, do not operate another high-wattage appliance on the same circuit.
- If the kettle is faulty and damaged, please do not use the kettle again and attempt to repair it. Please ensure your own safety first and contact customer support to resolve and provide warranty service for you.
- Please do not use other accessories that are not included in the accessories. Only use the kettle with the base provided. Do not use the base for anything other than its intended use.
- Please add water up to the maximum and minimum scale marks. If the kettle is overfilled, hot water may be ejected. If the water level is below the minimum scale mark of the kettle, dry boiling the kettle may result in permanent damage and potential fire.
- Do not let the cord hang over the edge of the table or counter, or touch hot surfaces.
- Do not use a longer detachable power-supply cord or extension cord.
- Remove all moisture on the bottom of the kettle before placing it onto the power base.
- Do not use the kettle if your hands are wet.
- Kettle must be operated on a flat surface away from the edge of the counter to prevent accidental tipping.

# SPECIFICATION

Product Name	Electric Tea Kettle
Model	CEK-207
Power	1200W
Voltage	AC 120V
Frequency	60Hz
Capacity	0.3L-1L
Product Size	9.6*7.2*6.6 inches

# PRODUCT DIAGRAM

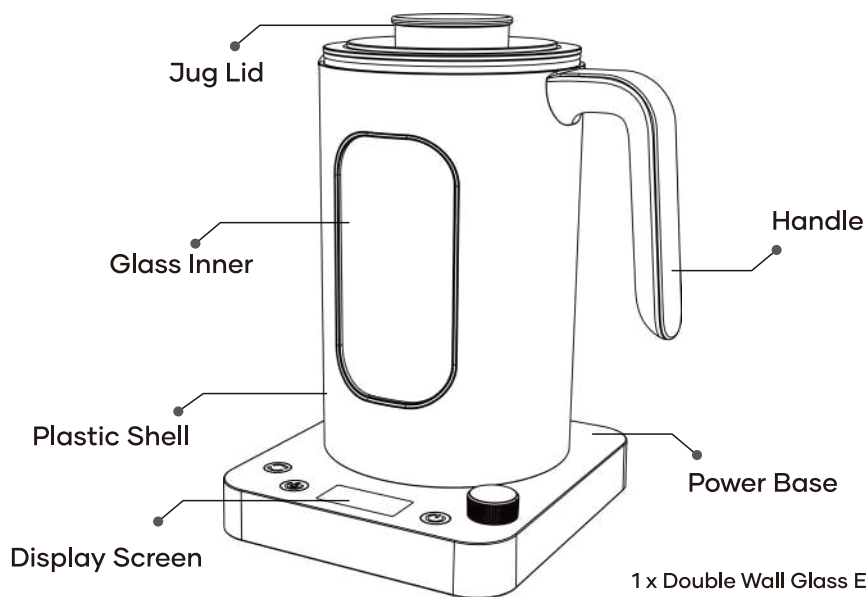

- 1 x Double Wall Glass Electric Kettle
- 1 x Rotatable Power Base
- 1 x User Manual
- 1 x Quick Start Guide

# OPERATION GUIDE

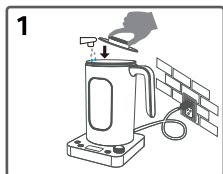

1. Add water to below the maximum water level line, plug in the power supply.

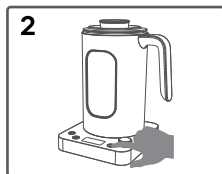

2. Click "Power button" to turn on the machine.



3. Rotate the knob to set the temperature or click "Custom temperature", then press "power button" to start heating.

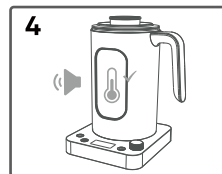

4. After reaching the set temperature, the machine will beep and finish its work.

## FUNCTION OVERVIEW

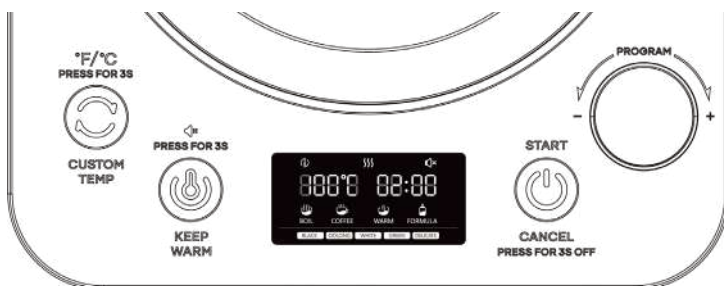



### Keep warm

Short press  button, the  icon will be displayed, and the kettle enter the keep warm mode.



### Temp unit switch

Long press  button to switch the temperature measurement unit.(°C/°F)

### Mute

Long press  button 3s enter "Mute" mode, the  icon will be displayed

### Start/Cancel

Short press the  button to turn on the kettle. Long press  button 3s to cancel all operation.

## Power base

Adapt to 120V AC, 60Hz voltage. Applicable to the US, CA, If you need to use it in other countries, please check whether the voltage is suitable?

## 9 Preset program

After turn on the kettle, you can spin the  knobs to select the 9 temp presets.

## Custom temp

Short press the  button to enter custom temp modle. Then you can



spin the  knobs to adjust the preset temp at  $\pm 1^{\circ}\text{F}$  unit.

# FEATURES

## Temp Set Memory

- The kettle will automatically memorize the set temperature when it was used last time. When you use the kettle next time, you don't need to set the temperature again, and the kettle will heat at the same temperature.
- When the set temperature is changed, the changed temperature will be automatically memorized.
- The memory function is reset when the power supply is no longer supplied, such as when the power plug is unplugged.



## Temp Unit Switching

- You need to press the  button to enter standby mode before press switch temperature units.
- The default temperature unit setting is  $^{\circ}\text{F}$
- Enter the standby state, Long press the  button to switch the temperature measurement unit. ( $^{\circ}\text{C}/^{\circ}\text{F}$ )

## Keep Warm

- If the current water temperature is lower than the set keep temperature, the kettle will heat up to the set temperature and enter the "keep keep" mode.
- When the water temperature reaches the set temperature, the kettle will automatically enter the "HOLD" mode.
- The default temp of keep warm setting is:  $80^{\circ}\text{C}/176^{\circ}\text{F}$



## 9 Preset Temperatures

- Turn the  knob to select a preset temperature setting: Green Tea, Black Tea. The corresponding temperature icon will light up.
- After entering the custom temperature mode, the preset temperature cannot be selected by rotating the temperature knob, and you need to long press the  3s to return to the main menu.

## Custom Temp

- Short press the "CUSTOM TEMP" button, the buzzer will sound once, and the CUSTOM TEMP button light will always be on.
- Rotate the  knob to customize the heating and holding temperature.
- Adjustable temperature range: 40~100°C, 100~212°F

## Mute

- Long press the  button for 3s, the kettle enters "MUTE" mode, The  icon will be displayed

## Add Water Reminder

- When the kettle is dry and running out of water, It will remind by 3 times beep, and the screen will display "EEE°E"
- You need lift the kettle and adding water, then put the kettle back, then short press the  button to start boiling.

# TEMPERATURE PRESETS

The following are the built-in preset temperature programs for the kettle. Please note, since tea has a wide range of types, the tea steeping temperatures below are basic guidelines. If your tea comes with brew instructions, we recommend following their instructions. (Customer can customize the temperature, please refer to "FEATURES" for details)

BOIL	212°F(100°C)
COFFEE	203°F(95°C)
WARM	136°F(58°C)
FORMULA	113°F(45°C)
BLACK	205°F(96°C)
OOLONG	194°F(90°C)
WHITE	185°F(85°C)
GREEN	176°F(80°C)
DELICATE	158°F(70°C)

## CLEANING AND STORAGE

### Cleaning

- Before cleaning, be sure the base is unplugged and the kettle has cooled completely. Empty any remaining water from the kettle.
- Wash the inside of the kettle with soapy water and rinse. **NEVER IMMERSE THE KETTLE IN WATER OR OTHER LIQUIDS.**
- Do not place in a dishwasher.
- Wipe the exterior of the kettle and base with a damp cloth or sponge and dry. Do not use abrasive soaps, cleansers, or scouring pads on any part of the kettle as it may damage the finish.
- Over time, the kettle may heat up but won't boil; this may be due to scaling and mineral deposits which can build up inside the kettle depending on your use and the hardness of the water in your area. When this happens, it's time for descaling. Use a scale/lime remover and follow its manufacturer's directions.
- Due to the impact of water quality in different areas, in the process of water heating will produce calcium carbonate oxide, lighter floating on the surface of the water to form a floating foam, heavier precipitation of the bottom of the pot into scale. The presence of limescale Will increase the boiling water resonance noise, but also affect the heat transfer to extend the boiling time. It must be cleaned up regularly with citric acid descaling agent, or you can use vinegar (preferably white vinegar). Put water and vinegar in 2:1 ratio into the pot and heat it, boil it and leave it overnight, pour the solution off the next day and clean it once by boiling it with water.



## Storage

- Before storing, please clean and dry all components, and then place the kettle in its box or in a spot that is both clean and dry.
- Please don't wrap the power cord around the kettle.

## TROUBLESHOOTING

Problem	Solution
The screen display "EEE°E"	When the screen displays "EEE°E", it means that there is no water in the kettle and it is boiling dry. At this time, the kettle should be lifted from the power base, and after adding water, press the "START/CANCEL" button again to start boiling water.
The kettle doesn't work	First of all, please check whether the kettle is powered on and whether the power voltage is suitable? Then check whether the kettle is placed flat on the power base? If that doesn't work, please contact customer support
The screen display "----*F"	When the screen display "----*F", it means that the kettle is not horizontally stable in the power base. Please recalibrate the kettle's position.

# HIGH ALTITUDE USE

At higher elevations, water will boil at a lower temperature. At sea level, water boils at 100°C(212°F). For every 500 feet/152 meters in elevation gain, the boiling point increases by approx. 0.5°C(0.9°F). Please use the following chart to adjust your temperature accordingly. Caution: Choosing a SET temperature greater than your relative boiling point can result in the kettle overflowing.

## NOTE:

At higher elevations, water will boil at a lower temperature. At sea level, water boils at 212°F. For every 500 feet/152 meters in elevation gain, the boiling point for water decreases by approx. 0.9°F/0.5°C.

Altitude, ft (m)	Boiling point of water, °F (°C)
0 (0 m)	212°F (100°C)
500 (150 m)	211.1°F (99.5°C)
1,000 (305 m)	210.2°F (99°C)
2,000 (610 m)	208.4°F (98°C)
5,000 (1524 m)	203°F (95°C)
6,000 (1829 m)	201.1°F (94°C)
8,000 (2438 m)	197.4°F (91.9°C)
10,000 (3048 m)	193.6°F (89.8°C)
12,000 (3658 m)	189.8°F (87.6°C)
14,000 (4267 m)	185.9°F (85.5°C)
15,000 (4572 m)	184.1°F (84.5°C)

## NOTE:

When the electric kettle is boiling water, the normal water volume is 1.0L. If the tea blue is used to boil tea, the water volume should be controlled at 0.8L.

# NEED HELP? TALK TO US!

---

## CUSTOMER SUPPORT

Phone: +1 833 721 2799 (US) Mon-Fri 9 am - 5 pm (PST)

✉ [support@intasting.com](mailto:support@intasting.com)

24-Months Warranty

## Manufacturer

**Shenzhen Intasting Technology Co., LTD**

518100

Guangdong Shenzhen

Xinghe World Tower C, 33rd Floor

Longhua District

Designed by INTASTING in California, Made in China



## FCC Statement

This device complies with Part 15 of the FCC Rules.

Operation is subject to the following two conditions:

(1) this device may not cause harmful ainterference, and (2) this device must accept any interference received, including interference that may cause undesired operation.