



500-WATT PERSONAL POWER BLENDER

Model: BL3460



User Manual



**- READ ALL INSTRUCTIONS BEFORE USE -
FOR HOUSEHOLD USE ONLY**

PARTS AND ACCESSORIES

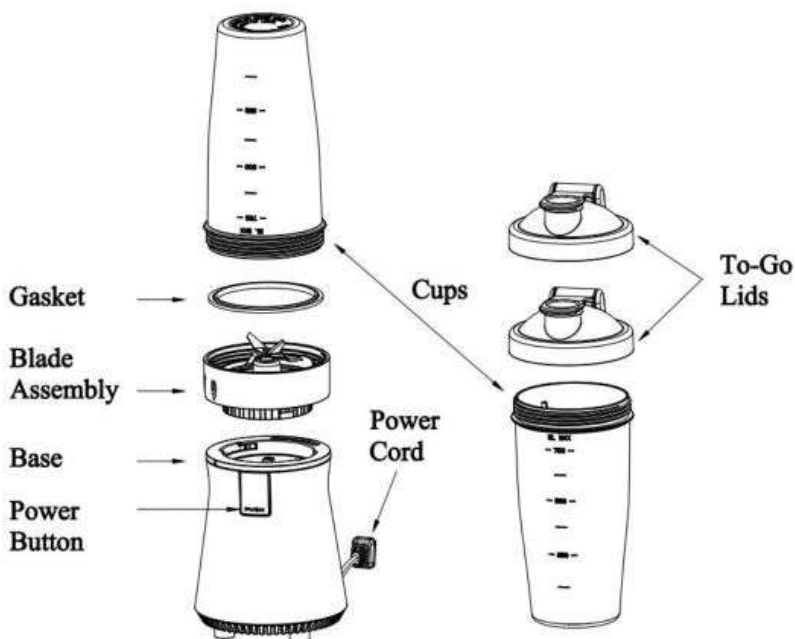

- 1 X 500W Motor Base
- 1 X Blade Assembly
- 2 X 750ml Blending/Drinking Jars (Cups)
- 2 X To-Go Lids

Electrical Specifications

Voltage	Frequency	Wattage
120V ~	60 Hz	500 W

How to use the blender

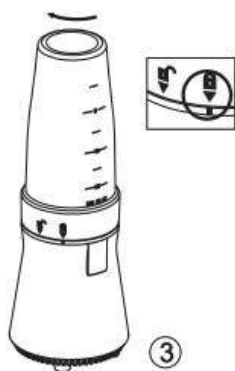
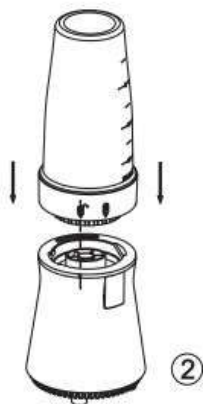

IMPORTANT SAFEGUARDS

READ ALL INSTRUCTIONS

When using electrical appliances, basic safety precautions should always be taken:

1. To protect against risk of electrical shock do not put cord, plug, or base in water or other liquid.
2. Close supervision is necessary when the appliance is used by or near children.
3. Unplug from the outlet when not in use, before putting on or taking off parts, and before cleaning.
4. Avoid contact with moving parts.
5. Do not operate any appliance with a damaged cord or plug, or after the appliance malfunctions or is dropped or damaged in any manner. Contact our customer service for information on examination, electrical repair, mechanical repair, or adjustment.
6. The use of attachments not recommended by the manufacturer may cause a risk of injury to persons.
7. Do not use outdoors.
8. Do not let the cord hang over edge of table or counter or touch hot surface including the stove.
9. Keep hands and utensils away from moving blades while processing food to reduce the risk of severe injury to persons or damage to the food chopper. A scraper may be used but must be used only when the food chopper is not running.
10. Blades are sharp. Handle carefully.
11. This appliance is intended for processing small quantities of food for immediate consumption. This appliance is not intended to prepare large quantities of food at one time.
12. To reduce the risk of injury, never place the cutting blade on base without first putting bowl properly in place.
13. Be certain the Cup Assembly is securely locked in place before operating appliance.
14. Keep the product and the Power Cord away from heat sources.
15. This product is intended solely for indoor, non-commercial, non-industrial use in processing liquids and foods for human consumption; do not use the product outdoors or for any other purpose.
16. Do not blend hot liquids.
17. Always operate the product with the Blade Assembly in place.
18. Do not attempt to place the Jar on the Base or remove the Jar from the base while the motor is running.

19. To disconnect the product from an electrical outlet, pull directly on the plug; do not pull on the Power Cord.
20. Do not put any stress on the Power Cord where it connects to the product, as the Power Cord could fray and break.
21. If using an extension cord with this product, the marked electrical rating of the cord set must be at least as great as the electrical rating of the product.
22. Always operate the product on a flat, level, stable surface.
23. Do not allow the Power Cord to hang, such as over the edge of a table or counter, where it may be tripped over or pulled.
24. Each time the product is used, do not plug into an electrical outlet until the Blade Assembly and Cup are securely attached to each other and then locked in place on the Base.

SAVE THESE INSTRUCTIONS!

FOR HOUSEHOLD USE ONLY

Task	Type load	Attachment	capacity	Operating Time
Chopper	Chicken breast	28 oz Colossal cup with Cross Blade	140g Max	10S
Blender	Carrots and water	28 oz Colossal cup with Cross Blade	300g carrot, 450g water	1 min

Recipe

CAUTION: Never grind hard nuts

iCucina LIMITED WARRANTY

LIMITED ONE-YEAR WARRANTY: Thank you for choosing iCucina Portable Bullet Blender. This product is warranted to be free from defects in material and workmanship under normal household use during the first one year from the date of original purchase with receipt. We will repair or replace it at our option. The limited warranty shall not apply to damages resulting from accidents, abuse, misuse, damage caused by shipping, or failure to follow safety instruction. The warranty is valid only for first quality goods purchased from an authorized resale and only valid in the United States.

CUSTOMER SERVICE INFORMATION

If you have any questions regarding to the warranty, the operation of iCucina appliances, or need parts for your appliance, please contact us via email: service@icucinakitchen.com. Inquires will be answered promptly. Thank you for purchasing!



Thimax Inc. Irvine, CA 92618

