

# Aqara

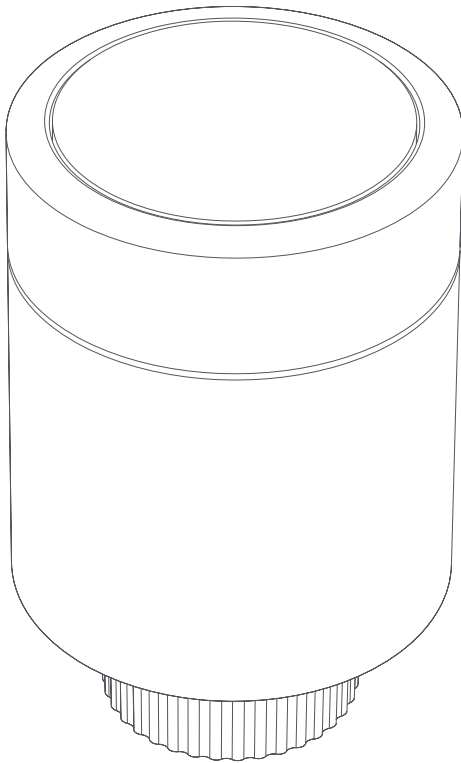

## Product Introduction

Radiator Thermostat W600 is a smart valve thermostat with a built-in low-power wireless communication module, Zigbee/Thread dual protocol support, an LED display, and is powered by 2 AA batteries. The device can be used on its own, or can be added to the Aqara Home app through a hub, transforming it into a smart home thermostat with advanced features and controls. Installing the thermostat for water-heated radiators is uncomplicated, and it maintains comfortable temperatures while reducing energy waste. When linked to temperature, humidity, door and window sensors, it can integrate into a full house automated climate control system.

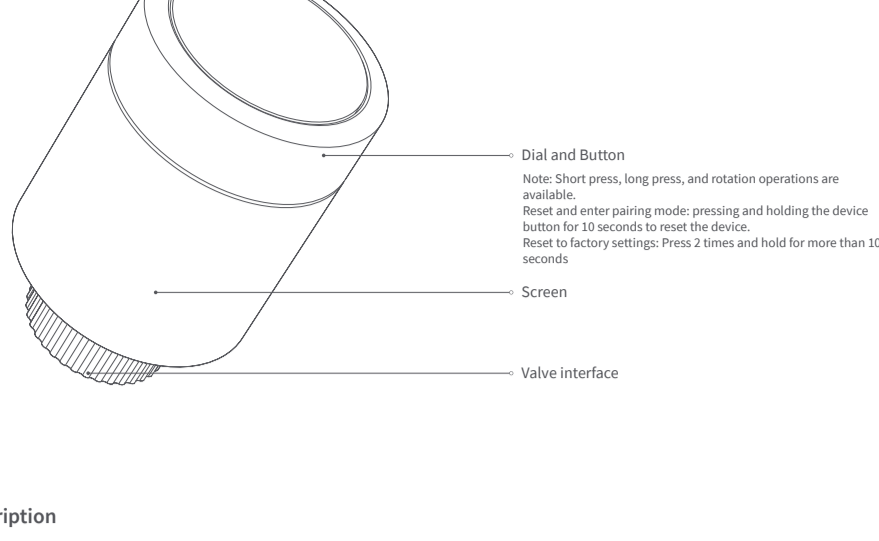

## Icon Description

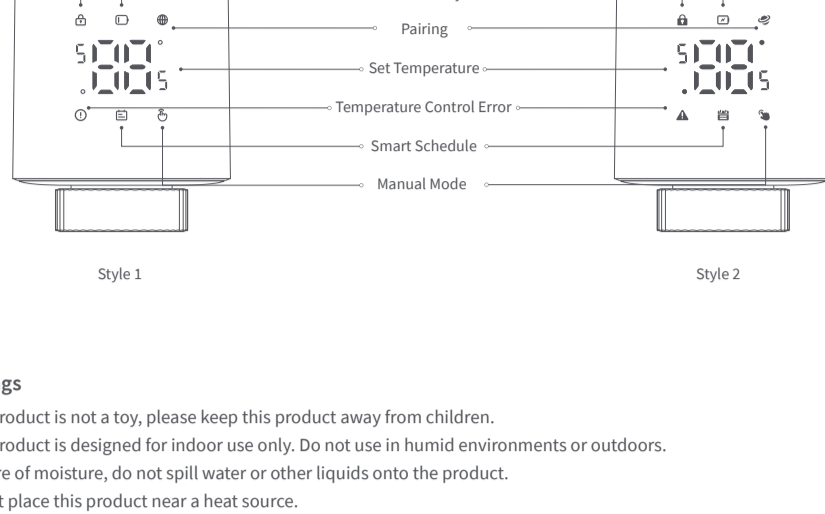

## Warnings

1. This product is not a toy, please keep this product away from children.
2. This product is designed for indoor use only. Do not use in humid environments or outdoors.
3. Beware of moisture, do not spill water or other liquids onto the product.
4. Do not place this product near a heat source.
5. Do not attempt to repair the product by yourself. All repairs should be performed by authorized personnel.
6. This product is designed only for improving the convenience of household life, and for sending notifications. If the user violates the product instructions and this warning, the manufacturer is not responsible for any risks and property losses caused thereby.

## Quick Setup

### (1) Access to Aqara Home

1. Download the Aqara Home app

Search for "Aqara Home" in the app store or scan the QR code below to download the "Aqara Home" app.

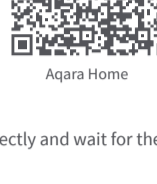

Aqara Home

### (2) Power on

Follow the instructions to install the thermostat correctly and wait for the device to power on.

### 3. Add device

Open the Aqara Home app, click "+" in the upper right corner of the home page, and select the device accordingly.

\* If the addition fails, move the device closer to the hub and try again.

\* Make sure that there is a hub that supports this device (such as, Hub M3) under the Aqara account, and it is within the connection range when using it.

### (2) Access to a 3rd-Party Matter ecosystem

#### Method 1:

1. Please make sure you have installed the Matter-compatible app and have a Matter-compatible Thread border router.
2. After the device is powered on, the indicator light will begin to flash slowly, indicating that the device has entered pairing mode.
3. Open the Matter-enabled app, scan the Matter QR code on the user manual or product, or enter the setup code to add the device to the app.

#### Method 2:

After adding the device to the Aqara Home app, select "Matter Ecosystem" on the settings page, and follow the prompts to join. Synchronize device-specific actions (such as single press, long press) to the Matter platform that supports "wireless switch" and "temperature and humidity sensor" device types (such as Apple Home, Home Assistant), and trigger automation and scenes.

\*For help, please visit: [www.aqara.com/support](http://www.aqara.com/support).

## Device Installation

### Installation Instructions

1. Before use, pull out the battery tab and confirm that the device is turned on.

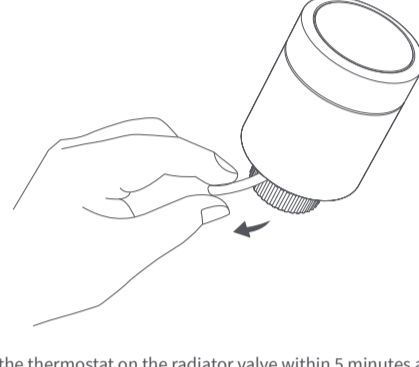

2. It is recommended to install the thermostat on the radiator valve within 5 minutes after the device starts.

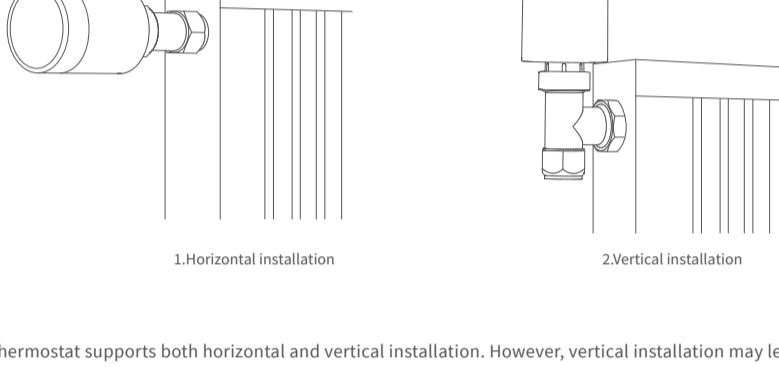

- a. The thermostat supports both horizontal and vertical installation. However, vertical installation may lead to inaccurate temperature readings because the built-in temperature sensor is close to the radiator.  
Note: Regardless of the installation method, an external Aqara temperature and humidity sensor is recommended to ensure a more precise temperature control.

- b. Align the thermostat interface nut with the radiator valve, and rotate the nut until it is tight.  
Note: The installation of the [M30\*1.5 mm] valve interface is as shown in the diagram.

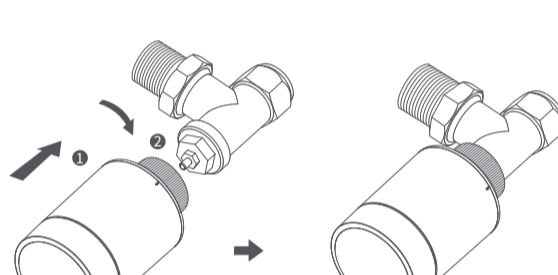

- c. When the screen displays the number [F1], press the thermostat button 3 times continuously to calibrate the valve. During calibration, the screen will show the [F2] symbol. ( Note: If [F1] is not displayed, you can try pressing and holding the device button for 10 seconds to reset the device.)

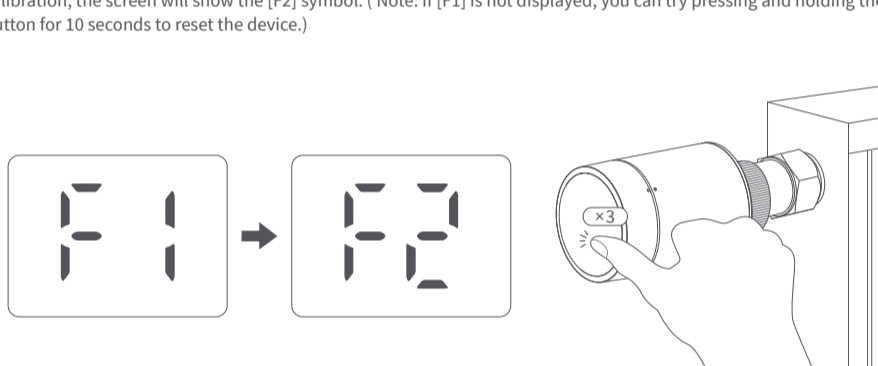

- d. The [F2] symbol will disappear after approximately 10 seconds, and the screen will display the current set temperature, indicating that the installation is complete.

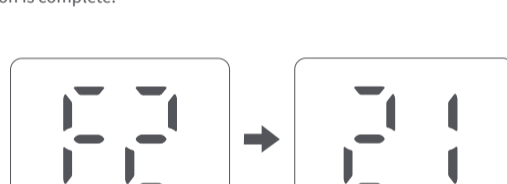

## How to Use

### 1. Frost Protection

When the built-in temperature sensor detects a temperature of  $\leq 5^{\circ}\text{C}$ , the device will automatically activate its anti-freeze protection and initiate heating; when the built-in temperature sensor detects a temperature of  $> 8^{\circ}\text{C}$ , the device will turn off anti-freeze protection and resume normal operation. (The anti-freeze mode in Zigbee is adjustable, with an adjustment range of  $5\text{--}15^{\circ}\text{C}$ . Under the Thread protocol, it is defaulted to  $5^{\circ}\text{C}$  and cannot be adjusted.)

### 2. Open Window Detection

Once Window Detection is enabled:

No door/window sensor bound: If the temperature drops by  $3^{\circ}\text{C}$  within 5 minutes, Heating mode will automatically pause for 30 minutes.

With a bound door/window sensor: If the sensor detects that a door or window has been open for more than 3 minutes, Heating mode will automatically pause for 30 minutes.

Note: You can deactivate the window detection function on the W600 device itself.

### 3. Schedule

The device will automatically control the heating system according to the preset time period and temperature, allowing different temperature to be set for the morning, daytime, evening and night time periods for each day of the week. A single schedule supports up to 7 time periods, each of which is at least 15 minutes.

### 4. Manual Control

Turn the heating on or off by manually adjust the target temperature, or select a comfortable heating temperature by manually switching presets (if a schedule is created, the device will follow the schedule after the Hold time ends).

### 5. Presets

Preset	Description
Home	The default temperature is $26^{\circ}\text{C}$ , but can be customized
Away	The default temperature is $18^{\circ}\text{C}$ , but can be customized
Go to Sleep	The default temperature is $24^{\circ}\text{C}$ , but can be customized
Sleep	The default temperature is $20^{\circ}\text{C}$ , but can be customized
Vacation	The default temperature is $10^{\circ}\text{C}$ , but can be customized. (Tip: If you are unsure about the duration of your vacation, we recommend setting the hold duration to permanent.)

### 6. Calibration

Supports calibration of built-in temperature and humidity sensors, with an adjustment range of  $-5\text{--}+5^{\circ}\text{C}$  and an adjusting increment of  $0.5^{\circ}\text{C}$

### 7. Fully on and fully off the modes

When you rotate the device beyond the minimum temperature adjustment range (continue rotating when the set temperature is below  $5^{\circ}\text{C}$ ), the device valve will be fully closed, and the screen will display OF at this time.

When you rotate beyond the maximum temperature adjustment range (continue rotating when the set temperature is above  $30^{\circ}\text{C}$ ), the device valve will be fully open, and the screen will display ON at this time.

## Device Interface

### Resetting the Device

Function	Operation	Description
Reset	Press and hold for 10 seconds	Deletes network configuration information; time-related functions and operations will no longer be executed.
Factory Reset	Double-click then press and hold for 10 seconds	Deletes all information and restores the device to the factory default state.

Status	Button	Result
Always: (except when anti-deletion is enabled)	Press and hold for 10 seconds	Resets the device's network information, enters pairing mode, and the network configuration icon flashes
Before Installation: (in the installation interface [F1])	Press the button 3 times in a row	Enters calibration state: switches from [F1] to [F2] calibration interface
After Installation	Single press	When the screen is off, a single press lights up the screen to display the current indoor temperature
	Rotation	Set target temperature
	Press and hold for 3 seconds	Enables child lock (child lock icon lights up) / disables child lock (child lock icon goes off)
	Press 5 times in a row	Flip the temperature number display on the device

## Indicator Descriptions

Function Description	Interaction Method
Pairing Successful	[Pairing] icon is displayed
Pairing Failed	[Pairing] icon turns off
Insert Battery	LED screen fully lights up for 2 seconds then turns off
Reset / Restore Factory Settings	LED screen fully lights up for 2 seconds then turns off
No operation for 10s after screen lights up	LED screen turns off and enters standby mode
Before Installation	Screen displays [F1]
Calibration	Screen displays [F2]
Device Valve Fully Open	Screen displays [ON]
Device Valve Fully Closed	Screen displays [OF]

## Product Specifications

Radiator Thermostat W600

Model: WT-A03E, WT-A03D

Wireless Protocols: Thread, Zigbee, BLE

Dimensions:  $\varnothing 57 \times 90$  mm ( $\varnothing 2.24 \times 3.54$  in.)

Battery:  $3\text{V} = (2 \times 1.5\text{V AA, Alkalinity})$

Threaded Connection:  $\text{M}30 \times 1.5$  mm

Operating Temperature:  $\text{T}40(0 \sim 40^{\circ}\text{C})$

Operating Humidity:  $0 \sim 95\%$  RH, no condensation

Made in China

What's in the Box: Radiator Thermostat W600  $\times$  1, User Manual  $\times$  1, 1.5V AA Battery  $\times$  2, Adapter (RA/RAV/RAVL/Caleffi/Giacomini/M28 $\times$ 1.5)  $\times$  6

## Notice

Use of the Works with Apple badge means that an accessory has been designed to work specifically with the technology identified in the badge and has been certified by the developer to meet Apple's performance standards. Apple is not responsible for the operation of this device or its compliance with safety and regulatory standards.

The Bluetooth® word mark and logos are registered trademarks owned by Bluetooth SIG, Inc. and any use of such marks by [Lumi United Technology Co., Ltd.] is under license. Other trademarks and trade names are those of their respective owners.

Manufacturer: Lumi United Technology Co., Ltd.

Address: Room 801-804, Building 1, Chongwen Park, Nanshan iPark, No. 3370, Liuxian Avenue, Fuguang Community, Taoyuan Residential District, Nanshan District, Shenzhen, China

Online Customer Service: [www.aqara.com/support](http://www.aqara.com/support)

Email: [support@aqara.com](mailto:support@aqara.com)