

COPYRIGHT © Hangzhou EZVIZ Software Co., Ltd. ALL RIGHTS RESERVED.

Any and all information, including, among others, wordings, pictures, graphs are the properties of Hangzhou EZVIZ Software Co., Ltd. (hereinafter referred to as “EZVIZ”). This user manual (hereinafter referred to as “the Manual”) cannot be reproduced, changed, translated, or distributed, partially or wholly, by any means, without the prior written permission of EZVIZ. Unless otherwise stipulated, EZVIZ does not make any warranties, guarantees or representations, express or implied, regarding to the Manual.

About this Manual

The Manual includes instructions for using and managing the product. Pictures, charts, images and all other information hereinafter are for description and explanation only. The information contained in the Manual is subject to change, without notice, due to firmware updates or other reasons. Please find the latest version in the EZVIZ™ website (<http://www.ezviz.com>).

Revision Record

New release – January 2025

Trademarks Acknowledgement

EZVIZ™, ™, and other EZVIZ’s trademarks and logos are the properties of EZVIZ in various jurisdictions. Other trademarks and logos mentioned below are the properties of their respective owners.

Legal Disclaimer

TO THE MAXIMUM EXTENT PERMITTED BY APPLICABLE LAW, THE PRODUCT DESCRIBED, WITH ITS HARDWARE, SOFTWARE AND FIRMWARE, IS PROVIDED “AS IS”, WITH ALL FAULTS AND ERRORS, AND EZVIZ MAKES NO WARRANTIES, EXPRESS OR IMPLIED, INCLUDING WITHOUT LIMITATION, MERCHANTABILITY, SATISFACTORY QUALITY, FITNESS FOR A PARTICULAR PURPOSE, AND NON-INFRINGEMENT OF THIRD PARTY. IN NO EVENT WILL EZVIZ, ITS DIRECTORS, OFFICERS, EMPLOYEES, OR AGENTS BE LIABLE TO YOU FOR ANY SPECIAL, CONSEQUENTIAL, INCIDENTAL, OR INDIRECT DAMAGES, INCLUDING, AMONG OTHERS, DAMAGES FOR LOSS OF BUSINESS PROFITS, BUSINESS INTERRUPTION, OR LOSS OF DATA OR DOCUMENTATION, IN CONNECTION WITH THE USE OF THIS PRODUCT, EVEN IF EZVIZ HAS BEEN ADVISED OF THE POSSIBILITY OF SUCH DAMAGES.

TO THE MAXIMUM EXTENT PERMITTED BY APPLICABLE LAW, IN NO EVENT SHALL EZVIZ’S TOTAL LIABILITY FOR ALL DAMAGES EXCEED THE ORIGINAL PURCHASE PRICE OF THE PRODUCT.

EZVIZ DOES NOT UNDERTAKE ANY LIABILITY FOR PERSONAL INJURY OR PROPERTY DAMAGE AS THE RESULT OF PRODUCT INTERRUPTION OR SERVICE TERMINATION CAUSED BY: A) IMPROPER INSTALLATION OR USAGE OTHER THAN AS REQUESTED; B) THE PROTECTION OF NATIONAL OR PUBLIC INTERESTS; C) FORCE MAJEURE; D) YOURSELF OR THE THIRD PARTY, INCLUDING WITHOUT LIMITATION, USING ANY THIRD PARTY’S PRODUCTS, SOFTWARE, APPLICATIONS, AND AMONG OTHERS.

REGARDING TO THE PRODUCT WITH INTERNET ACCESS, THE USE OF PRODUCT SHALL BE WHOLLY AT YOUR OWN RISKS. EZVIZ SHALL NOT TAKE ANY RESPONSIBILITIES FOR ABNORMAL OPERATION, PRIVACY LEAKAGE OR OTHER DAMAGES RESULTING FROM CYBER ATTACK, HACKER ATTACK, VIRUS INSPECTION, OR OTHER INTERNET SECURITY RISKS; HOWEVER, EZVIZ WILL PROVIDE TIMELY TECHNICAL SUPPORT IF REQUIRED. SURVEILLANCE LAWS AND DATA PROTECTION LAWS VARY BY JURISDICTION. PLEASE CHECK ALL RELEVANT LAWS IN YOUR JURISDICTION BEFORE USING THIS PRODUCT IN ORDER TO ENSURE THAT YOUR USE CONFORMS TO THE APPLICABLE LAW. EZVIZ SHALL NOT BE LIABLE IN THE EVENT THAT THIS PRODUCT IS USED WITH ILLEGITIMATE PURPOSES.

IN THE EVENT OF ANY CONFLICTS BETWEEN THE ABOVE AND THE APPLICABLE LAW, THE LATTER PREVAILS.

Table of Contents

Overview	1
1. Package Contents	1
2. Basics	1
Get the EZVIZ App	2
Preparations	3
1. Remove Cover	3
2. Remove Insulation Strip	3
Add Device	4
Installation	5
1. Put on the Table	5
2. Stick on the Wall	5
Battery Installation and Replacement	6
1. Install Battery	6
2. Replace Battery	6
3. Removable Lithium ion Battery(CR2032)	6
INFORMATION FOR PRIVATE HOUSEHOLDS	7

Overview

1. Package Contents



Bluetooth Remote Control (x1)



Double-sided Tape (x2)



Pin (x1)



Regulatory Information (x1)



Quick Start Guide (x1)

2. Basics

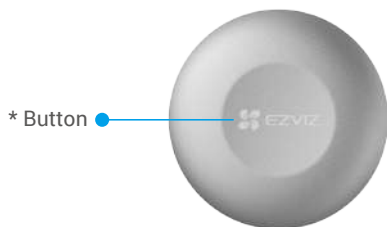

* Button

Front

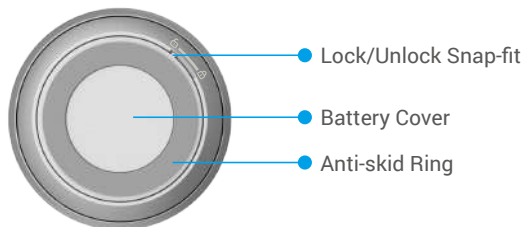

Lock/Unlock Snap-fit

Battery Cover

Anti-skid Ring

Rear

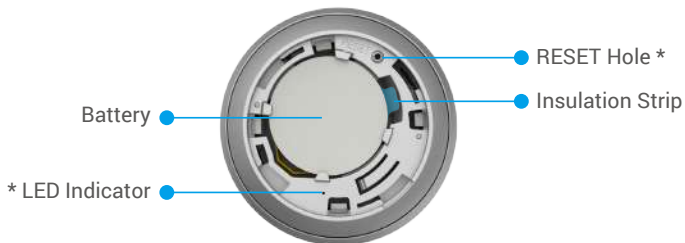

Rear(behind the cover)

Name	Description
Button	Short press, double press, or press and hold the button to perform operations. <i>i</i> The function of the remote control depends on the device it is added to.
RESET Hole	Press and hold the RESET hole with the pin for 2s, the remote control will reset and restart, and then enter adding mode.
LED Indicator	<ul style="list-style-type: none"> • Fast-flashing Blue: Remote control ready for adding. • Fast-flashing Blue and then off: Remote control is added successfully. • Fast-flashing Blue and then off in 180 seconds: Failed to be added.

Get the EZVIZ App

1. Connect your mobile phone to Wi-Fi (suggested).
2. Download and install the EZVIZ App by searching "EZVIZ" in the App Store or Google Play™.
3. Launch the App and register an EZVIZ user account.

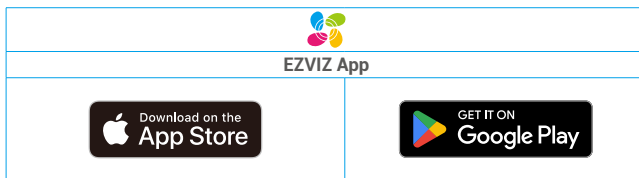

- i* If you have already used the App, please make sure that it is the latest version. To find out if an update is available, go to the App store and search for EZVIZ.

Preparations

1. Remove Cover

Hold the remote control and rotate the back cover counterclockwise to detach it.

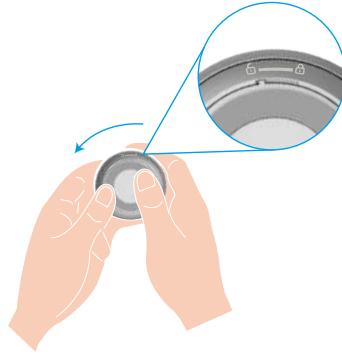

2. Remove Insulation Strip

Remove the battery insulation strip as shown in the figure below.

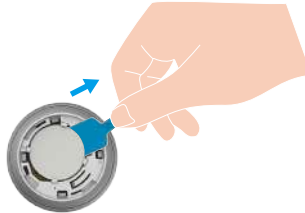

- Keep your hands dry and clean when touching the circuit board.
- If you need to replace the battery, please purchase one CR2032 210mAh.
- When replacing batteries, please insert with the positive side facing up.

Add Device

Add the remote control to other devices according to the following steps. Here takes EZVIZ Door Lock as an example.

- Place the remote control as close to the device as possible when adding it.
 - Make sure that the door lock has been installed properly and added to the EZVIZ App.
1. Log in to your EZVIZ account, select the door lock tab in the “Devices” interface.
 2. Select “Setting > Accessory Management > Bluetooth Remote Control” to go to the Scan QR Code interface.
 3. Open the battery cover of the remote control, press and hold the RESET hole with the pin for 2s until the LED indicator turns fast-flashing blue.
 4. Scan the QR code on the back of the battery cover of the remote control.
 5. Follow the EZVIZ App wizard to finish adding.
 6. Place the battery cover back to the remote control.

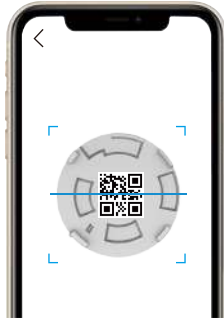

Installation

- The remote control can be put on the table, or be stuck on the wall through the double-sided tape.
- If you stick the remote control on the wall, please make sure that the remote control is below 1.5 meters.

1. Put on the Table

Put the remote control on a flat table.



2. Stick on the Wall

- Before sticking the remote control, clean the dust on the surface first. Do not stick the remote control on limewashed walls.
- Do not install the remote control on metal doors which will cause signal attenuation. You can install it on walls beside metal doors.
- It is recommended that the distance between the remote control and door lock be less than 10m. If there are walls between them, the number of walls should be no more than 1.

Take out the double-sided tape attached to the package and stick the remote control to a suitable position on the wall with the tape.



Battery Installation and Replacement

1. Install Battery

Tear off the battery insulation strip, put the battery into the base plate and insert it to the end.

2. Replace Battery

Remove the battery from base plate and replace battery with the Lithium Battery CR2032 purchased by a regular manufacturer. Test the device for correct operation whenever the batteries are replaced after re-fitting the device onto the base plate. If the device is not working properly, please add the device and configure the network again by following the steps in Setup part or directly contact our technical support.

- ⚠ Risk of explosion if the battery is replaced by an incorrect type.
- Improper replacement of the battery with an incorrect type may defeat a safeguard (for example, in the case of some lithium battery types).
- Do not dispose of the battery into fire or a hot oven, or mechanically crush or cut the battery, which may result in an explosion.
- Do not leave the battery in an extremely high temperature surrounding environment or extremely low air pressure, which may result in an explosion or the leakage of flammable liquid or gas.
- Dispose of used batteries according to the instructions.
- ⚡ identifies the battery holder itself and identifies the positioning of the cell(s) inside the battery holder.
- "+" identifies the positive terminal(s) of device which is used with, or generates direct current, "-" identifies the negative terminal(s) of device which is used with, or generates direct current.

3. Removable Lithium ion Battery (CR2032)

Chemical Name	CAS No.	% wt.
Manganese dioxide	1313-13-9	30
Graphite	7782-42-5	1.2
Carbon black	1333-86-4	1.2
Polytetrafluoroethylene	9002-84-0	1.0
Lithium	7439-93-2	2.6
Propylene Carbonate-solvent	108-32-7	2.3
1,2 Dimethoxyethane-solvent	110-71-4	2.1
Lithium salt	7791-03-9	2.4
Polypropylene (PP)	9003-07-0	4.2
Stainless steel	12597-68-1	53

- i For additional information about the device, please refer to www.ezviz.com/eu.

INFORMATION FOR PRIVATE HOUSEHOLDS

1. Separate collection of waste equipment: Electrical and electronic equipment that has become waste is referred to as waste equipment. Owners of waste equipment must dispose of it separately from unsorted municipal waste. In particular, waste equipment does not belong in household waste, but in special collection and return systems.
2. Batteries and rechargeable batteries as well as lamps: Owners of waste equipment shall, as a rule, separate waste batteries and rechargeable batteries that are not enclosed in the waste equipment, which can be removed from the waste equipment without being destroyed, from the waste equipment before handing them in at a collection point. This does not apply if waste equipment is prepared for reuse with the participation of a public waste management authority.
3. Options for returning waste equipment: Owners of waste equipment from private households can return it free of charge to the collection points of the public waste management authorities or to the take-back points set up by manufacturers or distributors within the meaning of the Electrical and Electronics Equipment Law. Stores with a sales area of at least 400 m² for electrical and electronic equipment and those grocery stores with a total sales area of at least 800 m² that offer electrical and electronic equipment several times a year or on a permanent basis and make it available in the market are required to take it back. This also applies in the case of distribution using means of distance communication, if the storage and shipping areas for electrical and electronic equipment are at least 400 m² or the total storage and shipping areas are at least 800 m². Distributors shall, in principle, ensure take-back by providing suitable return facilities at a reasonable distance from the respective end user. The possibility of returning waste equipment free of charge exists for distributors who are obliged to take it back, among other things, if a new similar device that essentially fulfills the same functions is delivered to an end user.
4. Privacy Notice: Waste equipment often contains sensitive personal data. This applies in particular to devices of information and telecommunications technology such as computers and smartphones. In your own interest, please note that each end user is responsible for deleting the data on the waste equipment to be disposed of.
5. Meaning of the symbol “crossed-out wheelee bin”: The symbol of a crossed-out wheelee bin regularly depicted on electrical and electronic equipment indicates that the respective device is to be collected separately from unsorted municipal waste at the end of its service life.