

尺寸：105x148mm

材质：100g书纸

工艺：双面四色印刷 折页

Sablute

User Manual

Wireless Keyboard Combo

After-Sales

Email:sabluteservices@outlook.com

Website URL: sablute.com

KM22 MAX

system support: win11/win10/win8/win7/mac/ios/Android/windows xp...

Product Specification

Keyboard parameters:

Product Size	430x216x36mm
Product Weight	688g±20g
Connectivity	2.4G Wireless Connection
Battery	1500mAh
Operating Voltage	3.7V
Working Time(with backlight)	15Hours
Charging Time	6Hours
Connection Distance	8-10M
Power Saving	The backlight will turn off after 90 seconds of inactivity on the keyboard
Backlight effect	9 backlight colors and 3 brightness levels
Working Distance	Within 10 meters
Key Life	10 Millions Strokes

Mouse parameters:

Mouse DPI	800-1200-1600
Power saving	Enter sleep mode after 8 min without action
Working Current	30 mA
Working Hours	30Hours
Backlight effect	Click the backlight button to cycle through 11 different lights.
Connection distance	10M

Compatible Systems: Windows XP, Windows 7/8/10/11, Mac OS, iPad OS, IOS, Android

You will receive

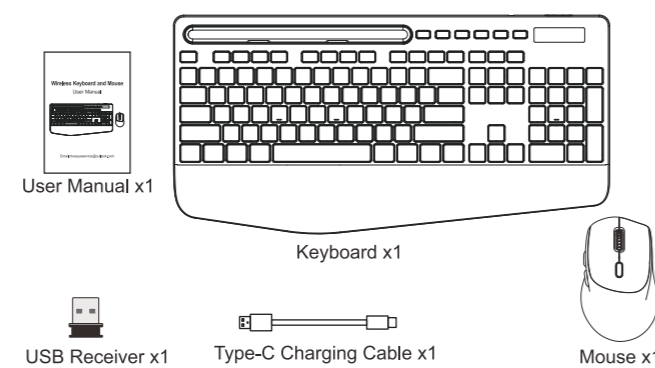

Where is my USB receiver?

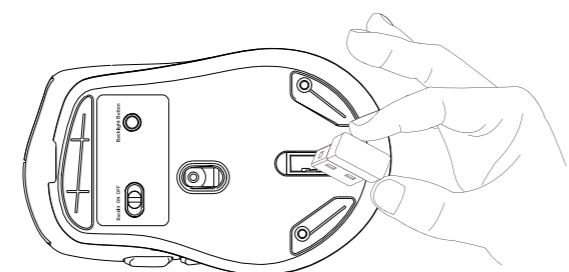

The keyboard and the mouse share a USB receiver, which is placed in the internal slot of the mouse.

How to set up

1 Step 1: Please put the USB receiver into your computer.

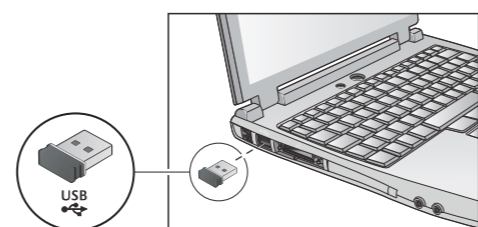

2 Step2: Turn on the keyboard and mouse.

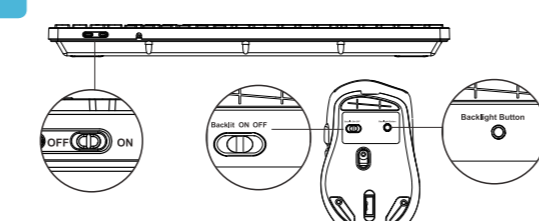

Note:Only when you turn on the mouse backlit switch, can you adjust different light colours through the backlight button.

3 Step3: The keyboard and mouse will automatically connect to the computer, no driver needed.

Indicator Light

LED Indicator of the Keyboard

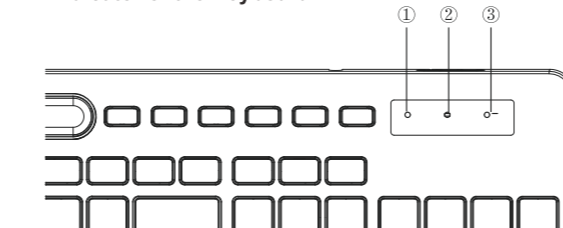

① Num Lock

The Num Lock indicator will turn red when Num Lock is activated.

② Caps Lock

The Caps Lock indicator will turn red when Caps Lock is activated.

③ Low battery warning

The battery will run out soon when the light flashes slowly.

Instruction for charging

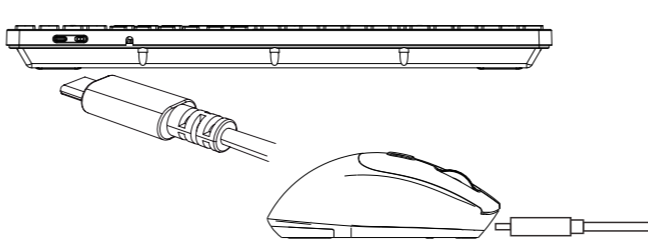

Multimedia button description

FN + F1	Media	FN + F7	Play/Pause
FN + F2	Volume-	FN + F8	CD stop
FN + F3	Volume+	FN + F9	Homepage
FN + F4	Mute	FN + F10	Mail
FN + F5	Previous Track	FN + F11	My Computer
FN + F6	Next Track	FN + F12	Favorites
FN +	Toggle Backlight		Refresh
FN +	Brightness+		Search
FN +	Brightness-		Stop
	Previous page of website		Calculator
	Next page of website	FN +	Turn on/off backlight

FAQ

Q1: Keyboard can not be connected.

A1:

Please switch on the keyboard, **ESC** + **FN** the light flashes quickly Plug the 2.4GHz USB receiver into the computer.

Within 10 seconds, put the keyboard at 10 cm from the receiver for pairing.

When the light turns off, the keyboard pairing is successful.

Q2: What should I do if the keyboard gets delayed or stuck?

A2:

Please check there is no 2.4GHz device (e.g. router) nearby to interfere with the connection.

Please check there is no full metal case that may block the signal.

Q3: Where is my USB receiver?

A3:

The keyboard and the mouse share a USB receiver, which is placed in the internal slot of the mouse.

Note

The multimedia keys are for Win 8 and Win 10,for other systems, there may be no function for some combined keys.

This equipment has been tested and found to comply with the limits for a Class B digital device, pursuant to part 15 of the FCC Rules. These limits are designed to provide reasonable protection against harmful interference in a residential installation. This equipment generates uses and can radiate radio frequency energy and, if not installed and used in accordance with the instructions, may cause harmful interference to radio communications. However, there is no guarantee that interference will not occur in a particular installation. If this equipment does cause harmful interference to radio or television reception, which can be determined by turning the equipment off and on, the user is encouraged to try to correct the interference by one or more of the following measures:

-Reorient or relocate the receiving antenna.

-Increase the separation between the equipment and receiver.

-Connect the equipment into an outlet on a circuit different from that to which the receiver is connected.

-Consult the dealer or an experienced radio/TV technician for help

Changes or modifications not expressly approved by the party responsible for compliance could void the user's authority to operate the equipment.

This device complies with Part 15 of the FCC Rules. Operation is subject to the following two conditions:

(1)This device may not cause harmful interference

(2)This device must accept any interference received, including interference that may cause undesired operation.

Cautions

1) Please fully charge the keyboard when you first receive the product as this helps to maintain the battery life.

2) Please remove the power supply when charging is complete.

3) If the keyboard is not used for a long time, it is recommended to turn off the power switch of the keyboard.

4) Please do not expose this product to water because it may cause short-circuit and damage the product.

5) Please do not drop or hit this product because shocks may damage the components inside.

6) Please do not place this product near the extreme heat or sources of fire.