

尺寸：105x148mm

材质：100g书纸

工艺：双面四色印刷 折页

Sablute

User Manual
Wireless Keyboard Combo

After-Sales
Email: sabluteservices@outlook.com
Website URL: sablute.com

MA41

system support: win11/win10/win8/win7/mac/ios/
Android/windows xp...

Where is USB?

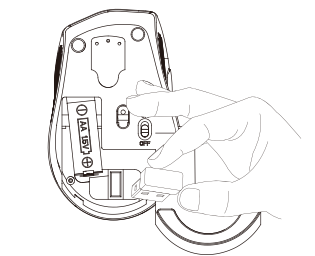

Take out the **USB from the back** of the mouse. The mouse and keyboard **share one USB**.

How to set up

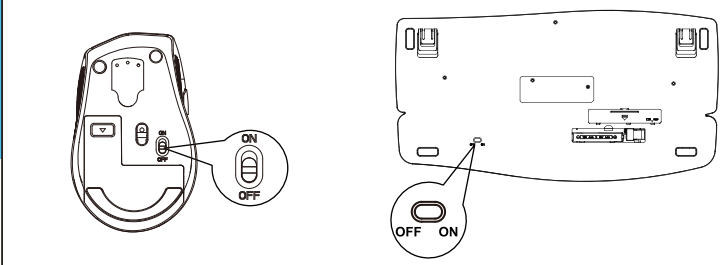

Step 1: Please put the USB receiver into your computer.
Step 2: then turn on the keyboard and mouse.
Note: The keyboard and mouse will automatically connect to the computer, no driver needed.

What to do if the keyboard loses connection with USB?

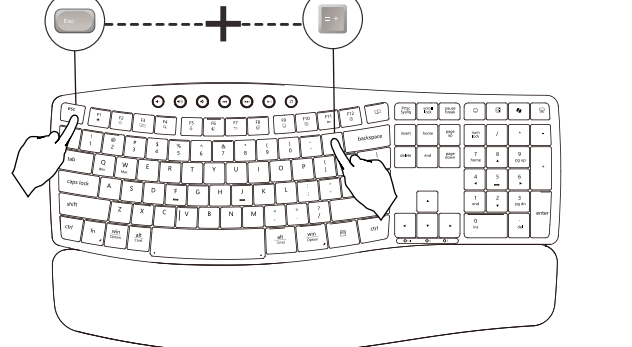

Pairing method: Long - press the "ESC" + "=" keys for three seconds until the red light flashes. Then, immediately plug in the receiver.

What to do if the mouse loses connection with USB?

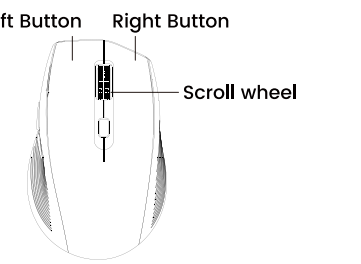

Press and hold the **left, middle, and right buttons** of the mouse for 3-5 seconds, then plug the USB into the computer.

The Functions of a Mouse

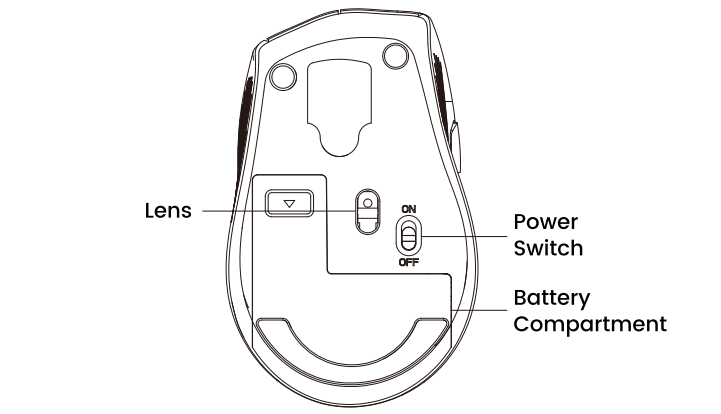
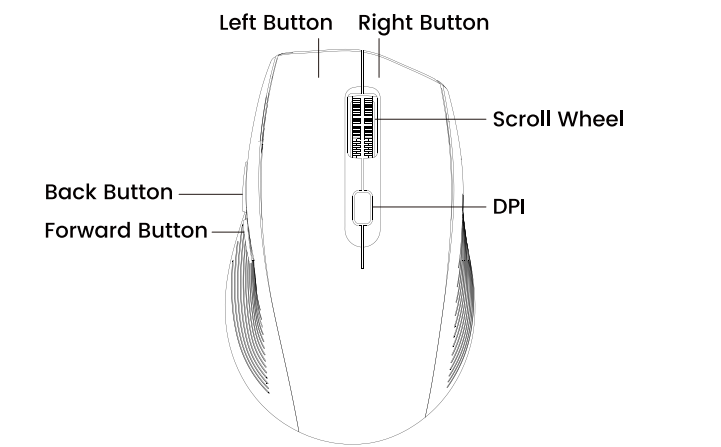

Introduction to the bottom of the keyboard

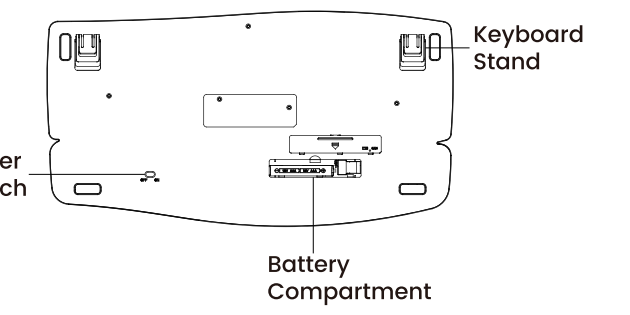

The functions of the shortcut keys

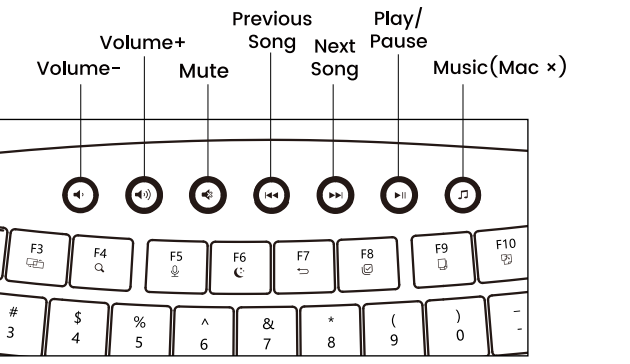

Features marked with x are not available on the Mac OS.

keyboard shortcut combination

FN Key Function Key	WIN FN+Q	MAC FN+W
	Reduce the Screen Brightness	Reduce the Screen Brightness
	Increase the Screen Brightness	Increase the Screen Brightness
	Window Switching	Window Switching
	Search Function	Search Function
	Voice Assistant	Siri
	Sleep	X
	Return	Return
	All Selected	All Selected
	Copy	Copy
	Stick	Stick
	Cut	Cut
	Language Switch	Language Switch
	Lock Screen	Lock Screen

Indicator light function

	Emoji	Emoji
	Calculator	X
	AI	X
	Screenshot	Screenshot

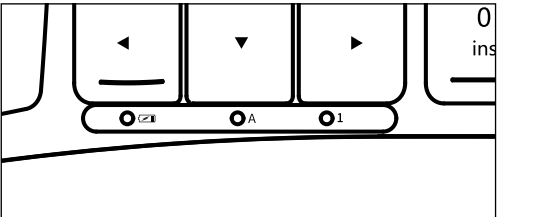

- o Num **Num LOCK:** The Num Lock indicator will turn green when Num Lock is activated.
- o Caps **Caps LOCK:** The Caps Lock indicator will turn green when Caps Lock is activated.
- o **Low battery indicator:** When the battery power is low, the low-voltage symbol lights up red, indicating that the power is low.

Product specifications and parameters

Keyboard:

Length:	438.28mm
Width:	237.14mm
Height:	31.01mm
Weight:	808±20g
Button switch life:	10 million times
Voltage:	3.0V

Mouse:

Length:	112.25mm
Width:	71.02mm
Height:	41.3mm
Weight:	72±5g
Voltage:	1.5V

FAQ

Q1: The keyboard and mouse can not be connected.

A1: Please switch on the keyboard, press "Esc" + "=", then observe the LED indicator light. Plug the 2.4GHz USB receiver into the computer. Within 10 seconds, place the keyboard at 10 cm near the receiver for pairing. When the light turns off, the keyboard pairing is successful.

mouse: Press and hold the left, middle, and right buttons of the mouse until the indicator light flashes, then plug the USB into the computer

Q2: What should I do if the keyboard gets delayed or stuck?

A2: Please check there are no 2.4GHz devices (e.g., routers) nearby that may interfere with the connection. Ensure there are no full-metal cases blocking the signal.

Q3: Where is my USB receiver?

A3: Take out the USB from the back of the mouse. The mouse and keyboard share one USB.

Customer service

Buy on SABLUTE, You will get:
30-Day Money-Back Guarantee
90-Day Free Replacement
Hassle-Free Warranty Without Returning
Lifetime Customer Support

Contact us

For FAQs and more information, please visit:

Phone: 1-888-858-1618(US), Mon-Fri,
9am-6pm (Worktime), 1pm-2pm (Rest)



sablute.com/pages/contact
sabluteservices@outlook.com

FCC Statement

This equipment has been tested and complies with the limits for Class B digital devices under Part 15 of FCC rules, designed to protect residential environments from harmful interference. The device emits radio frequency energy during use, and improper installation as per instructions may cause interference with wireless communications. If interference is detected (testable by power cycling), please take the following actions:

1. Adjust the position of the receiving antenna.
2. Increase the distance between the device and the receiver.
3. Connect the device to a different circuit outlet than the receiver.
4. Consult a technician or dealer for assistance.

Modifications not approved by the compliance responsible party will void the authority to operate the equipment. Operation is subject to two conditions:

The device must not cause harmful interference.
The device must accept any interference received, including that affecting normal operation.