

尺寸 : 90*125 MM

材质 : 100g书纸

工艺 : 双面四色印刷 折页

Sablute

User Manual

Track ball Mouse

After-Sales
Email: sabluteservices@outlook.com
Website URL: sablute.com

M2A2

system support: win11/win10/win8/win7/mac/ios/
Android/windows xp...

Package Contents (attachment)

Mouse x1 Receiver x1 Instructions x1 Charging cable x1

Product Function Introduction

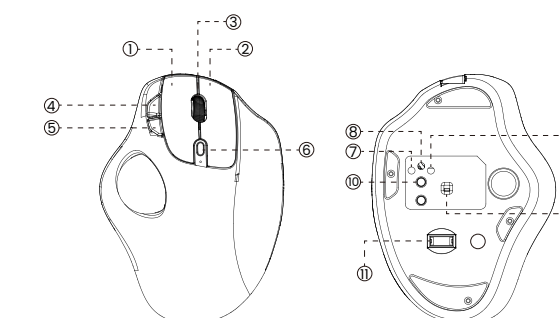

- ① Left Button
- ② Right Button
- ③ Scroll Wheel
- ④ Back Button
- ⑤ Forward Button
- ⑥ Adjust DPI Mode
- ⑦ BT 1 Indicator Light
- ⑧ BT 2 Indicator Light
- ⑨ 2.4 G Indicator Light
- ⑩ Switching Connection Methods
- ⑪ USB Receiver
- ⑫ Power Switch

-1-

Product Specifications and Parameters

Height:	49.95±0.5 mm
Length:	140.46±0.5 mm
Width:	103.73±0.5 mm
Weight:	145 g±5 g
Operating Voltage:	3.7 V
Battery Capacity:	500 mAh
Operating Current :	<5 mA
Sleep Current:	<0.1 mA
DPI:	100-200-400 (default) -800-1200

BT Mode

A. Pair Your First Device

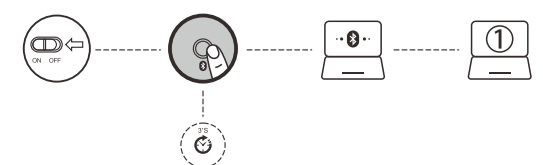

-2-

- Turn on the power switch.
- Press and hold the Bluetooth button for 3 seconds or more. The light flashes rapidly, and the mouse will enter Discoverable mode for 2 minutes.
- Complete Bluetooth pairing on your device, Use Bluetooth Named BT 3.0 or BT 5.0

B. Pair Your Second Device

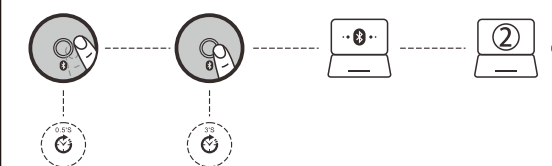

- Short press the Bluetooth button to switch channel.
- Follow Steps 2 and 3 in "Pair Your First Device" to complete pairing.
- Switch between devices.
Short press the Bluetooth button to switch between up to 3 paired devices.(Up to 2 devices via Bluetooth and 1 device via the 2.4 GHz receiver).

-3-

What If the Mouse Does Not Respond?

- Please charge the mouse with USB cable.
 - Make sure the power switch on the bottom of the mouse is "on" or at position.
 - Try to restart the computer.
 - Is the USB connection of the mouse not responding?
 - If it is still unsuccessful, please email to **E-mail: sabluteservices@outlook.com**
- Press and hold the **left, middle, and right buttons** of the mouse for 3 - 5 seconds, then plug the USB into the computer.

Left Button Right Button

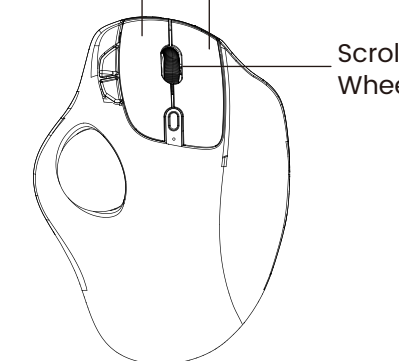

-4-

Trackball Maintenance

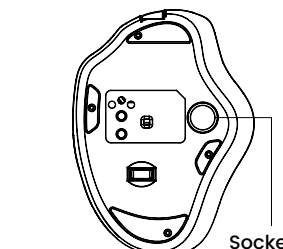

Step 1

Through the round hole on the bottom of the mouse, eject the trackball out of its socket.

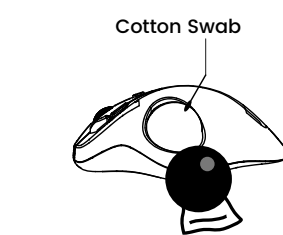

Step 2

Take out the trackball, and wipe its socket with a cotton swab cautiously.

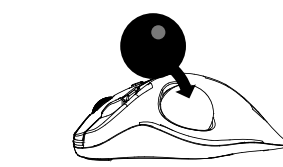

Step 3

Put the trackball back into the mouse.

-5-

Customer service

Buy on SABLUTE, You will get:
 30-Day Money-Back Guarantee
 90-Day Free Replacement
 Hassle-Free Warranty Without Returning
 Lifetime Customer Support

Contact us

For FAQs and more information, please visit:

Phone: 1-888-858-1618 (US), Mon-Fri,
9am-6pm (Worktime), 1pm-2pm (Rest)



sablute.com/pages/contact
sabluteservices@outlook.com

-6-

FCC ID

This equipment has been tested and complies with the limits for Class B digital devices under Part 15 of FCC rules, designed to protect residential environments from harmful interference. The device emits radio frequency energy during use, and improper installation as per instructions may cause interference with wireless communications. If interference is detected (testable by power cycling), please take the following actions:

- Adjust the position of the receiving antenna.
- Increase the distance between the device and the receiver.
- Connect the device to a different circuit outlet than the receiver.
- Consult a technician or dealer for assistance.

Modifications not approved by the compliance responsible party will void the authority to operate the equipment. Operation is subject to two conditions:

The device must not cause harmful interference.
The device must accept any interference received, including that affecting normal operation.

-7-