

尺寸: 70*100 MM

材质: 100g书纸

工艺: 双面四色印刷折页

Sablute

User Manual

Vertical mouse

After-Sales
Email: sabluteservices@outlook.com
Website URL: sablute.com

MAM51

system support: win11/win10/win8/win7/mac/
Android/windows xp...

Package Contents (attachment)

Instructions x1 Mouse x1 Receiver x1

Product Function Introduction

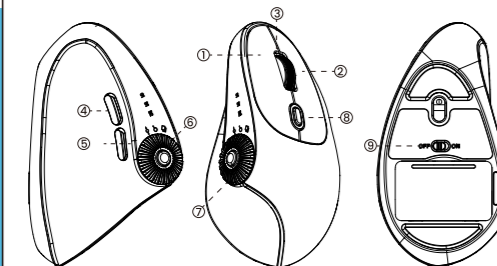

- ① Left Button
- ② Right Button
- ③ Middle Button
- ④ Forward Button
- ⑤ Backward Button
- ⑥ Multi - function Knob
- ⑦ Function Key
- ⑧ DPI Switch or Mode switch button
- ⑨ On/Off Switch

Product Parameters

Length:	121 mm
Width:	66.48 mm
Height:	74.94 mm
Weight:	85.65 ±10 g
Operating Voltage:	3.0 V
Battery Capacity:	2*AAA Batteries
DPI:	1200-2400-3200-4000
Working Hours:	30 days (150 hours)

Device Connection Tutorial

A. 2.4G connect

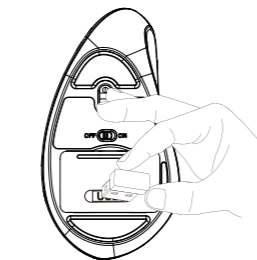

1. Plug in the USB receiver.
2. After connecting the USB to the computer, make sure the mouse display shows the connection icon as G1.
3. Once connected successfully, it can be used without any drivers.
4. If it still cannot connect in USB mode, long press the left, middle and right buttons for 3 seconds to pair. The red indicator light will flash rapidly to enter pairing mode. Bring the mouse close to the computer and reinsert the USB to connect successfully

B. BT/2 connect

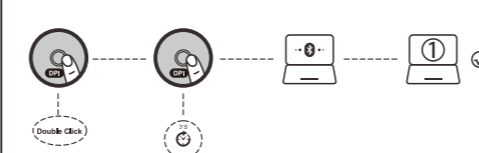

1. Turn on the power switch.
2. Quickly double-click the DPI button to switch to the BT connection icon 'B1 or B2' then press and hold the DPI button for 3 seconds. The BT indicator will flash rapidly, indicating it has entered pairing mode.
3. Complete Bluetooth pairing on your device by selecting MAM51 BT1 or MAM51 BT2.

(If you want to pair a new device, press and hold the DPI for 3 seconds to enter the corresponding Bluetooth pairing mode.)

Operating Instructions

1. DPI Button Function

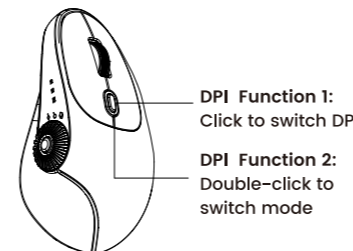

DPI Function
Click the DPI button to switch between DPI levels:
Level 1: 1200 DPI
Level 2: 2400 DPI
Level 3: 3200 DPI
Level 4: 4000 DPI

Mode Switching
Double-click the DPI button to switch connection modes in the following sequence:
2.4G → BT1 → BT2

2. Low Voltage Warning

When the battery voltage is below 2.0V, the indicator of the current mode will keep flashing to remind you to replace the battery.

3. Function Button & Knob Functions

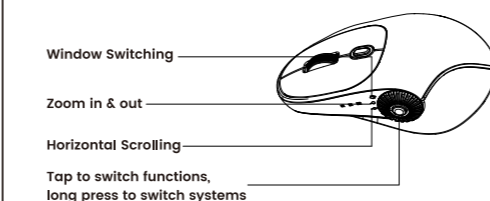

The function button supports: Window Switching / Zoom In & Out / Horizontal Scrolling within Tables.

Click the function button to cycle through the knob modes in the following order: Window Switching → Zoom In/Out → Horizontal Scrolling. Then rotate the multifunction knob to perform the corresponding action.

System Switching:

Long press the function button to switch between Windows and Mac systems.

When the current mode is "Window Switching," long press to toggle system mode:

Red light: Windows mode Green light: Mac mode

What If the Mouse Does Not Respond?

A. 2.4G connect

1. Make sure the power switch on the bottom of the mouse is "on" or at position.
2. Try to restart the computer.
3. Press and hold the left, middle, and right buttons of the mouse for 3 - 5 seconds, then plug the USB into the computer.

B. BT/2 connect

1. Check if it is the corresponding Bluetooth mode.
2. Check whether the Bluetooth connection has been completed; you can check if the device has M3IBT after successful Bluetooth connection.
3. Turn on the power.
4. If all else fails, Please press and hold the DPI button for three seconds, then re-pair the Bluetooth.

Customer service



Buy on SABLUTE, You will get:
30-Day Money-Back Guarantee
90-Day Free Replacement
Hassle-Free Warranty Without Returning
Lifetime Customer Support

Contact us

For FAQs and more information, please visit:

Phone: 1-888-858-1618 (US), Mon-Fri,
9am-6pm (Worktime), 1pm-2pm (Rest)



sablute.com/pages/contact
sabluteservices@outlook.com

Customer service

This equipment has been tested and complies with the limits for Class B digital devices under Part 15 of FCC rules, designed to protect residential environments from harmful interference. The device emits radio frequency energy during use, and improper installation as per instructions may cause interference with wireless communications. If interference is detected (testable by power cycling), please take the following actions:

1. Adjust the position of the receiving antenna.
2. Increase the distance between the device and the receiver.
3. Connect the device to a different circuit outlet than the receiver.
4. Consult a technician or dealer for assistance.

Modifications not approved by the compliance responsible party will void the authority to operate the equipment. Operation is subject to two conditions:

The device must not cause harmful interference. The device must accept any interference received, including that affecting normal operation.