



Air purifier
Purificador de aire
Purificateur d'air



User Manual
Manual de usuario
Guide d'utilisation

411+

411+

English User Manual
Model: JOY S

SAFETY	04
SYSTEM OVERVIEW	06
WHAT'S IN THE BOX	08
USAGE	09
SETUP	10
ON/OFF AND OPERATING SPEEDS	11
FILTERS	12
CARE AND MAINTENANCE	15
SPECIFICATIONS	16

General safety instructions

Remember, the 411+ is an electrical appliance. Please read these safety instructions carefully before use and take the necessary precautions to reduce the risk of fire, electric shock or injury.



WARNING: Indicates a hazardous situation that, if not avoided, could result in death or serious injury.



CAUTION: Indicates a hazardous situation that, if not avoided, could result in minor or moderate injury.

General



WARNING:

To avoid hazardous conditions, only the manufacturer, a service center authorized by Blueair or similarly qualified persons shall replace the power cord, if damaged.

CAUTIONS:



- Use the power cable provided with your 411+ unit to plug directly into an appropriate, electrical outlet. (Refer to the rating label on your unit).
- Do not alter the plug in any way.
- Remember to always disconnect the power supply before servicing the unit.
- Do not use the unit if the power cable or plug is damaged or malfunctions in any manner.
- Keep the power cable away from heated surfaces.
- Do not sit on, stand or climb onto the unit or use the unit either as a table or for storage.
- Do not place any objects on top of the unit, block air outlets or intakes, or allow foreign objects to enter the unit as this may cause an electric shock or damage the unit.

Intended Use

**CAUTIONS:**

- Supervise children to ensure that they do not play with the appliance.
- This appliance is not intended for use by persons (including children) with reduced physical, sensory or mental capabilities, or lack of experience and knowledge, unless they have been given supervision or instruction concerning use of the appliance by a person responsible for their safety.

SYSTEM OVERVIEW

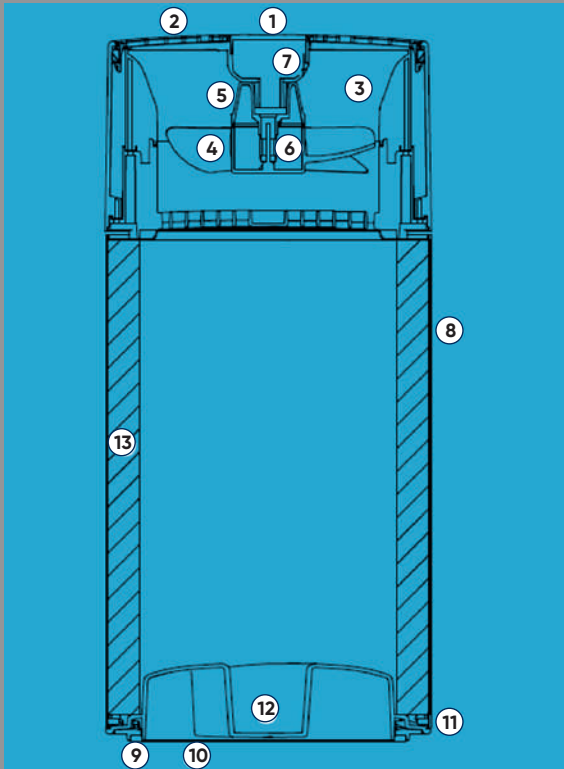

Blueprint

- 1 Touch button
- 2 Air outlet
- 3 Ion chamber
- 4 Fan blades
- 5 Fan holder
- 6 Fan motor
- 7 PCB (Printed Circuit Board)
- 8 Metal Frame
- 9 Rubber foot
- 10 Bottom lid
- 11 Bayonet connection
- 12 Locking handle
- 13 Main filter (Particle + Carbon filter or Sandwich filter)

411+ package



The 411+ air purifier

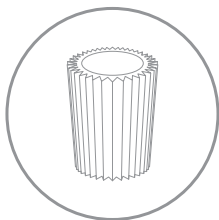

Particle + Carbon or
Sandwich filter

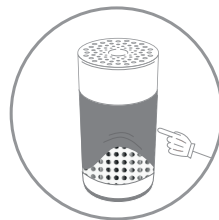

Dark Shadow fabric pre-filter
(accessory)

Options

- Particle + Carbon filter (replacement filter)
- Sandwich filter (replacement filter)
- Choice of color and design for the fabric pre-filter

Placement

Place the 411+ in an upright position on the floor in your room. Be sure to place the unit where it won't be knocked over by any person or pet in the household.

Using the unit in your bedroom?:

After 7 seconds the light automatically dims, and speed control goes into sleep mode. When the light is dimmed down, tap once to activate button and tap one more time to change speed.

Placing the unit:



Place the unit in a location where air can circulate freely in, out and around the unit.



Do not place the unit closer than 10 cm (4") from another object.



Do not place the unit directly on or against soft furnishings such as bedding or linen.



Make sure that the unit is placed in an upright position, standing on its circular rubber foot.



Do not place the unit near sources of heat, such as radiators, fireplaces or ovens.



Do not place the unit near wet areas, such as bathrooms or laundry rooms where it may come into contact with water.



Do not place the unit outdoors.

Getting started

1

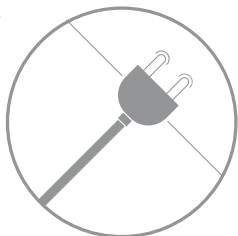

Plug in your 411+ air purifier.

2

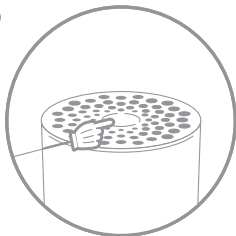

Press the top button to turn the unit on.

Adjust the speed setting to the required level (see "On/off and speed control").

On/off and speed control

1

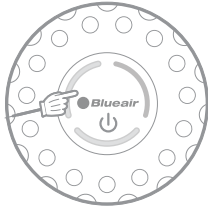

On/Low

Press once to turn the unit on and set it to the recommended energy-efficient speed 1.

2

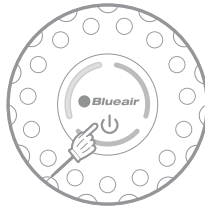

Medium

Press twice to set to medium speed 2.

3

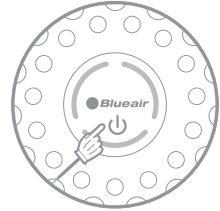

High

Press three times to set to high speed 3.

4

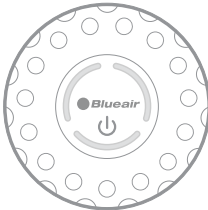

Off

Press a fourth time to turn the unit off.

INFORMATION

The indicator light(s) on the touch button indicate the selected speed for a period of 7 seconds. After 7 seconds the light(s) dim down indicating a non-active speed control mode.

Press the touch button once to reactivate on/off and speed control. The indicator light(s) light up and you can adjust the speed setting again.

Moreover, 411+ has an Autostart feature. This means that 411+ will automatically restart at the set speed if a power failure occurs, the unit is unplugged or a power switch timer is used.

Filters

General information

An additional colored pre-filter is delivered in the package to both enhance the unit's appearance and to initially capture any dust particles.

The main filter removes:



PM2.5*



Dust



Pollen



Pet dander



Mold



Dust mites



Bacteria



VOC



Smoke



Chemicals



Cooking odors

*Particle matter smaller than 2.5 microns

Vacuum or wash the pre-filter

Occasionally vacuum the exterior of the fabric pre-filter to remove any dust that has collected.

Always unplug the unit before removing the fabric pre-filter.

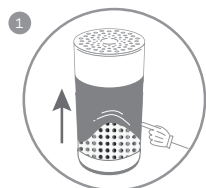

1 Remove the pre-filter from the unit's metal frame.

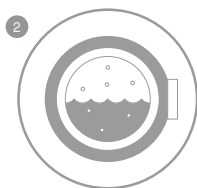

2 Wash the pre-filter in the washing machine, according to instructions on the pre-filter's label.

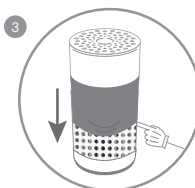

3 Refit the pre-filter back onto the unit's metal frame by guiding the elastic edge into the slot between the top cylinder and the metal frame.

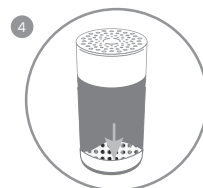

4 Attach the bottom edge of the pre-filter onto the edge of the bottom lid.

Changing the main filter

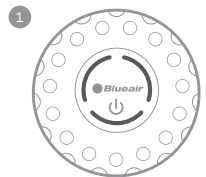

1 When the indicator lights turn red (after 6 months of operation) it is recommended to change the main filter.

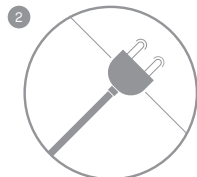

2 Turn off the unit and unplug it.

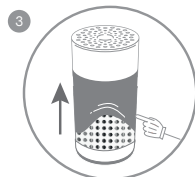

3 Remove the pre-filter from the unit's metal frame.

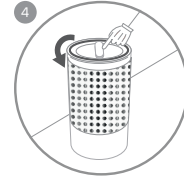

4 Carefully place the unit upside down on a flat surface and open the bottom lid by rotating counter-clockwise whilst holding the unit.

FILTERS

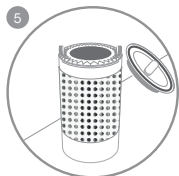

Remove the lid from the unit.

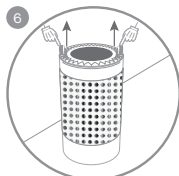

Grip the handles on the main filter and pull upwards to remove the main filter from the unit.

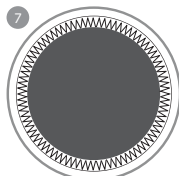

Position the new main filter into the metal frame. Ensure that the filter retains its cylindrical shape by pressing it against the metal frame from inside the unit.

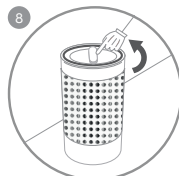

Replace the bottom lid by gently pushing it down and simultaneously rotating it clockwise to secure it back into the bayonet lock,

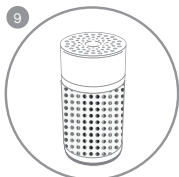

Turn the unit back into its correct position and place on the floor (see section "Placement").

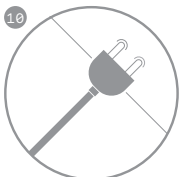

Plug and turn on the 411+ unit.

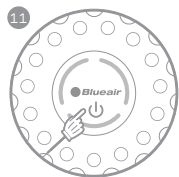

Press the touch button for a duration of 5 seconds to reset the filter replacement timer.

This lets 411+ know that you have changed the filter. The indicator light flashes 3 times, and then changes from red to white.

General care

Take good care of your 411+ to ensure that it delivers optimal performance.

- During use vacuum the pre-filter occasionally to remove dust, or wash it on a gentle, low temperature cycle in the washing machine.
- Change the main filter every six months, depending on the operating conditions. Remember to unplug the unit before changing the main filter.
- Occasionally wipe the top of the unit with a dry dust cloth.

Specifications¹

Room size:	17m ² (185 sq. ft.)					
Clean Air Delivery Rate (CADR)		Smoke	Dust	Pollen		
	cfm	119	121	131		
	m ³ /h	202	205	222		
Filter replacement indicator	Yes					
On/Off timer	No					
Speeds	1-2-3-off					
Dimensions	Height:	433 mm (17 in)				
	Width:	200 mm (7.8 in)				
	Depth:	200 mm (7.8 in)				
	Weight:	2.4 kg (5.29 lbs)				
Air exchange ²	5 per hour (17 m ² or 185 sq.ft.room)					
Power usage	1.5 - 10 W					
Noise level	17 - 46 dB(A)					
Average filter service life	six months ³					
Warranty	Local regulations					

¹Certified ratings as stated are based on models with Particle+Carbon Filter for JOY S.

²Air changes per hour are calculated on the recommended room size, assuming 8-foot (2.4-m) ceilings. For smaller rooms, the air changes per hour will increase.

³Depending on air quality in the area of use, the recommended six-month filter lifetime may be longer.



www.blueair.com

Blueair AB

Karlvägen 108
115 26 Stockholm
Sweden
Tel: +46 8 679 45 00
Fax: +46 8 679 45 45
info@blueair.se

Blueair AB Middle East

Jafza One, Office No. AB1503
Jebel Ali free Zone
P.O. Box No. 263947
Dubai, United Arab Emirates
Tel :+971 (4) 8821244
salesme@blueair.se

Blueair Asia Ltd.

7fl, Grand Millenium Plaza
181 Queen's Road Central
Central, Hong Kong
Tel :+852 3511 656
asia@blueair.se

Blueair Inc.

125 S Clark
Suite 2000
Chicago, IL 60603
USA
Tel: +1 888 258 3247
Fax: +1 312 727 1153
info@blueair.com

Blueair India Pvt. Ltd.

S-237, Greater Kailash-II
New Delhi - 110048
India
Tel: +91-124-4646119
info@blueair.in; www.blueair.com/in

Blueair (Shanghai) Trading Co. Ltd.

10th floor City Gateway
No. 398 North Caoxi Road
Xuhui Distr, Shanghai,
China
Tel: +86 21 6091 0981
Fax: +86 21 6091 0989
info@blueair.cn