



# BlendLab Pro 2.0

O W N E R ' S   G U I D E

# THANK YOU FOR PURCHASING

The BlendLab Pro 2.0



## REGISTER YOUR PURCHASE

 yflhome.com

 +91 7948223620

 Scan QR code using mobile device

## RECORD THIS INFORMATION

Serial Number: \_\_\_\_\_

Date of Purchase: \_\_\_\_\_  
(Keep receipt)

Online Site: \_\_\_\_\_

## TECHNICAL SPECIFICATIONS

Voltage: 220V ~50Hz

Power: 1200 Watts



**PLEASE READ CAREFULLY AND  
KEEP FOR FUTURE REFERENCE.**

# CONTENTS

<b>Important Safeguards .....</b>	<b>4</b>
<b>Getting to Know Your Blender .....</b>	<b>6</b>
Parts .....	6
Before First Use .....	6
<b>Using the Control Panel .....</b>	<b>7</b>
<b>Using the Jar .....</b>	<b>8</b>
<b>Care &amp; Maintenance .....</b>	<b>10</b>
Cleaning .....	10
Storing .....	10
Resetting the Motor Thermostat .....	10
<b>Troubleshooting Guide .....</b>	<b>11</b>
<b>Replacement Parts .....</b>	<b>12</b>
<b>Product Registration .....</b>	<b>12</b>
<b>Warranty .....</b>	<b>13</b>

## IMPORTANT SAFEGUARDS

HOUSEHOLD USE ONLY • READ ALL INSTRUCTIONS BEFORE USE

	<b>Read and review instructions for operation and use.</b>
	<b>Indicates the presence of a hazard that can cause personal injury, death or substantial property damage if the warning included with this symbol is ignored.</b>
	<b>For indoor and household use only.</b>
<b>When using electrical appliances, basic safety precautions should always be followed, including the following:</b>	

### WARNING

To reduce the risk of fire, electric shock, serious injury, death, or damage when using this appliance, follow these basic safety precautions.

#### General Precautions

- 1 Read all instructions prior to using the appliance and its accessories.
- 2 Carefully observe and follow all warnings and instructions. This unit contains electrical connections and moving parts that potentially present risk to the user.
- 3 **ALWAYS** exercise care when handling the Blades Assembly. The blades are sharp, handle carefully. **ONLY** grasp the Blades Assembly by the outer perimeter of the blade assembly base. Failure to use care when handling the blade assembly will result in a risk of laceration.
- 4 Take your time and exercise care during unpacking and appliance setup. This appliance contains sharp, loose blades that can cause injury if mishandled.
- 5 Take inventory of all contents to ensure you have all parts needed to properly and safely operate your appliance.
- 6 Blades are sharp. Handle carefully.
- 7 Unplug the appliance from the outlet when not in use, before assembling or disassembling parts, and before cleaning. To unplug, grasp the plug by the body and pull from the outlet. **NEVER** unplug by grasping and pulling the flexible cord.
- 8 Before use, wash all parts that may contact food. Follow washing instructions covered in this instruction manual.

- 9 To protect against the risk of electric shock, **DO NOT** submerge the appliance or allow the power cord to contact any form of liquid.
- 10 **DO NOT** use this appliance outdoors. It is designed for indoor household use only.
- 11 This appliance has important markings on the plug blade. The attachment plug or entire cordset (if plug is molded onto cord) is not suitable for replacement. If damaged, the appliance shall be replaced.
- 12 **DO NOT** operate any appliance with a damaged cord or plug, or after the appliance malfunctions or is dropped or damaged in any manner.
- 13 Extension cords should **NOT** be used with this appliance.
- 14 **DO NOT** allow children to operate this appliance or use as a toy. Close supervision is necessary when any appliance is used near children.
- 15 This appliance is **NOT** intended to be used by people with reduced physical, sensory, or mental capabilities, or lack of experience and knowledge, unless they have been given supervision or instruction concerning use of the appliance by a person responsible for their safety.
- 16 **DO NOT** attempt to sharpen blades.
- 17 **DO NOT** allow the unit or the cord to hang over the edges of tables or counters. The cord may become snagged and pull the appliance off the work surface.
- 18 **DO NOT** allow any part of the unit to contact hot surfaces, including stoves and other heating appliances.

- 19 **ALWAYS** use the appliance on a dry and level surface.
- 20 **NEVER** place a blade assembly on the motor base without it first being attached to the cup.
- 21 Keep hands, hair, and clothing out of the container when loading and operating
- 22 **ONLY** use attachments and accessories that are provided with the product or are recommended by YFL home. The use of attachments not recommended or sold by YFL home may cause fire, electric shock, or injury.
- 23 During operation and handling of the appliance, avoid contact with moving parts.
- 24 **DO NOT** operate the appliance with an empty container.
- 25 **DO NOT** fill containers past the **MAX FILL** or **MAX LIQUID** lines.
- 26 **DO NOT** microwave any containers or accessories provided with the appliance.
- 27 **DO NOT** perform grinding operations.
- 28 Before operation, ensure all utensils are removed from containers. Failure to remove utensils can cause containers to shatter and potentially result in personal injury and property damage.
- 29 **NEVER** operate the appliance without lids and caps in place. **DO NOT** attempt to defeat the interlock mechanism. Ensure the container and lid are properly installed before operation.
- 30 **DO NOT** expose the containers and accessories to extreme temperature changes. They may experience damage.
- 31 **NEVER** leave the appliance unattended while in use.
- 32 **DO NOT** blend hot liquids. Doing so may result in pressure buildup and steam exposure that can pose a risk of the user being burned.
- 33 If you find unmixed ingredients sticking to the sides of the cup, stop the appliance, remove the blade assembly, and use a scraper to dislodge ingredients.
- 34 **DO NOT** attempt to remove the container and lids from the power base while the blade assembly is still spinning. Allow the appliance to come to a complete stop before removing lid and container.
- 35 If the appliance overheats, a thermal switch will activate and temporarily disable the motor. To reset, unplug the appliance and allow it to cool for approximately 15 minutes before using again.
- 36 The maximum wattage rating for this appliance is based on the configuration of the Blades Assembly and Jar. Other configurations may draw less power or current.
- 37 To protect against risk of electrical shock, **DO NOT** immerse the power base in water or other liquid. Unplug the power base before cleaning.

## SAVE THESE INSTRUCTIONS

## GETTING TO KNOW YOUR BLENDER

### PARTS

- A** 1 N Storage Lid
- B** 1 N Sipper Lid
- C** 1 N Short Jar 700ML
- D** 1 N Tall Jar 1000ML
- E** 1 N Blending Blade
- F** 1 N 1200 W Power Base  
(attached power cord not shown)

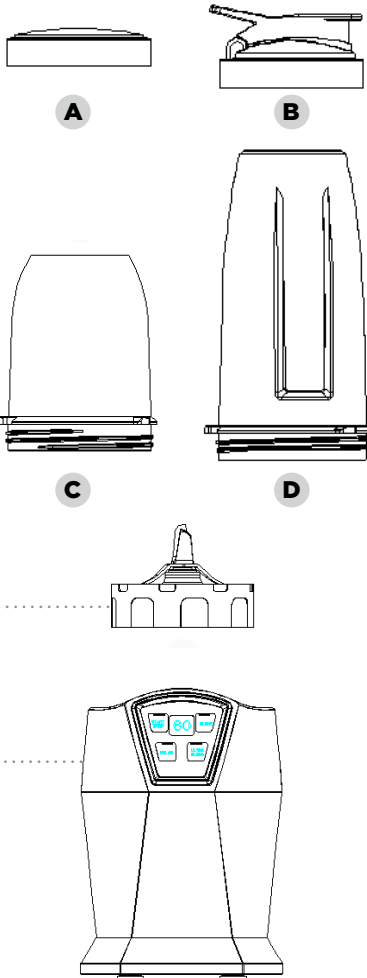

### BEFORE FIRST USE

**IMPORTANT:** Review all warnings on pages 4-5 before proceeding.

**NOTE:** Handle the Blending Blade Assembly by grasping around the perimeter of the blade assembly base.

**NOTE:** All attachments are BPA free and dishwasher safe. Ensure blade assembly and lid are removed from the container before placing in the dishwasher. Exercise care when handling blade assembly.

- 1** Remove all packaging materials from the unit. Exercise care when unpacking blade assembly, as the blades are sharp.
- 2** Wash containers, lids, and blade assembly in warm, soapy water using a dishwashing utensil with a handle to avoid direct contact with the blades. Exercise care when handling blade assembly, as the blades are sharp.
- 3** Thoroughly rinse and air-dry all parts.

## USING THE CONTROL PANEL

### PROGRAMS

Intelligent preset programs combine unique blending and pausing patterns that do the work for you. Once a preset program is selected, it will start immediately and automatically stop when blending is complete. To stop blending before the end of the program, press START/STOP or the currently active button again.

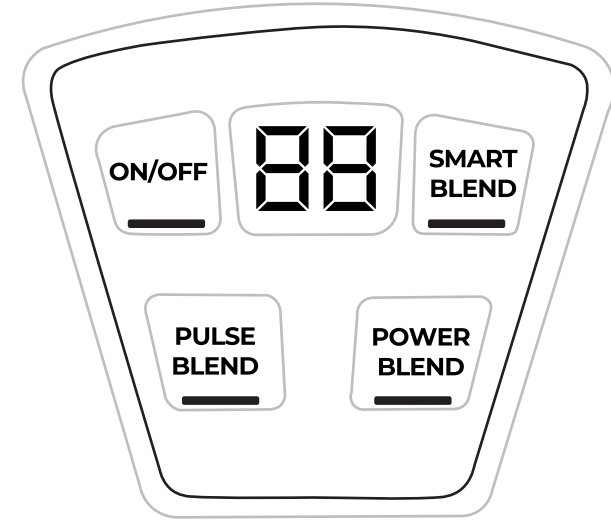

#### ON/OFF

Press once to start continuous running, press again to stop. Timer counts up by seconds, up to 60 seconds.

#### PULSE BLEND

Runs only while pressed down. Short presses make short pulses. Timer counts up by seconds as long as pressed down.

#### SMART BLEND

Pulses and blends fresh or softer ingredients to create consistent results. Timer counts down from 45 seconds.

#### POWER BLEND

Pulses and blends frozen, fibrous or hard ingredients to create smooth consistent results. Timer counts down from 60 seconds.

## USING THE JAR

**IMPORTANT:** Review all warnings on pages 4-5 before proceeding.

- 1 Plug in power base and place on a clean, dry, level surface such as a countertop or table.



- 2 Add ingredients to the jar. **DO NOT** add ingredients past the **MAX LIQUID** line.

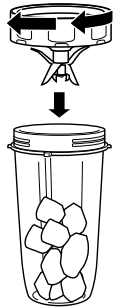

- 3 Place the Blades Assembly on the top of the cup and turn clockwise to seal.

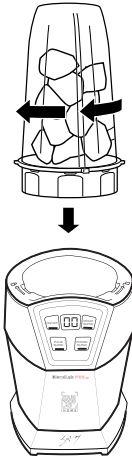

- 4 Turn the jar upside down and install on the power base by aligning the tabs on the jar with the slots on the base. Then, rotate jar clockwise until it clicks. Once locked in place, the programs will illuminate and the unit will be ready for use.

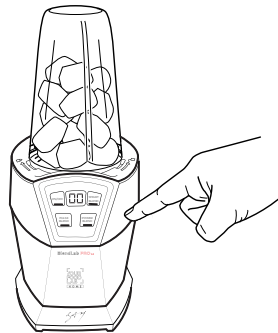

- 5a If using a program, select the program that best suits your desired output. The preset feature will automatically stop at the end of the program. To stop the unit at any time, press the currently active program again.
- 5b If using START/STOP, once the ingredients have reached your desired consistency, press START/STOP again, and wait for the unit to come to a complete stop.

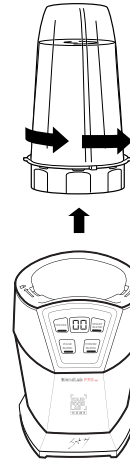

- 6 Remove the jar from the power base by turning it counterclockwise and then lifting up.



- 7 Remove the blade assembly by twisting counterclockwise. **DO NOT** store blended contents with the blade assembly attached. Only use the Lids to cover. Exercise care when handling the blade assembly, as the blades are sharp.

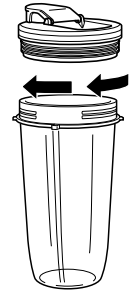

- 8 To enjoy on the go, place the Sipper Lid onto the jar and twist lid clockwise until firmly sealed.



- 9 Unplug the unit when finished. Refer to the Care & Maintenance section for cleaning and storage instructions.

## CARE & MAINTENANCE

### CLEANING

#### Hand-Washing

Wash containers, lids, and blade assembly in warm, soapy water. Use a dishwashing utensil with handle to avoid direct contact with the blades. Exercise care when handling the blade assembly as the blades are sharp. Thoroughly rinse and air-dry all parts.

#### Dishwasher

Containers, lids, and blade assembly are dishwasher safe. Ensure the blade assembly and lid are removed from the container before placing in the dishwasher.

#### Power Base

Unplug the unit before cleaning. Wipe motor base with a clean, damp cloth.

### STORING

Wrap the power cord around the cord wrap on the underside of the motor base. Store the unit upright and with the blade assembly attached to the cup.

**DO NOT** store blended or unblended ingredients in the cup with the blade assembly attached. Use only the sipper lid when storing blended or unblended ingredients in the containers.

**DO NOT** stack items on top of the containers. Store any remaining attachments alongside the unit or in a cabinet where they will not be damaged or create a hazard.

### RESETTING THE MOTOR THERMOSTAT

This unit features a unique safety system that prevents damage to the motor and drive system should you inadvertently overload it. If the unit is overloaded, the motor will be temporarily disabled. Should this occur, follow the reset procedure below.

- 1 Unplug the unit from the electrical outlet.
- 2 Allow the unit to cool for approximately 15 minutes.
- 3 Remove the blade assembly from the container. Empty the container and ensure no ingredients are jamming the blade assembly.

**IMPORTANT:** Ensure that maximum capacities are not exceeded. This is the most typical cause of appliance overload.

## TROUBLESHOOTING GUIDE

**WARNING: To reduce the risk of shock and unintended operation, unplug unit before troubleshooting.**

PROBLEMS	POSSIBLE REASONS & SOLUTIONS
<b>Motor doesn't start or attachment doesn't rotate.</b>	For the jars, make sure that the tabs are seated in the slots and turned clockwise.
<b>Food is unevenly chopped.</b>	Either you are chopping too much food at once, or you are not pulsing properly. Reduce the amount of food in the jar.
<b>Food is too finely chopped or too watery.</b>	The food has been over processed. Use short operating times for the best results.
<b>You can not achieve snow from ice cubes.</b>	For the best results, use ice straight from the freezer. Try using short operating times instead of long ones. Make sure the jar is completely dry before adding ice.
<b>Jar is leaking</b>	Make sure that your lid or blade assembly is properly assembled to the jar. Leaking may occur if it is misaligned when twisted onto the jar. Turn the lid tightly clockwise.
<b>Unit doesn't turn on</b>	Make sure the unit is plugged in. Make sure the blade assembly is properly assembled to the jar and that is not misaligned.
<b>Unit doesn't turn off</b>	Unplug the power cord from the electrical outlet and call customer service for support.
<b>Doesn't mix well</b>	Pulse ingredients for best results. Press down on the jar in short intervals for even blending and chopping. For frozen ingredients, pulse in short intervals of 2-5 seconds and repeat.
<b>Lid/blade assembly will not properly align to the jar</b>	Set the jar on a level surface. Place the lid or blade assembly on top of the jar and align the threads so that the lid/blades sit flat on the jar. Twist clockwise so that the lid/blades evenly align to the jar until you have a tight seal.

## REPLACEMENT PARTS

---

To order additional parts and attachments, visit [yflhome.com](http://yflhome.com)

## PRODUCT REGISTRATION

---

Please log onto [yflhome.com](http://yflhome.com) and complete the online warranty form with your personal and product details within 14 days.

The registration will enable us to contact you in the unlikely event of a product safety notification. By registering, you acknowledge you have read and understood the instructions for use and warnings set forth in the accompanying instructions.



## BlendLab Pro 2.0

### TWO (2) YEAR LIMITED WARRANTY

Dear Customer,

Thank you for choosing a **YFL home** consumer product. All YFL home products are designed and manufactured to the highest standards to deliver high quality performance, as well as easy installation and use. At YFL home, we believe in providing not only service, but adding value to your purchase. The warranty has therefore been designed especially for you with your interest at heart.

#### Warranty Service

This YFL home consumer product is covered against manufacturing defects from the date of purchase. The warranty is not transferable from one user/customer to another.

#### What is covered by this warranty?

1. The original unit and/or non-wearable parts deemed defective, in YFL home's sole discretion, will be repaired or replaced up to two (2) year from the original purchase date. In case of repairs or replacement of any part(s) of the product, this warranty will thereafter continue and remain in force only for the unexpired period of the warranty.

#### What is not covered by this warranty?

1. Normal wear and tear of wearable parts (such as blending vessels, lids, blades, blender bases, etc.), which require regular maintenance and/or replacement to ensure the proper functioning of your unit, are not covered by this warranty. Replacement parts are available for purchase at [yflhome.com](http://yflhome.com).
2. Any unit that has been tampered with or used for commercial purposes
3. Damage caused by misuse, abuse, negligent handling, failure to perform required maintenance (e.g., failure to keep the well of the motor base clear of food spills and other debris), or damage due to mishandling in transit.
4. Consequential and incidental damages.
5. Defects caused by repair persons not authorized by YFL home. These defects include damages caused in the process of shipping, altering, or repairing the YFL home product (or any of its parts) when the repair is performed by a repair person not authorized by YFL home.
6. Products purchased, used, or operated outside India.

#### How to get service

If your appliance fails to operate properly while in use under normal household conditions within the warranty period, visit [yflhome.com](http://yflhome.com) for product care and maintenance self-help.

Our Customer Service Specialists are also available at **07948223620** to assist with product support and warranty service options. To make a warranty claim, you must provide proof of purchase.



**Mojojojo Creators Private Ltd.**  
**07948223620**  
**[www.yfilhome.com](http://www.yfilhome.com)**

Illustrations may differ from actual product. We are constantly striving to improve our products; therefore the specifications contained herein are subject to change without notice

