



cúraa

Electric Milk Frother

O W N E R ' S G U I D E

By **YFL home**

THANK YOU FOR PURCHASING

Electric Milk Frother



REGISTER YOUR PURCHASE



yflhome.com



+91 7948223620



Scan QR code using mobile device

RECORD THIS INFORMATION

Serial Number: _____

Date of Purchase: _____

(Keep receipt)

Online Site: _____

TECHNICAL SPECIFICATIONS

Wattage:	10 W
Battery:	1500 mAh
Motor:	DC
Charging Port:	C Type
Charging Time:	5 Hours

**PLEASE READ CAREFULLY AND
KEEP FOR FUTURE REFERENCE.**

IMPORTANT SAFEGUARD

HOUSEHOLD USE ONLY

BEFORE USING FOR THE FIRST TIME

- 1** To ensure safety and maintain the high quality of the product, we recommend that you read and follow the instructions carefully.
- 2** Do not immerse the main body of the product in water or any other liquid to avoid harm to human or the product.
- 3** Keep body parts (e.g. fingers) and utensils away from the whisk when it is working .
- 4** Keep this product away from children.
- 5** Do not dismantle the product by yourself, or otherwise warranty will be invalid.
- 6** Do not use acidic, alkaline or other abrasive detergent to clean the product.
- 7** No extended use is allowed.
- 8** Keep away from flammable & explosive gas.
- 9** Use of the product in a manner not described in the instructions releases the manufacturer from all liability.

GETTING TO KNOW YOUR ELECTRIC FROTHER

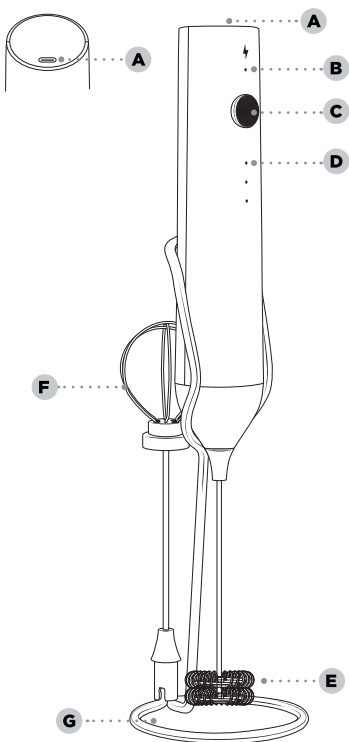

- A** Charging Socket
- B** Charging Indicator Light
- C** Power Button
- D** Speed Setting Indicator
- E** Spring Whisk
- F** Balloon Whisk
- G** Storage Stand
- H** Type-C Charging Cable

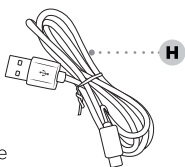

HOW TO CHARGE

- 1** Insert the charging cable interface into the Type-C charging socket at the top of the frother.
- 2** Connect the charging cable with an adapter, insert the adaptor into an indoor electric socket, the indicator light lights up, indicating it is charging normally.
- 3** The indicator light stops lighting when the battery is fully charged.
- 4** It takes less than 5 hours to fully charge the battery.

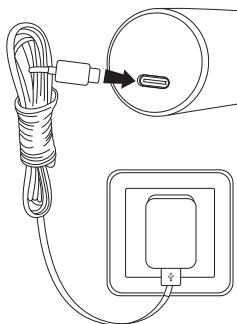

NOTE: Adapter not Included

⚠ CAUTIONS

- 1** Before connecting to the power source, please make sure the adapter, charging cable plug, and the charging port on the device are completely dry.
- 2** Always ensure that the device is disconnected from the power supply if it is to be left unattended.
- 3** Before each use, check that the appliance and cord are in good condition. Never use an appliance if the cord is damaged.
- 4** This is a rechargeable lithium-battery product. When not in use, it is recommended to charge every three months to ensure service life of the battery.
- 5** Adapter is not included with this product. Charge with UL/GS or equivalent safety approved adapters with output voltage of 5V.

HOW TO USE

- 1 Align the notch on the stirring head to the arrow on the docked buckle, then push the stirring head firmly onto the slot.

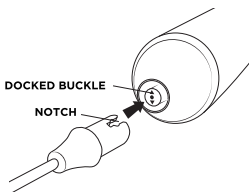

NOTE: Please note that in the case of correct operation, the installation process should be easy, if the installation is difficult to tighten, please do not press it by force to avoid damage to the components. Try to confirm and adjust the direction or position, and repeat the installation.

- 2 Press the button once and release it, the frother starts working.

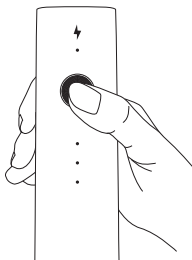

The frother's speed is controlled by a button with three adjustable settings: 1st speed, 2nd speed, and 3rd speed. Pressing the button once activates the frother at the 1st speed setting, with its indicator light turning on. Pressing it again switches to the 2nd speed setting, where both the 1st and 2nd setting lights illuminate. A third press selects the 3rd speed setting, lighting up all three indicators. Pressing the button a fourth time stops the frother, turning off all lights.

Additionally, pressing and holding the button at any speed setting will immediately stop the frother.

SPEED SETTINGS RECOMMENDATIONS

1st Speed Setting - Low Speed: Best for making egg custard and sauces.

2nd Speed Setting - Medium Speed: Ideal for making baby food and jam.

3rd Speed Setting - High Speed: Suitable for making milk foam and meringue.

It is recommended to use a combination of different speed settings when whipping meringue for optimal results.

⚠ CAUTIONS

- 1** After use, do not rinse the product directly, as water may enter the main unit and cause damage. It is recommended to immerse the frother's whisk in a cup of water and press the button to stir for easy cleaning.
- 2** When not in use, store the product in a clean and dry place.
- 3** The whisk is detachable. Do not try to detach or touch the whisk under working condition.
- 4** It is recommended that the continuous working time of this product should not exceed 2 minutes.
- 5** If there is water or other liquid on the whisk, please do not place the product upside down to avoid water flowing into the main body.

TROUBLESHOOTING

If the frother does not work or stops during frothing:

Please recharge it and then try again. (Note: It is not recommended to use the product while charging.)

If the above operations are all correct and the frother still works abnormally, please contact Cüraa/YFL home customer care for assistance.

cüraa

Electric Milk Frother

ONE (1) YEAR LIMITED WARRANTY

Dear Customer,

Thank you for choosing a **Cüraa by YFL home** consumer product. All Cüraa products are designed and manufactured to the highest standards to deliver high quality performance as well as easy installation and use. At Cüraa, we believe in providing not only service, but adding value to your purchase. The warranty has therefore been designed especially for you with your interest at heart.

Warranty Service

This Cüraa consumer product is covered against manufacturing defects from the date of purchase. The warranty is not transferable from one user/customer to another.

What is covered by this warranty?

1. The original unit and/or non-wearable parts deemed defective, in Cüraa's sole discretion, will be repaired or replaced up to one (1) year from the original purchase date. In case of repairs or replacement of any part(s) of the product, this warranty will thereafter continue and remain in force only for the unexpired period of the warranty.

What is not covered by this warranty?

1. Normal wear and tear of wearable parts, which require regular maintenance and/or replacement to ensure the proper functioning of your unit, are not covered by this warranty. Replacement parts are available for purchase at yflhome.com
2. Any unit that has been tampered with or used for commercial purposes.
3. Damage caused by misuse, abuse, negligent handling, failure to perform required maintenance (e.g., failure to keep the well of the motor base clear of food spills and other debris), or damage due to mishandling in transit.
4. Consequential and incidental damages.
5. Defects caused by repair persons not authorized by Cüraa. These defects include damages caused in the process of shipping, altering, or repairing the Cüraa product (or any of its parts) when the repair is performed by a repair person not authorized by Cüraa.
6. Products purchased, used, or operated outside India.

How to get service

If your appliance fails to operate properly while in use under normal household conditions within the warranty period, visit **yflhome.com** for product care and maintenance self-help.

Our Customer Service

Specialists are also available at

Email: support@yflhome.com,

Phone: +917948223620,

to assist with product support and warranty service options. To make a warranty claim, you must provide proof of purchase.

For recipes follow this QR



@yflhome

Sevenchef Consumers Home & Kitchen Private Ltd.
+917948223620
www.yflhome.com

Illustrations may differ from actual product.
We are constantly striving to improve our products,
therefore the specifications contained herein are
subject to change without notice.